

# AVION®

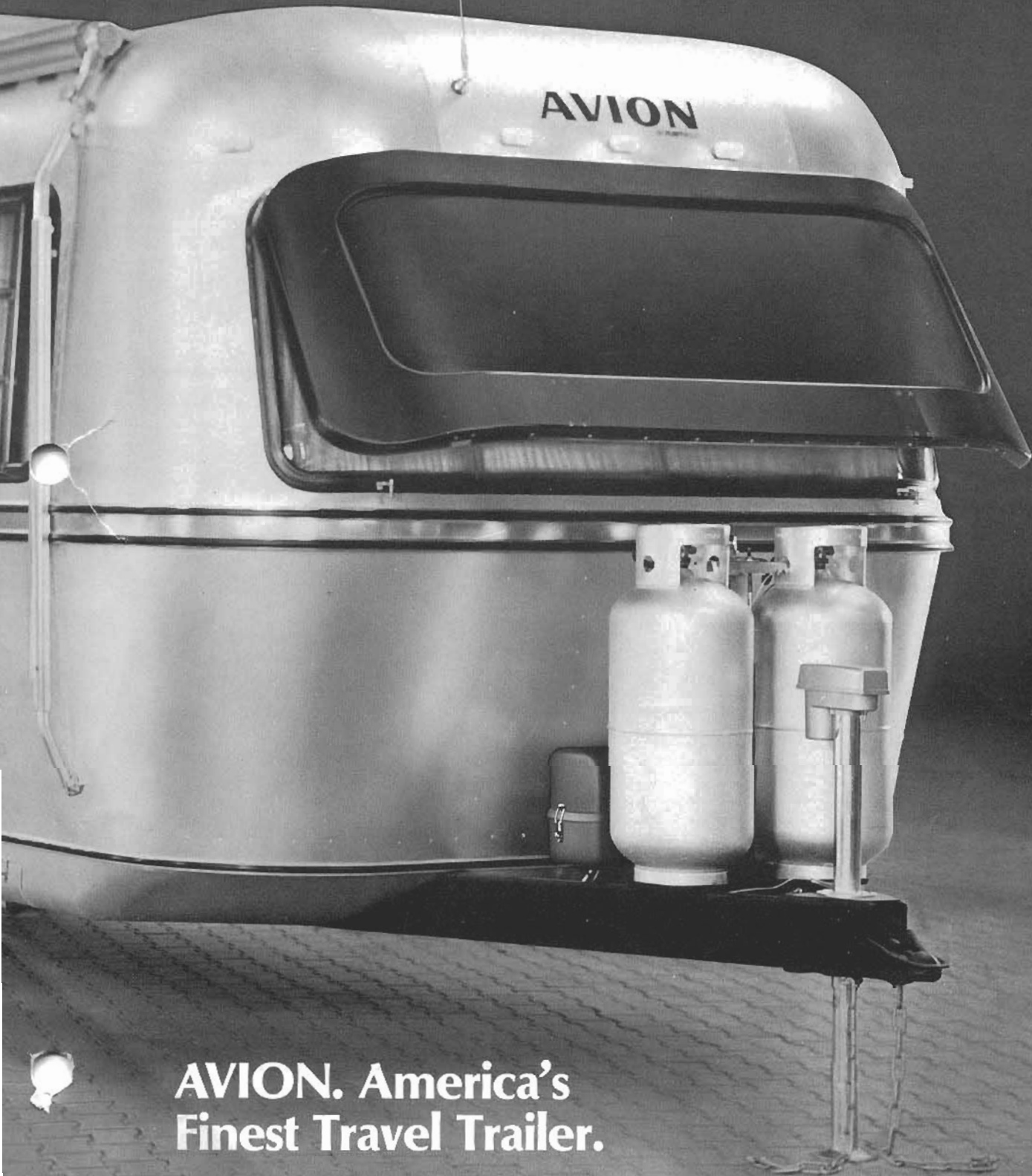

**AVION. America's  
Finest Travel Trailer.**

# Avion Model Selector

CHUCK  
Avion - 800-882-7728



## MODEL 30P

This tandem axle model features the side sofa bed and twin swivel chairs. No charge options include a double bed and a front sofa bed with side mounted extension table and swivel chair. Living room and bath are the same size as in Model 34V.

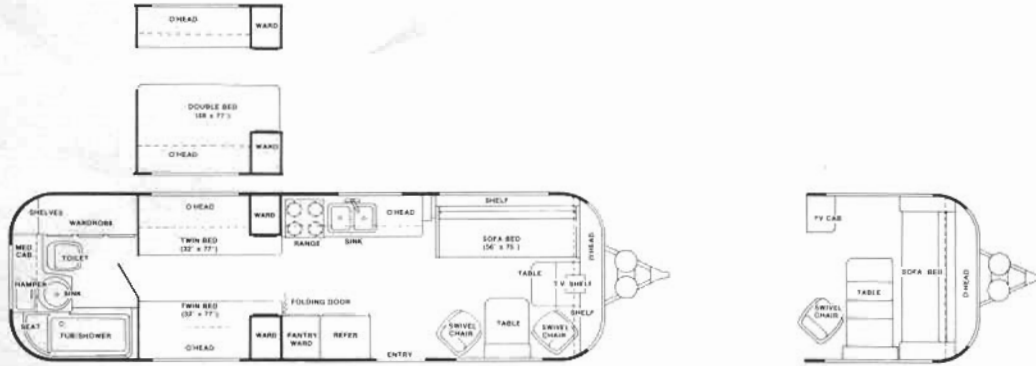

## MODEL 30R

This tandem axle plan offers center bath convenience and rear bedroom privacy. No charge options include a double bed and front sofa bed with side mounted extension table and swivel chair. Center bath has full size tub/shower.



## MODEL 34V

This highly popular Avion model offers the traditional features the discriminating family desires. No charge options include a front sofa bed with a side mounted extension table and swivel chair; double bed, roadside wards and vanity. Has tri-axle Adjust-A-Ride™ suspension.

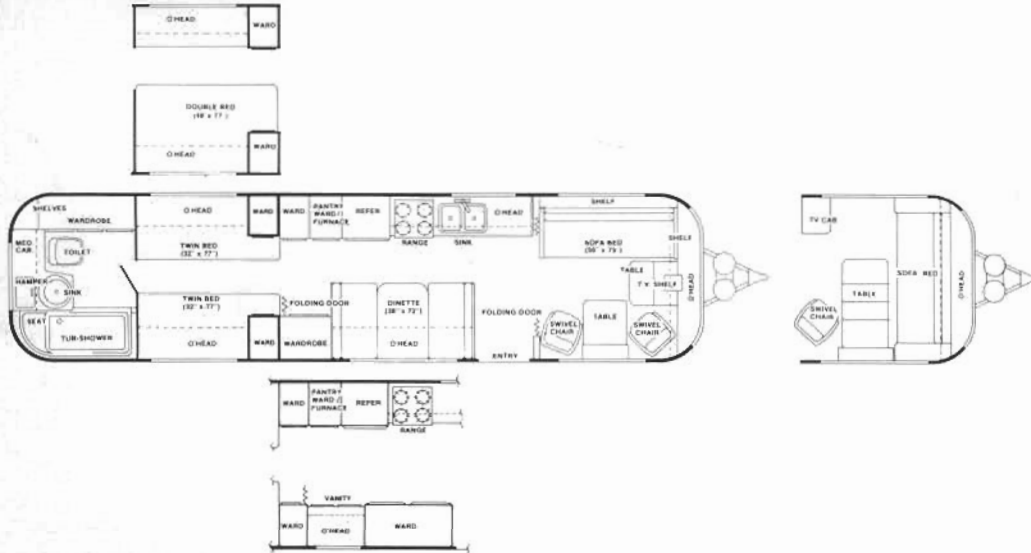

## MODEL 34W

This thirty-four foot tri-axle model has an extra large center bath with an exclusive full tub/shower and rear bedroom. It features the side sofa bed, tables and swivel chairs. No charge options include a double bed and front sofa bed with a side mounted extension table and swivel chair.

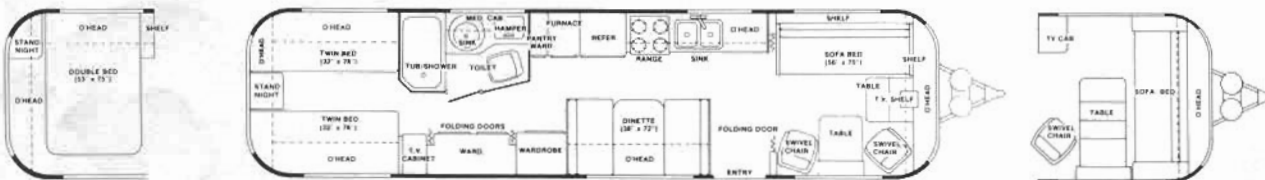

# 1984 Avion Specifications

	Model			
	30P	30R	34W	34V
<b>WEIGHTS, MEASURES</b>				
LENGTH, INCLUDING HITCH	30'-1"	30'-1"	34'-11"	34'-11"
WIDTH	7'-10 3/4"	7'-10 3/4"	7'-10 3/4"	7'-10 3/4"
HEIGHT (INCLUDING ROOF AIR)	9'-11"	9'-11"	9'-11"	9'-11"
GVWR — LBS.	8,550	8,550	9,500	9,500
GROSS DRY WEIGHT — LBS.	5,840	5,890	6,730	6,940
HITCH DRY WEIGHT — LBS.	630	610	720	765
<b>LIVABILITY SYSTEMS</b>				
FRESH WATER — GALS.	65	65	65	65
MANUAL WATER FILL — SPOUT W/LOCK	•	•	•	•
DUAL HOLDING TANKS - WASTE/GREY — GALS.	40/30	40/30	40/30	40/30
DUAL LP TANKS, SIGHT GAUGE — LBS.	40	40	40	40
EVERPURE™ WATER PURIFIER	•	•	•	•
13.5M BTU ROOF AIR, HEAT STRIP	•	•	•	•
LPG AUTO CHANGEOVER REGULATOR	•	•	•	•
30M BTU DUCTED FURNACE W/THERMOSTAT	•	•	•	•
ELECTRONIC IGNITION WATER HEATER — GALS.	6	6	6	6
<b>CONSTRUCTION</b>				
RIVETED ALUMINUM RIBS AND STRINGERS	•	•	•	•
BRIGHT ANODIZED ALUMINUM EXTERIOR	•	•	•	•
2" x 6" TUBULAR STEEL CHASSIS*	•	•	•	•
ADJUST-A-RIDE™ SUSPENSION	•	•	•	•
RIVETED VINYL COATED ALUMINUM INTERIOR	•	•	•	•
HAND FINISHED SOLID WOOD CABINETY	•	•	•	•
HEAVY DUTY REAR BUMPER	•	•	•	•
STEEL WHEELS, DELUXE COVERS	•	•	•	•
FULL SIZE ALUMINUM ENTRY/SCREEN DOOR	•	•	•	•
THERMO-X™ INSULATION	•	•	•	•
CODE APPROVED WIRING, PLUMBING	•	•	•	•
INSULATED SANDWICH PANEL SUBFLOOR	•	•	•	•
VINYL FOAM SEALANT TAPE	•	•	•	•
ELECTRIC BRAKES, ALL WHEELS	•	•	•	•
TIRES, H78 x 15 ST — LOAD RANGE	C	C	C	C
7.00 x 15 LT — LOAD RANGE	D	D	D	D
<b>ELECTRICAL</b>				
DUAL 12 VOLT BATTERY CONTAINER	•	•	•	•
OMNIPOWER 110V CONVERTER/CHARGER	•	•	•	•
UTILITY COMPARTMENT 110V OUTLET	•	•	•	•
EXTRA LONG H.D. 110V SHORE LINE	•	•	•	•
PREWIRED FOR CABLE TV	•	•	•	•
SWITCH CONTROLLED INTERIOR/EXTERIOR LIGHTING	•	•	•	•
<b>TRAVEL/CAMPING CONVENIENCES</b>				
FRONT WINDOW ROCKGUARD/SUNSHADE	•	•	•	•
HEAVY DUTY POWER HITCH JACK	•	•	•	•
RETRACTABLE ENTRY STEP W/HINGED COVER	•	•	•	•
MULTIPLE EXTERIOR STORAGE COMPARTMENTS	•	•	•	•
STABILIZING JACKS	•	•	•	•
EXTERIOR CONVENIENCE LIGHTS, HITCH, UTILITIES	•	•	•	•
AWNING RAILS, BOTH SIDES	•	•	•	•
WATER HOSE COMPARTMENT	•	•	•	•
CONCEALED DRAIN HOSE VALVE	•	•	•	•
LIGHTED TRUNK WITH SPARE TIRE AND JACK	•	•	•	•
BACKUP LIGHTS	•	•	•	•
EMERGENCY EGRESS, FIRE EXTINGUISHER	•	•	•	•
REAR HOSE STORAGE COMPARTMENT	•	•	•	•
LARGE TINTED GLASS TORQUE WINDOWS	•	•	•	•
RV SYSTEMS MONITOR W/12V FAILSAFE	•	•	•	•
<b>PERSONAL CONVENIENCES</b>				
ADJUSTABLE READING LIGHTS	•	•	•	•
AM/FM CASSETTE STEREO W/4 SPEAKERS	•	•	•	•
BRAUND SKYLINER™ VHF/UHF TV ANTENNA W/AMPLIFIER	•	•	•	•
DOMETIC™ 10 CU. FT. (RATED) AUTO 3-WAY REFRIGERATOR	•	•	•	•
MAGIC CHEF™ MICROWAVE OVEN	•	•	•	•
SEALY POSTUREPEDIC™ MATTRESS(ES)	•	•	•	•
LIGHTED/FAN POWERED GALLEY VENT	•	•	•	•
DELUXE CEILING VENTS WITH FANS	•	•	•	•
5" THICK SUPERFOAM CUSHIONS	•	•	•	•
INDIRECT LIGHTING, LIVING ROOM	•	•	•	•
REMOVABLE DEEP PILE CARPET	•	•	•	•

\* Includes additional 2" x 4" tubular steel reinforcement at load bearing points.

Prices and specifications are subject to change without notice.



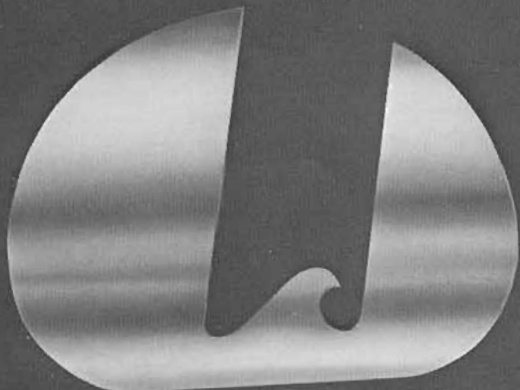

Your local dealer is:

**FLEETWOOD®**

FLEETWOOD ENTERPRISES, INC.  
P.O. Box 7638  
Riverside, California 92523