

Lakeview Estates at Lac La Nonne Proposed Area Structure Plan

Servicing and Storm Water Management Concept

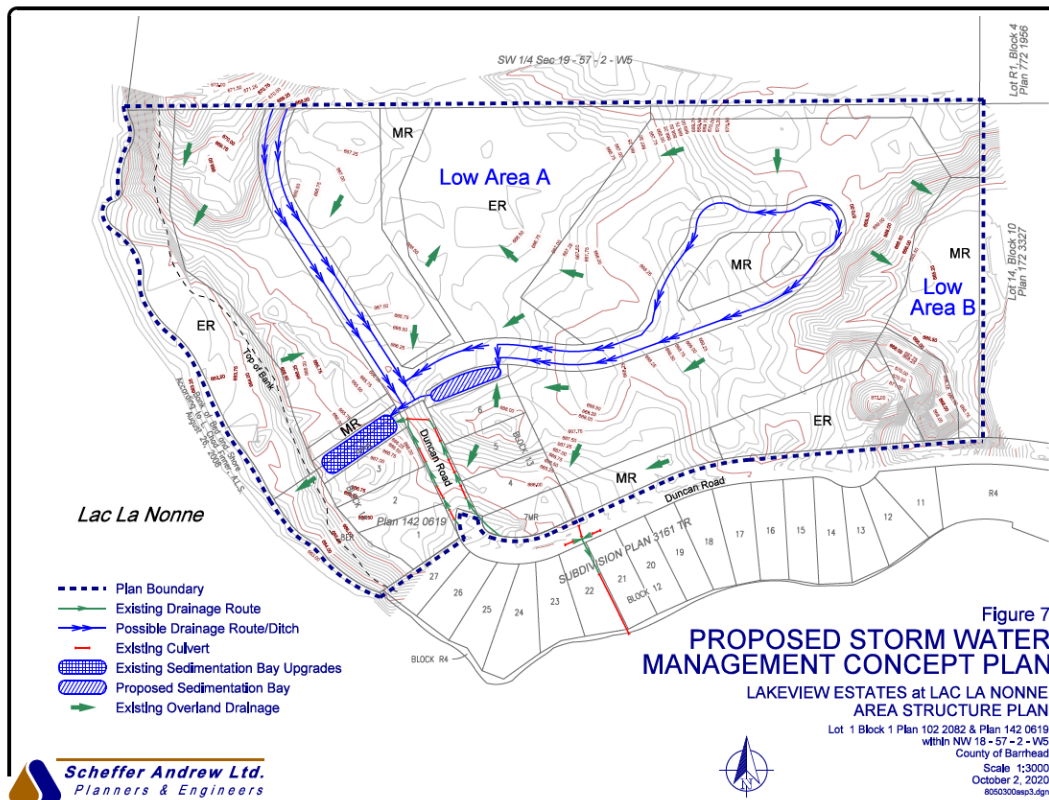

- ❖ Wastewater Servicing: All lots will be required to have a holding tank with pump out by vacuum truck. All tanks must comply with Alberta Environment and Parks, Safety Codes and County of Barrhead standards.
- ❖ Water Servicing: Drilled wells are only allowed on the existing six registered lots and the remaining lots must have cisterns with water hauled in.
- ❖ Storm water management for the proposed subdivision will consist of roadside ditches, culverts, and sedimentation basins located within Public Utility Lots.
- ❖ No on-site storm water detention is proposed as the calculated post-development increase in runoff will have a minimal impact on Lac La Nonne's water levels.
- ❖ Public Utility Lots will be owned and maintained by the County of Barrhead.
- ❖ A portion of the lots that are naturally sloped to the existing low areas will continue to retain their natural drainage patterns.
- ❖ Storm water management will meet or exceed the requirements of Alberta Environment. By using low impact development techniques for stormwater management, there will be an improvement in water quality of the surface runoff that is discharged into the lake.