

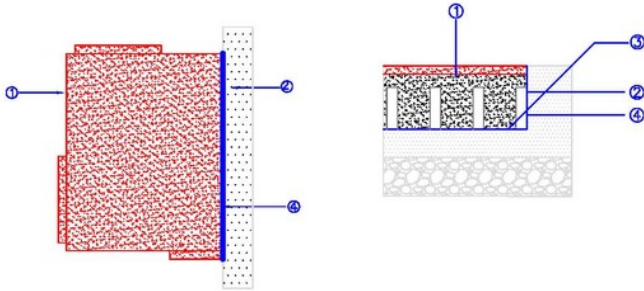

P.O. BOX 239, 4393 DISCOVERY LINE
 PETROLIA, ONTARIO
 N0N 1R0
 PHONE: (800) 263-2363
 PHONE: (519) 882-8799
 FAX: (519) 882-2697
 EMAIL: info@softsurfaces.com

Partial Tile Against a Vertical Surface



LEGEND:

- ① SoftTile® (See Specifications for Thickness and Color).
- ② Vertical Surface (Curb, Wall or Timber) See Specifications for Details.
- ③ Applied Adhesive (See Installation Instructions Below).
- ④ Window and Door Spray Foam May Be Applied If Extra Support is Required

SoftTile Thickness	Critical Fall Height (FT)	FILE NAME	Partial Tile Against a Vertical Edge	PREPARED BY	B. GOSS
2.00"	3'	REV	DESCRIPTION	DATE	
2.25"	4'	0	ORIGINAL ISSUE	11/15/11	
2.75"	5'	1	Updated	9/12/13	
3.25"	6'				
3.75"	7'				
4.25"	8'				
4.75"	9'				
5.00"	10'	SIZE	SCALE	DWG NO.	REV
5.75"	12'	A	N/A	2012-020	1



P.O. BOX 239, 4393 DISCOVERY LINE
 PETROLIA, ONTARIO
 N0N 1R0
 PHONE: (800) 263-2363
 PHONE: (519) 882-8799
 FAX: (519) 882-2697
 EMAIL: info@softsurfaces.com

Full Tile Installed Against A Vertical Surface

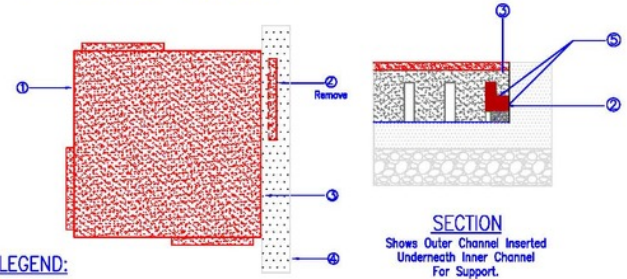

LEGEND:

- ① SoftTile® (See Specifications for Thickness and Color).
- ② Outer Channel.
- ③ Inner Channel.
- ④ Vertical Surface (Curb, Wall or Timber) See Specifications for Details.
- ⑤ Applied Adhesive (See Installation Instructions Below).

INSTALLATION INSTRUCTIONS:

1. Cut Outer Channel ② Flush With Edge of Tile to Allow Installation Against Vertical Surface.
2. Rotate and Insert Outer Channel ② Underneath Adjacent Inner Channel ③.
3. 1/2" Diameter Continuous Bead of SoftTile Adhesive at Each KrosLOCK Joint.
4. Apply SoftTile Adhesive to Hold Outer Channel in Place. In addition, adhere the first 12" of the

SoftTile Thickness	Critical Fall Height (FT)	FILE NAME	Full Tile Against Vertical Edge	PREPARED BY	B. GOSS
2.00"	3'	REV	DESCRIPTION	DATE	
2.25"	4'	0	ORIGINAL ISSUE	11/15/11	
2.75"	5'	1	Updated	9/12/13	
3.25"	6'				
3.75"	7'				
4.25"	8'				
4.75"	9'				
5.00"	10'	SIZE	SCALE	DWG NO.	REV
5.75"	12'	A	N/A	2012-021	1



P.O. BOX 239, 4393 DISCOVERY LINE
 PETROLIA, ONTARIO
 N0N 1R0
 PHONE: (800) 263-2363
 PHONE: (519) 882-8799
 FAX: (519) 882-2697
 EMAIL: allinfo@softsurfaces.com

SoftTile Over Aggregate Contained by Curb

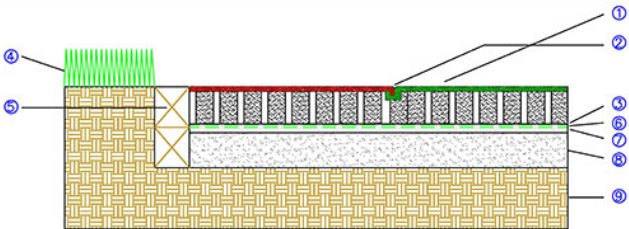

LEGEND:

- ① SoftTile® (See Specifications for Depth and Color).
- ② 1/2" Diameter Continuous Bead of SoftTile® Adhesive at Each KrosLOCK Joint.
- ③ 1.0% Slope - 1/8" / 12" (3mm / 300mm).
- ④ Sod
- ⑤ Containing Sidewalk/Curb/Timber
- ⑥ Rubber Sheeting to Stop 4" from Curb to Allow Drainage into Granular Base.
- ⑦ Minimum 1" deep 1/4" minus Fine Crushed Compacted Granite Screenings (As Required) to Achieve a Max 1/4" (6mm) Variation in Grade When Measured With a 10' (3m) Straight Edge in any Direction.
- ⑧ Compacted Granular A (Type I) (3/4" minus) to 95% S.P.D. (See Specifications for Depth).
- ⑨ Compacted Subgrade.

NOTES:

1. Consult with a local Civil Engineer to find out what drainage system is best for your application.
2. Ensure subsoil drains towards drainage system.
3. Review Most Recent Installation Manual and Sub Surface Guide

SoftTile Thickness	Critical Fall Height (FT)	FILE NAME	Over Aggregate Contained by Curb	PREPARED BY	B. GOSS
2.00"	3'	REV	DESCRIPTION	DATE	
2.25"	4'	0	ORIGINAL ISSUE	11/15/11	
2.75"	5'	1	Updated	9/12/13	
3.25"	6'				
3.75"	7'				
4.25"	8'				
4.75"	9'				
5.00"	10'	SIZE	SCALE	DWG NO.	REV
5.25"	11'	A	N/A	2012-022b	1
5.75"	12'				



P.O. BOX 239, 4393 DISCOVERY LINE
 PETROLIA, ONTARIO
 N0N 1R0
 PHONE: (800) 263-2363
 PHONE: (519) 882-8799
 FAX: (519) 882-2697
 EMAIL: info@softsurfaces.com

SoftTile Contained by SofRAMP

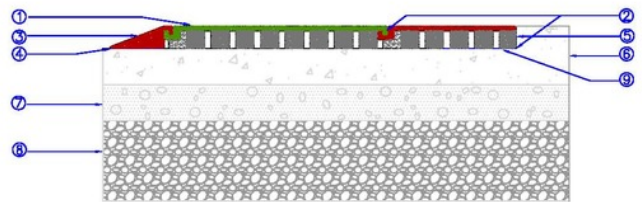

LEGEND:

- ① SoftTile® (See Specifications for Depth and Color).
- ② 1/2" Diameter Continuous Bead of SoftTile Adhesive at Each KrosLOCK Joint.
- ③ SofRAMP (ADA) or Standard SofRAMP Jr (See Specifications for Details).
- ④ Apply SoftTile Adhesive to Entire Bottom Edge and locking joint of SofRAMP.
- ⑤ Cut off "Lock" at any Retainer. Use Adhesive on the Retainer, and Under First 12" (300mm) of Perimeter Tiles.
- ⑥ Concrete or Asphalt Base and Curb (See Specifications for Depth and Details).
- ⑦ Compacted Granular A Type I
- ⑧ Compacted Subgrade.
- ⑨ 1.0% Slope - 1/8" / 12" (3mm / 300mm).

NOTES:

1. Consult with a local Civil Engineer to find out what drainage system is best for your application.
2. Ensure subsoil drains towards drainage system.
3. Review Most Recent Installation Manual and Sub Surface Guide

SoftTile Thickness	Critical Fall Height (FT)	FILE NAME	SoftTile Contained by ramp	PREPARED BY	B. GOSS
2.00"	3'	REV	DESCRIPTION	DATE	
2.25"	4'	0	ORIGINAL ISSUE	11/15/11	
2.75"	5'	1	Updated	9/12/13	
3.25"	6'				
3.75"	7'				
4.25"	8'				
4.75"	9'				
5.00"	10'	SIZE	SCALE	DWG NO.	REV
		A	N/A	2012-024	1



P.O. BOX 239, 4393 DISCOVERY LINE
 PETROLIA, ONTARIO
 NON 1R0
 PHONE: (800) 263-2363
 PHONE: (519) 882-8799
 FAX: (519) 882-2897
 EMAIL: info@softsurfaces.com

SoftTile Contained by Curb with Ledge

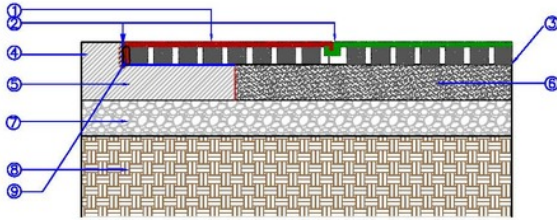

LEGEND:

- ① SoftTile® (See Specifications for Depth and Color).
- ② 1/2" Diameter Continuous Bead of SoftTile® Adhesive at Each KrosLOCK Joint.
- ③ 1.0% Slope - 1/8" / 12" (3mm / 300mm).
- ④ Containing Sidewalk
- ⑤ Concrete Ledge
- ⑥ Asphalt Sub Surface
- ⑦ Compacted Aggregate
- ⑧ Compacted Subgrade
- ⑨ Expansion Foam (polyurethane-based) - Great Stuff Window and Door or Equal.

NOTES:

1. Consult with a local Civil Engineer to find out what drainage system is best for your application.
2. Ensure subsoil drains towards drainage system.
3. Review Most Recent Installation Manual and Sub Surface Guide

SoftTile Thickness	Critical Fall Height (Ft)	FILE NAME	SoftTile Contained by Curb with Ledge	PREPARED BY	B. GOSS
2.00"	3'	REV	DESCRIPTION	DATE	
2.25"	4'	0	ORIGINAL ISSUE	8/9/12	
2.75"	5'	1	Updated	9/12/13	
3.25"	6'				
3.75"	7'				
4.25"	8'				
4.75"	9'				
5.00"	10'	SIZE	SCALE	DWG NO.	REV
5.75"	12'	A	N/A	2012-032	1



P.O. BOX 239, 4393 DISCOVERY LINE
 PETROLIA, ONTARIO
 NON 1R0
 PHONE: (800) 263-2363
 PHONE: (519) 882-8799
 FAX: (519) 882-2897
 EMAIL: info@softsurfaces.com

SoftTile Transitioning into Loose Fill-Corner

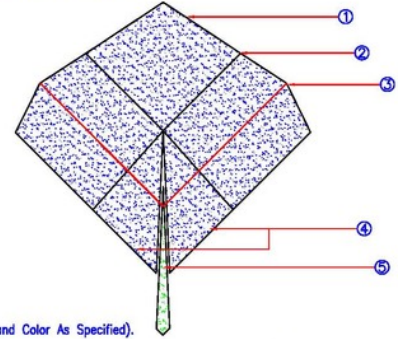

LEGEND:

- ① SoftTile (Thickness and Color As Specified).
- ② 1/2" Diameter Continuous Bead of SoftTile Adhesive at Each KrosLOCK Joint.
- ③ Start of 30 Degree Slope of Concrete Base into Loose Fill Material.
- ④ SoftTile Diagonally Trimmed to Conform To Concrete Base.
- ⑤ Section of SoftTile Material Will be Cut to Fill Gap Between the Sliced SoftTile Corner Pieces.

NOTES:

Apply SoftTile® Adhesive to Entire Base Surface Prior to Installing Tiles With a 3/8 Notched Trowel.

Tiles to be Secured with Weight at Transition Until Adhesive Cures - Min. 24Hrs.

SoftTile Thickness	Critical Fall Height (Ft)	FILE NAME	Corner Transition to Loose Fill	PREPARED BY	B. GOSS
2.00"	3'	REV	DESCRIPTION	DATE	
2.25"	4'	0	ORIGINAL ISSUE	12/22/11	
2.75"	5'	1	Updated	9/12/13	
3.25"	6'				
3.75"	7'				
4.25"	8'				
4.75"	9'				
5.00"	10'	SIZE	SCALE	DWG NO.	REV
5.75"	12'	A	N/A	2012-030	1



P.O. BOX 239, 4393 DISCOVERY LINE
 PETROLIA, ONTARIO
 NON 1R0
 PHONE: (800) 263-2363
 PHONE: (519) 882-8799
 FAX: (519) 882-2897
 EMAIL: info@softsurfaces.com

Buried Curb Retainer

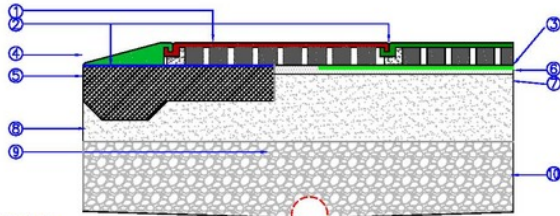

LEGEND:

- ① SoftTile® (See Specifications for Depth and Color).
- ② 1/2" Diameter Continuous Bead of SoftTile® Adhesive at Each KrosLOCK Joint, full width under ramp and 12" of perimeter tile to base.
- ③ 1.0% Slope - 1/8" / 12" (3mm / 300mm).
- ④ SofRRAMP Jr. Adhered down to Containing Curb as well as to the Adjacent SoftTile.
- ⑤ Concrete Under Ramp and 12" Minimum Under Tiles- ramp dimension determines width (see SofRRAMP Detail)
- ⑥ Rubber Sheetting to Slope 4" from Curb to Allow Drainage into Granular Base.
- ⑦ Minimum 1" Deep Fine Crushed Granular Screenings (As Required) to Achieve a Max 1/4" (6mm) Variation in Grade When Measured With a 10' (3m) Straight Edge in any Direction.
- ⑧ Compacted Granular A (Type I) Base To 95% S.P.D. (See Specifications for Depth).
- ⑨ 4" (100mm) Perforated Plastic or PVC Drain Tile at 16" (4.5m) On Center. **see Notes
- ⑩ Compacted Granular Sub-Base.

NOTES:

1. Consult with a local Civil Engineer to find out what drainage system is best for your application. ***
2. Ensure subsoil drains towards drainage system 2%
3. Review Most Recent Installation Manual and Sub Surface Guide

SoftTile Thickness	Critical Fall Height (Ft)	FILE NAME	Buried Curb Retainer	PREPARED BY	B. GOSS
2.00"	3'	REV	DESCRIPTION	DATE	
2.25"	4'	0	ORIGINAL ISSUE	11/15/11	
2.75"	5'	1	Updated	9/12/13	
3.25"	6'				
3.75"	7'				
4.25"	8'				
4.75"	9'				
5.00"	10'	SIZE	SCALE	DWG NO.	REV
5.75"	12'	A	N/A	2012-027	1



P.O. BOX 239, 4393 DISCOVERY LINE
 PETROLIA, ONTARIO
 NON 1R0
 PHONE: (800) 263-2363
 PHONE: (519) 882-8799
 FAX: (519) 882-2897
 EMAIL: info@softsurfaces.com

Multiple Fall Height

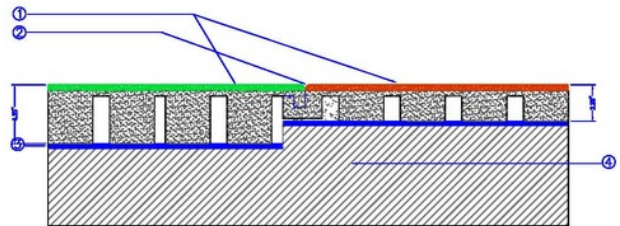

Not to Scale

LEGEND:

- ① SoftTile® (See Specifications for Depth and Color).
- ② 1/4" Diameter Continuous Bead of SoftTile Adhesive at Each KrosLOCK Joint.
- ③ Boast Adhesive Under both Thicknesses of SoftTILES.
- ④ Concrete Sub Base. Thickness should be discussed with local Civil Engineer.

SoftTile Thickness	Critical Fall Height (Ft)	FILE NAME	Multiple Fall Heights	PREPARED BY	B. GOSS
2.00"	3'	REV	DESCRIPTION	DATE	
2.25"	4'	0	ORIGINAL ISSUE	11/15/11	
2.75"	5'	1	Updated	9/12/13	
3.25"	6'				
3.75"	7'				
4.25"	8'				
4.75"	9'				
5.00"	10'	SIZE	SCALE	DWG NO.	REV
5.75"	12'	A	N/A	2012-028	1



P.O. BOX 239, 4393 DISCOVERY LINE
 PETROLIA, ONTARIO
 NON 1R0
 PHONE: (800) 263-2363
 PHONE: (519) 882-8799
 FAX: (519) 882-2897
 EMAIL: info@softsurfaces.com

Post Cuts

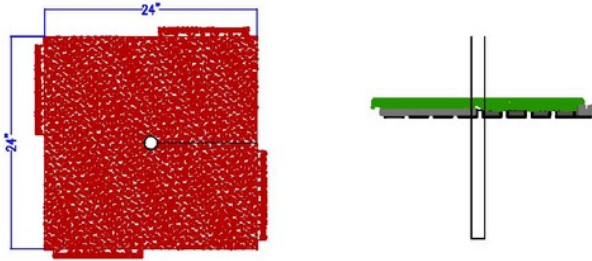

TIPS

- A cut into the side of the tile must be made before the circular post cut. When doing so, always cut the side of the tile that represents the shortest distance from the tile edge, or place the cut where it will be hidden by equipment. When possible, the cut should be made between pedestals which may result in a cut that is slightly off center, but provides structural stability.
- Since SoftILE is flexible, always make the hole cut slightly smaller ($\frac{1}{8}$ ") than required to allow for a very tight fit.
- Making the posts cut on a backward 15-20 degree angle where it meets the surface, allows for a tight neat appearance and provides some additional flexibility.
- Hole cuts must be made using a template and jigsaw. A hole saw can also be used to cut holes through tiles, although the back angle cut of a jigsaw allows for a tighter cut.

*** See Installation Manual For More Details.

SoftILE Thickness	Critical Fall Height (FT)	FILE NAME	Post Cuts	PREPARED BY	B. GOSS
2.00"	3'	REV	DESCRIPTION	DATE	
2.25"	4'	0	ORIGINAL ISSUE	11/15/11	
2.75"	5'	1	Updated	9/12/13	
3.25"	6'				
3.75"	7'				
4.25"	8'				
4.75"	9'				
5.00"	10'	SIZE	SCALE	DWG NO.	REV
5.75"	12'	A	N/A	2012-029	1



P.O. BOX 239, 4393 DISCOVERY LINE
 PETROLIA, ONTARIO
 NON 1R0
 PHONE: (800) 263-2363
 PHONE: (519) 882-8799
 FAX: (519) 882-2897
 EMAIL: info@softsurfaces.com

SoftILE KrosLOCK Cross Section DuraSafe

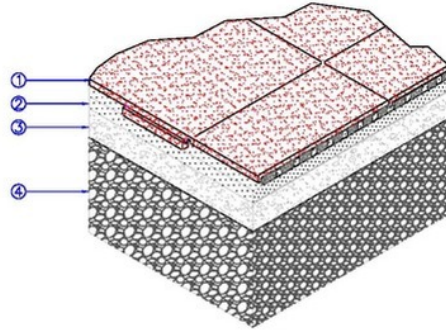

LEGEND:

- ① SoftILE® (See Specifications for Depth and Color).
- ② Concrete/Asphalt Depth and Strength to Specifications
- ③ Compacted Granular A (Type I) To 95% S.P.D. (See Specifications for Depth).
- ④ Compacted Subgrade.

SoftILE Thickness	Critical Fall Height (FT)	FILE NAME	Cross Section	PREPARED BY	B. GOSS
2.00"	3'	REV	DESCRIPTION	DATE	
2.25"	4'	0	ORIGINAL ISSUE	11/15/11	
2.75"	5'	1	Additional Thicknesses Added	6/19/13	
3.25"	6'				
3.75"	7'				
4.25"	8'				
4.75"	9'				
5.00"	10'	SIZE	SCALE	DWG NO.	REV
5.75"	12'	A	N/A	2012-018	1



P.O. BOX 239, 4393 DISCOVERY LINE
 PETROLIA, ONTARIO
 NON 1R0
 PHONE: (800) 263-2363
 PHONE: (519) 882-8799
 FAX: (519) 882-2897
 EMAIL: info@softsurfaces.com

SofRAMP ADA

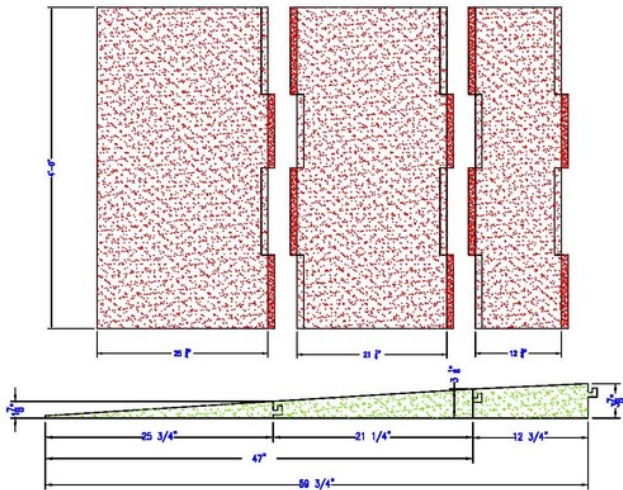

ADA Side View

SoftILE Fall Height	Height (ft)	Depth (ft)	Ratio of Slope	FILE NAME	SofRAMP ADA	PREPARED BY	B. GOSS
0'	1.25"	16.00"	1:13	REV	DESCRIPTION	DATE	
3'	2.00"	25.75"	1:13	0	ORIGINAL ISSUE	11/15/11	
4'	2.25"	32.00"	1:14	1	REVISED	6/19/13	
5'	2.75"	40.00"	1:14				
6'	3.25"	47.00"	1:14				
7'	3.75"	59.75"	1:16				
8'	4.25"	59.75"	1:14				
$\geq 8'$	a different means of access will need to be sourced.			SIZE	SCALE	DWG NO.	REV
				A	N/A	2013-015	1



P.O. BOX 239, 4393 DISCOVERY LINE
 PETROLIA, ONTARIO
 NON 1R0
 PHONE: (800) 263-2363
 PHONE: (519) 882-8799
 FAX: (519) 882-2897
 EMAIL: info@softsurfaces.com

SofRAMP ADA - Inset

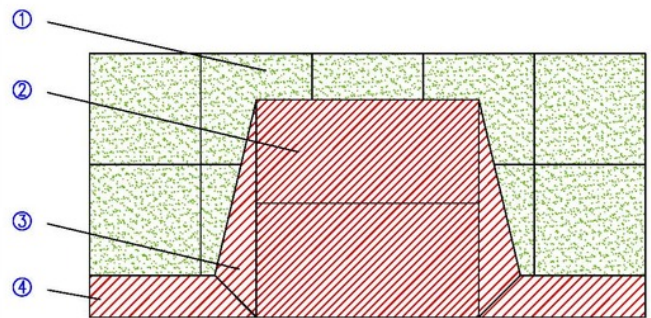

LEGEND:

- ① SoftILE (See Specification for Thickness and Color).
- ② SofRAMPS ADA - 2 piece (Dictated by SoftILE Thickness).
- ③ Modified SofRAMP to Fit Angle as Well as Mitre Into SofRAMP Jr.
- ④ SofRAMP Jr.

SoftILE Fall Height	Height (ft)	Depth (ft)	Ratio of Slope	FILE NAME	SofRAMP ADA Inset	PREPARED BY	B. GOSS
0'	1.25"	16.00"	1:13	REV	DESCRIPTION	DATE	
3'	2.00"	25.75"	1:13	0	ORIGINAL ISSUE	11/15/11	
4'	2.25"	32.00"	1:14	1	Thicknesses Adjusted	6/19/13	
5'	2.75"	40.00"	1:14				
6'	3.25"	47.00"	1:14				
7'	3.75"	59.75"	1:16				
8'	4.25"	59.75"	1:13				
$\geq 8'$	a different means of access will need to be sourced.			SIZE	SCALE	DWG NO.	REV
				A	N/A	2013-016	1