

Air Pump Kit

P/N QRJ04-PK

Installation Instructions

1. **Make sure jack is unloaded and there is no pressure in hydraulic system.**
2. **Make sure the jack is supported and release all hydraulic pressure from system. Remove existing Hydraulic hose from cylinder and unbolt/remove the hand pump and hose from jack.**
3. **Position the FRL Bracket & Air-Pump for hand drilling of the rolling jack pump plate. Ref Fig 1 for approx layout.**
4. **Using the FRL bracket and Air-Pump as templates, Drill (6) mounting holes in the pump plate.**
5. **Install push-loc elbow onto FRL outlet port and Install a ¼ NPT male quick disconnect coupling in air inlet of FRL. (Match to shop fittings), Mount FRL onto FRL bracket as shown.**
6. **Install elbow onto Air-Pump Hyd outlet port and mount pump onto the jack pump plate using the provided hardware.**
7. **Mount the FRL to pump plate using provided hardware**
8. **Install provided Hyd Hose from Air-Pump to cylinder.**
9. **Install 10mm airline from FRL outlet port elbow and connect to the Air-Pump inlet**
10. **Check hydraulic pump fluid level. When jack is completely lowered remove breather plug and check oil level. Oil should be at top of filler plug hole.**
11. **Inspect air/hydraulic system for leaks. Max regulated Air operating pressure to Air-Pump not to exceed 120psi.**

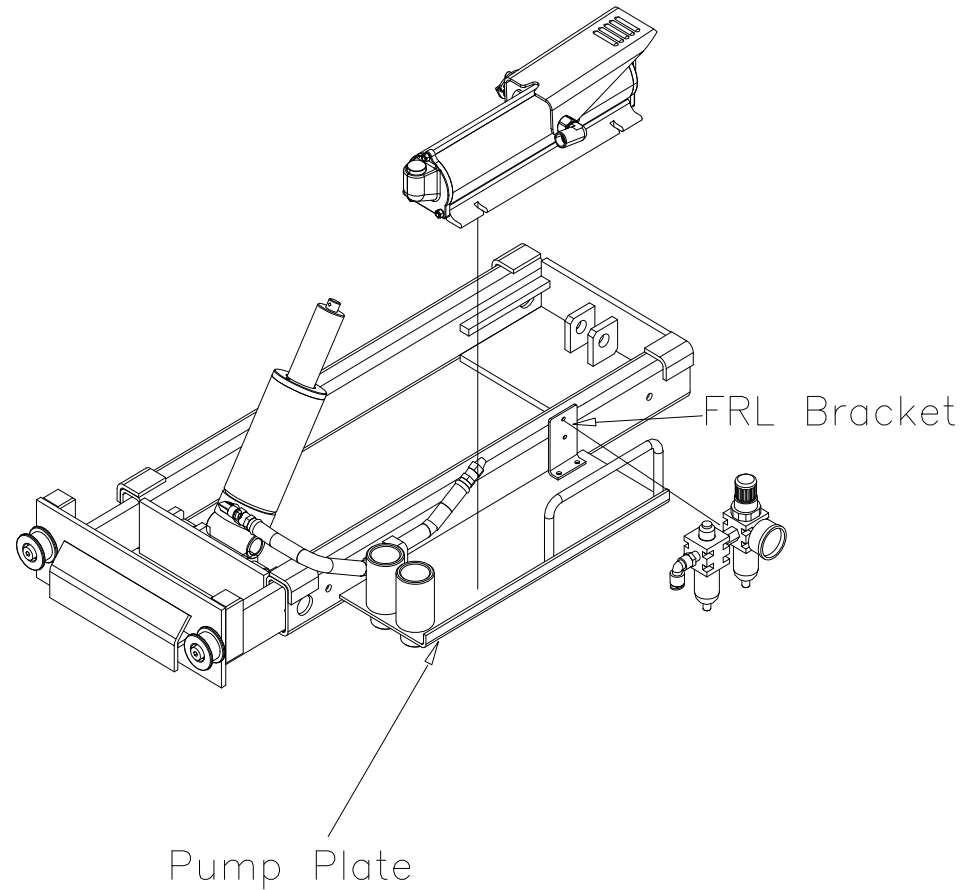

FILTER/REGULATOR/LUBRICATOR ASSEMBLY SPECIFICATIONS

MAXIMUM INLET PRESSURE: 140 psi
MAXIMUM OUTLET PRESSURE: 120 psi

