

SECTION III

**HIP AND ALUMINUM THRUST
BEARING JOINTS**

1000 SERIES

2000 SERIES

**ALUMINUM THRUST
BEARING JOINTS**

**HIP AND ALUMINUM
THRUST BEARING JOINTS**

BECKER HIP JOINT SYSTEM

Below you will find all material and size specifications for Becker hip joints. Please refer to the charts below for specifications on our hip joints, or call one of our customer service representatives with any additional questions you may have. This page is provided as a tool for orthotists in choosing the most appropriate hip joint for their patient's needs.

Material Specifications

Product	Material
1000 Series Midsections	410 Hardened Stainless Steel
2000 Series Midsections*	304-2B Stainless Steel 1/4 Temper
Aluminum Uprights	2024 T4 Aluminum
Stainless Steel Uprights	304-2B Stainless Steel 1/4 Temper
Titanium Uprights**	6-4 Titanium

*Does not apply to models 2040, 2041, 2045, or 2050

**Only available straight in 3/16" x 3/4" dimension

Upright Conversions

Inches	Millimeters
1/8"	3mm
5/32"	4mm
3/16"	5mm
1/4"	6mm
5/16"	8mm
3/8"	9.5mm
1/2"	13mm
5/8"	16mm
3/4"	19mm
1"	25mm
1-1/4"	32mm

HIP JOINTS			
	A SIZE	B SIZE	C SIZE
Designed For	*Adults 120#	*Youths 50-120#	*Children 30-50#
Bar Width	3/4"	5/8"	1/2"
Bar Thickness	1/4", 3/16"	1/4", 3/16"	3/16", 1/8"
Bushing Hole Diameter	3/8"	3/8"	5/16"
Upright Attachment Holes	3/16" or #12 Drill	5/32 or #22 Drill	1/8 or #30 Drill
Upright Attachment Rivet	RVT-A	RVT-BL/RVT-BS	RVT-C

* Discretion in choosing a joint size and designing an appropriate orthosis should be used by the orthotist in all cases.

1000 SERIES									
Model No.	Midsection Length			Proximal Upright Length (from KC)			Distal Upright Length (from KC)		
	A Size	B Size	C Size	A Size	B Size	C Size	A Size	B Size	C Size
1020	3-3/8"	3-1/8"	2-3/8"	5-1/8"	4-1/2"	3-5/8"	9-5/8"	8-5/8"	7-1/2"
S1020	3-3/8"	3-1/8"	2-3/8"	8-7/8"	7-3/4"	6-5/8"	9-5/8"	8-5/8"	7-1/2"
1022*	3-1/2"	2-7/8"	2-1/2"	4-7/8"	4-3/8"	3-1/2"	9-3/4"	8-3/4"	7-5/8"
S1022	3-1/2"	2-7/8"	2-1/2"	8-5/8"	7-5/8"	6-1/2"	9-7/8"	8-3/4"	7-5/8"
1023	3-5/8"	3-1/8"	~	5-1/4"	4-5/8"	~	9-5/8"	8-5/8"	~
S1023	3-5/8"	3-1/8"	~	9"	7-7/8"	~	9-5/8"	8-5/8"	~
1025	3-1/4"	2-3/4"	2-1/4"	4-7/8"	4-3/8"	3-3/8"	9-5/8"	8-5/8"	7-1/2"
S1025	3-1/4"	2-3/4"	2-1/4"	8-5/8"	7-5/8"	6-3/8"	9-5/8"	8-5/8"	7-1/2"
1026	3-5/8"	3-1/2"	3-3/8"	5-1/8"	4-1/2"	3-5/8"	10-1/8"	9-1/8"	8-3/8"
S1026	3-5/8"	3-1/2"	3-3/8"	8-7/8"	7-3/4"	6-5/8"	10-1/8"	9-1/8"	8-3/8"
1030	~	4-1/8"	~	~	5-3/4"	~	~	9"	~
S1030	~	4-1/8"	~	~	9"	~	~	9"	~
1031	~	4-1/8"	4-1/8"	~	6-3/4"	~	~	8-5/8"	6"
1040	~	4-1/8"	~	~	6-3/4"	~	~	8-7/8"	~

* 1022-I (Infant) size joints have a midsection length of 1-5/8" and a proximal and distal upright length of 6-1/2".

BECKER HIP JOINT SYSTEM CONTINUED

2000 SERIES									
Model No.	Midsection Length			Proximal Upright Length (from KC)			Distal Upright Length (from KC)		
	A Size	B Size	C Size	A Size	B Size	C Size	A Size	B Size	C Size
2020	2-3/8"	2"	1-3/4"	10-1/4"	10-1/8"	10-1/8"	10"	10"	10"
2025	2-3/8"	2"	1-3/4"	10-1/4"	10-1/8"	10-1/8"	10"	10"	10"
2032	2-3/8"	2"	1-3/4"	4-3/4"	4-3/4"	4-5/8"	4"	4"	4"
2040	~	2"	1-3/4"	~	6-3/4"	5"	~	8-5/8"	7-1/8"
2041	~	2"	1-3/4"	~	6-3/4"	5"	~	8-7/8"	7"
2045	~	2"	1-3/4"	~	6-3/4"	5"	~	8-1/4"	6-7/8"
2050	~	7/8"	~	~	3-1/4"	~	~	3"	~

ALUMINUM THRUST BEARING SERIES			
	A SIZE	B SIZE	C SIZE
Designed For:	*Adults 120#	*Youths 50-120#	*Children 30-50#
Bar Width	1 1/4"	1"	3/4"
Bar Thickness	1/4"	1/4"	1/4"
Bushing Hole Diameter	1/2"	1/2"	1/2"

* Discretion in choosing a joint size and designing an appropriate orthosis should be used by the orthotist in all cases.

Model No.	Midsection Length			Proximal Upright Length (from KC)			Distal Upright Length (from KC)		
	A Size	B Size	C Size	A Size	B Size	C Size	A Size	B Size	C Size
1055	1-1/4"	1-1/4"	1-1/4"	14"	12-1/4"	12-1/4"	17"	17"	12-1/4"
1065	2"	2"	2"	14"	12-1/4"	12-1/4"	17"	17"	12-1/8"
1075	3-5/8"	3-5/8"	3-1/2"	14"	12-1/4"	12"	18-1/2"	18-1/2"	13-5/8"
1085	5-1/2"	5-1/2"	3-5/8"	4-3/4"	4-3/4"	3"	13"	10"	8-1/4"
1090	6-3/8"	6-3/8"	4-1/4"	4-3/4"	4-3/4"	3"	13"	10"	8-1/4"
1095	6-3/8"	6-3/8"	4-1/4"	4-3/4"	4-3/4"	3"	13"	10"	8-1/4"
1096	3-5/8"	3-5/8"	3-1/2"	4-3/4"	4-3/4"	3"	15-1/2"	13-3/4"	13-5/8"

SECTION III

**HIP AND ALUMINUM THRUST
BEARING JOINTS**

**1000 SERIES
2000 SERIES
ALUMINUM THRUST
BEARING JOINTS**



MODEL 1020 RING LOCK HIP JOINT

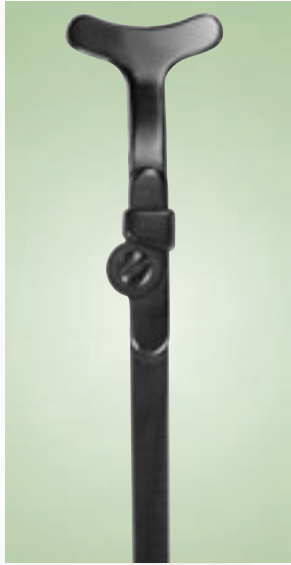

Model 1020 is the strongest locking hip joint we manufacture. It is recommended for large or extremely active patients. All midsections and uprights are made of stainless steel.

Order No.	Joint Size	Upright Dimensions	Side
1020-AL	A	3/16" x 3/4"	Left
1020-AR	A	3/16" x 3/4"	Right
1020-AP	A	3/16" x 3/4"	Pair
1020-BL	B	3/16" x 5/8"	Left
1020-BR	B	3/16" x 5/8"	Right
1020-BP	B	3/16" x 5/8"	Pair
1020-CL	C	3/16" x 1/2"	Left
1020-CR	C	3/16" x 1/2"	Right
1020-CP	C	3/16" x 1/2"	Pair

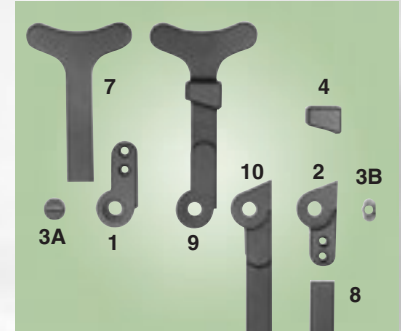

Model 1020 is also available with a straight proximal upright, instead of a "T" bar. To order, please add "S" to the beginning of the order number.

To order parts, please specify the order number, followed by the part number you desire.

- Shipped fully assembled
- Do not remove rings

MODEL 1022 MODIFIED RING LOCK HIP JOINT



Model 1022 has no protrusions to catch or fray garments when the patient is in the seated position. All midsections and uprights are made of stainless steel.

Order No.	Joint Size	Upright Dimensions	Side
1022-AL	A	3/16" x 3/4"	Left
1022-AR	A	3/16" x 3/4"	Right
1022-AP	A	3/16" x 3/4"	Pair
1022-BL	B	3/16" x 5/8"	Left
1022-BR	B	3/16" x 5/8"	Right
1022-BP	B	3/16" x 5/8"	Pair
1022-CL	C	3/16" x 1/2"	Left
1022-CR	C	3/16" x 1/2"	Right
1022-CP	C	3/16" x 1/2"	Pair



Model 1022 is also available with a straight proximal upright, instead of a "T" bar. To order, please add "S" to the beginning of the order number.

To order parts, please specify the order number, followed by the part number you desire.

- Shipped fully assembled
- Do not remove rings

MODEL 980 QUICK DISCONNECT™

Our Quick Disconnect™ allows you to build an orthosis with an easy method of disconnecting the KAFO from the hip module.

US Patent 6,129,689

NOTE: For ordering information, please see page 3.2.7.

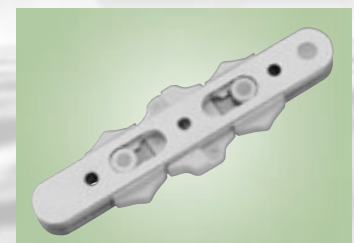

MODEL 1022-I INFANT MODIFIED RING LOCK HIP JOINT

Model 1022-I has been specially designed with very small midsections for use as an infant hip joint. The proximal and distal uprights are stainless steel.

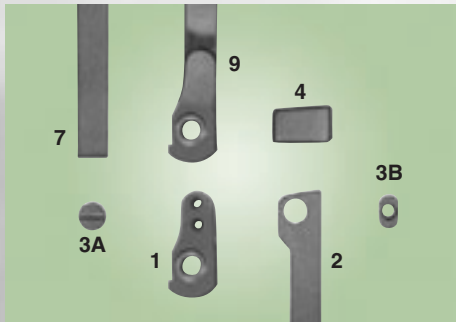

Order No.	Upright Dimensions	Side
1022-I8L	1/8" x 1/2"	Left
1022-I8R	1/8" x 1/2"	Right
1022-I8P	1/8" x 1/2"	Pair

To order parts, please specify the order number, followed by the part number you desire.



- Shipped fully assembled
- Do not remove rings

MODEL 1022-II INFANT MODIFIED RING LOCK HIP JOINT

Model 1022-II has an even shorter midsection length than model 1022-I. The proximal and distal uprights are made of stainless steel. The proximal joint unit is both riveted and welded to the proximal upright for added strength. Due to the decreased midsection length, the installation of ball catches is not available on these joints.

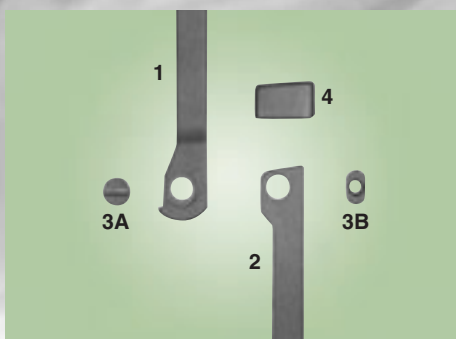

Order No.	Upright Dimensions	Side
1022-II8L	1/8" x 1/2"	Left
1022-II8R	1/8" x 1/2"	Right
1022-II8P	1/8" x 1/2"	Pair

To order parts, please specify the order number, followed by the part number you desire.

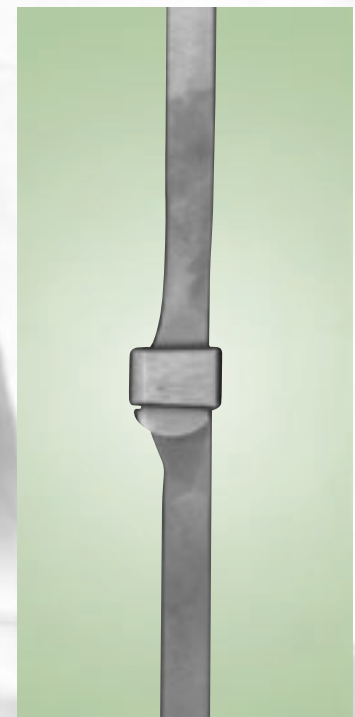

- Shipped fully assembled
- Do not remove rings

MODEL 1023 TRIGGER LOCK HIP JOINT



Model 1023 incorporates a lever mechanism which automatically engages the lock when the patient stands. All midsections and uprights are made of stainless steel.

Order No.	Joint Size	Upright Dimensions	Side
1023-AL	A	3/16" x 3/4"	Left
1023-AR	A	3/16" x 3/4"	Right
1023-AP	A	3/16" x 3/4"	Pair
1023-BL	B	3/16" x 5/8"	Left
1023-BR	B	3/16" x 5/8"	Right
1023-BP	B	3/16" x 5/8"	Pair

Model 1023 is also available with a straight proximal upright, instead of a "T" bar. To order, please add "S" to the beginning of the order number.

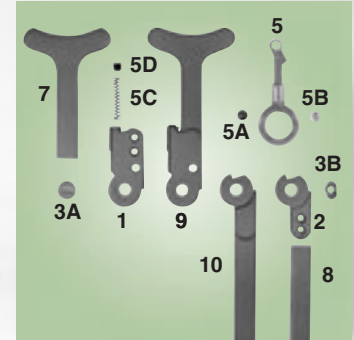

To order parts, please specify the order number, followed by the part number you desire.

• Shipped fully assembled

MODEL 1025 FREE MOTION HIP JOINT



Model 1025 is a free motion hip joint with a 180° extension stop. All midsections and uprights are made of stainless steel.

Order No.	Joint Size	Upright Dimensions	Side
1025-AL	A	3/16" x 3/4"	Left
1025-AR	A	3/16" x 3/4"	Right
1025-AP	A	3/16" x 3/4"	Pair
1025-BL	B	3/16" x 5/8"	Left
1025-BR	B	3/16" x 5/8"	Right
1025-BP	B	3/16" x 5/8"	Pair
1025-CL	C	3/16" x 1/2"	Left
1025-CR	C	3/16" x 1/2"	Right
1025-CP	C	3/16" x 1/2"	Pair

Model 1025 is also available with a straight proximal upright, instead of a "T" bar. To order, please add "S" to the beginning of the order number.

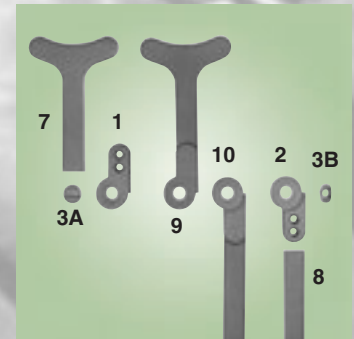

To order parts, please specify the order number, followed by the part number you desire.

• Shipped fully assembled

MODEL 980 QUICK DISCONNECT™

Our Quick Disconnect™ allows you to build an orthosis with an easy method of disconnecting the KAFO from the hip module.

US Patent 6,129,689

NOTE: For ordering information, please see page 3.2.7.

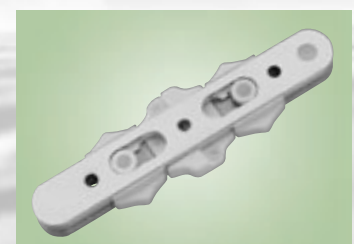

MODEL 1026 ADJUSTABLE FLEXION RING LOCK HIP JOINT

By using a serrated disc, the orthotist may increase or decrease the hip flexion angle by 6° intervals. All midsections and uprights are made of stainless steel.

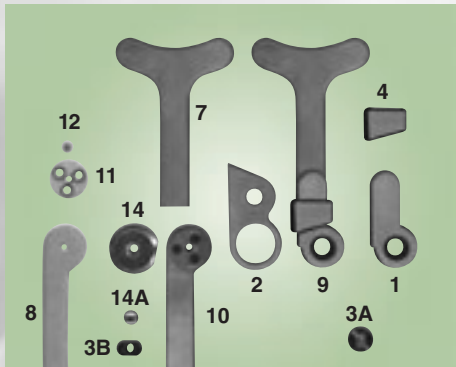

Order No.	Joint Size	Upright Dimensions	Side
1026-AL	A	3/16" x 3/4"	Left
1026-AR	A	3/16" x 3/4"	Right
1026-AP	A	3/16" x 3/4"	Pair
1026-BL	B	3/16" x 5/8"	Left
1026-BR	B	3/16" x 5/8"	Right
1026-BP	B	3/16" x 5/8"	Pair
1026-CL	C	3/16" x 1/2"	Left
1026-CR	C	3/16" x 1/2"	Right
1026-CP	C	3/16" x 1/2"	Pair

To order parts, please specify the order number, followed by the part number you desire.

Model 1026 is also available with a straight proximal upright, instead of a "T" bar. To order, please add "S" to the beginning of the order number.



- Shipped fully assembled
- Do not remove rings

MODEL 1030 ABDUCTION FLEXION HIP JOINT

Model 1030 is manufactured of stainless steel, making it one of the strongest hip joints available.

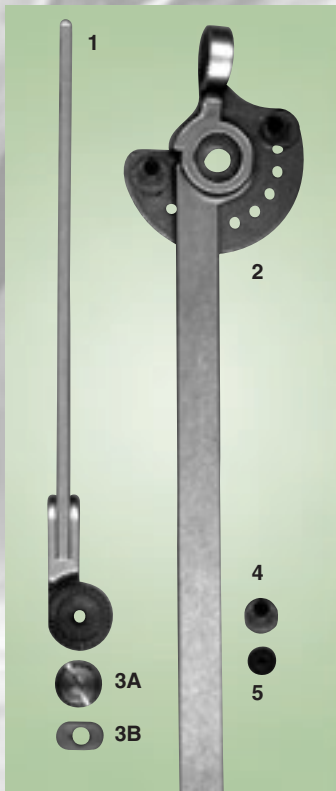

Order No.	Upright Dimensions	Side
1030-BL	3/16" x 5/8"	Left
1030-BR	3/16" x 5/8"	Right
1030-BP	3/16" x 5/8"	Pair

Model 1030 is also available with a straight proximal bar which is ideal for attaching a spinal orthosis. To order, please add "S" to the beginning of the order number.

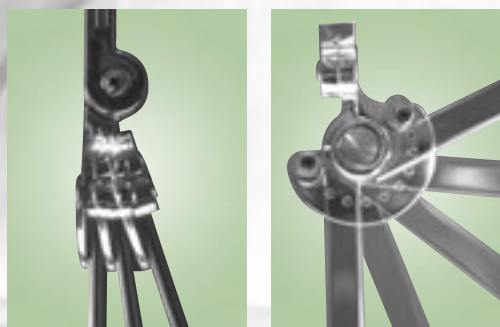

- Abduction adjustable in 9° increments
- Cam stops provide infinite ROM



- Shipped fully assembled

To order parts, please specify the order number, followed by the part number you desire.

MODELS 1040 AND 1041 MILLENNIUM HIP JOINT

The Millennium Hip Joint is offered in two configurations. Both models feature stainless steel midsections and aluminum uprights. Model 1040 has slotted uprights. Model 1041 has drilled and tapped #10-32 attachment holes for use with our Quick Disconnect™ System.

US Patent 6,203,511



1040

- Shipped fully assembled



1041

- Shipped fully assembled
- Tapped holes in proximal bar are #10-32

- Can be used on the left and right sides
- Range-of-Motion from 0° - 120° Flexion/Extension
- Flexion/Extension adjustable in 10° increments
- Abduction/Adduction adjustable in 9° increments

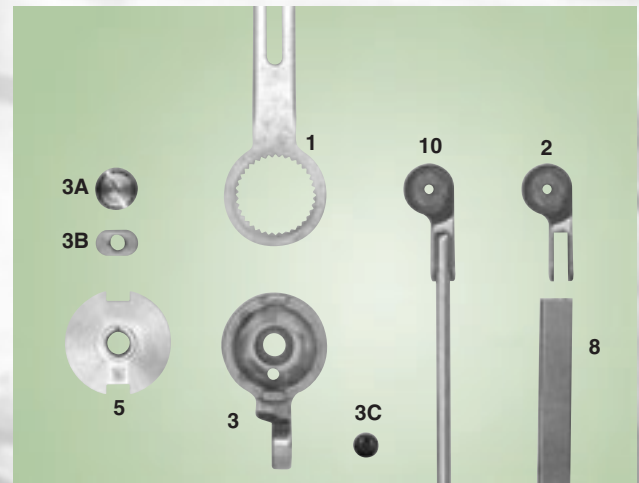

To order parts, please specify the order number, followed by the part number you desire.

Order No.	Joint Size	Uprights	Upright Dimensions
1040-B	A/B	Slotted	1/4" x 3/4"
1041-B	A/B	Tapped/Slotted	1/4" x 3/4"

MODEL 980 QUICK DISCONNECT™

Our Quick Disconnect™ allows you to build an orthosis with an easy method of disconnecting the KAFO from the hip module.

US Patent 6,129,689

NOTE: For ordering information, please see page 3.2.7.

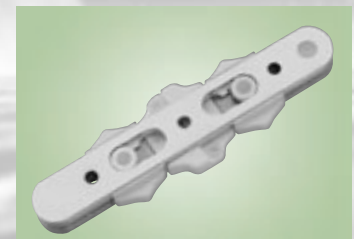

SECTION III

**HIP AND ALUMINUM THRUST
BEARING JOINTS**

1000 SERIES

2000 SERIES

**ALUMINUM THRUST
BEARING JOINTS**



2000 SERIES

2000 SERIES HIP JOINTS

The 2000 series was added to our product line to create a cost-effective, reliable hip joint. Stainless steel side plates are riveted onto the proximal upright to form the upper joint unit. The distal bar is machined to fit into the upper joint unit. The absence of a lower joint unit allows the orthotist to make a rapid medial contour.

MODEL 2020 ALUMINUM RING LOCK HIP JOINT

Model 2020 is our standard ring lock hip joint. The proximal and distal uprights can be made of aluminum or stainless steel. **Note: Nylatron washers are only required on models with aluminum uprights.**



- Shipped fully assembled
- Do not remove rings

MODEL 2020 WITH ROUND EDGE ALUMINUM UPRIGHTS

Order No.	Joint Size	Upright Dimensions	Side
2020-A4L	A	1/4" x 3/4"	Left
2020-A4R	A	1/4" x 3/4"	Right
2020-A4P	A	1/4" x 3/4"	Pair
2020-B4L	B	1/4" x 5/8"	Left
2020-B4R	B	1/4" x 5/8"	Right
2020-B4P	B	1/4" x 5/8"	Pair
2020-C6L	C	3/16" x 1/2"	Left
2020-C6R	C	3/16" x 1/2"	Right
2020-C6P	C	3/16" x 1/2"	Pair
2020-C8L	C	1/8" x 1/2"	Left
2020-C8R	C	1/8" x 1/2"	Right
2020-C8P	C	1/8" x 1/2"	Pair

MODEL 2020 WITH ROUND EDGE STAINLESS STEEL UPRIGHTS

Order No.	Joint Size	Upright Dimensions	Side
2020-A6SL	A	3/16" x 3/4"	Left
2020-A6SR	A	3/16" x 3/4"	Right
2020-A6SP	A	3/16" x 3/4"	Pair
2020-B6SL	B	3/16" x 5/8"	Left
2020-B6SR	B	3/16" x 5/8"	Right
2020-B6SP	B	3/16" x 5/8"	Pair
2020-C6SL	C	3/16" x 1/2"	Left
2020-C6SR	C	3/16" x 1/2"	Right
2020-C6SP	C	3/16" x 1/2"	Pair
2020-C8SL	C	1/8" x 1/2"	Left
2020-C8SR	C	1/8" x 1/2"	Right
2020-C8SP	C	1/8" x 1/2"	Pair

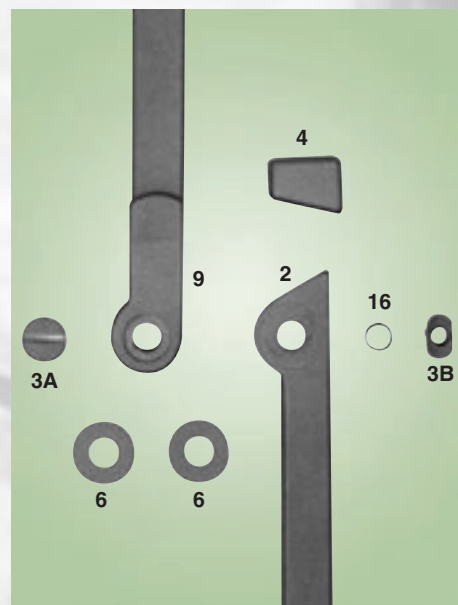

To order parts, please specify the order number, followed by the part number you desire.

MODEL 980 QUICK DISCONNECT™

Our Quick Disconnect™ allows you to build an orthosis with an easy method of disconnecting the KAFO from the hip module.

US Patent 6,129,689

NOTE: For ordering information, please see page 3.2.7.

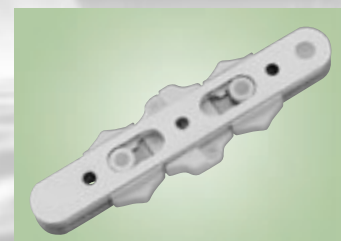

MODEL 2025

ALUMINUM FREE MOTION HIP JOINT

Model 2025 is a free motion hip joint with a 180° extension stop. **Note: Nylatron washers are only required on models with aluminum uprights.**

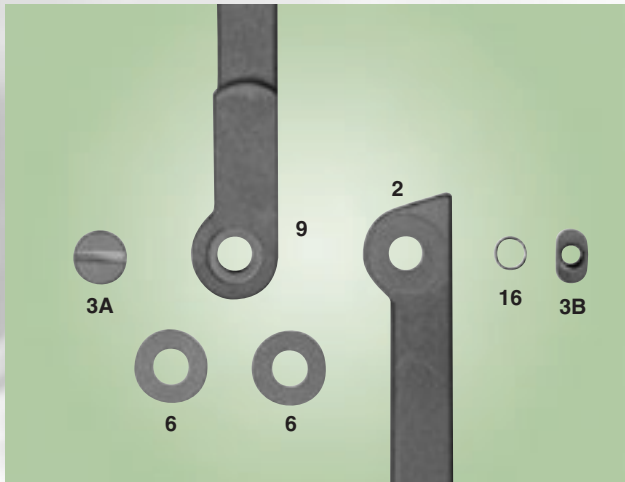

To order parts, please specify the order number, followed by the part number you desire.

MODEL 2025 WITH ROUND EDGE ALUMINUM UPRIGHTS

Order No.	Joint Size	Upright Dimensions	Side
2025-A4L	A	1/4" x 3/4"	Left
2025-A4R	A	1/4" x 3/4"	Right
2025-A4P	A	1/4" x 3/4"	Pair
2025-B4L	B	1/4" x 5/8"	Left
2025-B4R	B	1/4" x 5/8"	Right
2025-B4P	B	1/4" x 5/8"	Pair
2025-C6L	C	3/16" x 1/2"	Left
2025-C6R	C	3/16" x 1/2"	Right
2025-C6P	C	3/16" x 1/2"	Pair
2025-C8L	C	1/8" x 1/2"	Left
2025-C8R	C	1/8" x 1/2"	Right
2025-C8P	C	1/8" x 1/2"	Pair

MODEL 2025 WITH ROUND EDGE STAINLESS STEEL UPRIGHTS

Order No.	Joint Size	Upright Dimensions	Side
2025-A6SL	A	3/16" x 3/4"	Left
2025-A6SR	A	3/16" x 3/4"	Right
2025-A6SP	A	3/16" x 3/4"	Pair
2025-B6SL	B	3/16" x 5/8"	Left
2025-B6SR	B	3/16" x 5/8"	Right
2025-B6SP	B	3/16" x 5/8"	Pair
2025-C6SL	C	3/16" x 1/2"	Left
2025-C6SR	C	3/16" x 1/2"	Right
2025-C6SP	C	3/16" x 1/2"	Pair
2025-C8SL	C	1/8" x 1/2"	Left
2025-C8SR	C	1/8" x 1/2"	Right
2025-C8SP	C	1/8" x 1/2"	Pair

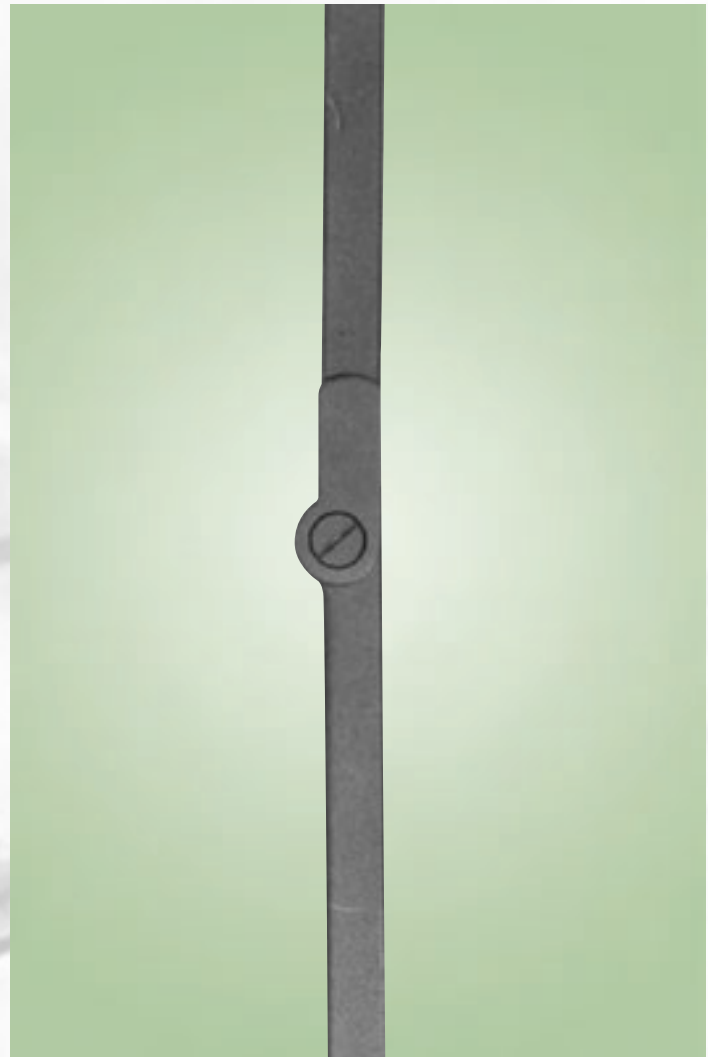

• Shipped fully assembled

MODEL 2032

TWO POSITION RING LOCK HIP JOINT

Model 2032 is designed to lock at 180° and at 90°. The proximal and distal uprights can be made of aluminum or stainless steel. **Note: Nylatron washers are only required on models with aluminum uprights.**

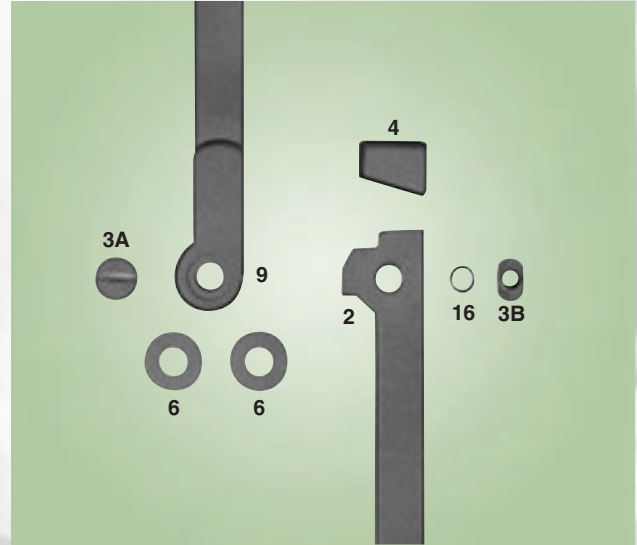
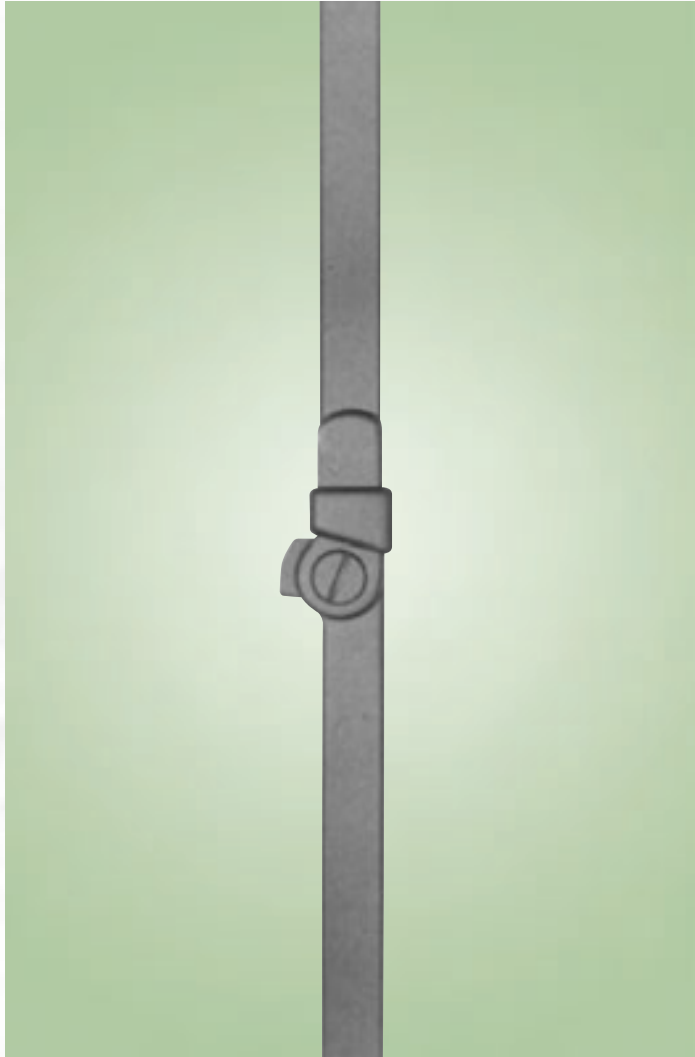

To order parts, please specify the order number, followed by the part number you desire.

MODEL 2032 WITH ROUND EDGE ALUMINUM UPRIGHTS

Order No.	Joint Size	Upright Dimensions	Side
2032-A4L	A	1/4" x 3/4"	Left
2032-A4R	A	1/4" x 3/4"	Right
2032-A4P	A	1/4" x 3/4"	Pair
2032-B4L	B	1/4" x 5/8"	Left
2032-B4R	B	1/4" x 5/8"	Right
2032-B4P	B	1/4" x 5/8"	Pair
2032-C6L	C	3/16" x 1/2"	Left
2032-C6R	C	3/16" x 1/2"	Right
2032-C6P	C	3/16" x 1/2"	Pair

MODEL 2032 WITH ROUND EDGE STAINLESS STEEL UPRIGHTS

Order No.	Joint Size	Upright Dimensions	Side
2032-A6SL	A	3/16" x 3/4"	Left
2032-A6SR	A	3/16" x 3/4"	Right
2032-A6SP	A	3/16" x 3/4"	Pair
2032-B6SL	B	3/16" x 5/8"	Left
2032-B6SR	B	3/16" x 5/8"	Right
2032-B6SP	B	3/16" x 5/8"	Pair
2032-C6SL	C	3/16" x 1/2"	Left
2032-C6SR	C	3/16" x 1/2"	Right
2032-C6SP	C	3/16" x 1/2"	Pair

- Shipped fully assembled
- Do not remove rings

MODEL 2040 ECONOHIP™ JOINT

Model 2040 is a lightweight and economical joint constructed entirely of 2024-T4 aluminum.

- Can be used on the left and right sides
- Flexion/Extension adjustable in 20° increments
- Abduction preset at 15°

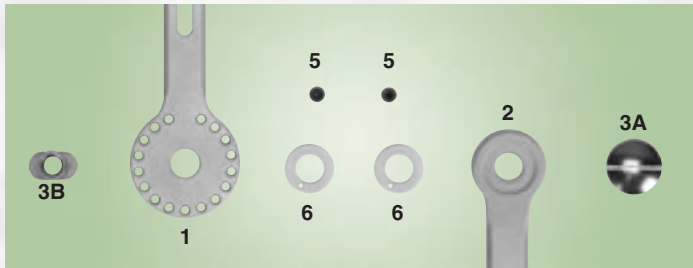

To order parts, please specify the order number, followed by the part number you desire.

Order No.	Joint Size	Upright Dimensions	Abduction Angle
2040-B	A/B	1/4" x 3/4"	Fixed @ 15°
2040-C	C	1/4" x 5/8"	Fixed @ 15°



• Shipped fully assembled

MODEL 2041 ECONOHIP™ JOINT WITH ADJUSTABLE ABDUCTION/ADDUCTION

Model 2041 is the same as model 2040 except that it features a stainless steel midsection which allows the orthotist to adjust the angle of abduction/adduction in 9° increments.

- Can be used on the left and right sides
- Flexion/Extension adjustable in 20° increments
- Abduction/Adduction adjustable in 9° increments

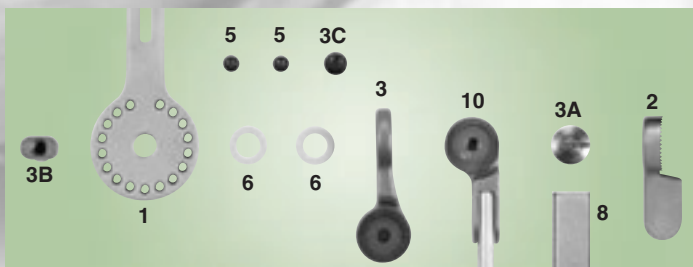

To order parts, please specify the order number, followed by the part number you desire.

Order No.	Joint Size	Side	Upright Dimensions	Abduction/Adduction
2041-BL	A/B	Left	1/4" x 3/4"	Adjustable in 9°
2041-BR	A/B	Right	1/4" x 3/4"	Adjustable in 9°
2041-CL	C	Left	1/4" x 5/8"	Adjustable in 9°
2041-CR	C	Right	1/4" x 5/8"	Adjustable in 9°



• Shipped fully assembled

MODEL 2045 B3 TRIPLE AXIS HIP JOINT

The B3 Triple Axis Hip Joint, model 2045, was developed in collaboration with Boston Brace International to create a hip joint that could provide adjustment and control in the sagittal, coronal, and transverse planes. The joint features a stainless steel midsection with aluminum uprights. Available in both adult and child sizes.



• Shipped fully assembled

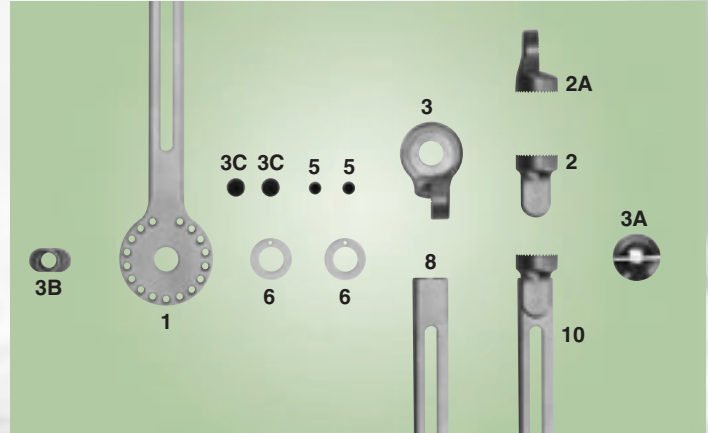

To order parts, please specify the order number, followed by the part number you desire.

Order No.	Side	Upright Dimensions	Joint Size
2045-BL	Left	1/4" x 3/4"	A/B
2045-BR	Right	1/4" x 3/4"	A/B
2045-BP	Pair	1/4" x 3/4"	A/B
2045-CL	Left	1/4" x 5/8"	C
2045-CR	Right	1/4" x 5/8"	C
2045-CP	Pair	1/4" x 5/8"	C

MODEL 2050 SPHERICAL HIP JOINT

This joint is used in our model 160 hip abduction orthosis. It consists of a free moving ball surrounded by a ring with two set screws. Tightening the set screws allows the orthotist to lock the joint in the desired position. This is an extremely versatile joint for any type of static positioning orthosis.

Order No.	Side	Ball Diameter
2050-BL	Left	1/2"
2050-BR	Right	1/2"



• Shipped fully assembled

MODEL 980 QUICK DISCONNECT™

Model 980 can be used in various orthotic applications. The Quick Disconnect™ allows the orthotist to make any section of the brace detachable. For example, the Quick Disconnect™ can be used at the KAFO/AFO interface when the patient needs to wear only the AFO section at night. It is available in nylon or heavy duty aluminum.

US Patent 6,129,689



980



980-HD

Order No.	Description
980	Nylon Quick Disconnect™
980-HD	Aluminum Heavy Duty Quick Disconnect™

SECTION III

**HIP AND ALUMINUM THRUST
BEARING JOINTS**

1000 SERIES

2000 SERIES

**ALUMINUM THRUST
BEARING JOINTS**



**ALUMINUM THRUST
BEARING JOINTS**

ALUMINUM THRUST BEARING JOINTS

Becker aluminum thrust bearing joints were originally designed for Cerebral Palsy patients. All joints are equipped with hardened steel races and thrust bearings to ensure smooth movement throughout the range-of-motion. Midsections are polished for strength and smooth action.

MODEL 1055 FREE MOTION ALUMINUM THRUST BEARING KNEE JOINT

Model 1055 has a full range-of-motion. There is no extension or flexion stop.

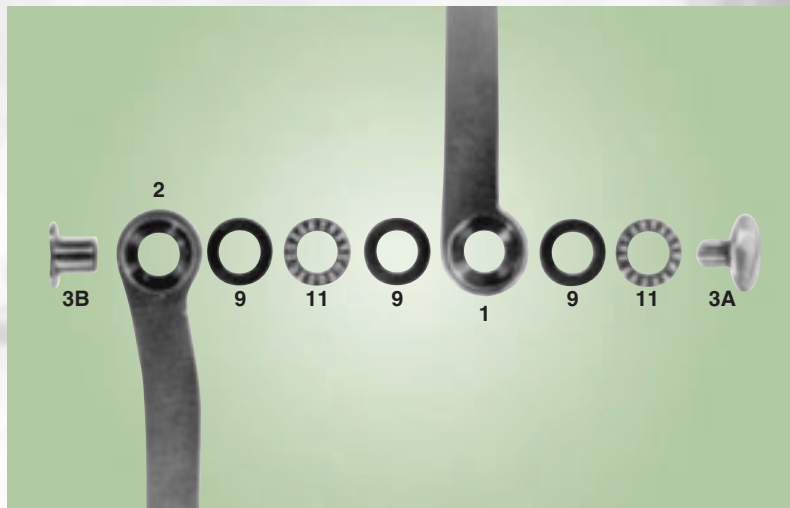

To order parts, please specify the order number, followed by the part number you desire.

Order No.	Joint Size	Upright Dimensions	Side
1055-AL	A	1/4" x 1-1/4"	Left
1055-AR	A	1/4" x 1-1/4"	Right
1055-AP	A	1/4" x 1-1/4"	Pair
1055-BL	B	1/4" x 1"	Left
1055-BR	B	1/4" x 1"	Right
1055-BP	B	1/4" x 1"	Pair
1055-CL	C	1/4" x 3/4"	Left
1055-CR	C	1/4" x 3/4"	Right
1055-CP	C	1/4" x 3/4"	Pair

• Shipped fully assembled

MODEL 1065 RING LOCK ALUMINUM THRUST BEARING KNEE JOINT

Model 1065 is equipped with a ring lock to hold the patient in full extension. Ball catches are standard.

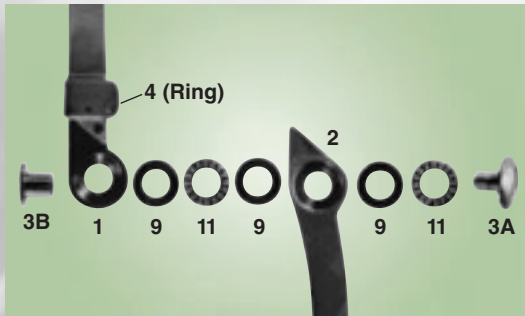

To order parts, please specify the order number, followed by the part number you desire.

Order No.	Joint Size	Upright Dimensions	Side
1065-AL	A	1/4" x 1-1/4"	Left
1065-AR	A	1/4" x 1-1/4"	Right
1065-AP	A	1/4" x 1-1/4"	Pair
1065-BL	B	1/4" x 1"	Left
1065-BR	B	1/4" x 1"	Right
1065-BP	B	1/4" x 1"	Pair
1065-CL	C	1/4" x 3/4"	Left
1065-CR	C	1/4" x 3/4"	Right
1065-CP	C	1/4" x 3/4"	Pair



- Shipped fully assembled
- Do not remove rings

MODEL 1075 ADJUSTABLE EXTENSION RING LOCK ALUMINUM THRUST BEARING KNEE JOINT

Model 1075 is the same as model 1065 except a serrated disk is incorporated into the design to allow the orthotist to increase or decrease the extension stop by 6° intervals. Ball catches are standard.

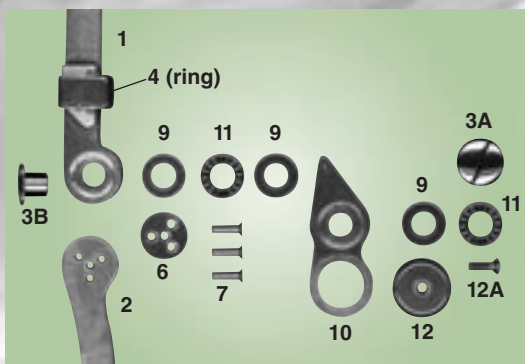

To order parts, please specify the order number, followed by the part number you desire.

Order No.	Joint Size	Upright Dimensions	Side
1075-AL	A	1/4" x 1-1/4"	Left
1075-AR	A	1/4" x 1-1/4"	Right
1075-AP	A	1/4" x 1-1/4"	Pair
1075-BL	B	1/4" x 1"	Left
1075-BR	B	1/4" x 1"	Right
1075-BP	B	1/4" x 1"	Pair
1075-CL	C	1/4" x 3/4"	Left
1075-CR	C	1/4" x 3/4"	Right
1075-CP	C	1/4" x 3/4"	Pair



- Shipped fully assembled
- Do not remove rings

MODEL 1085 FREE MOTION ALUMINUM THRUST BEARING HIP JOINT

Model 1085 has a full range-of-motion with no extension stop.

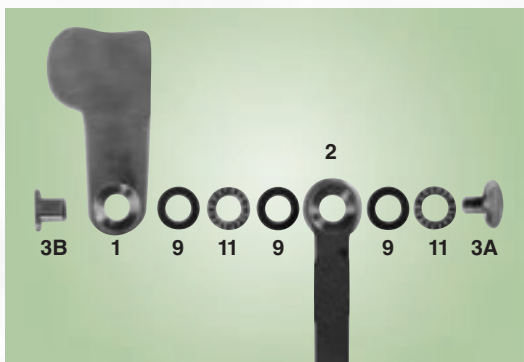

Order No.	Joint Size	Upright Dimensions	Side
1085-AL	A	1/4" x 1-1/4"	Left
1085-AR	A	1/4" x 1-1/4"	Right
1085-AP	A	1/4" x 1-1/4"	Pair
1085-BL	B	1/4" x 1"	Left
1085-BR	B	1/4" x 1"	Right
1085-BP	B	1/4" x 1"	Pair
1085-CL	C	1/4" x 3/4"	Left
1085-CR	C	1/4" x 3/4"	Right
1085-CP	C	1/4" x 3/4"	Pair

To order parts, please specify the order number, followed by the part number you desire.

• Shipped fully assembled

MODEL 1090 RING LOCK ALUMINUM THRUST BEARING HIP JOINT

Model 1090 locks in 180° of extension. Ball catches are standard.

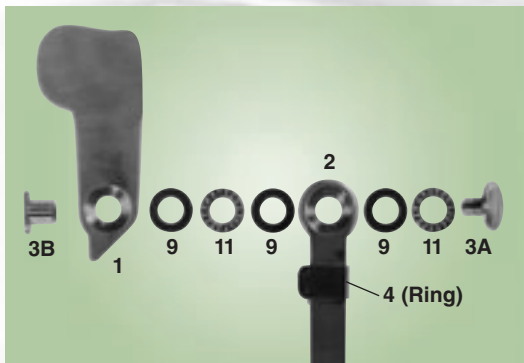

Order No.	Joint Size	Upright Dimensions	Side
1090-AL	A	1/4" x 1-1/4"	Left
1090-AR	A	1/4" x 1-1/4"	Right
1090-AP	A	1/4" x 1-1/4"	Pair
1090-BL	B	1/4" x 1"	Left
1090-BR	B	1/4" x 1"	Right
1090-BP	B	1/4" x 1"	Pair
1090-CL	C	1/4" x 3/4"	Left
1090-CR	C	1/4" x 3/4"	Right
1090-CP	C	1/4" x 3/4"	Pair

To order parts, please specify the order number, followed by the part number you desire.

• Shipped fully assembled

• Do not remove rings

MODEL 1095 TWO POSITION RING LOCK ALUMINUM THRUST BEARING HIP JOINT

Model 1095 locks at both 180° and 90°. Ball catches are standard.

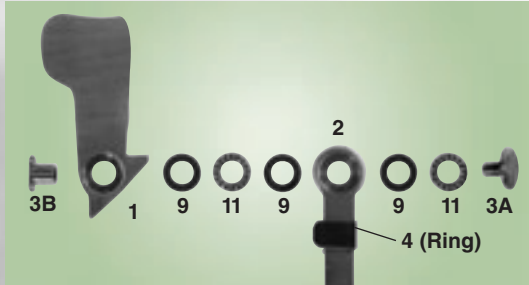

To order parts, please specify the order number, followed by the part number you desire.

Order No.	Joint Size	Upright Dimensions	Side
1095-AL	A	1/4" x 1-1/4"	Left
1095-AR	A	1/4" x 1-1/4"	Right
1095-AP	A	1/4" x 1-1/4"	Pair
1095-BL	B	1/4" x 1"	Left
1095-BR	B	1/4" x 1"	Right
1095-BP	B	1/4" x 1"	Pair
1095-CL	C	1/4" x 3/4"	Left
1095-CR	C	1/4" x 3/4"	Right
1095-CP	C	1/4" x 3/4"	Pair



- Shipped fully assembled
- Do not remove rings

MODEL 1096 ADJUSTABLE EXTENSION RING LOCK ALUMINUM THRUST BEARING HIP JOINT

Model 1096 is the same as model 1095 except a serrated disk is incorporated into the design to allow the orthotist to increase or decrease the extension stop by 6° intervals. Ball catches are standard.

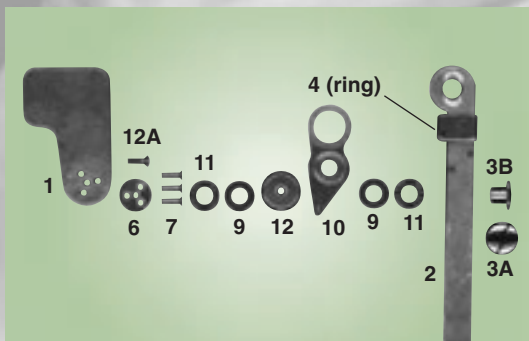

To order parts, please specify the order number, followed by the part number you desire.

Order No.	Joint Size	Upright Dimensions	Side
1096-AL	A	1/4" x 1-1/4"	Left
1096-AR	A	1/4" x 1-1/4"	Right
1096-AP	A	1/4" x 1-1/4"	Pair
1096-BL	B	1/4" x 1"	Left
1096-BR	B	1/4" x 1"	Right
1096-BP	B	1/4" x 1"	Pair
1096-CL	C	1/4" x 3/4"	Left
1096-CR	C	1/4" x 3/4"	Right
1096-CP	C	1/4" x 3/4"	Pair



- Shipped fully assembled
- Do not remove rings