



Stunning Real Stone Aesthetic ~ BEST Water Protection

Silvermine's patented and intuitive installation & flashing system provides a safe and professional finish trusted by the pros. Other systems may provide labor savings, but fall short when it comes to water penetration.

Silvermine provides the attractive look of real stone at a fraction of the cost. In fact, stone veneer was ranked the #1 best home improvement investment according to Remodeling Magazine's "Cost vs Value" report for 2020!



SILVERMINE®
MORTARLESS ARCHITECTURAL STONE PRODUCTS
 LABOR SAVING | LIFETIME WARRANTY | PATENTED WATER SEAL SYSTEM



"Simplest Stone in the World to Install!"

Stack It Up and Tack It On

- ◆ Real Stone Aesthetic
- ◆ Mortarless
- ◆ Install in Any Weather
- ◆ Durable & Maintenance Free
- ◆ Increase Home/Business Value
- ◆ No Water Penetration
- ◆ Patented Flashing System
- ◆ 40-50% Less Cost Installed!



Flats, Corners & Pillar Stone Available in All 5 Colors!

Sills & Accessories Available in Gray, Tan & Brown



Evening Gray

Dover Cliff

Marin Fog

Dakota Sunset

Monument Valley

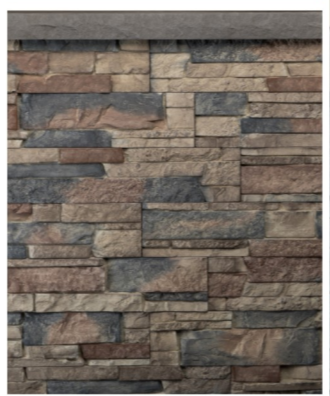
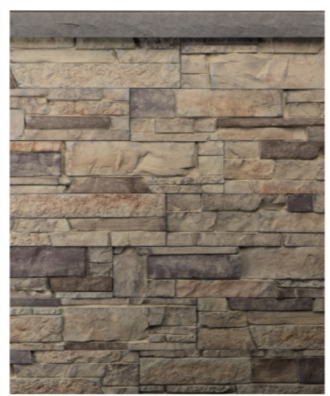
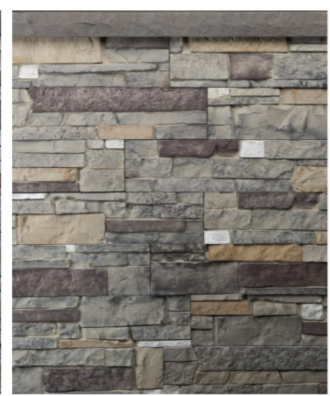
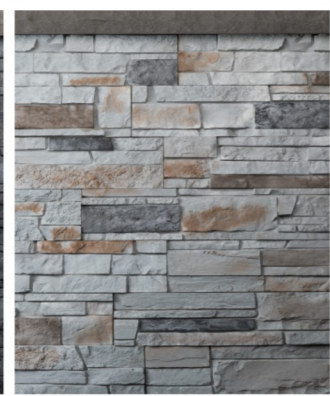

Vinyl Design Corporation
 7856 Hill Avenue
 Holland, OH 43528
 vinyldesigncorp.com
 PH: 800.469.4009
 PH: 419.865.4009
 Fax: 419.865.4453

vinyl design

Silvermine® Eliminates the Perils of Water Damage



More than 90% of stone veneer siding is installed incorrectly¹

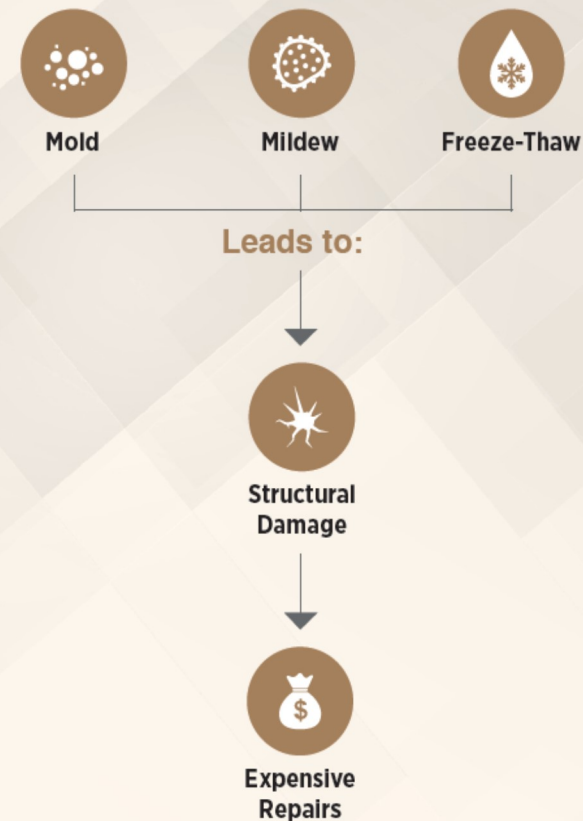

¹In accordance with the industry standard from the National Concrete Masonry Association

Silvermine® Stone Is THE SOLUTION

- ◆ Patented Hanging & Flashing System
- ◆ Almost Impossible to Install Incorrectly
- ◆ NO Water Penetration
- ◆ Lightning Fast Install Process

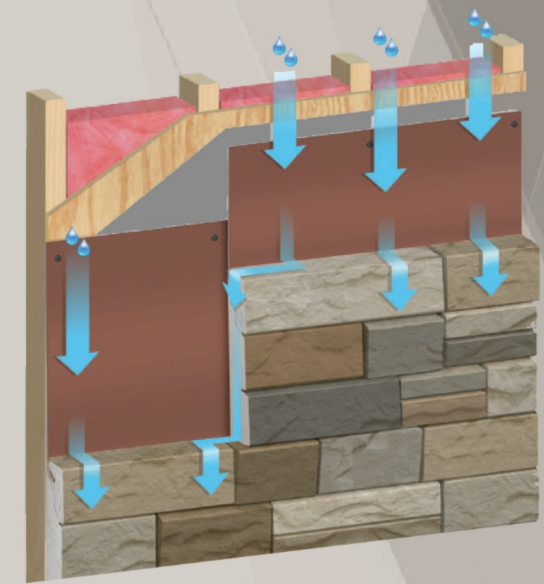



How Does it Work?

Our products:

- Look Great
- Include Our Patented Flashing System
- Install Up To 4 Times Faster
- Cost Less To Install Than Mortar-On And Other Mortarless Solutions
- Require Less Wall Preparation
- Can Be Installed In Any Season
- Are Simple To Install

 It starts with our 8" aluminum flashing, securely cast into each flat stone. This creates a "shingle" effect on your wall and won't allow water penetration like every other similar product on the market.

 Our unique corner system seamlessly works through inside/outside corners. Using the same stone for both, saving time, money and providing a foolproof water barrier.

 Finally, the system is capped off with our 3" sill pieces. The fastening hem tucked underneath existing siding or counter-flashed against masonry.

Protect Your Biggest Asset!

Mold & Mildew Problems

Trapped water can cause mold, and many stone veneer products allow water to seep in with no ability to escape. Mold and mildew doesn't just affect old homes – **improper installation, mis-matched products and poor design** can leave even recent builds at risk of potentially hazardous "infection" and failure, requiring **expensive repairs or complete rebuilds**.

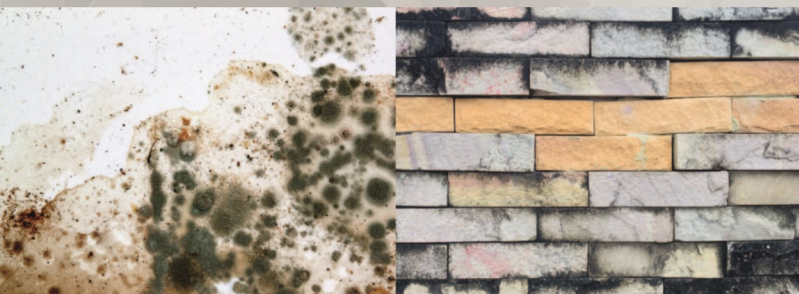

Freeze & Thaw Issues

When water gets inside the outer cladding of your home, it can freeze and expand, causing your siding to pop and break, creating more opportunities for water to get in and cause more damage. When a builder skips steps and takes shortcuts, gaps will remain, cracks will happen. **There's no way to fix this issue without tearing everything off and starting all over.**

