

Tom Hanna
Kensett, Iowa

Delores Lathrop
Falls Township
SE 1/2 of SW 1/4 & SW 1/2 of SE 1/4 Sect 31
Cerro Gordo County

Water

711.C.

~~711-237-0700~~

~~711-034~~

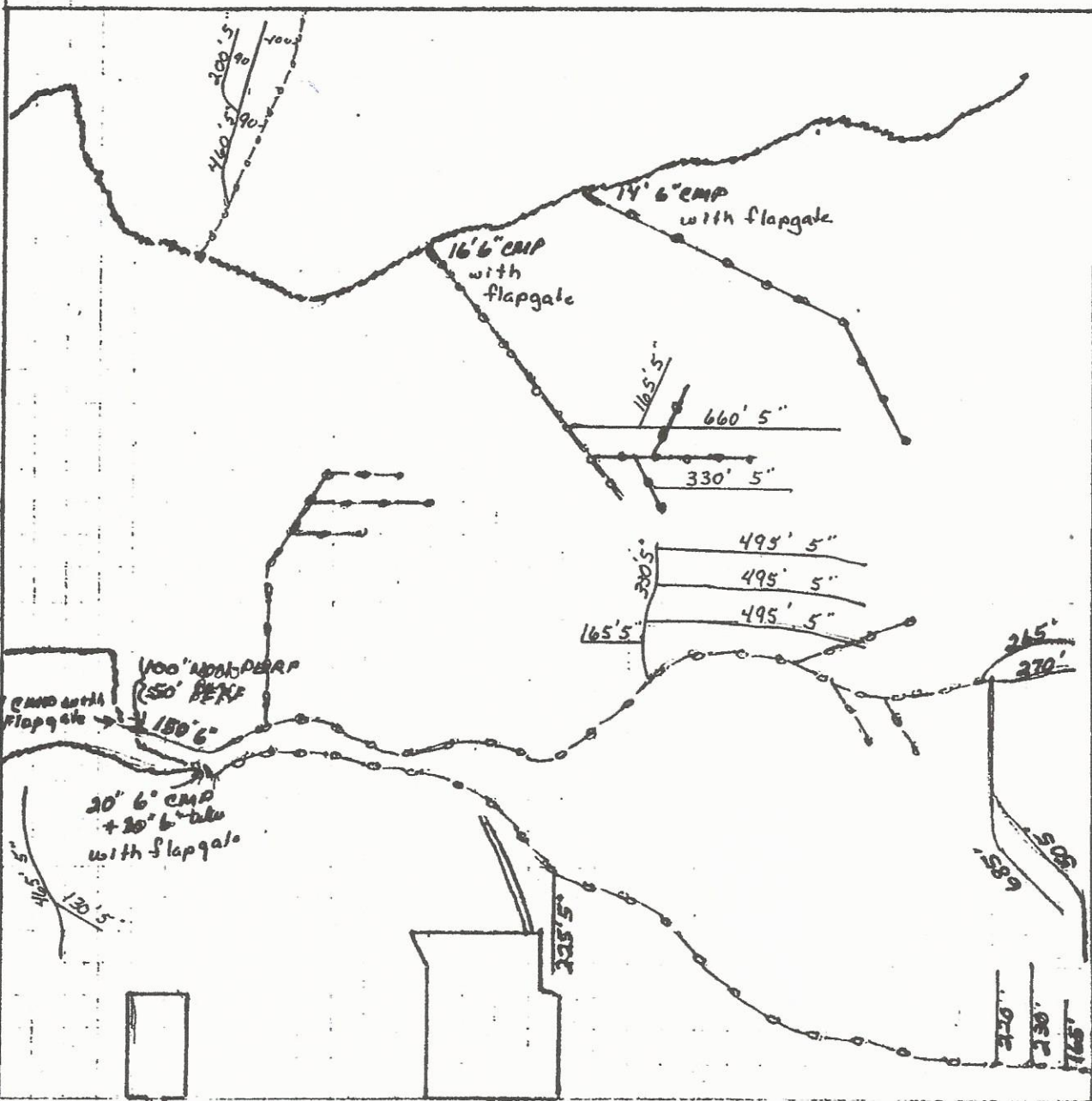

NA

1" = 400'
--- Existing Line
--- New Lines

2565' 5" installed
180' 6" non perf
100' 6" (leach bed)
(July, 1984)

4390' 5" installed
(April, 1986)