

SS38 ROMAN SHADE SYSTEM

STYLISH CUTTING EDGE SOLUTION
FOR TRADITIONAL APPLICATIONS

The new SS38 Roman Shade system by Rollease Acmeda offers a range of applications, a fresh contemporary design and many functional benefits.

Able to achieve straight or angled vertical drop, as well as sloping applications to achieve widths and drops up to 13 feet with a chain controlled operation.

The SS38 system features a slim square profile design with a low profile mounting clip that adds discretion to its finish.

Attach fabric with velcro, or use the innovative open slot that allows for easy flat spline fabric insertion. This shade system ensures smooth, quiet movement with the strength to manage shades of any weight – small or large.

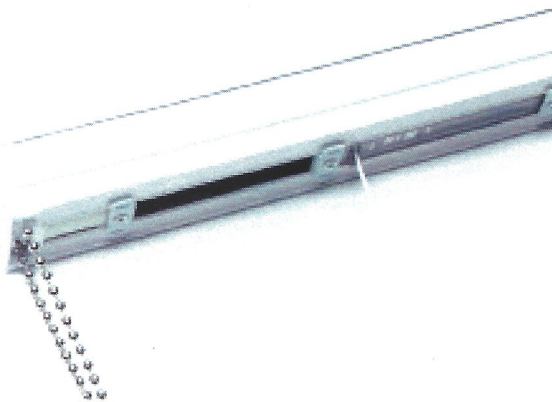

Leading innovator of precision hardware and automated shade solutions.
USA | AUSTRALIA | EUROPE rolleaseacmeda.com

© Rollease Acmeda Inc.

 **ROLLEASE
ACMEDA**
PRECISION IN MOTION

SS38 ROMAN CHAIN CONTROL | QUICK REFERENCE GUIDE

LOW PROFILE MOUNTING CLIP

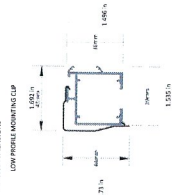

DEDUCTION
1,965.19

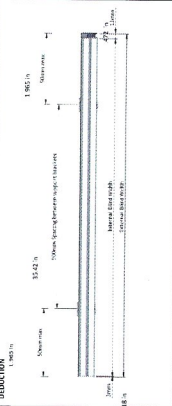

SYSTEM CAPACITY – STANDARD SPOOL

1m = 39.37"
2m = 78.74"
3m = 118.11"
4m = 157.48"

[illegible]

SS38 ROMAN CHAIN CONTROL SYSTEM

The 5538 Roman Blind System offers an elegant square profile, housing new operating mechanisms designed for efficient and smooth operation.

AESTHETICAL FEATURES

- Contemporary style in a minimalist design.
- End covers for a more overall finish.
- Our slim spines allow for improved appearance of other volumes.

PRODUCTION / ASSEMBLY FEATURES

- Low profile non obtrusive mounting options
- Push and release spring loaded mounting clip option
- Optional saline or hook and loop touch tape fabric attachment
- Effortless reposition

- Our slim steel

- FUNCTIONAL BENEFITS**
- Smooth and quiet operation.
 - 4m maximum width and drop capacity.
 - Guided-spoke system.
 - Our 5m spoke offers a 30% reduced user effort.
 - Achieving straight drop and up to 30 degree angled installations.

- 15

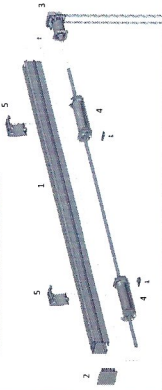

CHAIN CONTROL OPTIONS

- | | | |
|-------------------------|--------------------|-----------------|
| Planetary Drive [3.5:1] | Direct Drive [1:1] | Characteristics |
|-------------------------|--------------------|-----------------|



COLOUR RANGE

0721 Page 10

SYSTEM INDEX	
1	5518 Head Bar [10' Long tape + coil] 5518 0110 000400
2	5518 Head Bar End Cap 5518 0110 000260
3	5518 Dr. Vent Unit 5518 0420 000651 = Flareless Drive 5518 0411 000651 = Direct Drive
4	5518 Spool cone [14" dia. x 10" cord & 1" diam] 5518 8341 500451
5	5518 Low Profile Mounting Cg 5518 0212 000316

Phytophthora spp. in rice

SS38 SYSTEM

PRODUCT SPECIFICATIONS



July 2015



**ROLLEASE
ACMEDA**
PRECISION IN MOTION

CONTENTS

July 2015

SECTION NO.	DESCRIPTION	PAGE NO.
SECTION 1 – OVERVIEW		1.1
	PART A – GENERAL SCHEMATICS	1.1
	PART B – SYSTEM OPTIONS	1.2
SECTION 2 – SYSTEM SPECIFICATIONS		2.1
	PART A – SYSTEM SPECIFICATIONS	2.1
SECTION 3 – MATERIAL SPECIFICATIONS		3.1
SECTION 4 – WARRANTY		4.1
SECTION 5 – SPECIFICATION IMAGES		5.1
	DEDUCTIONS	5.1
	ADDITIONAL ARCHITECTURAL VIEWS	5.1
	LOW PROFILE MOUNTING CLIP SPACING	5.1
	SPRING LOADED MOUNTING CLIP SPACING	5.1
SECTION 6 – PRODUCT IMAGERY		6.1

DISCLAIMER

INTRODUCTION

This product specifications manual has been produced by Acmeda to supply the necessary information for safe and correct assembly and installation of this system.

DISCLAIMER

Acmeda has used reasonable care in preparing the information included in this document, but makes no representations or warranties as to the completeness or accuracy of the information. Information is supplied upon the condition that the persons receiving the information will make their own determination as to its suitability for their purposes prior to use. Acmeda assumes no liability whatsoever for any damages incurred by you resulting from errors in or omissions from the information included herein. Acmeda reserves the right to make changes without further notice to any products to improve reliability, function or design.

COPYRIGHT

COPYRIGHT © ROLLEASE ACMEDA 2015

All rights reserved. No part of this document may be reproduced or utilized in any means, by any means, electronic or mechanical including photocopying, recordings, or by any information storage or retrieval system, without the express permission from Rollease Acmeda.

SECTION 1 – OVERVIEW

PART A – GENERAL SCHEMATICS

The SS38 Roman Blind System offers an elegant square profile housing new operating mechanisms designed for efficient and smooth operation.

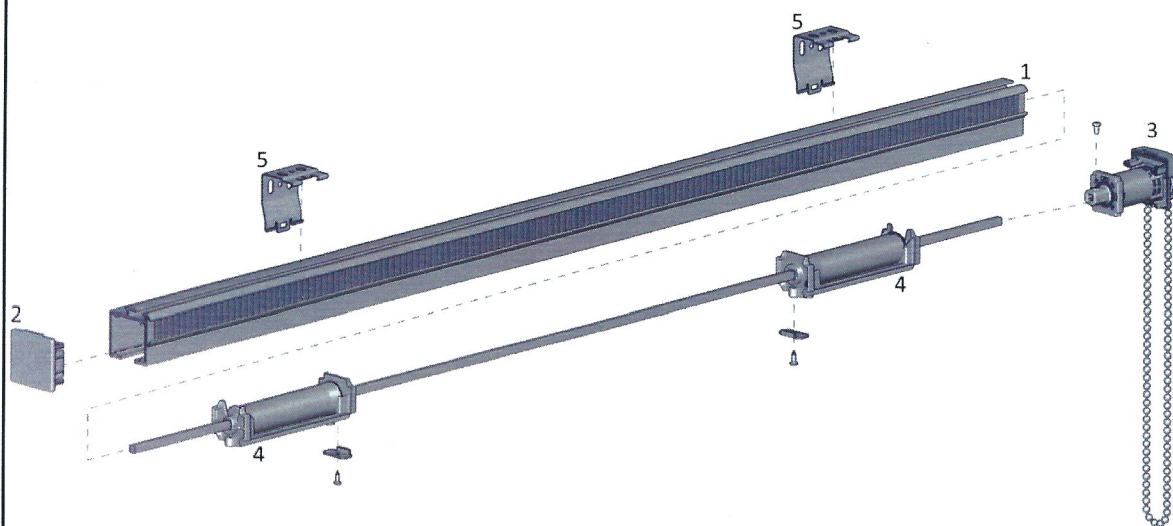

SYSTEM INDEX

1. SS38 Head Rail [incl. Crimp tape + rod]
2. SS38 Idle End Cap
3. SS38 Drive Unit
4. SS38 Spool Cone [incl. 4m white cord & clamp]
5. SS38 Low Profile Mounting Clip

PART B – SYSTEM OPTIONS

CHAIN CONTROL OPTIONS

Direct Drive [1:1]

The direct drive can be identified by an internal blue component

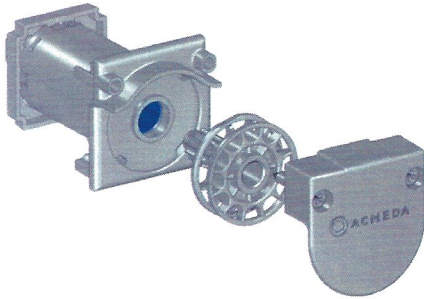

Planetary Drive [3.5:1]

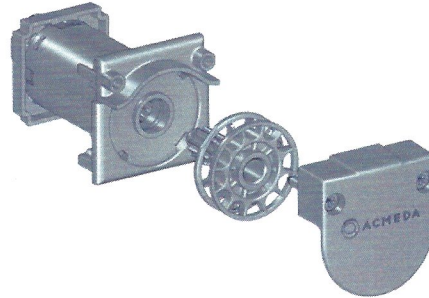

COLOR RANGE



pure white
069

COMPONENT OPTIONS

Chainhold Tension Device



SECTION 2 – SYSTEM SPECIFICATIONS

PART A – SYSTEM SPECIFICATIONS

DIRECT DRIVE

Direct Drive - 160 gsm

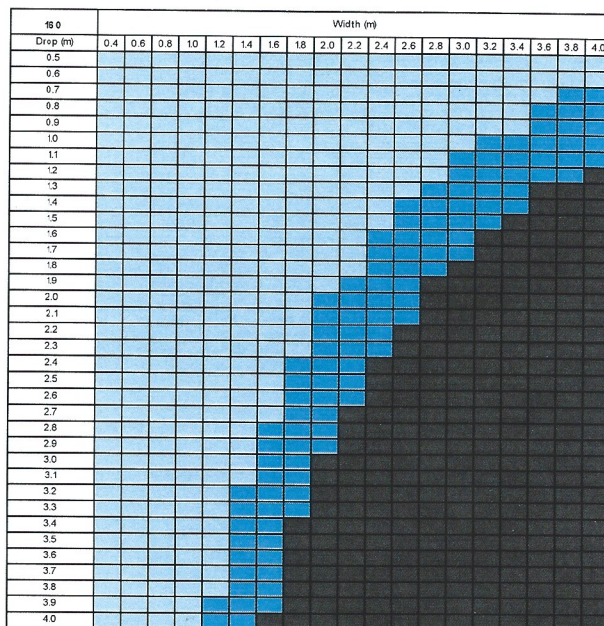

Direct Drive - 430 gsm

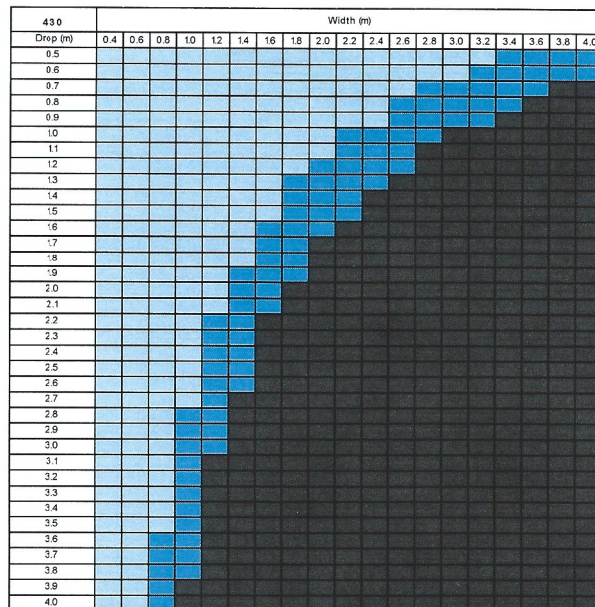

LEGEND	DESCRIPTION
	DIRECT DRIVE - CTS SPOOL 3.5 kg User Effort
	DIRECT DRIVE - SLIM SPOOL 3.5 kg User Effort
	Cannot be achieved - outside product specifications

PLANETARY DRIVE

Planetary Drive - 160 gsm

160	Width (m)																		
Drop (m)	0.4	0.6	0.8	1.0	1.2	1.4	1.6	1.8	2.0	2.2	2.4	2.6	2.8	3.0	3.2	3.4	3.6	3.8	4.0
0.5																			
0.6																			
0.7																			
0.8																			
0.9																			
1.0																			
1.1																			
1.2																			
1.3																			
1.4																			
1.5																			
1.6																			
1.7																			
1.8																			
1.9																			
2.0																			
2.1																			
2.2																			
2.3																			
2.4																			
2.5																			
2.6																			
2.7																			
2.8																			
2.9																			
3.0																			
3.1																			
3.2																			
3.3																			
3.4																			
3.5																			
3.6																			
3.7																			
3.8																			
3.9																			
4.0																			

Planetary Drive - 430 gsm

430	Width (m)																			
Drop (m)	0.4	0.6	0.8	1.0	1.2	1.4	1.6	1.8	2.0	2.2	2.4	2.6	2.8	3.0	3.2	3.4	3.6	3.8	4.0	
0.5																				
0.6																				
0.7																				
0.8																				
0.9																				
1.0																				
1.1																				
1.2																				
1.3																				
1.4																				
1.5																				
1.6																				
1.7																				
1.8																				
1.9																				
2.0																				
2.1																				
2.2																				
2.3																				
2.4																				
2.5																				
2.6																				
2.7																				
2.8																				
2.9																				
3.0																				
3.1																				
3.2																				
3.3																				
3.4																				
3.5																				
3.6																				
3.7																				
3.8																				
3.9																				
4.0																				

LEGEND	DESCRIPTION
	PLANETARY DRIVE - CTS SPOOL 3.5 kg User Effort
	PLANETARY DRIVE - SLIM SPOOL 3.5 kg User Effort
	Cannot be achieved - outside product specifications

SECTION 3 – MATERIAL SPECIFICATIONS

PART NUMBER	PRODUCT	MATERIAL	METAL FINISHES
SS38-0130-xxxLLL	SS38 ALUM. PROFILE + CRIMP TAPE + 5MM SQUARE ROD	ALUMINIUM	ANODISED 15
SS38-0411-xxx051	SS38 DIRECT DRIVE	POM, NYLON, ASA, STEEL	
SS38-0420-xxx051	SS38 PLANETARY DRIVE	POM, NYLON, ASA, STEEL	
SS38-8341-xxx451	SS38 SPOOL WITH CORD (4M)	POM, HDPE, PC, STEEL	
SS38-0212-xxx034	SS38 LOW PROFILE MOUNTING CLIP	STEEL	ZINC PLATED
SS38-0120-xxx040	SS38 HEAD RAIL END CAP	NYLON	
RB92-1001-001100	10MM ACM FLAT SPLINE - NO TAPE	ASA	
RB92-1002-001075	10MM ACM FLAT SPLINE – WITH DOUBLE SIDED TAPE (ONE SIDE)	ASA	
RB92-1003-001075	10MM ACM FLAT SPLINE - WITH DOUBLE SIDED TAPE (TWO SIDES)	ASA	
HD31-0125-060025	TOUCH TAPE SEW-ON LOOP 25MM		
VA01-1401-010Xss	METAL ROTATION CHAIN	STAINLESS STEEL	
VA01-1401-020Ass	METAL ROTATION CHAIN	ALUMINIUM	
VA01-1401-020Bss	METAL ROTATION CHAIN	BRASS	
VA01-1401-020sss	METAL ROTATION CHAIN	STEEL	NICKLE PLATED
VA01-1401-S20sss	PRE LOOPED METAL ROTATION CHAIN	STEEL	
VA01-1401-X10sss	PRE LOOPED METAL ROTATION CHAIN	STAINLESS STEEL	
VA01-1406-xxxsss	PRE LOOPED PLASTIC ROTATION CHAIN COLOURS	POM	
RB91-1321-xxx000	CHAIN TENSIONERS & SCREWS: FACE/WALL FIX	POM, PP, STEEL	
RB91-1322-xxx000	CHAIN TENSIONERS & SCREWS: RECESS FIX	POM, PP, STEEL	
SS91-1312-000040	CHAIN TENSIONING HOOK 'SMALL' & SCREW		

SECTION 4 – WARRANTY

Acmeda provide a 5 year hardware warranty against defects to the original purchaser (the fabricator/manufacturer).

The hardware warranty is not to be transferred to the end consumer.

The hardware warranty is limited to the repair or resupply of defective hardware components to the fabricator/manufacturer only.

The hardware warranty is applicable to normal use.

The hardware warranty will not apply where the defect arises due to incorrect assembly and installation.

Retailers are obliged to supply consumers with their own warranty, if required, at the point of purchase.

SECTION 5 – SPECIFICATION IMAGES

Please contact Rollease Acmeda: info@rolleaseacmeda.com to request electronic copies of the file listed below.

DEDUCTIONS

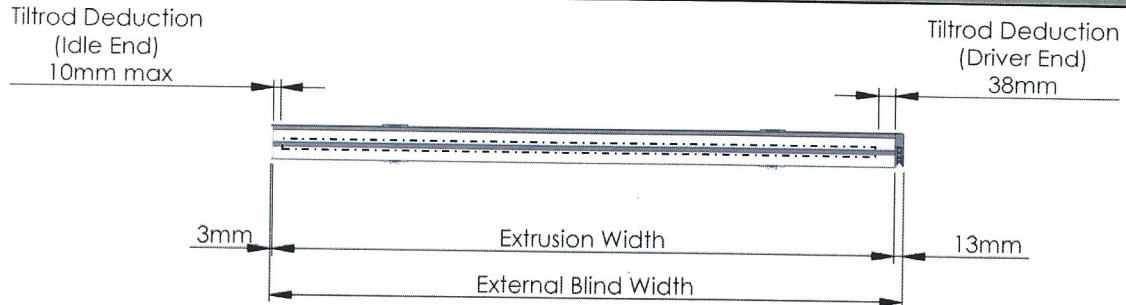

ADDITIONAL ARCHITECTURAL VIEWS

Low Profile Mounting Clip

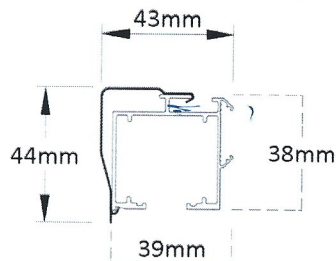

LOW PROFILE MOUNTING CLIP SPACING

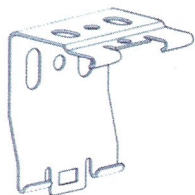

Bracket 50mm max. 900mm max. spacing between brackets



SECTION 6 – PRODUCT IMAGERY

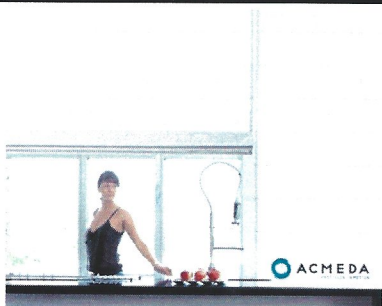

Filename: Photo 001 SS38 CHAIN CONTROL

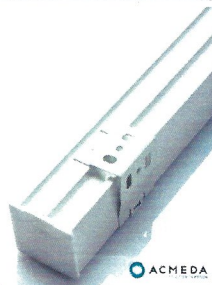

Filename: Photo 002 SS38 CHAIN CONTROL

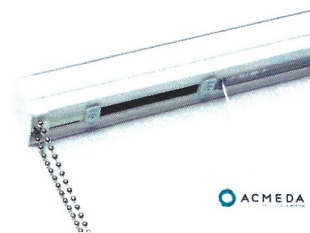

Filename: Photo 002 SS38 CHAIN CONTROL