

**NOTES**

1. ALL EXTERIOR WALLS SHOWN 4 1/2" THICK.
2. ALL INTERIOR WALLS SHOWN 4 1/2" THICK, UNLESS NOTED.
3. ALL INTERIOR DOORS ARE 6' 8" IN HEIGHT BY WIDTH LISTED ON PLANS.
4. ALL INTERIOR SHEET ROCK SURFACES WILL BE FINISHED SMOOTHED, AND SHALL BE PRIMED WITH AN APPROVED SHEET ROCK PRIMER.
5. GUTTERS AND DOWNSPOUTS ARE RECOMMENDED FOR THE PORTION OF THE STRUCTURE ABOVE THE PORCHES.

**LEGEND**

- WINDOW NUMBER ———— (12/53)  
SEE THIS SHEET FOR DETAILS
- DOOR NUMBER ———— (7/63)  
SEE THIS SHEET FOR DETAILS

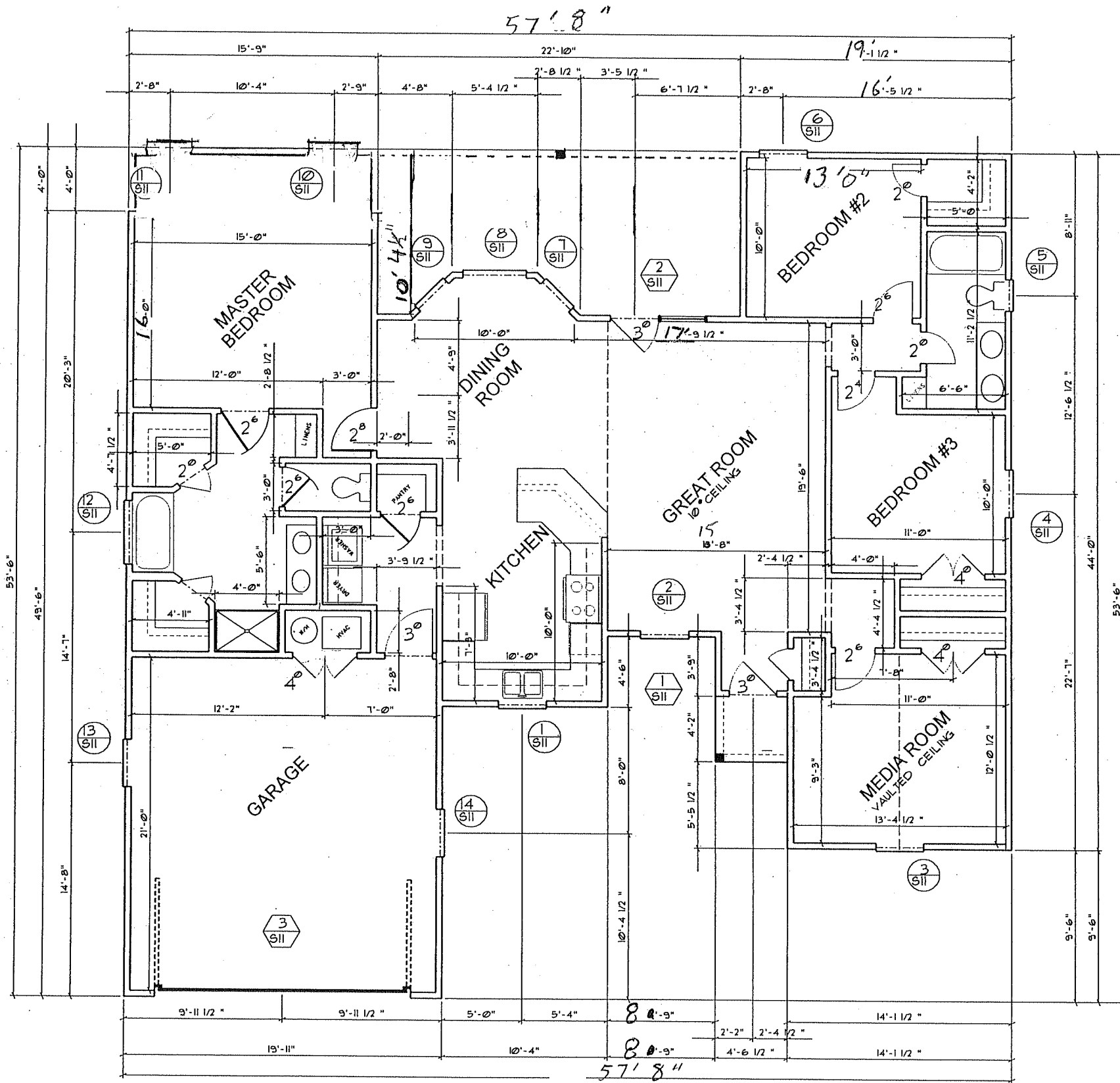

**FLOOR PLAN**

11 X 17 FORMAT SCALE: 1/8" = 1'-0"  
24 X 36 FORMAT SCALE: 1/4" = 1'-0"

|              |  |
|--------------|--|
| Approved By: |  |
| Date:        |  |
| Signature:   |  |

DRAFTING SERVICES:  
PROVIDING THE LATEST IN CAD MAPING,  
PLAN PRODUCTION AND INSTRUCTION  
**O'Steen Services**  
OFFICE IN SOUTH GEORGIA  
WAYNESVILLE, GA. (912) 776-8612

CONTRACTOR:

**JOHNS REALTY**

| Revising | Description |
|----------|-------------|
|          |             |
|          |             |
|          |             |

**DIMENSIONED FLOOR PLAN**

Sheet  
**3**