



Super Farm

(2/24/2020)

General Tractor Rules:

1. All engine blocks must remain in original location as intended by the manufacturer. Sheet metal to be stock length and location must be stock appearing
2. Tractors must have grill and hood in place as intended by manufacturer.
3. Tractors must have stock block, agricultural type block, OEM replacement block. No automotive blocks permitted. Maximum of 8 cylinders permitted. Approved recasted/ after-market block suppliers; (Hypermax, D&R, E-burg Components).
4. Maximum wheelbase is 114" and maximum length is 13' from the center of the rear axle to forward most part of the tractor.
5. All turbocharged engines on tractors will have one cable totally surrounding the engine block and head. The cable will consist of 3/8" diameter and located between the first and second cylinders. Cable must pass through the manifold areas. Cable will have four (4) to six (6) inches of slack. There will be a minimum of four (4) clamps at all splices. Maximum of 2 valves per cylinder.
6. A deflection shield between driver and engine from top of hood and top of transmission housing or clutch housing is required. Deflection shield will go from side shield to side shield. This will help provide a barrier during a flash fire.
7. All tractor engines are required to shield all rotating mass mounted on the front of the crankshaft. Shield to be frame rail to frame rail by a minimum .125 aluminium or steel fastened to the frame on each side by two evenly spaced bolts. (3/8-inch Grade 5 minimum.)
8. All tractors are required to have an approved bell housing blanket that meets the following specifications:
20 ply ballistic nylon or 20 ply Kevlar style 713 betting construction. At least seventeen (17) inches wide and long enough around the bell housing with six (6) inches of overlap, secured with a two (2) inch wide nylon web straps, with a steel "d" ring on one end and sewn the length of the blanket, except overlap area and long enough to pass back through the "d" ring and to be tied in a saddle cinch and with four (4) two inch nylon webs retaining strips, each at the front and back of blanket.
9. All tractors will run a safety tie bar system or a one- piece frame rail secured to the rear axle housing.
 - 9a. Tie bars will be mounted with at least four (4) axle housing bolts.
 - 9b. Tie bars will extend forward of bell housing area and be fastened to side of the block with a minimum of two (2) 5/8 bolts.
 - 9c. Tie bars will be of sufficient strength to support weight of the tractor with the bolts used to split tractor removed.
 - 9d. All safety blankets will be mounted inside safety tie bar system.
10. On cast iron OEM chassis a 1/2" steel spacer plate is permitted for clutch clearance.
11. Only mechanical activated clutches permitted.
12. All tractors with a competition weight of 7,000# to 10,000# will require a 47.1 SFI Spec rollover protection.

Super Farm

(2/24/2020)

Class Rules

1. Maximum weight permitted 9,300
2. Maximum tire size is 24.5" X 32".
3. Maximum cubic inch limit is 640. Maximum of 8 cylinders permitted.
4. Any cast or manufactured cylinder head will be accepted. Cylinder head must retain OEM width and length for the engine application. Valves must retain OEM angle for engine application. 2 valve per cylinder maximum. Cylinder head must retain OEM bolt pattern for exhaust manifold and intake. The stock exhaust manifold and intake bolt pattern must be used to attach the exhaust manifold and intake. No overhead cams permitted.
5. Intake manifold: Maximum inlet size 3.75" measured on the outside diameter. One inlet pipe only.
6. OEM exhaust manifolds for that model and series engine only permitted on cylinder head
7. Intercoolers are permitted with the use of water and/or ice only.

8. Chassis-

- 8A. Components are not permitted.
 - 8B. OEM rear-end, transmission, and engine must be in stock location, bolted and secured to OEM chassis.
 - 8C. Engine cannot move independent or rear-end/ transmission housing(s).
 - 8D. Stock transmission housing or manufacturer's replacement and stock final drive housings or manufacture's replacement.
 - 8E. Chassis and frame must remain stock from rear of engine block to the rear of tractor.
 - 8F. Tie bars are mandatory or full frame must be mounted rigid to engine, transmission, and final drive housings.
9. **Fuel Systems:** Largest fuel injection pump allowed will be a P-pump OE housing with only one plunger per cylinder. No aftermarket pump housings permitted.

10. Turbos:

- 10A. Altering of a turbo housing to accommodate a smaller foot or base will not be permitted.
- 10B. Exhaust housing and exhaust manifold bolt pattern shall be no larger than 2.75 X 3.5 inches.

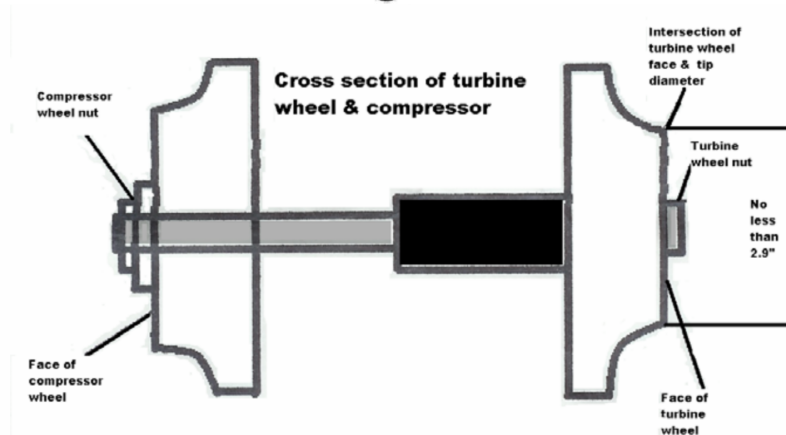
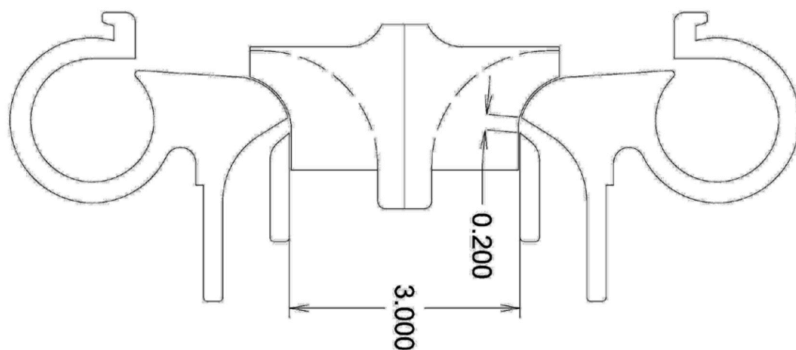

Super Farm

(2/24/2020)

11. Intake:

- Map width enhancement is allowed. Maximum map width .200". MWE groove must be inside neck area where intake covered is measured at 3"
- Compressor wheel must protrude into three inch bore.
- Intake housing to be no larger than three inches at the face of the wheel.

12 Exhaust:

- All turbine wheel blades to protrude into three inch bore. All air must exit through 3" opening. No map width enhancements on exhaust housing permitted.
- Turbine wheel exhaust blade to be no less than 2.90" in diameter at intersection of turbine wheel face and tip diameter.
- Turbine housing to be no larger than three inches at intersection of turbine wheel face and tip diameter.
- Exhaust housing will be measured at intersection of turbine wheel face and tip diameter.

14. No waste gates will be permitted.

15. No variable geometric turbos permitted.

16. All ITPA General rules apply.