

Visions of the future

ESTATES STRATEGY 2005 - 2015

The University of Northampton

Park Campus

**Boughton Green Road
Northampton NN2 7AL**

Avenue Campus

**St George's Avenue
Northampton NN2 6JD**

Main switchboard 01604 735500

Course freephone 0800 358 2232

Course email study@northampton.ac.uk

Web www.northampton.ac.uk



THE UNIVERSITY OF
NORTHAMPTON

Transforming lives,
inspiring change



Visions of the future

ESTATES STRATEGY 2005 - 2015

The University of Northampton

Park Campus
Boughton Green Road
Northampton NN2 7AL

Avenue Campus
St George's Avenue
Northampton NN2 6JD

Main switchboard 01604 735500

Course freephone 0800 358 2232

Course email study@northampton.ac.uk

Web www.northampton.ac.uk



Transforming lives,
inspiring change

Forward by Gill Winder, Director of Estates
The University of Northampton

welcome

I am delighted to present to you 'The University of Northampton's Estates Strategy 2005-2015 brochure'. The following pages provide a preview of some of the exciting estates and facilities developments that will take place at the University over the next decade

These plans represent £80 million worth of investment in new building developments and refurbishment, a series of headline projects that will continue to reinforce our position as a leading University attracting students, research and businesses from across the UK and the world.

The facilities on offer at The University of Northampton have grown considerably over the last 14 years. As a result of the investment of over £73 million Park Campus has

almost doubled in size, increasing the space and number of buildings on site. Our Avenue Campus has also received substantial investment and is set to be the focus of the next phase of our 10 year Estates strategy.

At The University of Northampton, we recognise that to be considered a 21st century, modern university, we need the facilities to match. This strategy will help us continue to realise our goals

These plans
represent
£80 million
worth of
investment



Developments to date

Park Campus

The University of Northampton has invested over £73 million in its campuses to date. Here we highlight some of the most recent developments, notwithstanding over £1.3 million in improvements to accessibility across both Park and Avenue campuses and a £1.5 million ongoing investment in our IT infrastructure.

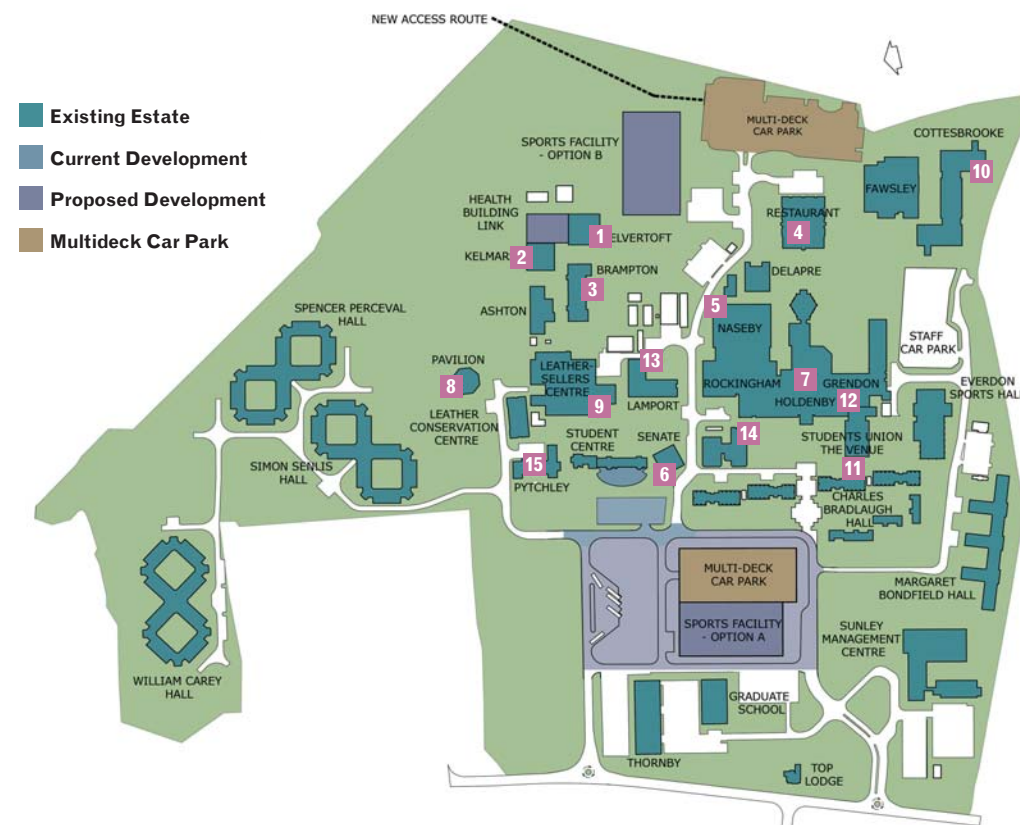

1 Yelvertoft

Home to the School of Health's nursing and midwifery courses, Yelvertoft was officially opened in October 2004 by HRH Duchess of Gloucester following a £1.2m investment. Dedicated to the provision of healthcare education, this purpose-built facility now provides academic and administrative offices, flexible teaching rooms and a state-of-the-art clinical skills laboratory. We hope it will continue to develop and enhance our students' competence and confidence for many years to come.

2 Kelmarsh

Built in 1997 following an £850,000 investment, Kelmarsh provides a dedicated Occupational Therapy teaching block for the School of Health.

3 Brampton

Built in the early 1990s, Brampton is home to the School of Health's Podiatry, Mental Health and more recently Sports Divisions.

4 The Restaurant

Our award-winning £1.35m restaurant was completed in 1993. The design was conceived not only to cater for 500 diners but also act as a focal point for the Campus. Described in The Architects' Journal as a 'classic solution of an elegantly proportioned and immaculately detailed pavilion', the building went on to win the prestigious National Civic Trust Award in 1995 and has also featured in a Higher Education Design Award Forum Exhibition in 1996 organised by the RIBA.

5 Naseby

As well as being one of the main bases for the School of Social Sciences, Naseby is part of the library on Park Campus with the main base being in the adjoining Rockingham building, which has had over £10m refurbishment over the last decade – including a £3.5m extension and extra floor space added in 2000.

6 Senate

Built following a £1m charitable donation by The Horne Foundation, the Senate building is located at the heart of Park Campus and is a striking design, with its exposed tubular steel frame and eternal roof supports. Designed to give staff a modern working environment, it includes a suite of meeting rooms, a dining room, training rooms, video conferencing suite and the Directorate offices.

7 Holdenby

As well as being the base for the Admissions office and some of the other support departments, Holdenby houses a number of large lecture theatres (used mainly for Social Sciences, Health and Business) that have benefited from a £0.5m refurbishment over the last four years.

8 Pavillion

Built in 1996, the Pavillion Bar now provides a staff and postgraduate students social venue and hosts sporting and other external events for University College Northampton and external clients.

9 Leather Conservation Centre

Built in the late 1990s, this £0.5m conservation centre for the Worshipful Company of Leathersellers is the only one of its kind in the world. Unique facilities include a conservation workshop, laboratory and other specialist areas, all environmentally controlled to maintain levels of temperature and relative humidity – suitable for the handling and treatment of damaged or ageing leather products.

10 Cottesbrooke

Home of the Business School, the Cottesbrooke building was designed with the professional requirements of the business community – as well as the needs of our students and staff – in mind. Completed in 1992, the £4.1m new building featured some 36 lecture/seminar rooms to cater for groups of 25-50 students and two large

lecture rooms with state-of-the-art lecture facilities. These not only allow 150 students to attend a lecture but also permit lectures to be recorded and referred to at a later date.

11 The Venue

Purpose-built for the Students' Union, the £0.8m new building was designed to provide recreational, refreshment and advice facilities for students. It houses all union offices, a games room, shop, coffee bar and three bars, including nn2 – a restaurant by day, nightclub in the evening!

12 Holdenby/Grendon

The base for IT Services, Grendon was last improved in the 1993, when £0.5m was invested to create the open access student IT facilities.

13 Lamport

A refurbishment following a £322,000 investment in 2004 upgraded some of the undergraduate teaching laboratories and created cross-functional research laboratories shared by the Schools of Health and Applied Sciences. A further £100,000 investment in laboratory facilities in science education teaching was completed in early 2005.

14 Sulgrave

Home to the School of Education, Sulgrave was originally built in the 1970s but underwent a £950,000 refurbishment in the early 1990s when a top floor was added.

15 Pitchley Parade/Oundle

These provide the current base for many of the student services, including shops and cash machines, financial services and student services – some of which will move across into the new Student Centre, which will be situated nearby.

Developments to date

Avenue Campus

Avenue Campus Map

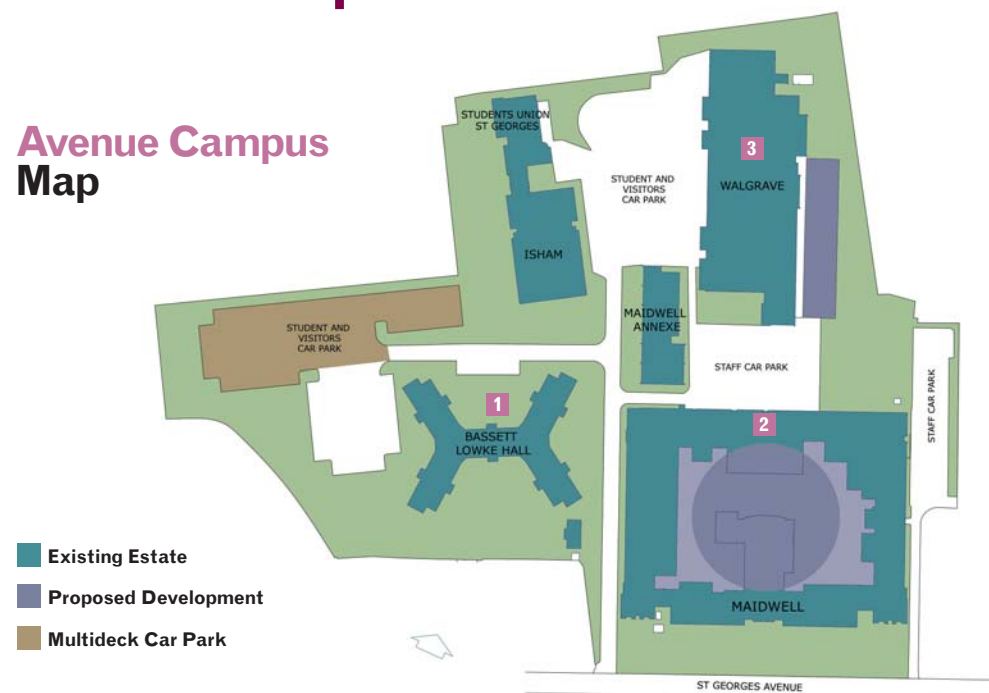

1 Bassett Lowke Hall

This £4.3m halls of residence was built in 1998 and offers some of the newest accommodation at University College Northampton. It created 232 en-suite rooms and additional car parking.

2 Maidwell

Home to the School of the Arts, Applied Sciences and the library on Avenue Campus, Maidwell has benefited from almost £1m in refurbishment in the last two years – including an extension to the library, refurbished reception and state-of-the-art media studios.

3 Walgrave

Largely the base for the School of the Arts art workshops, Walgrave underwent a £0.5m refit in 1995.



Our aims are to create the best possible environment for educational excellence.

Avenue Campus the future

The Arts

Much of Avenue Campus is given over to arts, media and performance activities. Estates development plans include the extension and remodelling of the existing Maidwell building, which fronts onto St George's Avenue. The facilities on show will feature a welcoming environment with excellent social amenities alongside first class exhibition, performance, screening and studio spaces. Learning and teaching facilities will also be improved to create the best possible environment for educational excellence.

Applied Science

The development of the University's Maidwell building along with an area of planned demolition will make way for the development of a proposed three or four-storey combined learning, teaching, research and consultancy block on the same site which will also provide new facilities for the Applied Sciences learning and teaching.

Creative Industries Innovation Centre

Work has also already begun to create an Innovation Centre for the creative industries; the centre is to include 20 start-up and pre-start up business units. Funded collaboratively by the Northampton Partnership, East Midlands Development Agency, the Arts Council and the University itself this is the first project the University has engaged in with the assistance of external partners. This unique development will be designed to fuse the need to support new companies as they develop by providing skills, expertise and specialist facilities that the University already has available.

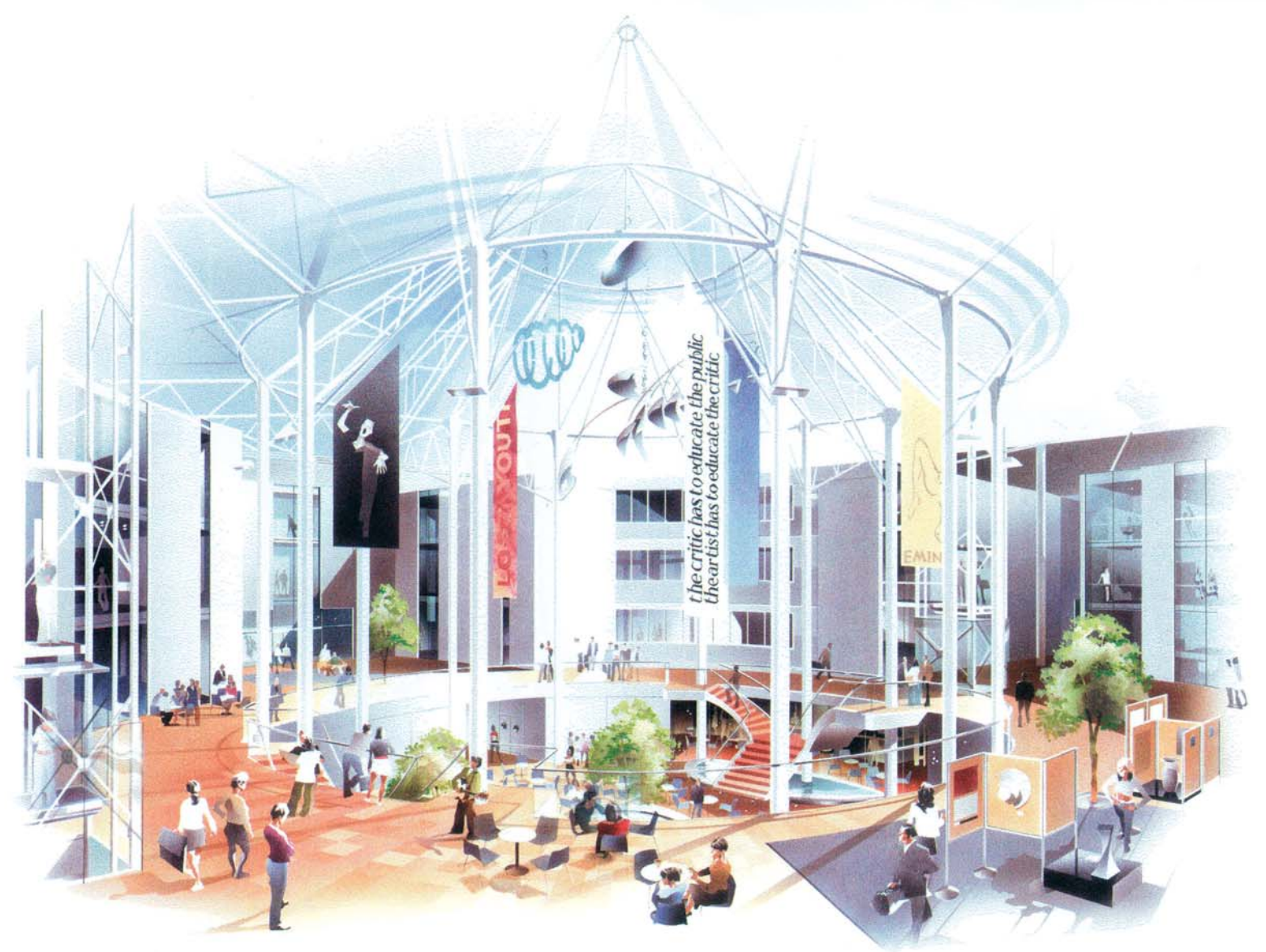

Sports and healthy living

There is a strong demand from a majority of students for a university that includes top class sporting facilities. This factor, combined with the obvious health benefits associated with regular exercise and sports participation makes the development of sports facilities a headline project for The University of Northampton.

As a result the University intends to develop a sports and health centre that will benefit both the local region by being open to the public, as well as providing an exciting and full range of facilities for its staff and students.

Supporters already include Sport Northamptonshire, Moulton College and the Borough and County Councils. In addition, links with local sporting clubs, Kingsthorpe Community College and private sector sporting organisations are also being developed.



New Sports Facilities

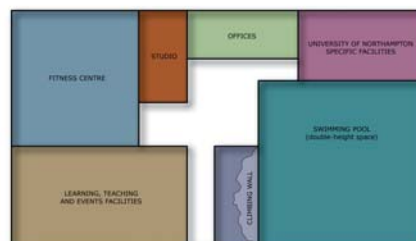

Conceptual First Floor Plan

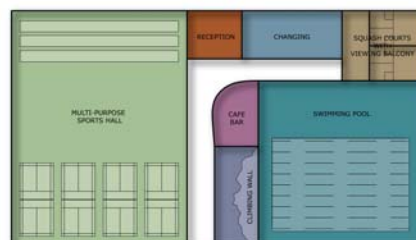

Conceptual Ground Floor Plan



London's tremendous achievement in winning the Olympic city venue bid for 2012 has lent a whole new dimension to these plans and the University is now looking for strategic partners to help take this project forward as quickly as possible.



A state of the art sports and health centre to benefit and be enjoyed by both the public and University alike.

Supporting educational excellence

The University of Northampton is currently developing an exciting new Student Centre due to be completed in January 2005, operating as a 'one-stop service' for students' needs.

The major project, based at Park Campus, will bring together a whole range of services and activities for students with a 'Learning and Teaching' focus.

It will offer the opportunities for students to hand in completed assignments, develop learning practices, have learning support needs assessed and for them to apply for additional financial assistance in one location.

The Student Centre will take full advantage of new technology to allow students to access information about their courses, administrative matters and support, including booking appointments.

The University has a strong reputation for supporting its students and will continue to build upon this reputation with sensitive and appropriate developments that provide an effective and flexible learning and teaching environment

The centre will be a one-stop and technologically advanced hub for students, with a focus on learning and teaching

Research & Knowledge Transfer

The award of research degree awarding powers has been a vital development for the University.

In addition to the already existing Knowledge Exchange at Park Campus, planned developments include the construction of a dedicated research centre at Avenue campus, project spaces for research and Knowledge transfer activity and the refurbishment and upgrading of existing research areas. A dedicated research development centre at Avenue will also become a key part of the University's strategy to increase knowledge transfer with the local economy.

A dedicated research centre will be a key part of our strategy to increase knowledge transfer with the local economy.



developing standards and approaches to promote sustainable construction and design.

Sustainability

As a socially responsible institution The University of Northampton is committed to improving the performance of its estate and as a result is carrying out a thorough review of its current environmental impact, policies and procedures.

This essential work will help identify target areas for improvement. It is being carried out using expertise from staff at the University, the County and Borough Councils and with support from the Government-funded Carbon Trust action programme, which helps businesses and the public sector reduce carbon emissions and exploit the potential of low carbon technologies.

This benchmarking activity is now already well underway, covering areas that include initiatives on water conservation, waste minimisation, recycling, producing and implementing green travel plans, reviewing and developing standards and approaches acceptable to the University to promote sustainable construction and design.

**We recognise that
to be considered a
21st century,
modern university,
we need the
facilities to match.
This strategy will
help us continue to
realise our goals**