

# PARTS LIST

KEY	QUAN.	PART NUMBER	NAME
1.	4	P-703-1	S.C.S. 8-32 x 1/2"
2.	1	703	Bearing Holder
3.	1	706	Drive
4.	1	737	Pulley Key
5.	1	758	Drive Spring
6.	1	759	Backlash Washer
7.	1	P-706-1	Ring #5008-87
8.	2	P-706-2	Drive Bearing
9.	2	P-740-1	Bracket S.C.S. 3/8 x 1 1/4"
10.	1	P-740-850	Bracket 2 1/4"
11.	1	P-703-2	Ring #5002-185
12.	1	P-706-3	Ring #5100-98
13.	1	P-700-1	S.S.S. 10-32 x 1/4"
14.	1	P-700-2	S.C.S. 3/8-16 x 2"
15.	1	718	Spring Holder
16.	1	717	Quill Plug
17.	1	719	Link
18.	1	724	Quill Plug Screw
19.	1	721	Dial Washer
20.	1	P-721-B	Dial Plate
21.	1	722	Dial Screw

# PARTS LIST

KEY	QUAN.	PART NUMBER	NAME
22.	1	725	Handle Screw
23.	1	723	Link Screw
24.	1	720-1	Handle
25.	1	731	Quill Spring
26.	1	P-720-A	Knob
27.	1	704	Quill
28.	1	730	Spring Screw Plug
29.	1	716	Micrometer Lock Nut Scale
30.	1	729	Scale
31.	2	P-729-1	R.H.S. 6-32 x 1/4"
32.	1	715	Micrometer Nut
33.	1	712-2	Quill Stop
34.	1	P-712-3	SCS 1/4-20 x 3/4"
35.	1	728	Lock Screw Washer
36.	1	727	Lock Screw Handle
37.	1	P-805-6	Type 100 Collet Nut
38.	1	P-805-5	Type 100 Collet (Specify Size)
39.	2	708	Bearing Lock Nuts
40.	1	P-805-1	Lower Spindle Bearing
41.	1	707-C	Spacer

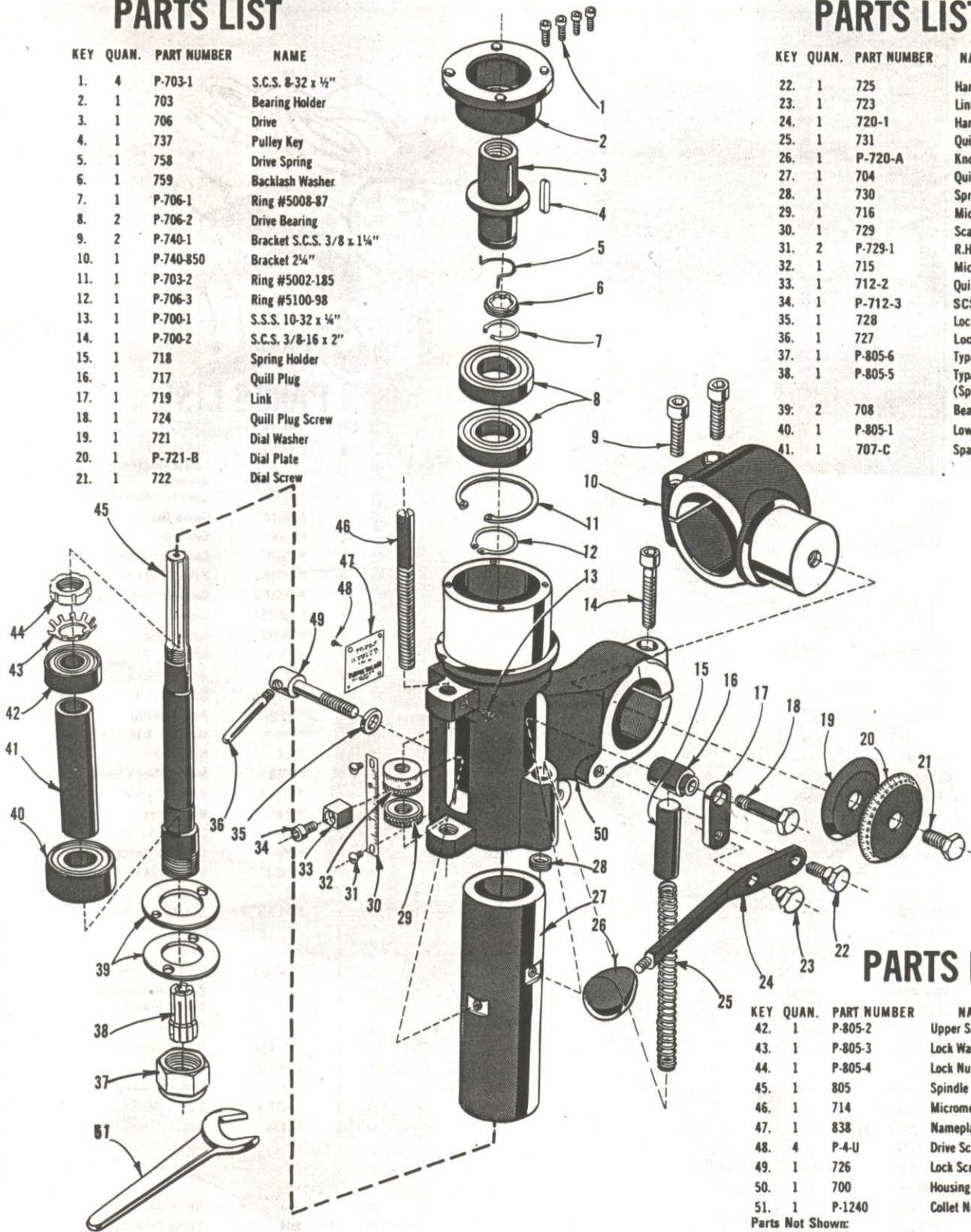

# PARTS LIST

KEY	QUAN.	PART NUMBER	NAME
42.	1	P-805-2	Upper Spindle Bearing
43.	1	P-805-3	Lock Washer W-03 Precision
44.	1	P-805-4	Lock Nut N-03 Precision
45.	1	805	Spindle
46.	1	714	Micrometer Screw
47.	1	838	Nameplate
48.	4	P-4-U	Drive Screws
49.	1	726	Lock Screw
50.	1	700	Housing
51.	1	P-1240	Collet Nut Wrench
Parts Not Shown:			
52.	1	760	O-Line Pointer
53.	1	P-760-1	PHMS 6-32 x 1/4"
54.	1	P-758	Lockwasher