

 PORTER
PRESTON



BASICS

WINDOW SHADINGS

Effective February 4, 2019

design simplified™

TABLE OF CONTENTS

Product Overview

- Features & Benefits 3
- Collection Information (includes Light Control) 4

Pricing Groups

- Pricing Group 1 (Translucent). 5
- Pricing Group 2 (Light Dimming) 6

Product Specifications

- Product Specifications and Finished Dimensions 7
- Options and Additional Notes 8
- Standard Shading Operation 9
- Motorization Overview 10-11
- Product Components. 12-14

Oversize Common Carrier Delivery

All orders with any quantity of shades or blinds or any continuous valance 96" or more in width are considered oversize. Therefore, a net shipping charge of \$40 per oversized unit will be assessed.

Oversized orders that require expedited shipping will be quoted and charged accordingly.

Please see General Information for additional freight and shipping charge information.

FEATURES & BENEFITS



- Offered in the popular 2-1/2" vane size, ideal for any size window.
- Streamlined collection featuring both translucent and light-dimming vane styles to provide varying degrees of light control.
- Available with one of the two new motorization systems
 - Simplicity Rechargeable: Rechargeable RF motorization system provides months of use between charges (with normal use). The rechargeable battery is hidden in the rotating rail meaning no external battery pack. Solar recharge option available.
 - PowerWand: The ease of Simplicity motorization with the convenience of remote free operation. Lift and lower the shading with the touch of a button on the pendant that hangs from the front of the headrail. The rechargeable battery is charged using the charging port in pendant.
 - > To suit your customer's needs the black or white colored wand is available in one foot increments from one to five feet and can be placed on either the left or right.
- Limited Lifetime Warranty ensures your customers' satisfaction.

COLLECTION INFORMATION

Family Name	Color Name	Family Code	Color #	Coordinating Hardware Color Name	Light Control	Price Group
Dynamic 2-1/2" Translucent	Aspen	DYSS	335	White	B	1
	Confection	DYSS	333	White	B	1
	Mystic	DYSS	331	White	B	1
	Pencil Sketch	DYSS	330	White	B	1
	Poppyfield	DYSS	334	White	B	1
	Tailwind	DYSS	332	White	B	1
Mistral 2-1/2" Translucent	Bay Leaf	MTSS	300	Evening Light	B	1
	Casual White	MTSS	304	White	B	1
	December Gray	MTSS	305	Silver Gray	B	1
	Prailine	MTSS	303	Vanilla	B	1
	Sailcloth	MTSS	302	Vanilla	B	1
	Wildflower	MTSS	301	Vanilla	B	1
Pergola 2-1/2" Translucent	Butter Cream	PGSS	315	Vanilla	B	1
	Canvas	PGSS	313	Vanilla	B	1
	Cobblestone	PGSS	310	Silver Gray	B	1
	Cotton Field	PGSS	311	White	B	1
	Honey Beige	PGSS	314	Vanilla	B	1
	Spring Snow	PGSS	312	White	B	1
Repose 2-1/2" Light Dimming *	Cloud White	RPSS	325	White	C	2
	Peaceful	RPSS	322	Vanilla	C	2
	Sandrift	RPSS	323	Vanilla	C	2
	Sesame	RPSS	324	Vanilla	C	2
	Shadow	RPSS	320	Silver Gray	C	2
	Twilight	RPSS	321	White	C	2

* Light Dimming fabrics provide category C, opaque light control because even when the vanes are completely closed they DO NOT completely seal off all incoming light.

See vane closure diagram on page 8 for a visual reference.

Note: Collections are presented alphabetically. Within each collection colors are also arranged alphabetically



A. Glare Reducing

Softly filters light and reduces glare. Images, shapes and people can be seen clearly. Provides the least amount of light and shape screening.



B. Filtering

Filters strong light. Images, shapes and people can be seen with some clarity. Provides a modest degree of light and shape screening.



C. Shading

Significantly reduces light. Images, shapes and people cannot be seen clearly. Provides a moderate to strong degree of light and shape screening.



D. Blocking

Dramatically reduces light. Images, shapes and people are not distinguishable. Provides privacy against most all direct light and shape screening (except minimal light that may seep through closed or overlapping opaque/blackout vanes).



E. Blackout

Blocks out virtually all light (except light that may enter on the sides of the shade) for maximum privacy and darkness.

2-1/2" Translucent
Dynamic (DYSS)
Mistral (MTSS)
Pergola (PGSS)

GROUP 1

WIDTH TO:	24"	30"	36"	42"	48"	54"	60"	66"	72"	76"	84"	90"	96"	102"	109"	120"
HEIGHT TO:																
36"	\$330	371	412	454	494	538	577	620	728	771	813	856	896	952	1066	1164
42"	346	393	436	482	527	574	620	666	776	824	869	916	960	1021	1142	1247
48"	368	413	464	511	562	611	665	715	827	877	925	974	1025	1086	1216	1327
54"	381	435	487	543	596	650	705	767	876	930	982	1039	1096	1163	1304	1424
60"	401	459	515	570	627	692	751	814	922	983	1042	1106	1169	1247	1402	1532
66"	418	481	541	600	666	731	800	867	971	1040	1107	1177	1243	1330	1502	1640
72"	436	503	567	632	702	776	847	918	1025	1097	1170	1243	1316	1408	1593	1738
78"	449	519	588	662	732	808	883	961	1073	1153	1228	1306	1379	1481	1675	1829
84"	467	541	613	693	771	850	933	1013	1129	1214	1294	1374	1453	1559	1767	1929
90"	486	562	640	726	808	895	978	1063	1183	1270	1358	1443	1527	1636	1855	2025
96"	506	586	667	757	847	934	1023	1113	1238	1330	1422	1510	1601	1720	1948	2125
102"	578	670	760	860	951	1037	1158	1272	1360	1452	1547	1634	1725	1834	2069	2260
108"	608	703	800	904	999	1092	1217	1341	1431	1528	1627	1722	1817	1931	2180	2380
114"	644	747	849	961	1064	1161	1293	1423	1520	1625	1725	1825	1925	2048	2309	2522
120"	693	800	911	1028	1135	1243	1384	1522	1627	1738	1849	1954	2062	2192	2472	2700

STANDARD FEATURES

- Headrail Size: 3-5/8" x 3"
- Snap-in Bracket Style
- Cord Tilt & Lift
- Color-Coordinated Hardware

OPTIONS: NO CHARGE – SPECIFY ON ORDER

- Tilt Only
- Control Positions (R or L)
- Spacer Blocks
- Hold-Down Brackets
- Two-On-One Headrail – price as 2 separate shades (Standard Cord Loop Only)

OPTIONS: EXTRA CHARGE

- Fabric Headrail Insert add \$38 per shading
- Cordless Lift add \$77 per shading

MOTORIZATION OPTIONS: EXTRA CHARGE

- Simplicity Rechargeable Motor add \$281 per shading
 (Charging port available on the right side only)
 – 5 Channel Remote Control
 (Black Part #CS5138 or White Part #CS5138W) add \$41 each
 – Solar Panel (Part #CS52096) add \$153 each
- PowerWand add \$113 per shading
 – PowerWand Options (must be specified):
 1) Control Side (Left or Right)
 2) Wand Color (Black or White)
 3) Wand Length:
 1 foot (12")
 2 feet (24")
 3 feet (36")
 4 feet (48")
 5 feet (60")
- Plug-in Charger (Can be used for both Simplicity Rechargeable and PowerWand) (Part #CS5199) add \$31 each

SIZE STANDARDS	Standard Cord Loop	
	Single Shade	2-on-1 Headrail
Minimum ordered width	12"	24"
Minimum ordered width – tilt only	6"	N/A
Maximum ordered width	120"	120"
Maximum ordered width – tilt only	11-7/8"	N/A
Minimum ordered height	16"	16"
Maximum ordered height – translucent	120"	120"

SIZE STANDARDS	Cordless Lift	Simplicity Rechargeable	PowerWand™
Minimum ordered width	18"	19"	21"
Minimum ordered width – tilt only	NA	N/A	N/A
Maximum ordered width	84"	120"	120"
Maximum ordered width – tilt only	NA	N/A	N/A
Minimum ordered height	16"	16"	16"
Maximum ordered height – translucent	84"	120"	120"

GROUP 2

**2-1/2" Light Dimming
 Repose (RPSS)**

WIDTH TO:	24"	30"	36"	42"	48"	54"	60"	66"	72"	76"	84"	90"	96"	102"	109"	120"
HEIGHT TO:																
36"	\$364	409	455	501	544	592	635	683	798	848	895	943	987	1048	1176	1283
42"	381	434	481	531	582	632	683	731	855	905	957	1007	1057	1121	1252	1368
48"	403	455	511	562	619	673	730	785	905	962	1017	1072	1127	1195	1340	1462
54"	420	479	538	597	652	715	776	840	961	1023	1079	1143	1209	1280	1440	1572
60"	441	503	566	628	692	758	831	896	1014	1079	1146	1217	1288	1371	1542	1683
66"	460	525	596	665	731	805	880	955	1069	1144	1219	1293	1367	1463	1653	1805
72"	481	552	625	694	774	855	931	1008	1127	1209	1289	1367	1444	1549	1774	1936
78"	494	568	647	727	805	893	972	1058	1181	1266	1353	1437	1518	1628	1903	2078
84"	515	596	673	759	849	935	1026	1113	1243	1335	1423	1595	1666	1733	2041	2227
90"	536	619	702	796	892	983	1077	1168	1298	1396	1569	1665	1737	1845	2142	2337
96"	613	702	795	895	985	1073	1180	1287	1446	1537	1628	1721	1811	1936	2247	2453
102"	702	803	905	1017	1105	1190	1336	1470	1588	1679	1773	1860	1951	2068	2386	2605

STANDARD FEATURES

- Headrail Size: 3-5/8" x 3"
- Snap-in Bracket Style
- Cord Tilt & Lift
- Color-Coordinated Hardware

OPTIONS: NO CHARGE – SPECIFY ON ORDER

- Tilt Only
- Control Positions (R or L)
- Spacer Blocks
- Hold-Down Brackets
- Two-On-One Headrail – price as 2 separate shades (Standard Cord Loop Only)

OPTIONS: EXTRA CHARGE

- Fabric Headrail Insert add \$38 per shading
- Cordless Lift add \$77 per shading

MOTORIZATION OPTIONS: EXTRA CHARGE

- Simplicity Rechargeable Motor add \$281 per shading
 (Charging port available on the right side only)
 – 5 Channel Remote Control
 (Black Part #CS5138 or White Part #CS5138W) add \$41 each
 – Solar Panel (Part #CS52096) add \$153 each
- PowerWand add \$113 per shading
 – PowerWand Options (must be specified):
 1) Control Side (Left or Right)
 2) Wand Color (Black or White)
 3) Wand Length:
 1 foot (12")
 2 feet (24")
 3 feet (36")
 4 feet (48")
 5 feet (60")
- Plug-in Charger (Can be used for both Simplicity Rechargeable and PowerWand) (Part #CS5199) add \$31 each

SIZE STANDARDS	Standard Cord Loop	
	Single Shade	2-on-1 Headrail
Minimum ordered width	12"	24"
Minimum ordered width – tilt only	6"	N/A
Maximum ordered width	120"	120"
Maximum ordered width – tilt only	11-7/8"	N/A
Minimum ordered height	16"	16"
Maximum ordered height – light dimming	102"	102"

SIZE STANDARDS	Cordless Lift	Simplicity Rechargeable	PowerWand™
Minimum ordered width	18"	19"	21"
Minimum ordered width – tilt only	N/A	N/A	N/A
Maximum ordered width	84"	120"	120"
Maximum ordered width – tilt only	N/A	N/A	N/A
Minimum ordered height	16"	16"	16"
Maximum ordered height – light dimming	84"	102"	102"

PRODUCT SPECIFICATIONS

FEATURES

# of fabric styles	4
# of colors	24
Headrail size	3-5/8" x 3"
Bracket style	Snap-in
Cord loop tilt and lift	Yes
Safety cord tensioner	Color Coordinated
Warranty	Limited Lifetime

OPTIONS

Two-on-One Headrail Option (Std Cordloop ONLY) not available with Cordless Lift or Motorized systems	Yes
Cordless Lift	Yes
Control positions	Left or Right
Fabric Headrail Insert	Yes
Hold-down brackets	Yes
Spacer blocks	Yes
Tilt Only (Standard Cordloop ONLY)	Yes
Specialty shapes	No
Tile cut-out	No
Cord Loop Drop	Yes

MOTORIZATION OPTIONS

Simplicity Rechargeable	Yes
- Remote	Black or White
- Plug-in Charger	Yes
- Solar Panel Charger	Yes
PowerWand Motorization (Rechargeable)	Yes
- Wand Length	1, 2, 3, 4, 5 feet
- Wand Color	Black or White
- Wand Position	Left or Right
- Plug-in Charger	Yes

CORD LOOP LENGTH

Translucent	
Ordered Length	Cord Length
16" to 19-7/8"	12"
20" to 26-7/8"	18"
27 to 39-7/8"	24"
40" to 59-7/8"	36"
60" to 83-7/8"	48"
84" to 107-7/8"	60"
108" to 120"	72"

Light Dimming	
Ordered Length	Cord Length
16" to 19-7/8"	12"
20" to 26-7/8"	18"
27 to 39-7/8"	24"
40" to 59-7/8"	36"
60" to 83-7/8"	48"
84" to 102"	60"

MOUNTING REQUIREMENTS

INSIDE MOUNT	
Minimum casement depth*	1-1/2"
Minimum casement depth*, fully recessed	3-3/4"
Minimum rear fabric clearance	1/8"

OUTSIDE MOUNT	
Minimum mounting surface height	3-1/8"
Recommended width overlap per side	3"
Minimum rear fabric clearance	1/8"

FINISHED DIMENSIONS

NOTE: WIDTH AND HEIGHT MAY VARY ± 1/8"

INSIDE MOUNT – Standard Deductions		
	Standard Cord Loop	
	Single Shade	2-on-1 Headrail
Headrail unit	1/8" less than ordered width	1/8" less than ordered width
Fabric width	1" less than ordered width	1" less than ordered width
Shading height	1/8" less than ordered height	1/8" less than ordered height
Fabric Gap	N/A	3/8"
OUTSIDE MOUNT – Standard Deductions		
	Standard Cord Loop	
	Single Shade	2-on-1 Headrail
Headrail unit	ordered width	ordered width
Fabric width	3/4" less than ordered width	3/4" less than ordered width
Shading height	1/8" less than ordered height	1/8" less than ordered height
Fabric Gap	N/A	3/8"

INSIDE MOUNT – Standard Deductions			
	Cordless Lift	Simplicity Rechargeable	PowerWand™
Headrail unit	1/8" less than ordered width	1/8" less than ordered width	1/8" less than ordered width
Fabric width	3/4" less than ordered width	1-1/8" less than ordered width	1" less than ordered width
Shading height	1/8" less than ordered height	1/8" less than ordered height	1/8" less than ordered height
OUTSIDE MOUNT – Standard Deductions			
	Cordless Lift	Simplicity Rechargeable	PowerWand™
Headrail unit	ordered width	ordered width	ordered width
Fabric width	5/8" less than ordered width	1" less than ordered width	3/4" less than ordered width
Shading height	1/8" less than ordered height	1/8" less than ordered height	1/8" less than ordered height

OPTIONS

FABRIC HEADRAIL INSERT

Features a coordinating fabric inserted into the front of the headrail to provide a soft fabric look from top to bottom.
(See surcharge on pricing pages)



SIDE-BY-SIDE VANE ALIGNMENT

When window shadings are installed side by side, vane alignment can be guaranteed within 1/4" only if:

- Shadings are ordered at the same time and in the identical style, color and height.
- Shadings that need to be aligned are specified on the order form (a note must be included in Special Instructions).

ADJACENT SHADINGS

To span wide window openings, window shadings may be installed adjacently, so their headrails abut. The gap between the fabric panels of the adjacent shadings varies according to the control placement, as shown in the table below.

CONTROL PLACEMENT	
Adjacent (Abutting)	Window Shadings
Left/Right Shadings	Center Gap
Right/Right Controls	3/4"
Left/Left Controls	3/4"
Right/Left Controls	1-1/16"
Left/Right Controls	1/2"
Window shadings are not recommended for bay windows or butt-and-pass applications.	

ADDITIONAL NOTES

SHADING ADJUSTMENT

Shadings should wind evenly and not skew to one side.

A balance weight on the bottomrail can easily be adjusted if the fabric winds unevenly on the roll when the window shading is raised. Uneven winding can cause damage to the edge of the fabric.

- If skewing does occur:
 - Ensure headrail was installed level; shim if necessary.
 - To release, insert a flat blade screwdriver into the weight lock and turn clockwise.
 - Adjust placement of weight in bottomrail, 1" at a time, toward side where fabric is gathering.
 - Secure the weight locks in position by turning them counter clockwise, after making the adjustment.
 - Raise shade, then lower, if necessary, adjust again.

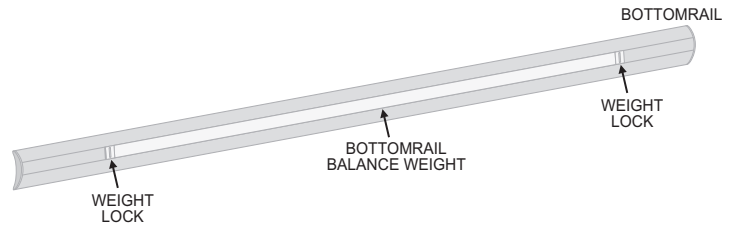

MAGNETIC HOLD-DOWN BRACKETS

Magnetic hold-down brackets secure the bottom of the shading to prevent swaying. Available upon request. Standard on tilt-only shadings.

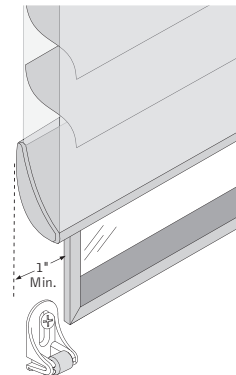

STANDARD SHADING OPERATION

STANDARD SHADING OPERATION

Referring to the illustration below.

- 1) Shading in fully raised position.
- 2) Pull down on rear half of the cord loop to lower shading and open fabric vanes.
- 3) Pull down on front half of the cord loop to close vanes and raise shading.

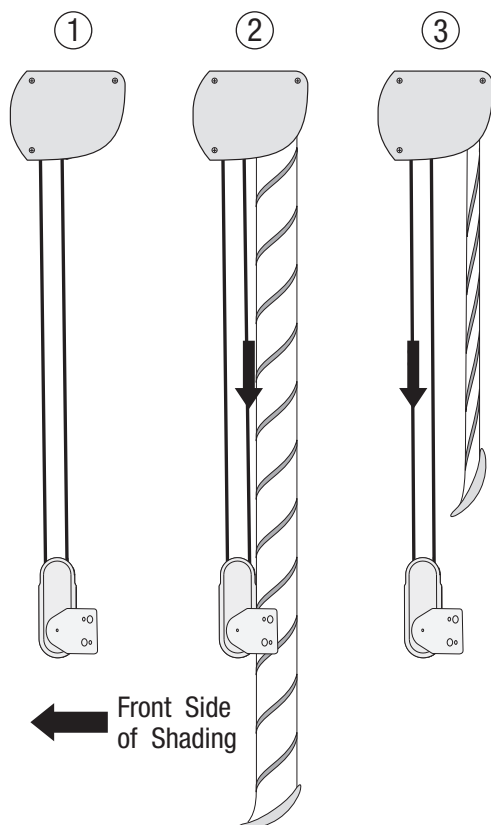

Light Control

With the shading in the fully lowered position, the cord loop is used to adjust the fabric vanes from open to closed, and anywhere in between. Light control is at your customer's fingertips. (Note: The degree of maximum vane closure varies slightly from the top to the bottom of the shading.)

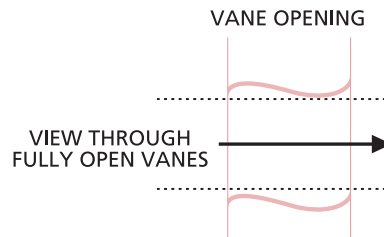

Vane Opening

Vane opening is the amount of unobstructed visibility between fully open vanes when looking through the shading at eye level. Vane opening for shadings is up to 1-1/4".

Vane Closure

When the vanes of a window shading are closed, they overlap each other, blocking the view. However, the vanes do not contact each other along the full length of the shading – they do not form a perfect seal against light leakage. This is most visible toward the bottom of the shading.

Vane closure is measured as the distance between the front and rear fabric facings 6" up from the lowest point of the bottomrail, with the shading fully lowered and the vanes closed, as illustrated here. Vane closure is 5/8" for shadings under 96" in height and 7/8" for shadings over 96" in height.

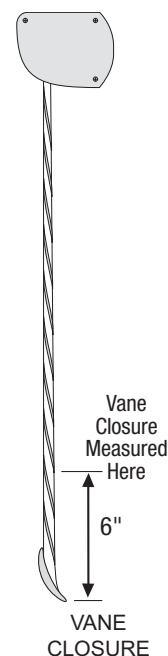

PLEASE NOTE: Cord tensioner MUST be mounted to window casement or wall in order for the shade to operate.

Cordless Operation

To Lower The Shade

- Pull down on the tassel until the shade is at the desired height.

To Raise The Shade

- Gently pull down on the tassel. To raise the shade completely, simply release the tassel and the shade will roll up fully into the headrail. To raise the shade partially, when the shade is at the desired height, gently pull on the tassel to stop the shade from raising.



Optional cordless lift control only

SIMPLICITY RECHARGEABLE MOTORIZATION: OVERVIEW

Simplicity Rechargeable

- The Rechargeable Simplicity motor program features an integrated rechargeable lithium ion battery in the motor casing and is fully concealed by the inner tube.
- Rechargeable battery is included with the motor. The average battery charge will last 6-12 months based on an average sized shade raised and lowered once per day. The life of the battery charge will vary based on the type of window covering selected, the size and weight of the window covering and the number of times the shade is operated on a daily basis. The battery can be recharged up to 500 times. It takes approximately 5 hours to recharge the motor when fully depleted. Charging port available on the right side only.

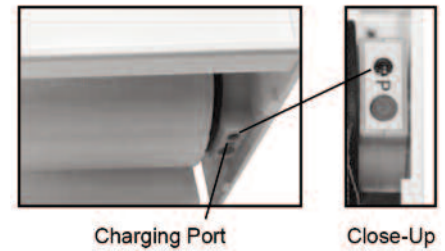

Battery Charger

- An 8.4 Volt charger requires a standard power outlet to recharge the battery. The charger must be specified when ordering Simplicity Rechargeable Motorized shade option. The charger plugs into the charging port of the motor. The charger is black and comes with a 156" wire. The dimensions are 1" wide x 2-1/2" length x 1-3/4" deep. Sold separately.



Solar Panel Recharge Option

- Plugs in to any Simplicity Rechargeable motorized shading (does not work with PowerWand). Provides constant trickle charge to 7.4v Li-ION Rechargeable battery packs. Does not require direct sunlight, but performs best in regular direct sunlight applications. Will prolong the life of the charge of the 7.4v rechargeable battery packs, and in some applications will maintain charge indefinitely.
- Life of charge is subject to application variables such as size and weight of shade, frequency of use, amount of direct sunlight exposure, etc.



Dimensions of panel
18½" x 1½"

5 Channel Remote

- The remote can operate up to five shadings simultaneously, individually or in groups. Remotes and holders are available in white or black. The remote comes with a holder which can be mounted to a wall for easy storage. The range of the remote is approximately 80 feet.



White
(Part #CS5138W)

Black
(Part #CS5138)

Please Note:

- Not all motors run at the same rate of speed.
- Simplicity motors have a "Favorites" position setting. To set a "Favorites" position, follow instructions provided in the installation instructions.

POWERWAND MOTORIZATION: OVERVIEW

PowerWand™ Motorization

- Shadings can be fabricated with the PowerWand Rechargeable Push Button Control option. The PowerWand Rechargeable option is an easy, cord free motorized operation for the budget savvy homeowner. PowerWand Rechargeable uses Simplicity motors and components.

PowerWand Rechargeable Shades Operation

- Press the up or down button on the pendant to raise or lower the shading to your desired position. No programming is required with PowerWand as upper and lower limits are set at the factory. If desired, upper and lower limits can be adjusted in the field.
- Please refer to the installation instructions for instructions on resetting the upper and lower limits and setting a favorites position can be programmed on-site.

PowerWand Appearance

- The PowerWand Rechargeable wand and pendant is attached to the head rail and requires no additional mounting.
- The wand and pendant hangs down the front of the shades from the head rail.
- Pendant is 2-1/2" long.
- The pendant does not need to be mounted to the wall to operate the shade.

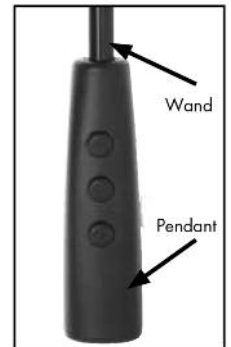

PowerWand Options

- Wand is available in Black or White (there is no default)
- Wand is available in 1 foot increments from 1 to 5 feet (there is no default)
- Wand is available on either the right or left side of the shade (there is no default)



White



Black Shown with
Plug-In Charger

PowerWand Battery Life

- The battery life will vary based on the type of window covering selected, the size and weight of the window covering and the number of times you operate the blind on a daily basis.

Battery Charger

- 8.4 Volt charger requires a standard power outlet to recharge the battery. The charger must be specified when ordering the PowerWand motorization option. The charger plugs into the charger port on the side of the pendant. The charger is black and comes with a 156" wire. The dimensions are 1" wide x 2-1/2" length x 1-3/4" deep.



PRODUCT COMPONENTS – STANDARD

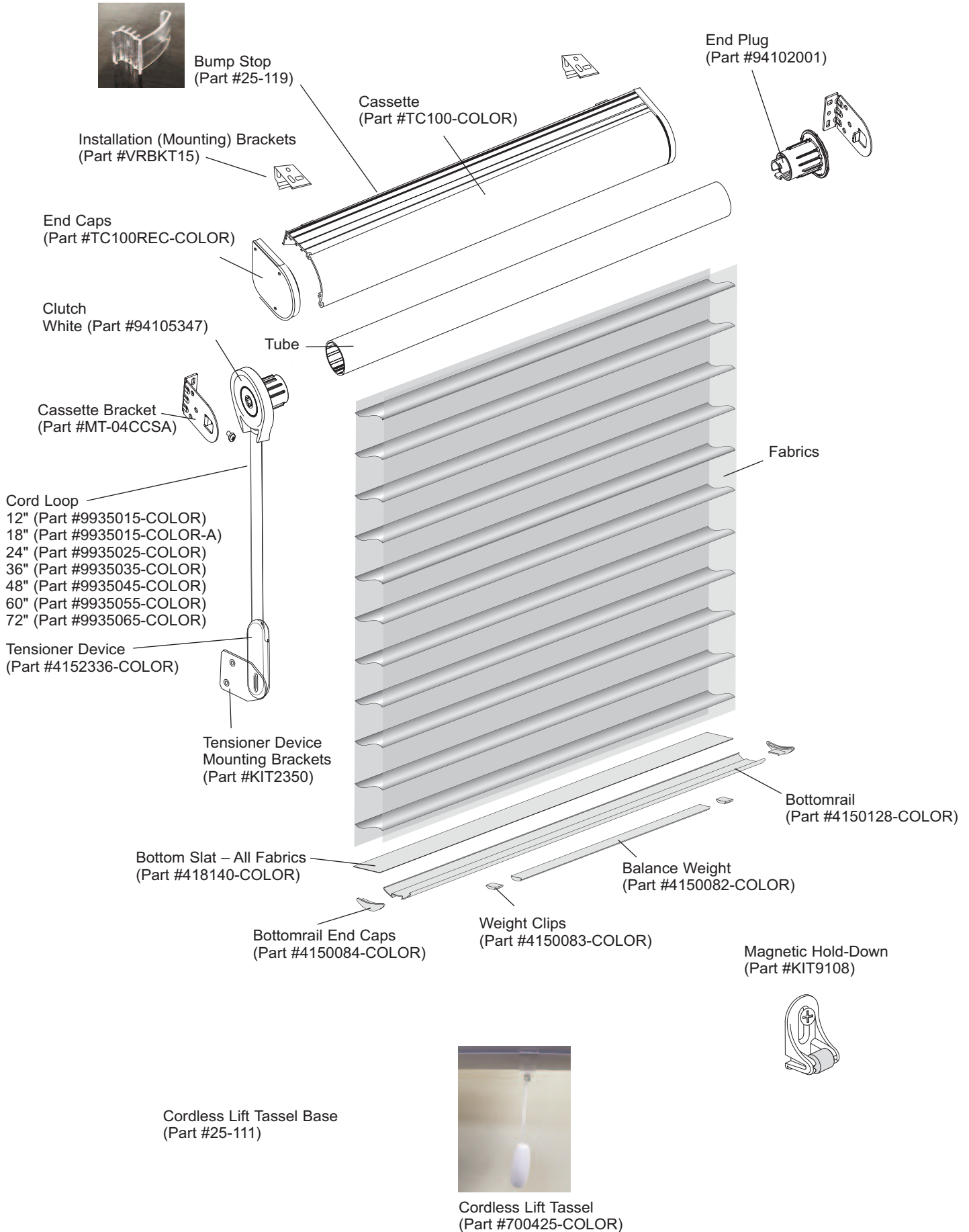

PRODUCT COMPONENTS – SIMPLICITY RECHARGEABLE MOTORIZATION

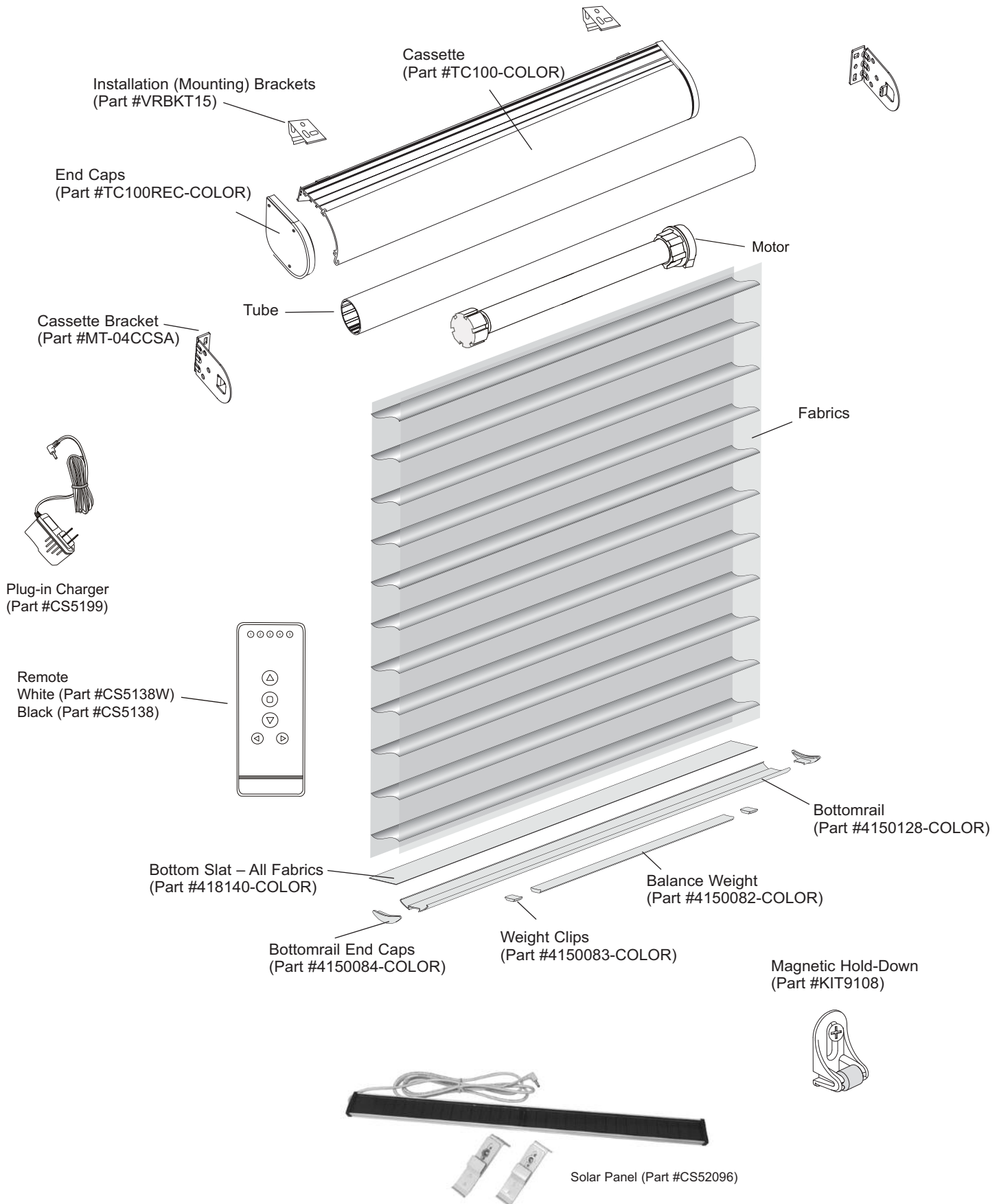

PRODUCT COMPONENTS – POWERWAND MOTORIZATION

