

SINGLE STORY STANDARD POLE BARN FORM

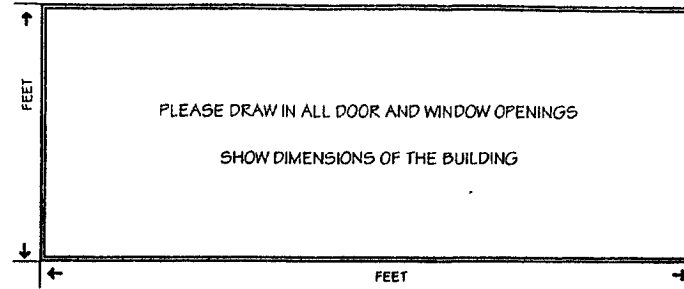
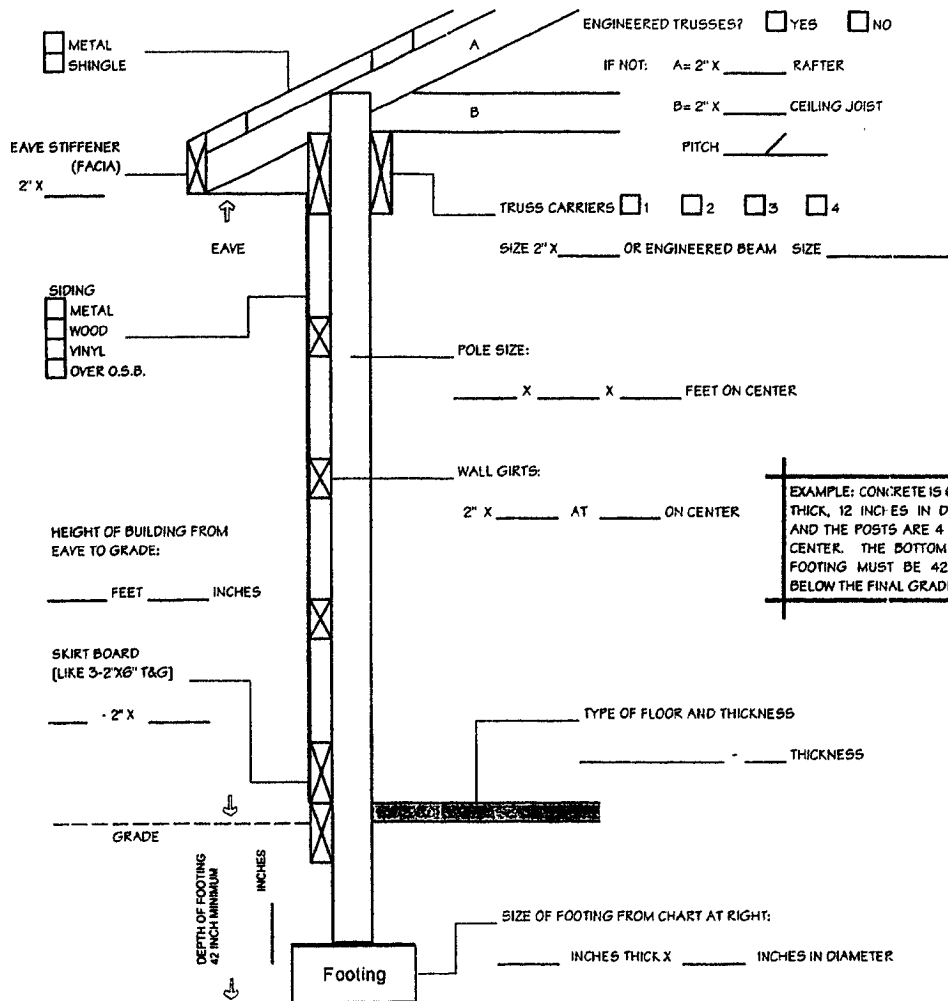

FOOTING SIZES FOR POLE BUILDINGS

THIS IS FOR 3000# PER SQUARE FOOT SOIL CAPACITY

WIDTH OF BUILDING	POLE SPACING FOR ONE STORY BUILDINGS						
	4 FEET	6 FEET	8 FEET	10 FEET	12 FEET	14 FEET	16 FEET
16 FEET	6'x12"	6'x12"	6'x14"	6'x14"	8'x16"	8'x16"	8'x18"
20 FEET	6'x12"	6'x12"	6'x14"	8'x16"	8'x16"	10'x20"	10'x20"
24 FEET	6'x12"	8'x16"	8'x16"	8'x18"	10'x20"	10'x22"	10'x22"
28 FEET	6'x12"	8'x16"	8'x18"	10'x20"	10'x22"	10'x22"	12'x24"
32 FEET	6'x12"	8'x16"	8'x18"	10'x20"	10'x22"	12'x24"	12'x26"
36 FEET	6'x12"	8'x16"	10'x20"	10'x22"	12'x24"	12'x26"	12'x28"
40 FEET	6'x14"	8'x18"	10'x20"	12'x24"	12'x26"	12'x28"	12'x28"
44 FEET	8'x16"	8'x18"	10'x22"	12'x24"	12'x28"	12'x28"	14'x30"
48 FEET	8'x16"	10'x20"	10'x22"	12'x26"	12'x28"	14'x30"	14'x32"
52 FEET	8'x16"	10'x20"	12'x24"	12'x26"	12'x28"	14'x30"	14'x32"
56 FEET	8'x16"	10'x22"	12'x24"	12'x28"	14'x30"	14'x32"	16'x34"
60 FEET	8'x18"	10'x22"	12'x26"	12'x28"	14'x30"	16'x34"	16'x36"

EXAMPLE: CONCRETE IS 6 INCHES THICK, 12 INCHES IN DIAMETER AND THE POSTS ARE 4 FEET ON CENTER. THE BOTTOM OF THE FOOTING MUST BE 42 INCHES BELOW THE FINAL GRADE.

CARRIER SIZES FOR POLE BUILDINGS

THIS CHART IS FOR SPRUCE-PINE-FIR (SPF) #1 OR BETTER DRESSED LUMBER

WIDTH OF BUILDING	POLE SPACING FOR ONE STORY BUILDINGS						
	4 FEET	6 FEET	8 FEET	10 FEET	12 FEET	14 FEET	16 FEET
10 FEET	2-2'x4"	2-2'x6"	2-2'x8"	2-2'x10"	2-2'x12"	3-2'x12"	3-2'x12"
20 FEET	2-2'x6"	2-2'x8"	2-2'x8"	2-2'x10"	2-2'x12"	3-2'x12"	4-2'x12"
24 FEET	2-2'x6"	2-2'x8"	2-2'x10"	2-2'x10"	2-2'x12"	3-2'x12"	4-2'x12"
28 FEET	2-2'x8"	2-2'x10"	2-2'x12"	3-2'x12"	4-2'x12"		
32 FEET	2-2'x8"	2-2'x12"	3-2'x10"	3-2'x12"	4-2'x12"		
36 FEET	2-2'x8"	2-2'x12"	3-2'x12"	4-2'x12"	4-2'x12"		
40 FEET	2-2'x10"	3-2'x10"	3-2'x12"	4-2'x12"			
44 FEET	2-2'x10"	3-2'x10"	4-2'x10"	4-2'x12"			
48 FEET	2-2'x12"	3-2'x12"	4-2'x12"				
52 FEET	2-2'x12"	3-2'x12"	4-2'x12"				
56 FEET	2-2'x12"	3-2'x12"	4-2'x12"				
60 FEET	3-2'x10"	4-2'x10"					

MUST BE ENGINEERED