

Block 6 LeTort Block of the Month

Cutting Directions

Color	Letter	Cut strips	Sub cut strips	Number needed
Purple	A	2 7/8"	2 7/8" x 2 7/8"	10
Blue	A	2 7/8"	2 7/8" x 2 7/8"	2
	B	3 3/8"	3 3/8" x 3 3/8"	4
Pink	A	2 7/8"	2 7/8" x 2 7/8"	4
White	A	2 7/8"	2 7/8" x 2 7/8"	12

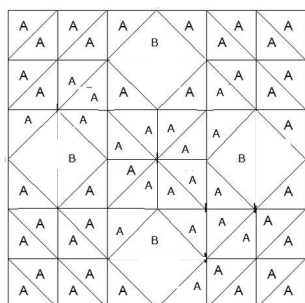

Layout Picture

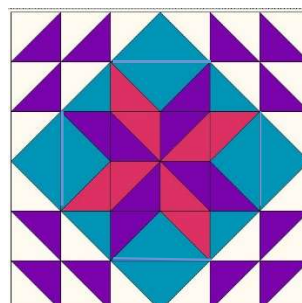

Finished Block

Directions:

Remember, all seams are 1/4".

Let's start with the half square triangles in the corners. Gather (6) (A) purple and (6) (A) white squares. Draw one line diagonally on each white fabric. Stitch 1/4" away on both sides of the drawn line. (Step 1). Cut on the drawn line and press to the dark side. Trim to 2 1/2". You will have 12 half square triangles when you are finished.

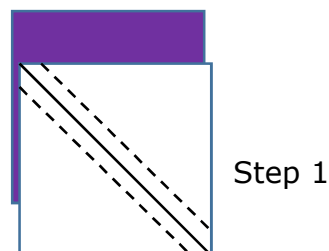

Step 1

Let's do the same process again, this time using (2) (A) blue and (2) (A) white. Step 2. You will have 4 half square triangles.

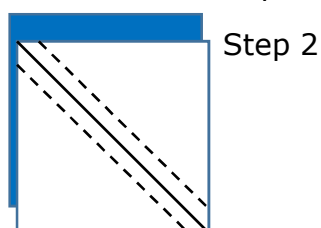

Step 2

Block 6 LeTort Block of the Month

Now, with confidence, grab (2) (A) purple and (2) (A) pink and repeat the process one last time. Step 3. You will have 4 half square triangles.

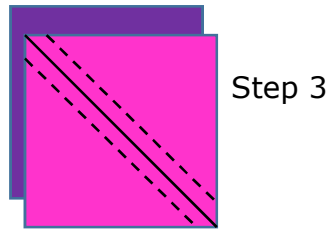

Last section, gather the (4) (B) blue, the (4) (A) white, the (2) (A) purple and pink. Take the (A) pieces and spray with starch or sizing and press (this is important). Cut all the (A) pieces on the diagonal once. Lay the pieces out as seen in Step 4 below. You will have 4 square in a square.

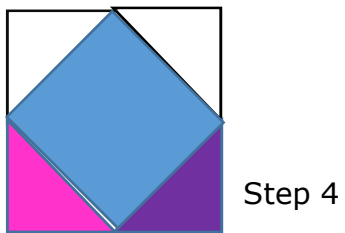

Sew the pink and then the opposite white, press open and repeat with the purple and the white; then press. (Secret: you can sew the purple first and then the opposite white. It does not matter as long as you do opposite sides).

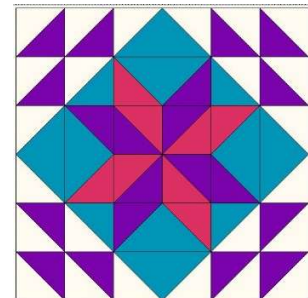

Putting it together: lay out the pattern and sew together.