

Soils Map

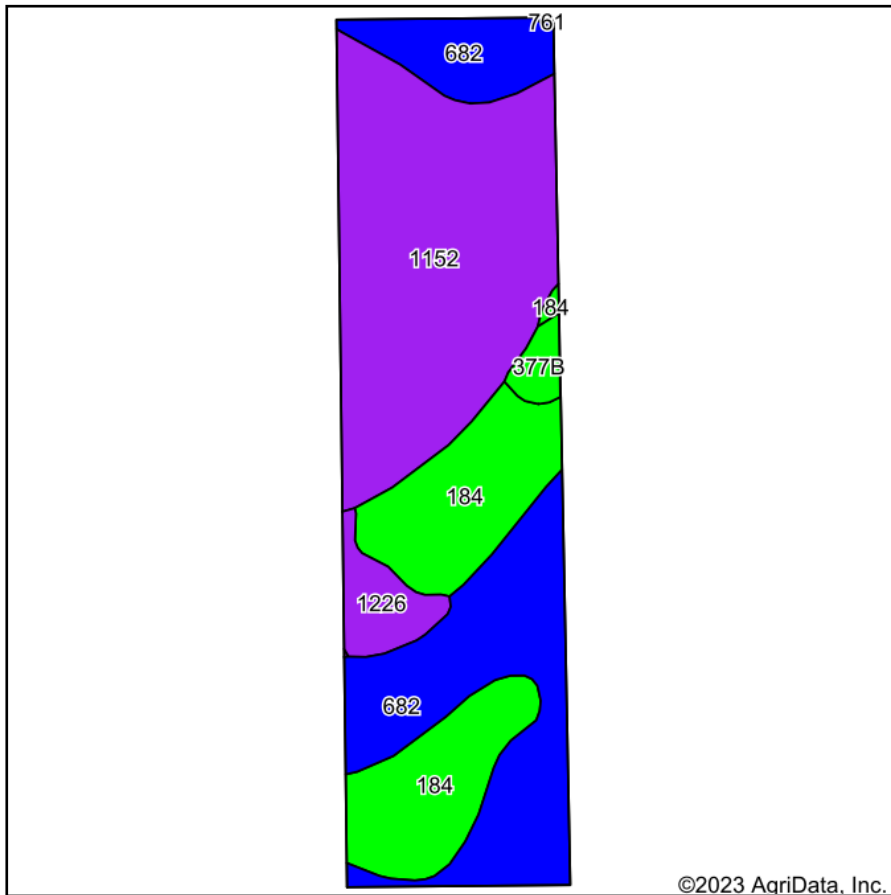

Soils data provided by USDA and NRCS.

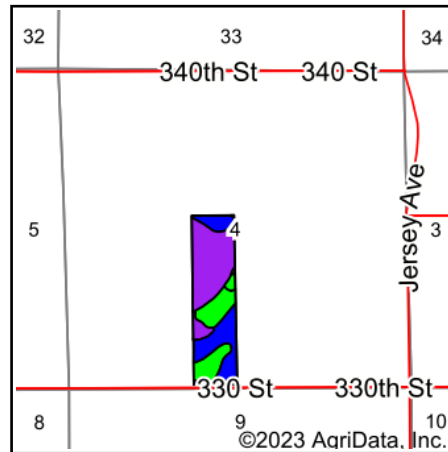

State: **Iowa**
 County: **Mitchell**
 Location: **4-97N-17W**
 Township: **Cedar**
 Acres: **39.24**
 Date: **4/20/2023**

Maps Provided By:

 CUSTOMIZED ONLINE MAPPING
 © AgriData, Inc. 2023 www.AgriDataInc.com



Area Symbol: IA131, Soil Area Version: 28

Code	Soil Description	Acres	Percent of field	CSR2 Legend	Non-Irr Class *c	CSR2**	CSR	*n NCCPI Soybeans	
1152	Marshan clay loam, 0 to 2 percent slopes, rarely flooded	15.71	40.0%		llw	54	66	60	
682	Maxfield silt loam, 0 to 2 percent slopes	11.85	30.2%		llw	83		65	
184	Klinger silty clay loam, 1 to 4 percent slopes	9.39	23.9%		lw	95	93	82	
1226	Lawler loam, 0 to 2 percent slopes, rarely flooded	1.63	4.2%		lls	59	70	60	
377B	Dinsdale silty clay loam, 2 to 5 percent slopes	0.66	1.7%		lle	94	88	74	
Weighted Average						1.76	73.4	*-	*n 67

**IA has updated the CSR values for each county to CSR2.

*- CSR weighted average cannot be calculated on the current soils data, use prior data version for csr values.

*n: The aggregation method is "Weighted Average using all components"

*c: Using Capabilities Class Dominant Condition Aggregation Method

Soils data provided by USDA and NRCS.