



Giles County
Public Library



Main Branch, Pulaski

122 South Second Street

Pulaski, TN 38478

(931) 363-2720

Elkton Branch

110 Main Street

Elkton, TN 38455

(931) 468-2506

Lynnville Branch

105 Mill Street

Lynnville, TN 38472

(931) 527-0707

Fax: 931-424-7032

www.gilescountylibrary.org

glibrary@gilescountylibrary.org

Facebook: Giles County Public Library

Leadership

My family has been a part of this community and county for many years. We have both witnessed and participated in numerous changes that have taken place during that time. As a result of the efforts and leadership of many, Pulaski and Giles County have progressed and grown. One of the most important community organizations that needs our help, our support, encouragement, AND our financial support is the Giles County Public Library. In the pages that follow you will learn and hear from your friends and neighbors about why the library is so important – and why this campaign is critical to not only the library's future, but to our collective future as a city and county. I urge you to consider how you can help and hope that you will invest as generously as possible in support of **Growing Forward Together: Investing in Our Community's Future.**



Brenda S. Speer
Campaign Chair



Joe Lester
Honorary Co-Chair

To survive and thrive, special places like Pulaski and Giles County must have a dynamic library – a place to gather, a place to impact citizens of all ages, and a place to help secure a bright future for our citizens. Growing up in this community and having access to such a place meant everything. We can vividly recall the helpful staff, the abundant resources, and the place where the community came together. One of our fondest memories was attending kindergarten at the library. It truly was our foundation for learning. Today, we must come together again to demonstrate our belief that the Giles County Public Library is worthy of the investment needed to enhance the facility. It is such a wonderful privilege to come home again and rekindle very fond memories of a community that gave us so much. We invite you to join us and many others by investing in our library's future.



Sally Stephens Bergquist
Honorary Co-Chair



Cindy Nesbitt
Library Director

There is no doubt in my mind that the Giles County Public Library makes a positive difference in our community. We would surely be diminished without the materials, programming, access to the Internet, a genuine gathering spot, and so much more that the library provides. Our facility is in need of an update. For the growth we are experiencing as well as what we know is around the corner, this campaign is necessary to live out our mission. My hope is that the community will come together and invest in the library. Doing so is a reflection of your generosity and your belief in our future.



Giles County Public Library

*Acting as a focal point for the cultural and literary life of Giles County,
the Giles County Public Library is dedicated to providing all citizens
the best in library and outreach services.*

- Giles County Public Library Mission

Our mission is our vision. Beloved and valued by our many patrons across the county, the Giles County Public Library is a focal point for our community. Our goal is to enhance our collections and resources, our programs, and our facilities. To this end we believe it is imperative to embark upon an ambitious journey in which we make substantial improvements to the library building. This investment is essential to meet the needs of the community for the years ahead. Our growth is not necessarily in the size of our facility but rather in what we provide to the community.



**Growing Forward Together:
Investing in Our Community's Future
The Campaign for the Giles County Public Library**



The Challenge Before Us

Over the past few years we have identified and prioritized several critical needs that must be addressed and ones in which we hope your support will enable us to reach our goals in a timely manner. Specifically, there are three major initiatives, and we must focus our efforts on their completion.

**Priority One:
Health and Safety**

**Priority Two:
Facility and Sustainability**

**Priority Three:
Service and Technology**

Your support and commitment to this campaign will help ensure a bright future for our library and for our community.



"I am a frequent patron of the Library because of the wonderful resources and programs provided to our community. Our Library attracts patrons from across the county because of such events and programs like the quarterly teas, literary programs, availability of best selling books and popular DVD's, and generous access to Wi-Fi and computer stations. And it is a gathering place where you can visit with old friends and meet new ones."



Karen Spivey

Health and Safety

The health and safety of our library patrons as well as our staff is critically important. The ability to safely use the resources and participate in programs is an essential element to our patrons. And the opportunity to work in such an environment is necessary for our staff to thrive.

Replacing the Roof

The first challenge that we must meet is the replacement of the roof. The current roof is over twenty-four years old. As a flat roof, it should not allow standing water and associated problems. However, it has passed its effective lifetime and is overdue for major maintenance to prevent rainwater from pooling and leaking into the library building. The roof's poor condition translates into significant leaking in the exterior walls. Inadequate drainage is adding to this problem because it is putting extra weight on the roof, which no longer meets code requirements and poses a potential safety risk.

The solution that we believe is the only way to provide a long-term answer is to replace the roof with one that slopes. There is no question that making this investment is the most cost-effective option. The new roof will last for decades, prevent water from collecting, and ensure future repairs will be much easier and less costly. Any temporary fix is just that – and that is something we should not seriously consider. Another benefit to replacing the roof will be a reduction of both heating and cooling costs. This will occur because replacing the roof allows us to install new insulation, which will in turn save money. This solution eliminates leaks, enhances safety, and provides for a reduction in heating and cooling expenses – over both the short and long term.



Replacing HVAC System

The second challenge under the category of health and safety is the HVAC system.

Three different air conditioning units operate in the building and each is controlled by three separate thermostats routed to different areas of the library via a labyrinth of separate air ducts. As a result problems are not detected until they become critical. When one goes down, the others must counterbalance by working harder while the faulty unit wastes resources. The operation of this “system” is very costly when compared to larger, more efficient units available today. This duct work needs cleaning with the understanding that it may need to be replaced.

The solution to these challenges is clear and will result in greater efficiency and productivity as well as drastically reducing health concerns. We need new units that are controlled by Energy Star rated programmable thermostats.

The benefits of installing the new units would address all-important cost savings that will result from a more efficient new system.



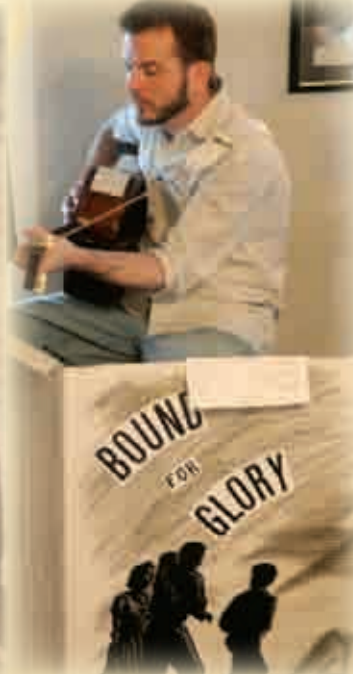

Facility and Sustainability

Improving the Lighting

The lighting currently in use is fluorescent fixtures that are inefficient and cause eyestrain. These lights are especially a problem for our older patrons.

The solution is to replace the existing fluorescent lighting with new suspended direct/indirect fluorescent fixtures. In addition the library must install a master light control, as well as motion sensors in the restrooms, office areas, and storage rooms. Also needed is the installation of lighting fixtures in front of the library.

This vastly improved lighting will provide numerous benefits. The hanging, diffused indirect lighting will be less of a strain on the eyes while improving light dispersion that will result in a more enjoyable reading experience for patrons. In addition the new lights will upgrade the appearance of the interior by lighting the ceiling and tops of the walls. The increase in energy efficiency is an impressive 75% meaning the investment in the new lighting will produce a total return on investment in less than three years.

The new master light control will simplify opening/closing procedures for staff and ensure that only emergency lighting remains on when the building is closed. Motion control sensors in seldom-utilized areas will ensure that lights are on only when people are present. Exterior lighting will improve the library's appearance and cause it to stand out at night.



Phyllis Owens

“For over 200 years, public libraries across the country have been respected and utilized by the communities they serve. Public libraries provide the availability of free education for all, representing the collective commitment of a community to their future. They symbolize what is most important – a commitment to educating our next generation. I know my children will benefit from the welcoming learning experience at our library.”



Repairing the Plumbing

Infrastructure problems continue with the library's plumbing. It has fallen into disrepair and it will require considerable work. For a number of years the plumbing problems have been resolved by temporary, inexpensive fixes.

The library's sump pump, a device used to remove water that has accumulated in a water-collecting sump basin, in the library's basement, has completely rusted.

The solution is to replace the pipes and ensure they are properly supported to allow for adequate drainage. The sump pump must be replaced. The benefits of having proper water flow will result in fewer and less costly repairs and cause fewer disruptions to library operations.



Enhancing the Exterior

An inviting, welcoming outside appearance should reflect the great collections, programs, and services found on the inside. The Giles County Public Library is a focal point for the city and county but this is not clearly communicated by the library's exterior. The white brick has faded as the result of over three decades of accumulated dirt and vehicle exhaust and truly does not reflect the vibrant community within.

The solution is simple and straightforward. The exterior must be pressure washed to provide a thorough cleaning of the brick. There will also be places that must be repainted where the paint has faded or chipped away. To protect the exterior walls a spray-on sealant must be applied. In addition, the streetscaping plants will be trimmed or removed and replaced with new plants.

Finally, the library's new logo and branding through signage will complete the aesthetics ensuring quality throughout.

The improvements to the library exterior provide enormous benefits. Not only will these improvements be more visually appealing but they will provide a level of protection not seen in many years. For example, the sealant will prevent moisture from entering the building and keep the exterior looking new and clean for decades.

Replacing Windows and Doors

Energy efficiency is a theme of this campaign and that includes windows and doors. Current conditions mandate that window blinds be completely closed to prevent sunlight from fading books and heating the building. The solution calls for the replacement of the windows with aluminum storefront windows that contain insulated glass. These new windows will require some tinting to block intense sunlight. Replacing the front entry doors will also improve building insulation.



As with all improvements described elsewhere, there are important benefits that result from these changes. Insulated, tinted windows will reduce heating and cooling costs while improving reading conditions. While precise savings are difficult to calculate, experts describe the savings as sizeable.

Enhancing the Floors

Having been installed about twenty-five years ago the carpet is worn out, stained, and water damaged as a result of the leaking roof. We have determined that the best solution is to replace the carpet with new carpet tiles. The children's, teen, and media rooms will have colorful carpet tiles. The front entrance as well as the circulation desk area will have hard porcelain tiles.

The benefits of these changes include the flexibility to clean and replace individual sections when and where necessary. They also allow for creativity with different patterns and color schemes. Combined with new paint, these areas will be set apart from other areas allowing for better navigation for patrons. The flooring in the high traffic areas of the entrance and circulation desk will last far longer than carpet.

Replacing the Furnishings

Comfort, appearance, and functionality all play an important role in the library's furnishings. Over time all three have been sacrificed where today there are no comfortable gathering places where teens can curl up with a book or parents can read to their children.

The solution is to refurnish areas of the library with a new sofa for the children's area; a gathering space for teens to meet with friends and enjoy coffee; age appropriate décor for the juvenile room; and comfortable seating in our adult reading area. These additions provide numerous benefits for our patrons. The children's room additions will encourage parent/child reading, which in turn further children's literary skills and desire to read. This will increase overall patron use and reinforce the library's desire to be an inviting and friendly environment available to everyone.



Service and Technology

Enhancing the Layout

The library's floor plan is dated and no longer serves our programmatic or technology needs. There has been little reorganization in about twenty-five years. The main floor is inadequate for the large crowds who attend the "Tea and Talk" programs. Preparation for events such as these must occur in the cramped break area. Office area lacks room for the full-time librarians and part-time library aides. The break room has no space for staff program planning or storage for new books and materials as they are being prepared for circulation.

The layout is a major challenge, and the solution will require it to be professionally designed in order to make the most out of very limited space. The layout directly impacts our ability to support collections, programs, patrons, and staff.

Reorganization of the space will mean important benefits for everyone who cares about the library's future. These changes to shelving and surrounding areas will allow the library to have larger audiences for a variety of events, including teas and author experiences.



"Giles County is very fortunate to have a strong and visible public library. From its beginning the library has served as a beacon for all the people of our county to enjoy. The presence of a strong public library is vital to our growth. The well being of Giles County is integrally linked to a public library with a visionary plan for the challenges of the 21st century. I am honored to have served as a member of the Library's Board of Trustees for almost twenty years."



Bill Rutherford

Improving DVD Storage and Checkout

The checking out and in of the library's DVD collection is one of the most time-consuming activities of all work done at the circulation desk. Peak hours may cause the desk to be unattended while staff is transferring DVDs, leaving patrons to wait at a deserted desk.

The solution to this issue is to add a self-checkout station that stores and dispenses 600 DVDs with additional compact storage devices located behind the circulation desk. These devices will be extremely helpful in streamlining daily circulation operations.

"The Giles County Public Library has been a valued and important part of our lives for many years. The resources have increased over the years and I am grateful from the abundance of materials and the warm and friendly staff."



Georgia Ude





These new devices will completely remove the need to seek out and transfer DVDs into new cases by dispensing discs almost immediately after being checked out. The benefits include decreasing wear and breakage of the DVDs by reducing handling of the discs. In addition, desk staff is freed up and can focus on assisting patrons and other tasks that need attention.

While many libraries have switched to expensive Radio Frequency Identification (RFID) systems, this device is more secure and less time consuming to implement. The efficiency of the device even enhances our ability to spread out the circulation desk staff to cover more hours or other tasks. This is a more useful way to utilize staff time by allowing them to better focus on other priorities.

Acquiring Early Literacy and Children's Computers

The library does not have any children's computers and, as a result, many children utilize patron computers in order to play on the Internet. Unfortunately, these games are not educational and can expose public computers to security vulnerabilities. Our solution is to install an Early Literacy Station in the Children's Room. This station is an automatically configured, child-friendly computer loaded with more than fifty educational games.

Promoting children's literacy is an important benefit and an issue on which the library is focused. These new stations will be a helpful ally in this effort. Having these computers will also free-up computers for other library patrons.

Reorganizing the Computer Room

The area for patron computer use is completely filled with ten computers and desks and allows almost no room to maneuver. Because of these crowded conditions there is no access for wheelchairs. The cramped space also makes privacy a concern.



The solution is included in the reorganization plan of the main floor and calls for a repositioning and improved use of space. The benefits will be the increase in privacy, giving patrons additional personal space when the computers are rearranged. The construction of new desks will ensure the computers are compliant with the Americans with Disabilities Act.

Replacing Computers

Computers play an important role in the accessing of resources, use of the Internet, and the operation of the library. They are expensive and require considerable funds to keep current. With three library branches to maintain, we are not winning that battle. Five computers need to be replaced this year, including three used by the circulation staff.

The solution is to replace these computers as well as add one for the branch in Elkton and one at the branch in Lynnville. One of the many ways libraries continue to have an impact on the communities they serve is by providing computers that include multimedia software for editing videos, audio, and photos. One of the new computers needed will include this software and be powerful enough to handle the Adobe suite of software.

The benefits will be significant. Computers being replaced may also be used as dedicated Search Stations, replacing even older computers.

We are asking for your support, your commitment, and your investment for the future of our library and the future of our community. The Giles County Public Library is in many ways the heart of our community. We attract and serve a cross-section of the public, all ages, all day long, and all across our city and county. This library is worthy of your investment. Together, we can go forward by growing forward.



Ways to Give

The Giles County Public Library welcomes and appreciates gifts of all sizes. Your generosity is an investment in the future of our library and our community. We are pleased to offer a variety of ways in which you can support this campaign. We recommend that donors consult with their financial advisors before finalizing a contribution regarding the tax deductibility of gifts.

Gifts of Cash

Many donors choose to make gifts of cash (check, Visa, MasterCard, money order, bank draft, and currency). Such gifts to the Giles County Public Library are tax deductible if the donor itemizes their deductions.

Pledges

Pledge payments to the campaign may be spread over three years to allow and encourage donors to make larger commitments and complete them over a multi-year time frame. Of course contributions made on a different time-table are welcome. We will be glad to work this out with you.

Gifts of Securities

Donors who choose to give appreciated securities can receive a charitable tax deduction for the full market value of the securities and avoid capital gains tax if the donor has owned the asset for at least one year. To avoid the capital gains tax you must provide the securities themselves, not the proceeds of their sale. These gifts may be deducted at fair market value on the date of transfer to the Giles County Public Library.

Additional Giving Options

In addition to the options identified above, the campaign offers donors other ways in which to support this campaign. These include:

- Gifts of Real Estate
- Retained Life Estate
- Memorial or Honorary Gifts
- Gifts of Retirement Plan Assets
- Matching Gifts
- Bequest
- Gifts of Life Insurance
- Endowment

GIVING LEVELS:

The Chairman's Circle.....\$50,000+
Hemingway..... \$25,000-\$49,999
Faulkner \$10,000-\$24,999

Kipling\$5,000-\$9,999
Steinbeck..... \$1,000-\$4,999
Morrison\$100-\$999
Buck..... \$1-\$99



Your Investment is the Key

Please be as generous as possible. Someone's future is counting on you!

The Investment needed is outlined below.

Priority One: Health and Safety

Roof replacement	\$55,000
Five-year warranty extension.....	\$2,400
Rental of two storage pods.....	\$3,000
Plumbing, drain pipe, and sump pump replacement.....	\$10,500
HVAC, air duct, ceiling tile, and interior lighting	\$211,000

Priority Two: Physical Plant and Sustainability

Flooring replacement, wall repair and repainting;.....	\$80,000
exterior wall pressure washing, painting, and sealing	
Landscaping	\$5,000
Window and door replacement.....	\$29,300
Remodeling office, purchasing and installing	\$1,000
appliances for basement kitchen	
Erecting privacy wall; rerouting network cables.....	\$3,500

Priority Three: Service and Technology

DVD storage and checkout	\$19,500
Early Literacy Station.....	\$3,300
Rearranging patron computer stations for ADA;	\$500
building new computer desk	
Replacing outdated computers.....	\$6,000

Priority Four: Endowment

Creation of an endowment for facility maintenance.....	\$70,000
--	----------

TOTAL INVESTMENT NEEDED..... \$500,000

The library has been integral part of my life ever since the weekly visits to story hour as a young child. My experiences with the library helped spark a love of reading that led to my profession as a reading teacher. In that position I continue to receive support from the library's many resources. The Children's Summer Reading Program has evolved since my childhood days. Its magic captivates my daughters, and I can always find new worlds to explore through books. We are blessed to have this accessible and wonderful resource for our community!



Laura Jane Reynolds

Named Gift Opportunities

The Growing Forward Together campaign offers our donors numerous opportunities to make a special commitment and be recognized for extraordinary generosity. There are several opportunities to name spaces within the library. Your commitment may be made on a permanent basis or you may choose to name the space for a period of ten years. At the completion of this time period you may renew your commitment, make your commitment permanent, or decide not to renew your commitment. Below is a list of spaces that may be named with investment needed for both the permanent and ten-year commitment:

Room/Area	Permanent Amount	Ten-Year Amount
1. Computer Room.....	\$50,000.....	\$30,000
2. Reading Area/Commons	\$50,000.....	\$30,000
3. Fiction Area (Adult).....	\$50,000.....	\$30,000
4. Circulation Area.....	\$50,000.....	\$30,000
5. Administrative Area.....	\$25,000.....	\$15,000
6. Director's Office	\$25,000.....	\$15,000
7. Community Room.....	\$25,000.....	\$15,000
8. Non-fiction (Adult)	\$25,000.....	\$15,000
9. Juvenile Fiction Area.....	\$15,000.....	\$10,000
10. Meeting Room/Reference.....	\$15,000.....	\$10,000
11. Teen Room	\$15,000.....	\$10,000
12. Landscaping	\$15,000.....	\$10,000
13. Western Collection	\$5,000.....	\$2,500
14. Romance Collection	\$5,000.....	\$2,500

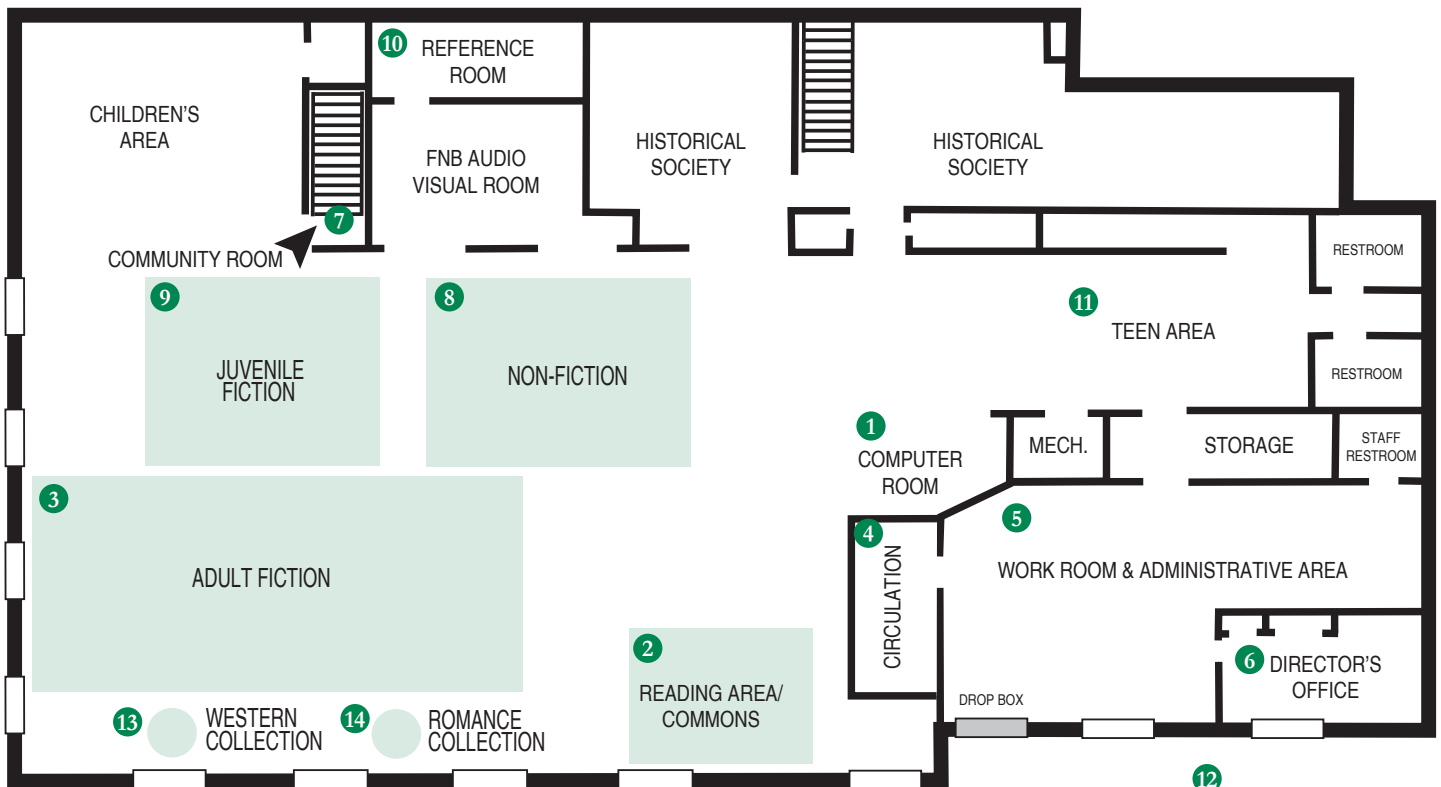

**Giles County Public Library
Growing Forward Together Campaign Committee**

Brenda S. Speer, Campaign Chair
Sally Stephens Bergquist, Honorary Co-Chair
Joe Lester, Honorary Co-Chair

Preston Murrey
Cindy Nesbitt
Claudia Oakes
Karen Spivey

Giles County Public Library Board of Trustees

Preston Murrey, Chairman
Carolyn Harrison, Treasurer
Joyce Wood, Secretary

Bill Blair

Marcus Houston
Claudia Oakes
David Rackley
Bill Rutherford
Brenda S. Speer
Karen Spivey
Alice Trimble

Giles County Historical Society Board of Directors

Malinda White, President
Sam T. Collins, Vice President
Robert H. Wynne, Treasurer

Mary Funk, Secretary
George W. Newman

James Puryear
Bill Rudd

Robert R. Womble

