

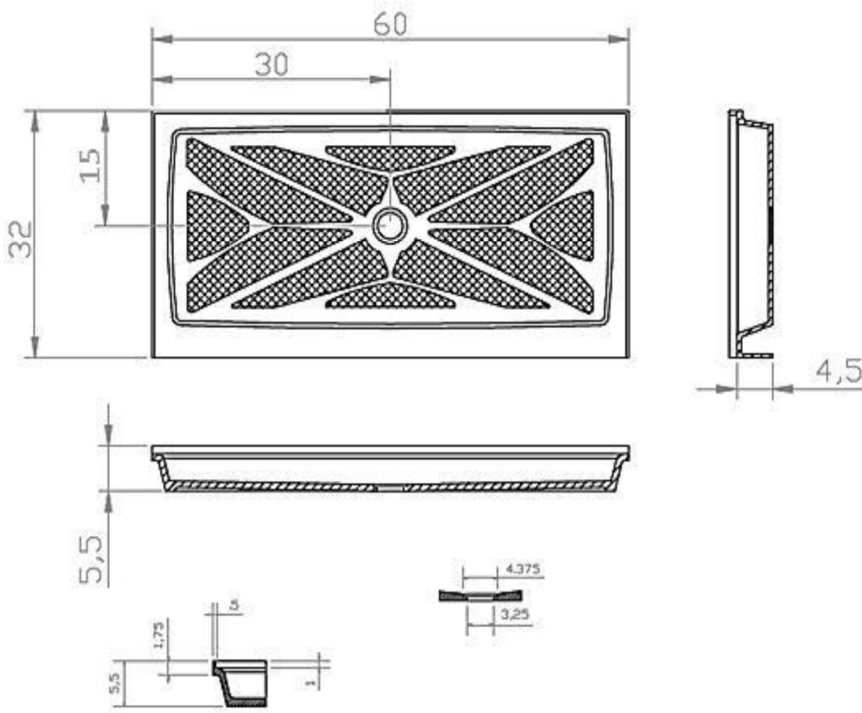

# SP-4310



### Standard Features:

- Solid one – piece construction.
- Pre leveled rests on subfloor.
- Mold and mildew resistant.
- Bacteria resistant.
- Textured non - slip finish.
- Abrasion resistan gelcoat surface.

### Specifications:

- Size: 32" x 60" size.
- Drain: Center 15-30.

NOTE: In the casting process slight shrinkage in length will occur 1/8" - 1/2"

[www.ffeinternational.ca](http://www.ffeinternational.ca)

660 Mgr Dubois, Suite 100, Saint-Jérôme, Québec J7Y 3L8

☎ (450) 990-2002

☎ (450) 432-3383