

WEEP SCREED

Information

The following information was taken from the 1997 Uniform Building Code: This is the same requirement in the new 2008 Code.

2506.5 Applications of Metal Plaster Bases. The application of metal Lath or wire fabric lath shall be as specified in Section 2505.3 and they shall be furred out from vertical supports or backing not less than ¼ inch (6.4mm) except as set forth in Table 25-B, Footnote 2.

Where no external corner reinforcement is used, lath shall be furred out and carried around corners at least one support on frame construction.

A Minimum 0.019-inch (0.48 mm) (No. 26 galvanized sheet gage) corrosion-resistant weep screed with a minimum vertical attachment flange of 3 ½ inches (89 mm) shall be provided at or below the foundation plate line on all exterior stud walls. **The screed shall be placed a minimum of 4 inches (102 mm) above the earth or 2 inches (51 mm) above paved areas and shall be of a type that will allow trapped water to drain to the exterior of the building.** The weather-resistive barrier shall lap the attachment flange, and the exterior lath shall cover and terminate on the attachment flange of the screed.

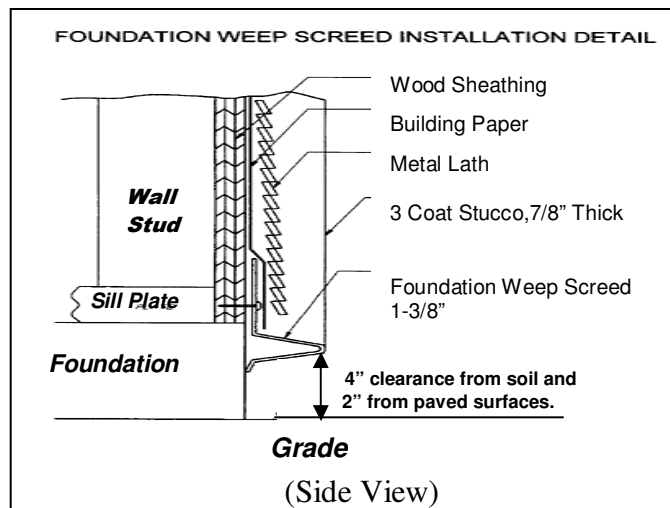

Proper clearance from Weep Screed at left side of house.



Corroded Weep Screed due to soil contact and sprinkler spray.



Weep Screed inappropriately covered with concrete flatwork.



**Further information regarding Weep Screed installation and Site Requirements can be found in the Uniform Building Code and/or from your local building department. A standard home inspection is not a CODE inspection.



Brought to you courtesy of...
(949) 275-4950

26741 Portola Parkway, 1E-469, Foothill Ranch, Ca 92610

20/20
Advanced
Property & Mold
Inspections