

Oak ES Construction Phasing

PHASE 1 Oct 10 - Mar 3 = 5 Months
Bldg. B, Classrooms 10 - 19

PHASE 2 Mar 6 - May 5 = 2 Months
Classrooms 4, 6, 7, 8, 9, & Library

PHASE 3A May 8 - Nov 31 = 6 Months

Admin. Rooms, Bldg. C, Corridors, Teacher Parking, Courtyard, Bungalows 22 & 23, Restroom 2, & Ramps

PHASE 3B Classrooms 1, 2, 3, & 5, and Perimeter Fencing

Total = 13 Months

SITE LEGEND

- PROPERTY LINE
- (Hatched pattern) (E) BUILDING TO BE SOUND MITIGATED
- (Dotted pattern) (E) COVERED ARCADE / WALKWAY

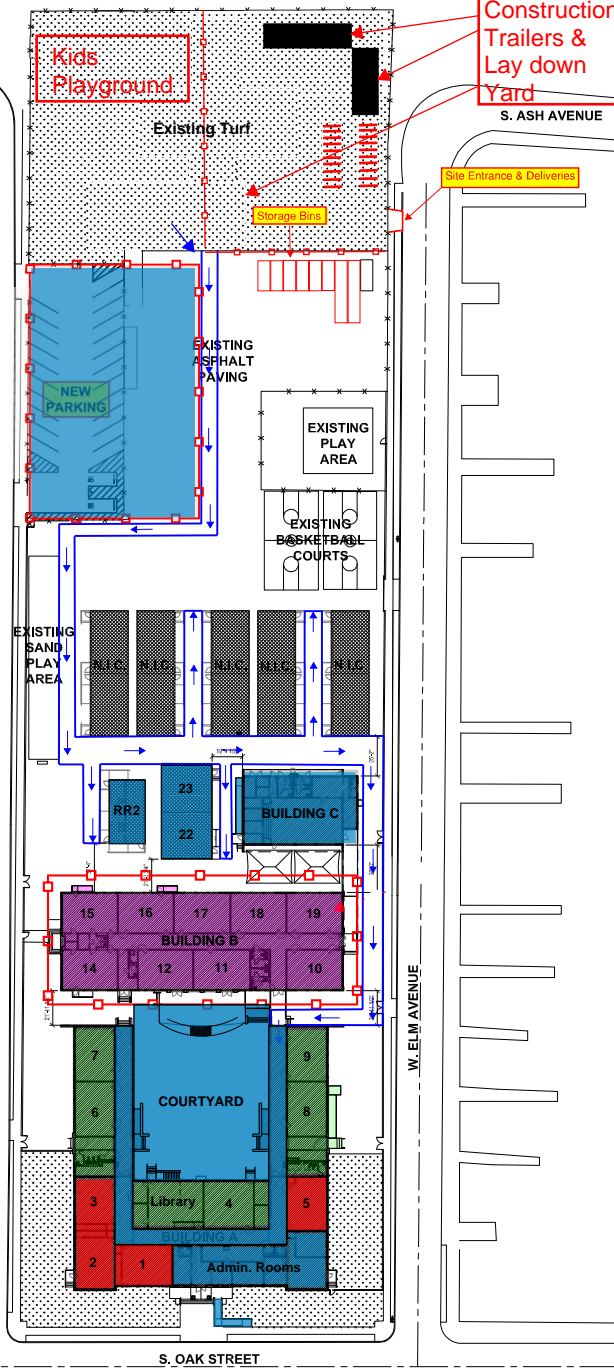

Construction Trailers & Lay down Yard

PROJECT DATA AND CODE ANALYSIS

1. OCCUPANCY AND CONSTRUCTION TYPE

1- OCCUPANCY GROUPS (PER CBC SECTION 302)

GROUP #2 ASSEMBLY * CAFETERIA / MULTISE AREA
 GROUP #3 LIBRARY
 GROUP #5 EDUCATION AND ACCESSORY FUNCTIONS
 GROUP #6 EDUCATION AND ACCESSORY FUNCTIONS

2- TYPE OF CONSTRUCTION

TYPE VB CONSTRUCTIBLE

3- BUILDING DATA

1- BUILDING A (E) 1 STORY ADMINISTRATION, CLASSROOM AND BUNGALOW BUILDING

OCCUPANCY GROUP A3 / B / E
 CONSTRUCTION TYPE VB, NONSPRINKLERED
 BUILDING HEIGHT (E) 10'0" / 0
 GROSS BUILDING AREA (E) 14,158 SF
 COVERED AREA (E) 2,110 SF
 SUBTOTAL (E) 15,268 SF

2- BUILDING B (E) 1 STORY CLASSROOM BUILDING

OCCUPANCY GROUP E
 CONSTRUCTION TYPE VB, NONSPRINKLERED
 BUILDING HEIGHT (E) 20'0" / 0
 GROSS BUILDING AREA (E) 11,246 SF
 COVERED AREA (E) 482 SF
 SUBTOTAL (E) 11,728 SF

3- BUILDING C (E) 1 STORY MULTISE BUILDING

OCCUPANCY GROUP A2
 CONSTRUCTION TYPE VB, NONSPRINKLERED
 BUILDING HEIGHT (E) 14'0" / 0
 GROSS BUILDING AREA (E) 13,154 SF
 COVERED AREA (E) 791 SF
 SUBTOTAL (E) 3,915 SF

4. ALLOWABLE AREA, NUMBER OF STORES AND BUILDING HEIGHT

4- ALLOWABLE BUILDING HEIGHT, STORES, AREA (PER CBC CHAPTER 5)

OCCUPANCY TYPE	CONSTRUCTION TYPE	MAX ALLOWABLE STORES	MAX ALLOWABLE AREA PER STORY (SQ)	MAX ALLOWABLE HEIGHT PER STORY (FT)
A2	TYPE VB	1	40	5,000 SF
A3	TYPE VB	1	40	5,000 SF
B	TYPE VB	2	40	5,000 SF
E	TYPE VB	1	40	5,000 SF

2- BUILDING AREA MODIFICATION CALCULATIONS

AUTOMATIC SPRINKLER INCREASE: NOT USED - ALL BUILDINGS HAVE OPEN SPACE > 30' FRONTAL PORCHES

IF $(P + 0.25) > 0.75$
 $(P + 0.25) + 0.003 > 0.75$
 $A_2 = (A_1 - (A_1 \times P)) + (A_1 \times P)$

AREA INCREASE FOR BUILDING A, USE OCCUPANCY (A3)

$A_2 = (5,000 - (5,000 \times 0.75)) + 10,500 SF$
 $BL'P + BL'W = 1,190 + 2,881 = 971 SF \gg (OK)$

AREA INCREASE FOR BUILDING B, USE OCCUPANCY (E)

$A_2 = (5,000 - (5,000 \times 0.75)) + 10,750 SF$
 $BL'P + BL'W = 619 + 547 = 206 SF \gg (OK)$

AREA INCREASE FOR BUILDING C, USE OCCUPANCY (A2)

$A_2 = (5,000 - (5,000 \times 0.75)) + 16,625 SF$
 $BL'P + BL'W = 2,719 + 5,557 = 10,276 SF \gg (OK)$

5. EXTERIOR WALL PROTECTION AND EXTERIOR OPENING PROTECTION

1- BUILDING ON SAME LOT (PER 502.2)

(E) HISTORY BUILDING "M" AS PORTION OF (E) HISTORY BUILDING "P"
 (E) HISTORY BUILDING "A" AS PORTION OF (E) HISTORY BUILDING "C"
 (E) HISTORY BUILDING "D" AS PORTION OF (E) HISTORY BUILDING "C"
 (E) HISTORY BUILDING "F" AS PORTION OF (E) HISTORY BUILDING "C"
 (E) HISTORY BUILDING "H" AS PORTION OF (E) HISTORY BUILDING "C"
 (E) HISTORY BUILDING "I" AS PORTION OF (E) HISTORY BUILDING "C"
 (E) HISTORY BUILDING "J" AS PORTION OF (E) HISTORY BUILDING "C"

2- FIRE RESISTIVE RATING REQUIREMENTS FOR BUILDING ELEMENTS (PER CBC TABLE 601.6, TABLE 602)

OCCUPANCY: ALL AREAS
 TYPE: VB CONSTRUCTIBLE

BUILDING ELEMENT	REQUIRED SEPARATION (HOURS)
PRIMARY STRUCTURAL FRAME	0
BUILDING WALLS	0
ROOF	0
NONFIRE-RATED WALLS AND PARTITIONS	0
EXTERIOR	0
NONFIRE-RATED WALLS AND PARTITIONS	0
FLOOR CONSTRUCTION AND ASSOCIATED SECONDARY MEMBERS	0
ROOF CONSTRUCTION AND ASSOCIATED SECONDARY MEMBERS	0

6. MEANS OF EGRESS ACCESS PROVISIONS

EXIT ACCESS TRAVEL DISTANCE (PER TABLE 1017.2)

OCCUPANCY	DISTANCE IN FEET IN NONSPRINKLERED BUILDINGS
A2 & A3	200
B	300
E	300

155 S. Fair Oaks, 2nd Floor, Pasadena, California 91105
 1 (626) 696-6906
 1 (626) 696-3440
 www.gkkworks.com

CANNON DESIGN

gkkworks

ARCHITECTURAL FIRM

ARCHITECT

AGENCY APPROVAL

SOUND MITIGATION PROGRAM

OAK STREET ELEMENTARY SCHOOL
 833 South Oak Street
 PASADENA, CA 91105

PROJECT NUMBER: **10292**

DRAWN: _____
 CHECKED: _____
 DESIGNED: _____
 APPROVED: _____
 DATE: _____

CODE ANALYSIS

G101