

17000 sq.ft.

12645 Delta St, Taylor, MI 48180



Listing ID: 30197521
 Status: Active
 Property Type: Industrial For Lease
 Industrial Type: Flex Space, Free-Standing
 Contiguous Space: 17,000 SF
 Total Available: 17,000 SF
 Lease Rate:
 Lease Type: Modified Gross
 Loading: 2 Docks, 2 Doors
 Ceiling: 18 - 20 ft.
 Office SF: 1,783 SF
 Drive-In Bays: 2 Bays



Overview/Comments

17,000 sq.ft. for lease by owner. Dual Truck well, great neighbors, tons of storage, and over 1,509 sq.ft. of office. Gross Lease available. Call REA Construction at 734-946-8730 for a tour. Move in date of march is available.

General Information

Tax ID/APN:	263960770	Zoning:	LIGHT INDUSTRIAL
Industrial Type:	Flex Space, Free-Standing, Industrial-Business Park, Manufacturing, Mixed Use, Light Industrial, Warehouse/Distribution	Building Name:	12645 Delta
		Land Area:	1.25 Acres

Available Space

Suite/Unit Number:	12645 delta	Offices:	7
Space Available:	17,000 SF	Office SF:	1509 SF
Minimum Divisible:	17,000 SF	Kitchen/Breakroom:	Yes
Maximum Contiguous:	17,000 SF	Parking Spaces:	25
Space Type:	Relet	Loading Docks:	2
Date Available:	03/01/2018	Loading Doors:	2
Lease Rate:		Drive In Bays:	2
Lease Type:	Modified Gross	Ceiling Height:	20
Rent Escalators:	Step-Up Lease	Clear Height:	18
Conference Rooms:	2		

Area & Location

Property Located Between: Telegraph and Beech Daly
 Highway Access: I94
 Airports: Detroit Metropolitan

Building Related

Tenancy:	Single Tenant	Office Space SF:	1,509 SF
Total Number of Buildings:	1	Property Condition:	Excellent
Number of Stories:	1	Year Built:	1991

Roof Type:	Flat	Amps:	200
Construction/Siding:	Block	Volts:	208
Parking Ratio:	1.4 (per 1000 SF)	X-Phase:	3
Parking Type:	Surface	Heat Type:	Natural Gas, Suspended Radiant Heaters
Total Parking Spaces:	25	Lighting:	Metal Halide
Column Spacing:	50	Internet Access:	Cable
Passenger Elevators:	0	Interior Description:	Huge Mezzanine
Freight Elevators:	0		

Land Related

Water Service:	Municipal
Sewer Type:	Municipal

Location

Address:	12645 Delta St, Taylor, MI 48180	MSA:	Detroit-Warren-Dearborn
County:	Wayne	Submarket:	Airport District



Property Images

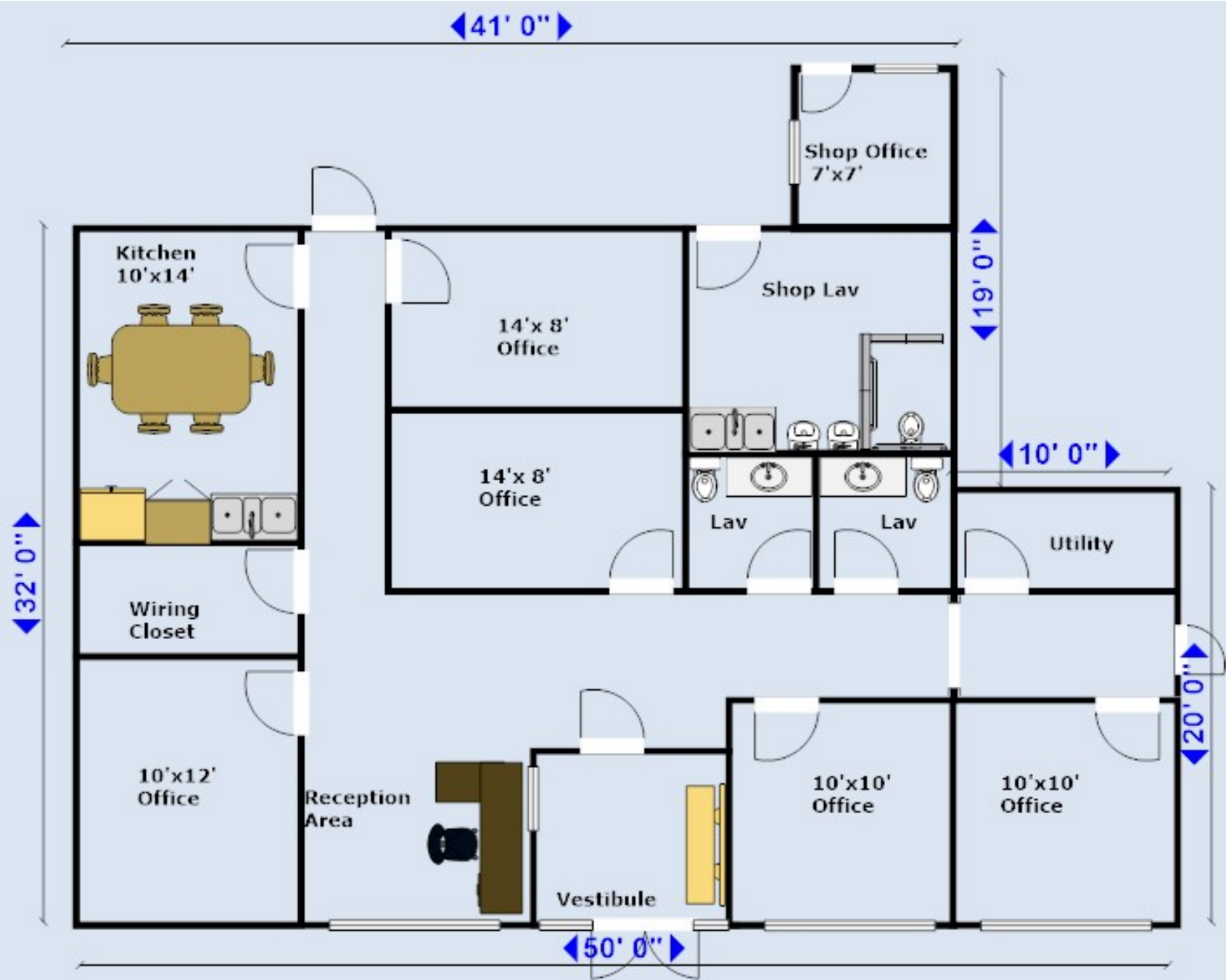

1,509 Sq.Ft.
Office layout

31' 0"

1,509
sq.ft.
Office
Area

153' 0"

Dual Truck Well

17,000
sq.ft

125' 0"

124' 0"

Grade level
Overhead Door

Grade level
Overhead Door

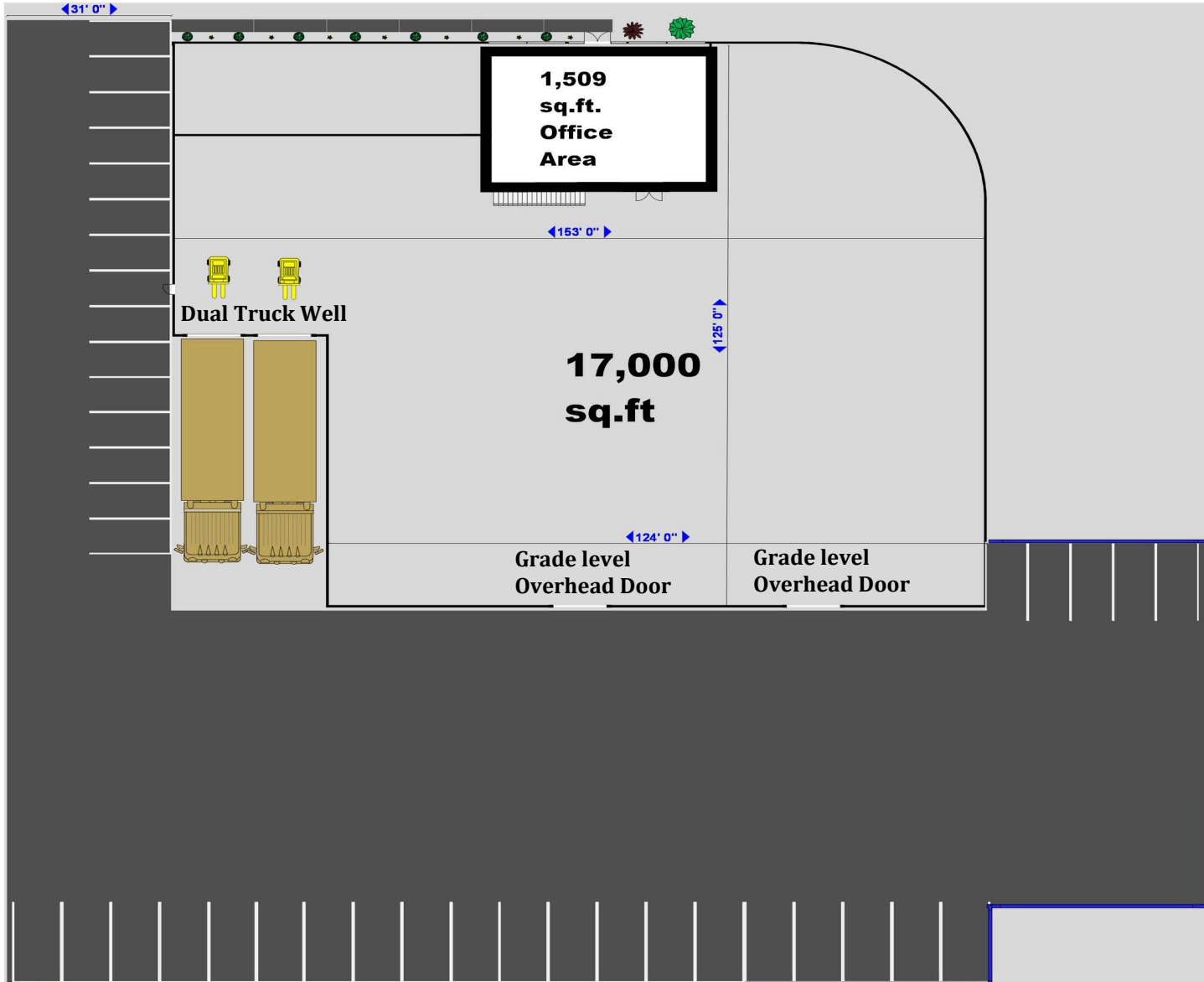

Property Contacts



Yvon Rea

Rea Construction

734-946-8730 [0]