



WINDOW

SHADINGS

Effective April 1, 2018

design simplified™

TABLE OF CONTENTS

Product Overview

- Features & Benefits 2
- Collection Information (includes Light Control) 3-4

Pricing Groups

- Pricing Group 1 (Standard and Options). 5
- Pricing Group 2 (Standard and Options). 6

Product Specifications. 7

- Options and Additional Notes 8-10
- RemoteLift™ 2.0 Motorization. 11-12
- Standard Retractable Cord and Cordless Operation 13-14
- Product Components. 15-18

FEATURES & BENEFITS



- Three vane sizes complement any window, providing desired view through – available in 2", 2 1/2" and 3" for decorating flexibility.
- Available in translucent and light-dimming vane styles to provide varying degrees of light control.
- Filters out up to 88% of incoming harmful UV rays when open, and up to 99% when closed.
- Covers large window expanses with no visible internal lift cords to detract from their elegant appearance.
- When raised, they completely disappear into the headrail allowing more outside view.
- Standard cord loop, retractable cord control, cordless lift and battery-operated RemoteLift 2.0 motorization options for operating convenience.
- Cordless lift and battery-operated RemoteLift 2.0 motorization shades are certified Best for Kids
- Fabric-covered headrail option for a soft look top to bottom.
- Limited Lifetime Warranty ensures your customers' satisfaction.

COLLECTION INFORMATION

Family Name	Color Name	Family Code	Color #	Coordinating Hardware Color Number	Coordinating Hardware Color Name	Light Control	Price Group
Classic 2-1/2" Translucent	Applesauce	N8	226	551	Worn Leather	B	1
	Beige Glow	N8	203	320	Rich Cream	B	1
	Butternut	N8	214	350	Vanilla	B	1
	Cashmere	N8	206	320	Rich Cream	B	1
	Dusky View	N8	208	679	Buff Beige	B	1
	Grey Mist	N8	212	897	Heatherwood	B	1
	New Snow	N8	213	885	Flex White	B	1
	Porcelain	N8	210	885	Flex White	B	1
	Powder Blue	N8	218	896	Gray Lady	B	1
	Sand Dunes	N8	207	320	Rich Cream	B	1
	Snow Cap	N8	201	661	White Tiara	B	1
	Spring Garden	N8	216	002	Alabaster	B	1
	Stardust	N8	204	320	Rich Cream	B	1
	Sun Dream	N8	202	320	Rich Cream	B	1
	Warm Wicker	N8	209	679	Buff Beige	B	1
Coastal 2" Translucent	Foam	SL2	700	885	Flex White	B	1
	Sand	SL2	701	320	Rich Cream	B	1
	Seashell	SL2	703	679	Buff Beige	B	1
	Sunrise	SL2	702	320	Rich Cream	B	1
Crossroads 2-1/2" Translucent	Citron	CS	205	656	Golden Straw	B	1
	Lily	CS	221	132	Charming Rosewood	B	1
	Parchment	CS	203	319	Earthen Beige	B	1
	Sage Mist	CS	219	697	Evening Light	B	1
	Sunlit Crème	CS	204	329	Summer Linen	B	1
	Swan White	CS	201	661	White Tiara	B	1
Passion 2-1/2" Translucent	Classic Cream	P9	254	350	Vanilla	B	1
	Destiny's Dream	P9	253	661	White Tiara	B	1
	Heather White	P9	250	661	White Tiara	B	1
	Hint of Spice	P9	255	319	Earthen Beige	B	1
	Spiced Vinegar	P9	251	320	Rich Cream	B	1
	Touch of Beige	P9	252	320	Rich Cream	B	1
Retreat 2" Light Dimming	Alpine	SR2	300	885	Flex White	C	2
	Antique	SR2	302	329	Summer Linen	C	2
	Bamboo	SR2	304	320	Rich Cream	C	2
	Buff	SR2	303	133	Feather Fantasy	C	2
	Soft Peach	SR2	305	205	Fawn	C	2
	Sunset	SR2	301	320	Rich Cream	C	2
Retreat 3" Light Dimming	Alpine	SR3	300	885	Flex White	C	2
	Antique	SR3	302	329	Summer Linen	C	2
	Bamboo	SR3	304	320	Rich Cream	C	2
	Buff	SR3	303	133	Feather Fantasy	C	2
	Cloud	SR3	309	320	Rich Cream	C	2
	Coffee Bean	SR3	308	849	Mocha	C	2
	Maple Leaf	SR3	307	472	Aspen Leaf	C	2
	Pebble	SR3	311	810	Mushroom	C	2
	Slate	SR3	306	048	Black	C	2
	Soft Peach	SR3	305	205	Fawn	C	2
	Stone	SR3	310	656	Golden Straw	C	2
	Sunset	SR3	301	320	Rich Cream	C	2
Slub Style 2-1/2" Translucent	Chiffon	N10	213	320	Rich Cream	B	1
	Custard	N10	205	350	Vanilla	B	1
	Honey Roast	N10	222	679	Buff Beige	B	1
	Magnolia	N10	210	885	Flex White	B	1
	Seashell	N10	204	320	Rich Cream	B	1
	Sugar Cane	N10	201	661	White Tiara	B	1
	Tea Time	N10	220	319	Earthen Beige	B	1
	Willow Herb	N10	226	551	Worn Leather	B	1
Soft Stripe 2-1/2" Translucent	Banana Split	N14	205	350	Vanilla	B	1
	Crème Brulee	N14	203	320	Rich Cream	B	1
	Ground Ginger	N14	226	551	Worn Leather	B	1
	Honey Butter	N14	222	679	Buff Beige	B	1
	Swan Song	N14	201	661	White Tiara	B	1
	Vanilla Milk Shake	N14	204	320	Rich Cream	B	1

* Light Dimming fabrics provide category C, opaque light control because even when the vanes are completely closed they DO NOT completely seal off all incoming light. See vane closure diagram on page 12 for a visual reference.

Note: Collections are presented alphabetically. Within each collection colors are also arranged alphabetically



A. Glare Reducing

Softly filters light and reduces glare. Images, shapes and people can be seen clearly. Provides the least amount of light and shape screening.



B. Filtering

Filters strong light. Images, shapes and people can be seen with some clarity. Provides a modest degree of light and shape screening.



C. Shading

Significantly reduces light. Images, shapes and people cannot be seen clearly. Provides a moderate to strong degree of light and shape screening.



D. Blocking

Dramatically reduces light. Images, shapes and people are not distinguishable. Provides privacy against most all direct light and shape screening (except minimal light that may seep through closed or overlapping opaque/blackout vanes).



E. Blackout

Blocks out virtually all light (except light that may enter on the sides of the shade) for maximum privacy and darkness.

COLLECTION INFORMATION

Family Name	Color Name	Family Code	Color #	Coordinating Hardware Color Number	Coordinating Hardware Color Name	Light Control	Price Group
Solitude 2-1/2" Light Dimming	Citron	M16	205	350	Vanilla	C	2
	Jute	M16	203	679	Buff Beige	C	2
	Parchment	M16	201	320	Rich Cream	C	2
	Soft Souffle	M16	204	551	Worn Leather	C	2
	Sunlit Crème	M16	202	320	Rich Cream	C	2
	Swan White	M16	200	661	White Tiara	C	2
Sophisticate 2" Translucent	Applesauce	SS2	607	350	Vanilla	B	1
	Carmel	SS2	610	205	Fawn	B	1
	Cocoa	SS2	613	205	Fawn	B	1
	Coffee Bean	SS2	614	849	Mocha	B	1
	Dusty Peach	SS2	608	679	Buff Beige	B	1
	Eggnog	SS2	605	320	Rich Cream	B	1
	Glacier	SS2	616	661	White Tiara	B	1
	Herb Garden	SS2	612	697	Evening Light	B	1
	Hush White	SS2	600	885	Flex White	B	1
	Lily	SS2	601	885	Flex White	B	1
	Maple Leaf	SS2	611	472	Aspen Leaf	B	1
	Mist	SS2	602	661	White Tiara	B	1
	Moonlight	SS2	603	320	Rich Cream	B	1
	Natural Linen	SS2	619	002	Alabaster	B	1
	Opal	SS2	604	320	Rich Cream	B	1
	Pearl Grey	SS2	617	320	Rich Cream	B	1
	Pebblestone	SS2	618	133	Feather Fantasy	B	1
	Praline	SS2	609	350	Vanilla	B	1
	Sandstone	SS2	606	319	Earthen Beige	B	1
	Slate	SS2	615	048	Black	B	1
Sophisticate 3" Translucent	Applesauce	SS3	607	350	Vanilla	B	1
	Cocoa	SS3	613	205	Fawn	B	1
	Coffee Bean	SS3	614	849	Mocha	B	1
	Eggnog	SS3	605	320	Rich Cream	B	1
	Herb Garden	SS3	612	697	Evening Light	B	1
	Lily	SS3	601	885	Flex White	B	1
	Maple Leaf	SS3	611	472	Aspen Leaf	B	1
	Moonlight	SS3	603	320	Rich Cream	B	1
	Opal	SS3	604	320	Rich Cream	B	1
	Sandstone	SS3	606	319	Earthen Beige	B	1
	Slate	SS3	615	048	Black	B	1
Villa 2-1/2" Light Dimming	Autumn	N6	209	132	Charming Rosewood	C	2
	Castle Stone	N6	226	551	Worn Leather	C	2
	Coral	N6	202	320	Rich Cream	C	2
	Cotton	N6	201	885	Flex White	C	2
	Dusty Peach	N6	205	320	Rich Cream	C	2
	Fawn	N6	203	320	Rich Cream	C	2
	Hazelnut	N6	204	320	Rich Cream	C	2
	White Sand	N6	213	885	Flex White	C	2
Weavescape 2-1/2" Translucent	Beach	N7	207	319	Earthen Beige	B	1
	Blush	N7	202	320	Rich Cream	B	1
	Chamois	N7	206	320	Rich Cream	B	1
	Cloud	N7	201	661	White Tiara	B	1
	Linen	N7	210	885	Flex White	B	1
	Stone	N7	203	320	Rich Cream	B	1
Windswept 2" Translucent	Cream	SB2	501	661	White Tiara	B	1
	Custard	SB2	503	350	Vanilla	B	1
	Mesa	SB2	504	205	Fawn	B	1
	Soft White	SB2	500	885	Flex White	B	1
Windswept 3" Translucent	Cream	SB3	501	661	White Tiara	B	1
	Custard	SB3	503	350	Vanilla	B	1
	Mesa	SB3	504	205	Fawn	B	1
	Soft White	SB3	500	885	Flex White	B	1

* Light Dimming fabrics provide category C, opaque light control because even when the vanes are completely closed they DO NOT completely seal off all incoming light. See vane closure diagram on page 12 for a visual reference.

Note: Collections are presented alphabetically. Within each collection colors are also arranged alphabetically



A. Glare Reducing

Softly filters light and reduces glare. Images, shapes and people can be seen clearly. Provides the least amount of light and shape screening.



B. Filtering

Filters strong light. Images, shapes and people can be seen with some clarity. Provides a modest degree of light and shape screening.



C. Shading

Significantly reduces light. Images, shapes and people cannot be seen clearly. Provides a moderate to strong degree of light and shape screening.



D. Blocking

Dramatically reduces light. Images, shapes and people are not distinguishable. Provides privacy against most all direct light and shape screening (except minimal light that may seep through closed or overlapping opaque/blackout vanes).



E. Blackout

Blocks out virtually all light (except light that may enter on the sides of the shade) for maximum privacy and darkness.

GROUP 1

2" Translucent
Coastal (SL2)
Sophisticate (SS2)
Windswept (SB2)

2 1/2" Translucent
Classic (N8)
Crossroads (CS)
Passion (P9)
Slub Style (N10)
Soft Stripe (N14)
Weavescape (N7)

3" Translucent
Sophisticate (SS3)
Windswept (SB3)

WIDTH TO:	24"	30"	36"	42"	48"	54"	60"	66"	72"	76"	84"	90"	96"	102"	109"	120"
HEIGHT TO:																
36"	\$407	458	509	560	610	666	713	766	899	952	1005	1058	1107	1177	1317	1438
42"	428	485	539	596	651	710	766	822	958	1018	1075	1132	1187	1262	1411	1541
48"	455	510	574	632	694	755	821	883	1021	1083	1144	1204	1267	1342	1503	1640
54"	472	538	602	671	737	804	872	948	1081	1148	1214	1283	1353	1437	1612	1759
60"	496	567	636	704	774	855	928	1007	1139	1215	1288	1366	1444	1541	1733	1893
66"	517	594	669	741	822	903	988	1072	1200	1284	1368	1454	1537	1643	1856	2026
72"	539	621	701	781	868	958	1046	1135	1267	1356	1446	1537	1625	1741	1969	2149
78"	555	641	727	817	905	999	1090	1188	1326	1425	1518	1614	1703	1829	2070	2260
84"	577	669	757	857	952	1051	1153	1251	1395	1499	1599	1698	1795	1927	2184	2383
90"	601	694	791	897	999	1106	1209	1314	1462	1569	1678	1783	1887	2022	2293	2502
96"	625	724	824	935	1046	1154	1265	1375	1530	1643	1757	1867	1978	2125	2407	2627
102"	714	828	940	1063	1175	1282	1430	1572	1681	1794	1912	2020	2132	2266	2558	2792
108"	751	870	988	1118	1234	1350	1504	1657	1768	1889	2010	2128	2245	2385	2695	2942
114"	796	923	1050	1188	1315	1435	1598	1758	1879	2008	2132	2255	2379	2530	2853	3116
120"	857	988	1126	1271	1403	1537	1710	1881	2010	2148	2286	2415	2549	2708	3055	3336

STANDARD FEATURES

- Headrail Size: 3-1/4" x 3-1/16"
- Snap-in Bracket Style
- Cord Tilt & Lift
- Color-Coordinated Hardware

OPTIONS: EXTRA CHARGE

- Fabric-Covered Headrail Surcharge **add \$42 per shading**
- Hardware Color Substitution Surcharge . . **add \$24 per shading**
- Cordless Lift Surcharge **add \$85 per shading**
- Retractable Cord Control Surcharge **add \$75 per shading**
- Retractable Cord Two-on-One Headrail **add \$150**
- RemoteLift **see page 10**

OPTIONS: NO CHARGE – SPECIFY ON ORDER

- Tilt Only Shadings 6" to 11-7/8" (standard only)
- Two-On-One Headrail – price as 2 separate shades (standard)
- Control Positions (R or L)
- Spacer Blocks
- Extension Brackets
- Hold-Down Brackets
- Back Cover for Inside Mounts
- Dust Cover for Outside Mounts

SIZE STANDARDS	Standard Loop	Retractable Cord
Minimum ordered width	12"	12"
Minimum ordered width – tilt only	6"	N/A
Maximum ordered width	120"	120"
Maximum ordered width end mount	48"	48"
Maximum ordered width – tilt only	11-7/8"	N/A
Minimum ordered height	16"	16"
Maximum ordered height – translucent	120"	120"

SIZE STANDARDS	Cordless Lift
Minimum ordered width	18"
Maximum ordered width	84"
Maximum ordered width end mount	N/A
Minimum ordered height	16"
Maximum ordered height – Translucent	84"

Note: Two-On-One Headrail option not available with cordless lift

Note: End Mount not available with cordless lift

TWO-ON-ONE HEADRAIL	Standard Loop	Retractable Cord
Minimum ordered width	24"	24"
Maximum ordered width	144"	144"
Maximum height	120"	120"
Center gap	3/8"	3/8"

Note: Two-On-One Headrail option not available for end mount applications.

IR/RF MOTORIZATION UPGRADE	
Minimum ordered width with motor and optional battery wand	12" or 20"***
Maximum ordered width with motor and optional battery wand	120"
Minimum ordered height with motor	12"
Maximum ordered height with motor – translucent	120"

** Battery Pack or DC Power Supply = 12" min. Built-in Battery Wand = 20" min.

GROUP 2
2" Light Dimming
Retreat (SR2)
2 1/2" Light Dimming
Solitude (M16)
Villa (N6)
3" Light Dimming
Retreat (SR3)

WIDTH TO:	24"	30"	36"	42"	48"	54"	60"	66"	72"	76"	84"	90"	96"	102"	109"	120"
HEIGHT TO:																
36"	\$450	505	561	618	672	731	785	843	986	1047	1106	1165	1220	1294	1453	1586
42"	472	536	594	657	719	781	843	903	1056	1119	1182	1245	1306	1385	1548	1690
48"	498	562	632	694	764	831	902	970	1119	1189	1257	1325	1393	1477	1656	1806
54"	519	592	666	738	806	883	959	1038	1188	1264	1334	1413	1494	1582	1779	1942
60"	544	621	700	775	855	937	1026	1107	1252	1334	1417	1504	1591	1693	1905	2080
66"	568	649	737	821	903	995	1087	1180	1320	1414	1506	1598	1689	1809	2042	2230
72"	594	681	772	858	956	1056	1149	1246	1393	1494	1592	1689	1784	1914	2192	2392
78"	610	702	800	898	995	1103	1201	1307	1460	1564	1673	1776	1877	2013	2351	2567
84"	636	737	831	939	1050	1155	1268	1375	1537	1649	1758	1971	2059	2142	2521	2753
90"	662	764	868	984	1102	1215	1331	1443	1605	1725	1939	2058	2146	2280	2646	2889
96"	757	868	983	1105	1216	1326	1459	1590	1787	1899	2013	2127	2237	2392	2776	3031
102"	867	992	1119	1257	1365	1471	1651	1817	1962	2075	2191	2298	2412	2557	2949	3219

STANDARD FEATURES

- Headrail Size: 3-1/4" x 3-1/16"
- Snap-in Bracket Style
- Cord Tilt & Lift
- Color-Coordinated Hardware

OPTIONS: EXTRA CHARGE

- Fabric-Covered Headrail Surcharge **add \$42 per shading**
- Hardware Color Substitution Surcharge . . **add \$24 per shading**
- Cordless Lift Surcharge **add \$85 per shading**
- Retractable Cord Control Surcharge **add \$75 per shading**
- Retractable Cord Two-on-One Headrail **add \$150**
- RemoteLift **see page 10**

OPTIONS: NO CHARGE – SPECIFY ON ORDER

- Tilt Only Shadings 6" to 11-7/8" (standard only)
- Two-On-One Headrail – price as 2 separate shades (standard)
- Control Positions (R or L)
- Spacer Blocks
- Extension Brackets
- Hold-Down Brackets
- Back Cover for Inside Mounts
- Dust Cover for Outside Mounts

SIZE STANDARDS	Standard Loop	Retractable Cord
Minimum ordered width	12"	12"
Minimum ordered width – tilt only	6"	N/A
Maximum ordered width	120"	120"
Maximum ordered width end mount	48"	48"
Maximum ordered width – tilt only	11-7/8"	N/A
Minimum ordered height	16"	16"
Maximum ordered height – light dimming	102"	102"

TWO-ON-ONE HEADRAIL	Standard Loop	Retractable Cord
Minimum ordered width	24"	24"
Maximum ordered width	144"	144"
Maximum height	102"	102"
Center gap	3/8"	3/8"

Note: Two-On-One Headrail option not available for end mount applications.

SIZE STANDARDS	Cordless Lift
Minimum ordered width	18"
Maximum ordered width	84"
Maximum ordered width end mount	N/A
Minimum ordered height	16"
Maximum ordered height – light dimming	84"

Note: Two-On-One Headrail option not available with cordless lift

Note: End Mount not available with cordless lift

IR/RF MOTORIZATION UPGRADE	
Minimum ordered width with motor and optional battery wand	12" or 20"***
Maximum ordered width with motor and optional battery wand	120"
Minimum ordered height with motor	12"
Maximum ordered height with motor – light dimming	102"

*** Battery Pack or DC Power Supply = 12" min. Built-in Battery Wand = 20" min.

PRODUCT SPECIFICATIONS

FEATURES	
# of fabric styles	13
# of Colors	112
Headrail size	3-1/4" X 3-1/16"
Bracket style	Snap-in
Cord loop tilt and lift	Yes, Standard
Raise, lower and tilt with one cord	Yes
Safety cord tensioner	Color Coordinated
Warranty	Lifetime Limited

OPTIONS - EXTRA CHARGE	
Fabric Covered Headrail	Yes
Hardware Color Substitution	Yes
Retractable Cord Control*	Yes
Cordless Lift <small>Not available as Two-on-One headrail</small>	Yes
RemoteLift 2.0 Motorization <small>Not available as Two-on-One headrail</small>	Yes
OPTIONS - NO CHARGE	
Tilt Only (available on standard loop control only)	Yes
Two-On-One Headrail Option <small>Not available with Cordless Lift or RemoteLift</small>	Yes
Control positions	R or L
Spacer blocks	Yes
Extension brackets	Yes
Hold-down brackets	Yes
Back cover (Inside or End Mounts)	Yes
Dust cover (Outside Mounts)	Yes
Cord length (See Cord Loop Drop Chart)	Yes
Specialty shapes	No
Tile cut-out	No

* Retractable cord will be equal to 2/3 of shading height.

MOUNTING REQUIREMENTS

INSIDE MOUNT - Standard, Cordless & Retractable Cord	
Minimum casement depth*	1"
Minimum casement depth*, fully recessed	3-3/8"
Minimum rear fabric clearance	1/8"

OUTSIDE MOUNT - Standard, Cordless & Retractable Cord	
Minimum mounting surface height	1"
Recommended width overlap per side	3"
Minimum rear fabric clearance	1/8"

END MOUNT - Standard & Retractable Cord	
Minimum mounting surface depth*	1-1/4"

* Add 1/4" to minimum depth dimensions if optional back cover is used for inside or end mounts.

INSIDE MOUNT - REMOTELIFT 2.0	Built-In Wand	Sat. Bat. Pack
Minimum casement depth*	2"	1-1/4"
Minimum casement depth*, fully recessed	4"	3-1/2"
Minimum rear fabric clearance	1/8"	1/8"

OUTSIDE MOUNT - REMOTELIFT 2.0	Built-In Wand **	Sat. Bat. Pack
Minimum mounting surface height	1"	1"
Recommended width overlap per side	3"	3"
Minimum rear fabric clearance	1/8"	1/8"

END MOUNT - REMOTELIFT 2.0	Built-In Wand	Sat. Bat. Pack
Minimum mounting surface depth*	2-1/8"	1-1/2"

* For inside and end mounts an optional back cover and back cover bracket may be ordered.

The back cover bracket attaches to the installation brackets.

** Requires 3/4" spacers per installation bracket (included), due to the added clearance required for the battery wand.

CORD LOOP DROP CHART

SHADING HEIGHT	CORD LOOP DROP
16" to 26-7/8"	1 ft. (white-only)
27" to 39-7/8"	2 ft.
40" to 59-7/8"	3 ft.
60" to 83-7/8"	4 ft.
84" to 107-7/8"	5 ft.
108" to 120"	6 ft. (white-only)

OPTIONAL CORD DROPS (White Cord Only)	
CORD DROP	INCREMENTS
6' – 12'	6" increments
12' – 16'	12" increments

Note: 18" white only cords available upon request

FINISHED DIMENSIONS

Dimensions apply to standard loop control, cordless lift, retractable cord and motorization	
NOTE: WIDTH AND HEIGHT MAY VARY ± 1/8"	
INSIDE MOUNT – Standard Deductions	
Headrail unit	1/8" less than ordered width
Fabric width	1" less than ordered width
Fabric width - Cordless Lift	3/4" less than ordered width
Shading height	Ordered height
Shading height - Cordless Lift	1/8" less than ordered height
OUTSIDE MOUNT – Standard Deductions	
Headrail unit	ordered width
Fabric width	3/4" less than ordered width
Fabric width - Cordless Lift	5/8" less than ordered width
Shading height	ordered height
Shading height - Cordless Lift	1/8" less than ordered height
END MOUNT – Standard Deductions (not available with cordless lift)	
Headrail unit	11/16" less than ordered width
Fabric width	1-1/2" less than ordered width
Shading height	ordered height
TWO-ON-ONE HEADRAIL (not available with cordless lift)	
Fabric width	1 1/4" less than ordered width
Gap between fabric panels	3/8"
FABRIC GAP – End Gap to Fabric (Gaps On Each Side)	
Control Side	5/8"
Idle Side	3/8"
Both Sides - Cordless Lift	3/8"

OPTIONS

RETRACTABLE CORD

Raise, lower and tilt shadings with one retractable cord. The cord length remains constant when shading is raised or lowered, making it ideal in homes with children or pets. Cord length will be equal to 2/3 of the shading height and may be shortened for enhanced child safety.

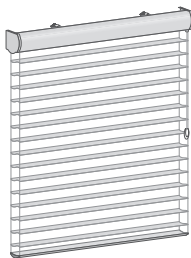

TWO-ON-ONE HEADRAIL

Cover patio doors and other large expanses by placing two independently operated shades side-by-side on the same headrail. Note there will be a 3/8" light gap between the two shades, see minimum/maximum requirements under product specification section.

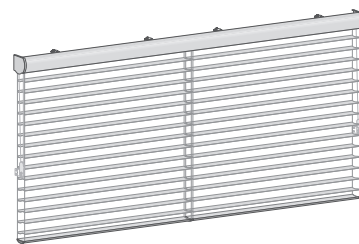

CORDLESS LIFT

To Lower the Shading

Gently pull down on the strap handle.



To Open the Vanes

Lower the shading all the way down and continue pulling down on the handle until the vanes open.

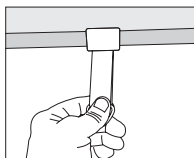

To Close the Vanes and Raise the Shading

Pull down on the handle slightly (about 1") and release the handle. The vanes will close first and then the shading will retract into the headrail.

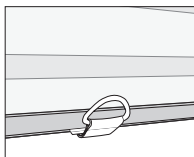

NOTE: With inside mounted shadings, you may need to pull the bottom rail away from the window to release the locking mechanism.

IMPORTANT: To reposition the shading, it must be raised several inches first to reset the mechanism and then pulled down to the new position.

NOTE: Once you are done operating the shading, lift the pull ring toward the front of the bottom rail until the magnet holds it in place.

TILT ONLY SHADING

Ideal for sidelights or narrow windows.

- Shading cannot be raised, it can only be tilted open or closed.
- Hold down brackets are used to secure the bottomrail.

FABRIC-COVERED HEADRAIL

Features a coordinating fabric wrapped onto the headrail to provide a soft fabric look from top to bottom.



OPTIONAL BACK COVER (INSIDE MOUNT)

Used with inside mounts to conceal the open rear side of the headrail for a more pleasing exterior look. Use of the back cover adds 1/4" to minimum inside mounting depths.

MINIMUM INSIDE MOUNTING DEPTH

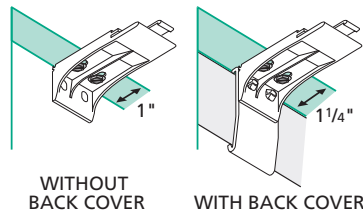

The back cover is secured in place by a back cover bracket attached to the installation bracket.

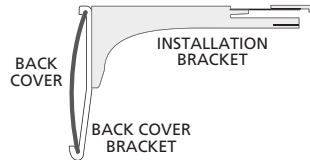

BACK COVER BRACKET

When a back cover is used, attach back cover brackets to the installation brackets before mounting them. Remove the tab from the top of the back cover brackets and both tabs at the rear of the installation brackets.

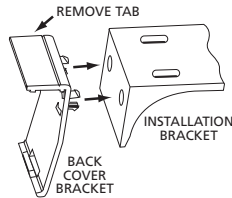

After mounting the installation brackets, install the back cover.

OPTIONAL DUST COVER (OUTSIDE MOUNT)

Shields the fabric and internal headrail components from dirt, dust, and other contaminants.

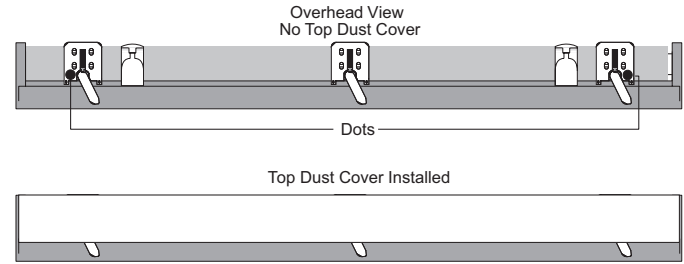

SIDE-BY-SIDE VANE ALIGNMENT

When window shadings are installed side by side, vane alignment can be guaranteed within 1/4" only if:

- Shadings are ordered at the same time and in the identical style, color and height.
- Shadings that need to be aligned are specified on the order form (a note must be included in Special Instructions).

Note: Vane alignment cannot be guaranteed for Two-On-One Headrail and motorized shadings combined on the same order.

ADJACENT SHADINGS

To span wide window openings, window shadings may be installed adjacently, so their headrails abut. The gap between the fabric panels of the adjacent shadings varies according to the control placement, as shown in the table below.

CONTROL PLACEMENT	
Adjacent (Abutting)	Window Shadings
Left/Right Shadings	Center Gap
Right/Right Controls	3/4"
Left/Left Controls	3/4"
Right/Left Controls	1-1/16"
Left/Right Controls	1/2"
Window shadings are not recommended for bay windows or butt-and-pass applications.	

ADDITIONAL NOTES

SHADING ADJUSTMENT

Shadings should wind evenly and not skew to one side.

A balance weight on the bottomrail can easily be adjusted if the fabric winds unevenly on the roll when the window shading is raised. Uneven winding can cause damage to the edge of the fabric.

- If skewing does occur:
 - Ensure headrail was installed level; shim if necessary.
 - To release, insert a flat blade screwdriver into the weight lock and turn clockwise.
 - Adjust placement of weight in bottomrail, 1" at a time, toward side where fabric is gathering.
 - Secure the weight locks in position by turning them counter clockwise, after making the adjustment.
 - Raise shade, then lower, if necessary, adjust again.

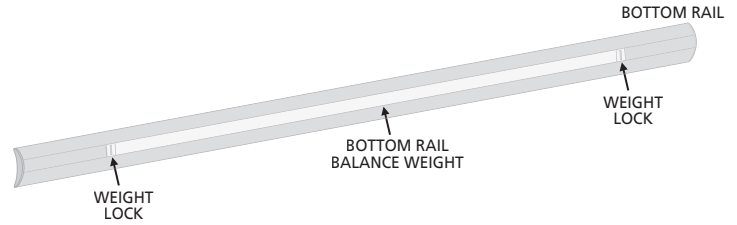

SHADING INSTALLATION

To mount the shading, insert the top of the headrail into the brackets between the locking tab and the bracket flange. Push the headrail into the brackets until the locking tab clicks in place.

To remove the shading, lift the locking tab to release the headrail, rotate the headrail forward, and pull it straight out.

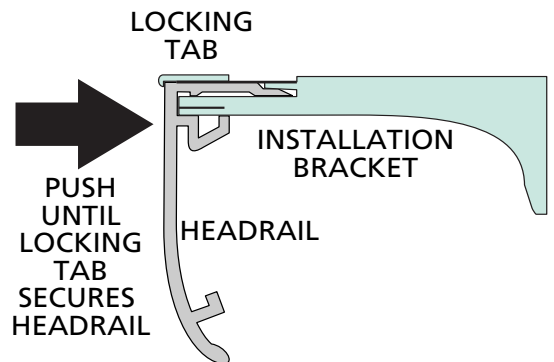

MAGNETIC HOLD-DOWN BRACKETS

Magnetic hold-down brackets secure the bottom of the shading to prevent swaying. Available upon request. Standard on tilt-only shadings.

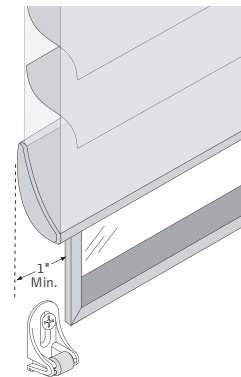

REMOTELIFT™ MOTORIZATION OPTIONS: EXTRA CHARGE – SPECIFY ON ORDER

• Motorization	add \$502 per shading
• Remote Control.....	Part #2984495100.....add \$61 each
• Satellite Battery Pack – select with wire length below.....	Part #KIT2520
• Satellite Battery Pack – with 15" wire	Part #2989899000.....add \$71 each
• Satellite Battery Pack – with 4' wire	Part #2989900000.....add \$79 each
• Satellite Battery Pack – with 10' wire	Part #2989901000.....add \$91 each
• Satellite Battery Pack – with 20' wire	Part #2989902000.....add \$102 each
• DC Power Supply – select with wire length below.....	Part #7806000000
• DC Power Supply – with 15" wire	Part #2989899000.....add \$106 each
• DC Power Supply – with 4' wire	Part #2989900000.....add \$107 each
• DC Power Supply – with 10' wire.....	Part #2989901000.....add \$112 each
• DC Power Supply – with 20' wire.....	Part #2989902000.....add \$116 each
• Daisy Chain Adapter – select with wire length below	Part #2989875000
• Daisy Chain Adapter – with 15" cable	Part #2989899000.....add \$50 each
• Daisy Chain Adapter – with 4' cable	Part #2989900000.....add \$57 each
• Daisy Chain Adapter – with 10' cable	Part #2989901000.....add \$62 each
• Daisy Chain Adapter – with 20' cable	Part #2989902000.....add \$67 each

Notes: For surcharges on oversize common carrier delivery, express ship program, shipments to Hawaii, Alaska and Puerto Rico, see General Information Section

MOMENTA APP BRIDGE KIT

- Momenta App Bridge Kit (includes one Momenta Extender Kit)Part #2920072100 (must be submitted as part order).....add \$146 NET Cost
- Momenta Extender Kit.....Part #2920075100 (must be submitted as part order).....add \$54 NET Cost

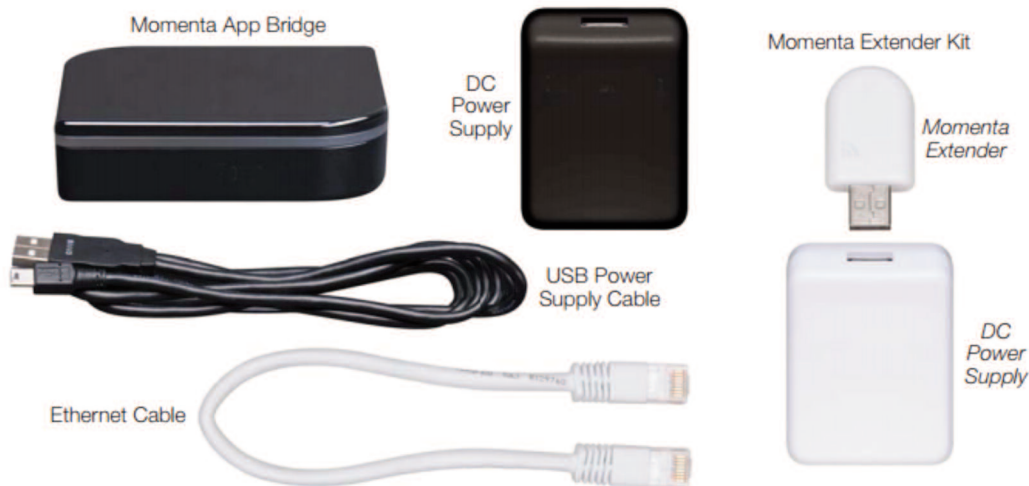
Momenta App Bridge Kit (Includes One Momenta Extender Kit)

REMOTELIFT 2.0 ORDERING NOTES

- Specify Inside (IB), outside (OB) or end (EB) mount.
- Specify if optional back cover is desired with inside (IB) mounts or end (EB) mounts.
- Specify if additional spacer blocks or extension brackets are needed for added clearance.
- Specify left- or right-side motor assembly.
- Specify number of remote control units (at least 1 required per order).
- If ordering satellite battery pack, specify wire length (15", 4', 10' or 20').
- If ordering DC power supply, specify wire length (15", 4', 10' or 20').
- Specify if daisy-chain cables are required to daisy-chain 2 or 3 shadings together (requires DC power supply). If ordering, specify wire length (15", 4', 10' or 20')

REMOTELIFT™ 2.0 PRODUCT CONFIGURATION SPECIFICATIONS

RemoteLift 2.0 combines IR and RF wireless signals to control your window shadings. By using both line-of-sight (infrared technology) and "out-of-sight" (radio frequency technology), your customers achieve more operating flexibility. RemoteLift 2.0 operates one window at a time or a group of windows, even in multiple rooms.

- Quieter, more robust motor for raising, lowering and tilting shadings
- Ideal option for hard-to-reach windows behind furniture, above counters, in high foyers, etc.
- Enhanced safety in homes with children and pets
- State-of-the-art convenience; multiple options allow even further customization of window shadings
- Battery-powered system is easy to install and requires no additional wiring



REMOTELIFT 2.0 SYSTEM OPTIONS

BATTERY WAND

Battery wands are the standard power source whether inside (IB), outside (OB) or end (EB) mount, if applicable. Battery wands are mounted on the rear of the headrail. The redesigned battery wand will allow for batteries to be changed without removing the window covering from the window.

- 12 AA 1.5V alkaline batteries.
- Battery life exceeds one year, depending on usage.
- Replace batteries when the window covering(s) begin to operate slowly.



18V Battery Wand

SATELLITE BATTERY PACK

The satellite battery pack is an optional power source. The battery pack connects to the same side of the headrail where the receiver eye or satellite eye is located. The satellite battery pack is the best choice when the window covering is mounted in a high window, restricting access to a battery wand.

- 18V satellite battery pack:
 - Available in 15", 4', 10' and 20' wire lengths.
 - 12 AA 1.5V alkaline batteries.
- Battery life is approximately one year, depending on usage.
- Replace batteries when the window covering(s) begin to operate slowly.
- Mounting options: top of headrail, next to molding or under the sill.
- Satellite battery pack cover can be painted.



18V Satellite Battery Pack

DC POWER SUPPLY

The DC power supply is an optional power source. The DC power supply plugs into any standard household outlet.

- 18V DC power supply:
 - Available in 15", 4', 10' and 20' wire lengths.
- Eliminates need to change batteries.



18V DC Power Supply

DAISY CHAIN

The optional Daisy Chain Adapter allows up to 3 shades to run off of one DC power supply. You must specify the cable wire length when order is placed.

Note: Keep in mind which side the sensor eye is positioned on each side when determining daisy-chain length.



Daisy-Chain Adapter/Connector

STANDARD SHADING OPERATION

STANDARD SHADING OPERATION

Shadings are operated using a continuous cord loop. As shown in the illustration below, from the fully raised position [1] pulling down on the rear half of the cord loop lowers the shading [2, 3]. After it is fully lowered, continuing to pull down on the cord pivots the bottomrail and opens the fabric vanes [4]. When the vanes are fully open [5], limit stops in the headrail prevent further movement in that direction.

With the fabric vanes fully open, pulling down on the front half of the cord loop first closes the vanes [6, 7] and then raises the window shading [8]. When it is fully raised [1], limit stops again halt shading movement, preventing the bottomrail from being retracted too far into the headrail.

Light Control

With the shading in the fully lowered position, the continuous cord loop is used to adjust the fabric vanes from open to closed, and anywhere in between. Light control is at your customer's fingertips. (Note: The degree of maximum vane closure varies slightly from the top to the bottom of the shading.)

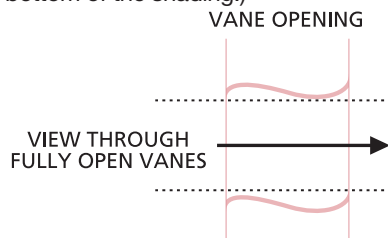

Vane Opening

Vane opening is the amount of unobstructed visibility between fully open vanes when looking through the shading at eye level. Vane opening for shadings is 1" to 1-1/2" depending on vane size and opacity.

Vane Closure

When the vanes of a window shading are closed, they overlap each other, blocking the view. However, the vanes do not contact each other along the full length of the shading – they do not form a perfect seal against light leakage. This is most visible toward the bottom of the shading.

Vane closure is measured as the distance between the front and rear fabric facings 6" up from the lowest point of the bottomrail, with the shading fully lowered and the vanes closed, as illustrated here. Vane closure is 5/8" for shadings under 96" in height and 7/8" for shadings over 96" in height.

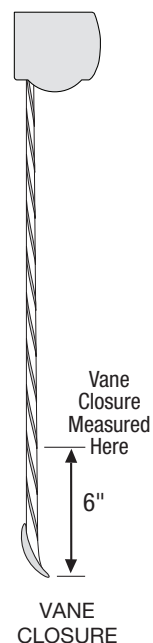

PLEASE NOTE: Cord tensioner MUST be mounted to window casement or wall in order for the shade to operate.

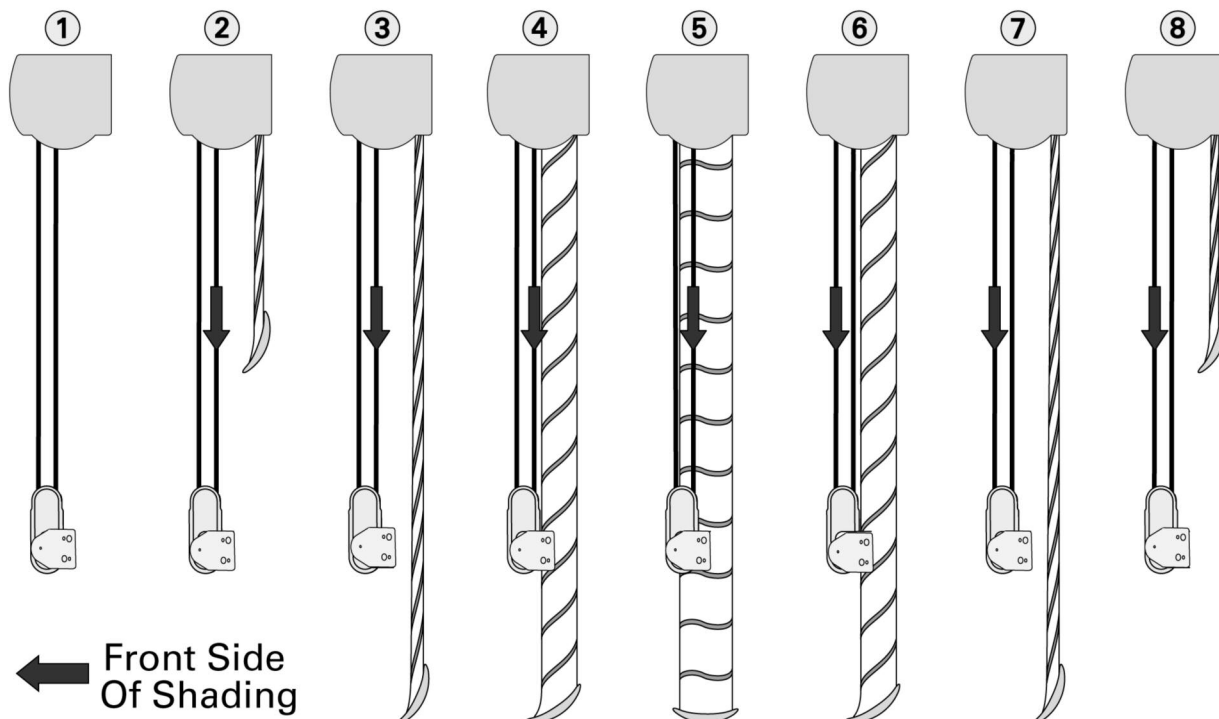

OPERATION

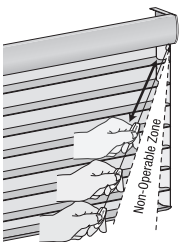

RETRACTABLE CORD

To Lower the Shading

To lower shading and open vanes, pull cord toward the center and down in long even strokes.
Note: Allow cord to fully retract between each stroke.

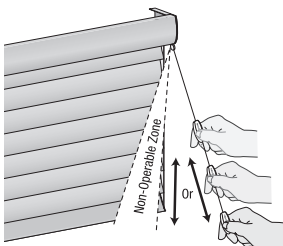

To Close and Raise the Shading

To close vanes and raise shading, pull cord straight down or down and slightly out using long even strokes.

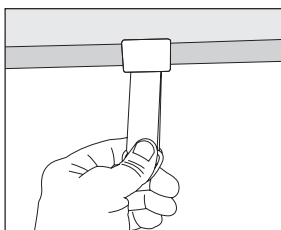

CORDLESS LIFT

To Lower the Shading

Gently pull down on the strap handle.

To Open the Vanes

Lower the shading all the way down and continue pulling down on the handle until the vanes open.



To Close the Vanes and Raise the Shading

Pull down on the handle slightly (about 1") and release the handle. The vanes will close first and then the shading will retract into the headrail.

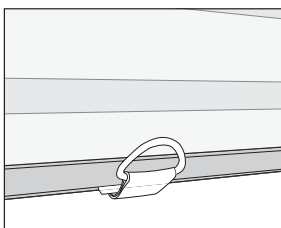

NOTE: With inside mounted shadings, you may need to pull the bottom rail away from the window to release the locking mechanism.

IMPORTANT: To reposition the shading, it must be raised several inches first to reset the mechanism and then pulled down to the new position.

NOTE: Once you are done operating the shading, lift the pull ring toward the front of the bottom rail until the magnet holds it in place.

PRODUCT COMPONENTS – STANDARD

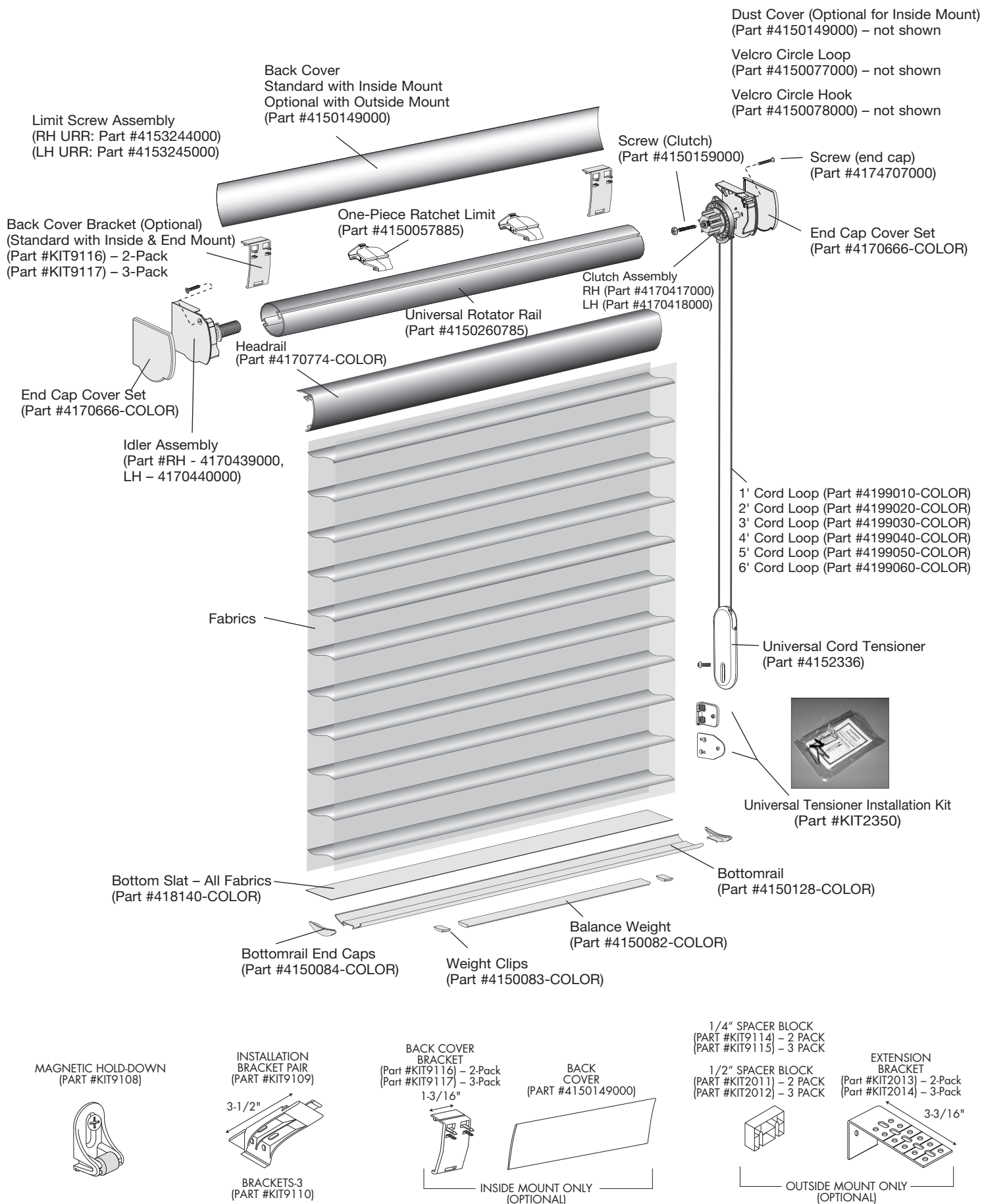

PRODUCT COMPONENTS – RETRACTABLE CORD

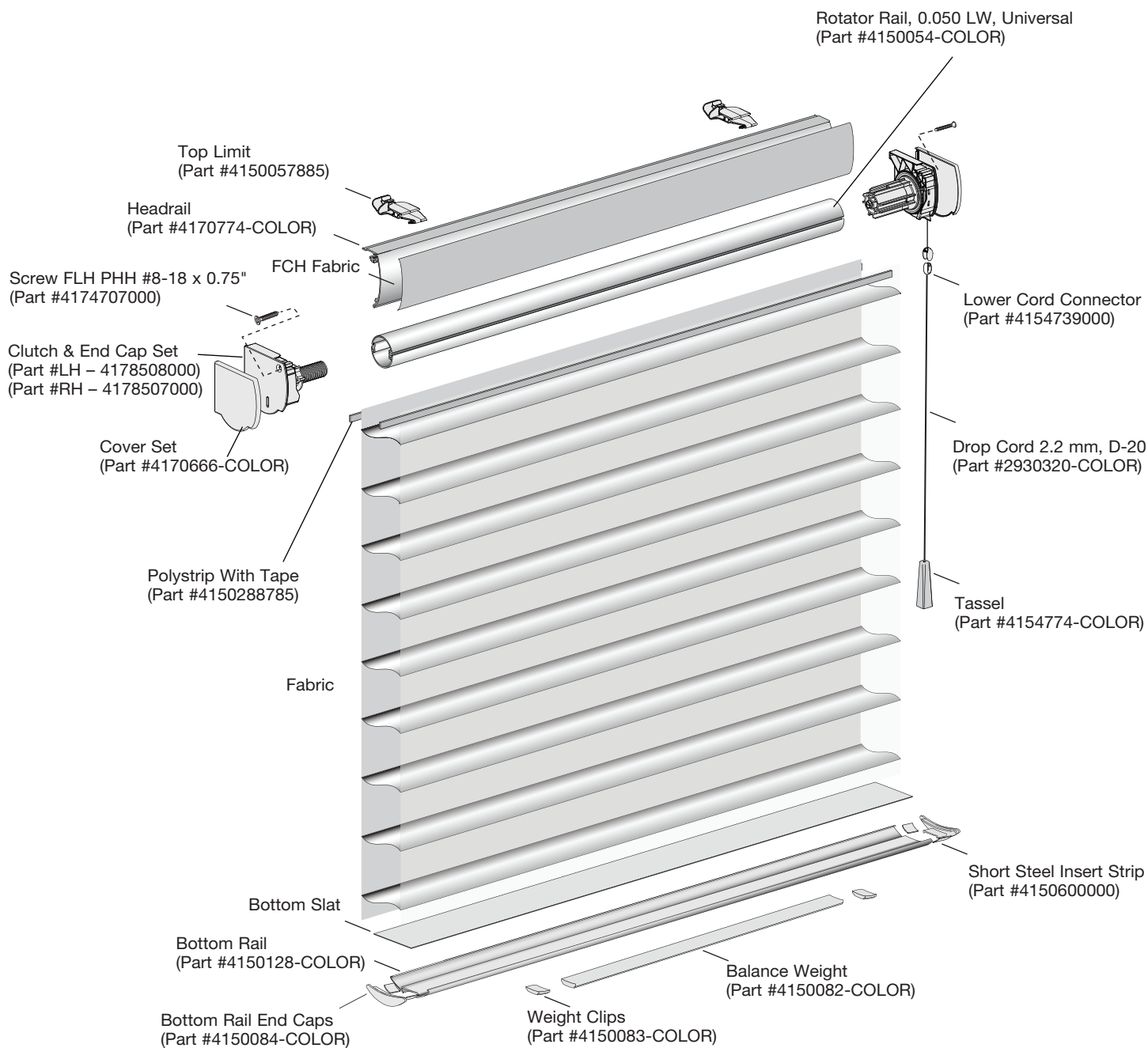

PRODUCT COMPONENTS – CORDLESS LIFT

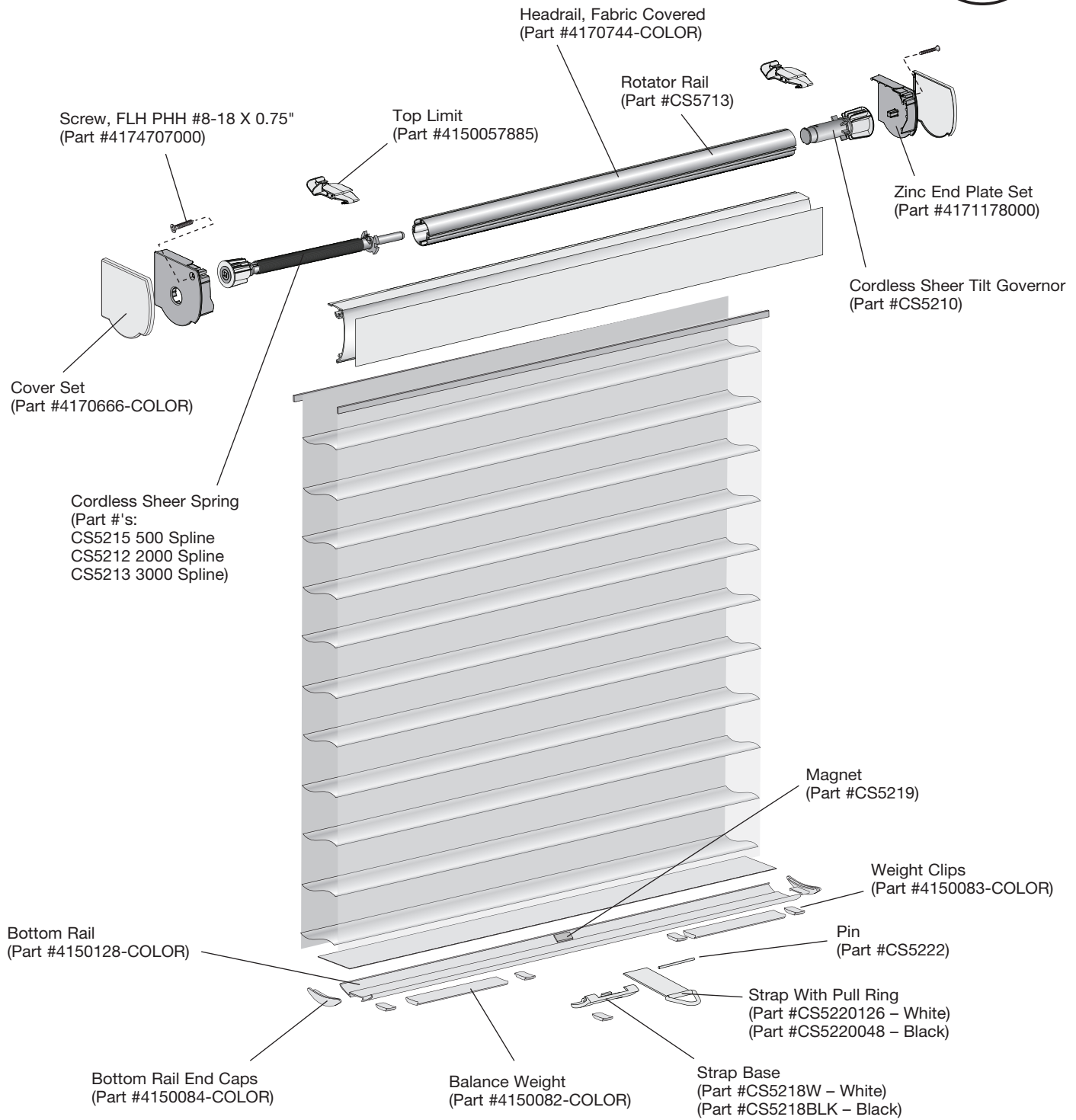

PRODUCT COMPONENTS – REMOTELIFT™ 2.0

