

Soils Map

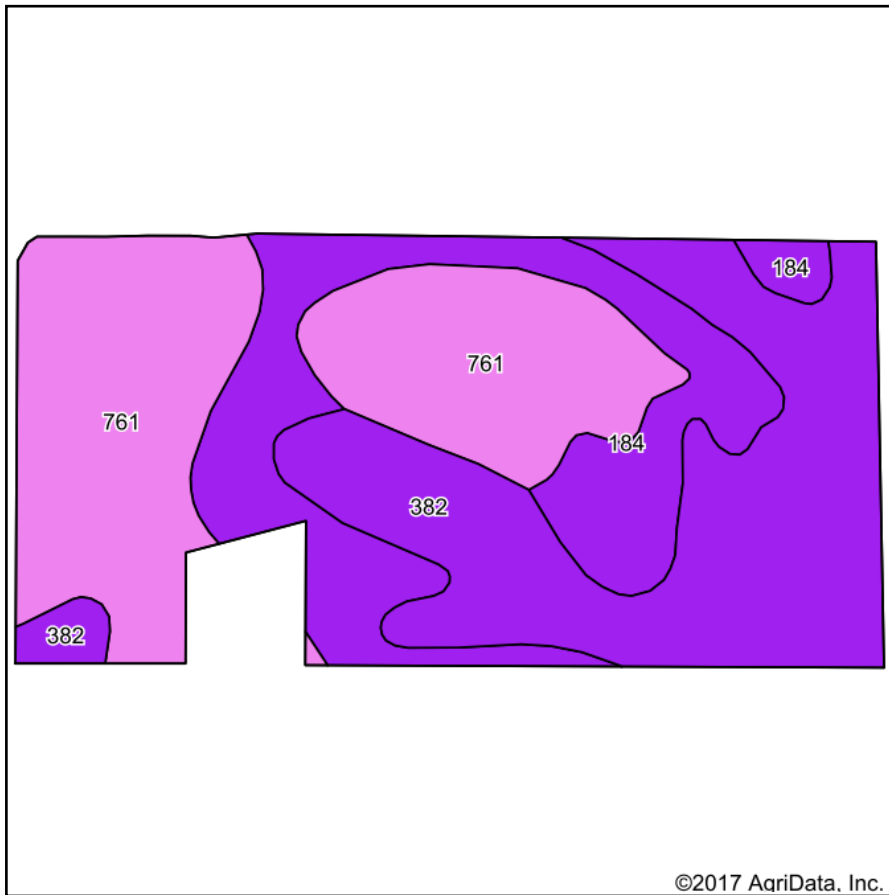

Soils data provided by USDA and NRCS.

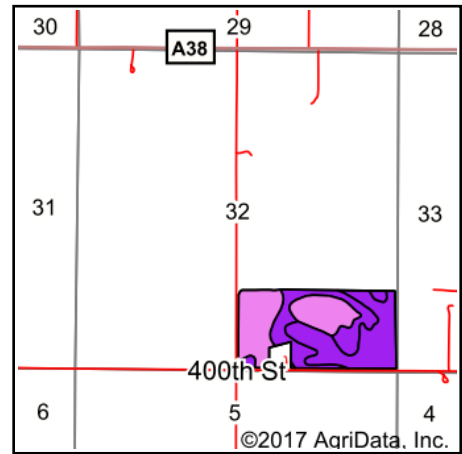

State: **Iowa**
 County: **Worth**
 Location: **32-99N-20W**
 Township: **Kensett**
 Acres: **73.15**
 Date: **10/12/2017**



Maps Provided By:



© AgriData, Inc. 2017

www.AgriDataInc.com



Area Symbol: IA195, Soil Area Version: 20

| Code | Soil Description | Acres | Percent of field | CSR2 Legend | Non-Irr Class *c | CSR2** | CSR | Corn | Soybeans |
|------------------|-------------------------------------------------|-------|------------------|-------------|------------------|--------|------|------|----------|
| 761 | Franklin silt loam, 1 to 3 percent slopes | 28.14 | 38.5% | | lw | 85 | 90 | 221 | 64 |
| 382 | Maxfield silty clay loam, 0 to 2 percent slopes | 26.43 | 36.1% | | llw | 94 | 86 | | |
| 184 | Klinger silty clay loam, 1 to 4 percent slopes | 18.58 | 25.4% | | lw | 95 | 93 | | |
| Weighted Average | | | | | | 90.8 | 89.3 | 85 | 24.6 |

**IA has updated the CSR values for each county to CSR2.

*c: Using Capabilities Class Dominant Condition Aggregation Method

Soils data provided by USDA and NRCS.