

TORQ-HUB

99%
Accurate Torque
Readings



INNOVATIVE
FOUNDATION SOLUTIONS LTD.

www.ifsequip.com



99% Accurate Torque Readings

We are pleased to introduce The Torq Hub. It delivers over 99% accurate torque readings. Data is sent over a robust 2.4 GHz RF FHSS signal to the handheld display/datalogger.

The Torq hub reliably and accurately measures torque forces in either ft/lb or N-m, as well as pile/anchor inclination.

This monitoring and data logging device is intended to mount directly onto the drill rig Kelly bar.



Wireless signal is 2.4 GHz FHSS RF. Outdoor range – up to 2.5 miles (4 km) Frequency Hopping Spread Spectrum technology allows clear communication across up to 79 frequencies

7" Window OS LCD touchscreen in a rugged ABS casing. Designed to IP67 ingress protection.

Circuit boards, firmware and software all designed by CTS specific to the application. Fully potted, sealed, gasketed and cushioned to ensure maximum protection and long life.



The heart of the Torq Hub is the PCB containing a microprocessor which converts the analog strain gage input to a digital signal which is transmitted over a robust 2.4 GHz RF Signal



Available with 2", 2-1/2", 2-5/8" & 3" hex input shafts

Available with 5-1/4" & 7-5/8" bolt circle flange types

Improved Reporting



IFS is pleased to introduce our vastly improved reporting capabilities.

- ⇒ Reports are exportable directly from the display, either via email using a smartphone with its' hotspot enabled, or through the onboard USB port connected to a flash drive.
- ⇒ Reports are exported as both bare data (.dat file – open with Excel), and as a PDF line chart as shown below. One cover page for the job and a page for each individual pile is generated.
- ⇒ Additionally, the PDF line chart will show depth as it is entered during the job. This will give the engineer a view of depth vs. torque on each pile. An optional hand held trigger is available which allows the operator (or his helper) to depress it when the pile/ anchor reaches a marked depth, allowing a more accurate (and more continuous) representation of torque vs. time"

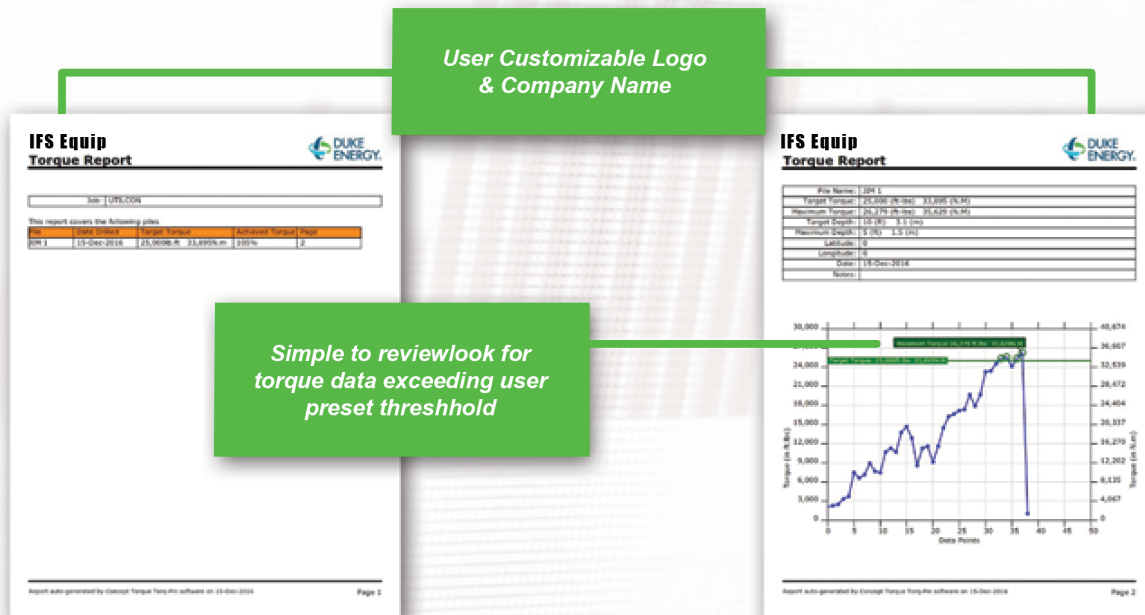

Smartphone Apps

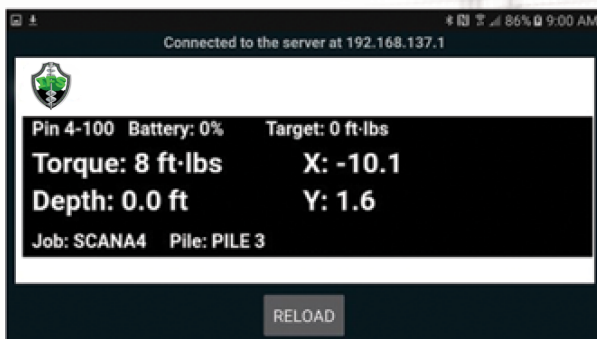

IFS is now offering a free smartphone app for both iOS (Apple) and Android (Samsung, etc) users.

- ⇒ Available for FREE download from either the Apple App Store or Google Play.
- ⇒ Allows a user to remotely monitor torque and inclination data for piles/ anchors as they are installed via a WIFI connection between their smartphone and our display.

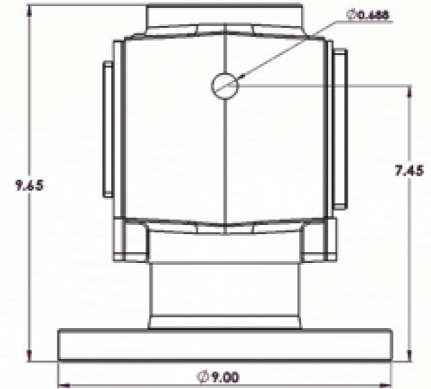
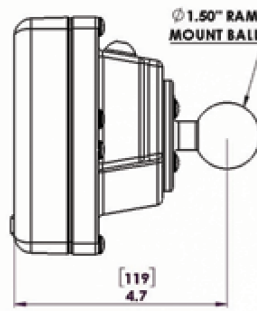
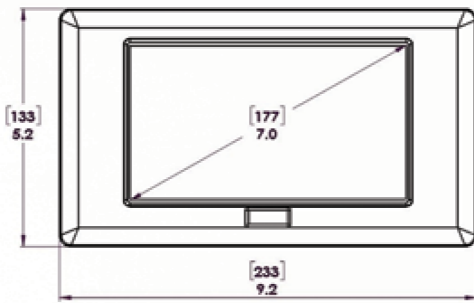

Rated Output (R.O):	2 mV/V nominal
Nonlinearity:	0.1% of R.O.
Hysteresis:	0.1% of R.O.
Nonrepeatability:	0.05% of R.O.
Zero Balance:	1.0% of R.O.
Compensated Temp. Range:	60° to 160° F
Safe Temp. Range:	-65° to 200° F
Temp. Effect on Output:	0.005% of Load/°F
Temp. Effect on Zeror:	0.005% of R.O./°F
Terminal Resistance:	350 ohms nominal
Excitation Voltage:	5 VDC
Safe Overload:	150% of R.O.

2", 2-1/2 & 2-5/8" Torq Hubs are offered Double-drilled to accomodate either the 5-1/4" or 7-5/8" bolt circle on the same hub. Torque ratings remain limited by bolt capacity (10,000 or 15,000 FT/LB). 3" are offered with the larger 7-5/8" pattern only.

FLANGE BOLT CIRCLE DIA.	HEX SHAFT SIZE	PART NUMBER	TORQUE RATING (MAX.)
5-1/4" & 7-5/8"	2"	TQHB-2	10,000 ftlb (5-1/4" BC) 20,000 ftlb (7-5/8" BC)
5-1/4" & 7-5/8"	2-1/2"	TQHB-212	10,000 ftlb (5-1/4" BC) 20,000 ftlb (7-5/8" BC)
5-1/4" & 7-5/8"	2-5/8"	TQHB-258	10,000 ftlb (5-1/4" BC) 20,000 ftlb (7-5/8" BC)
7-5/8"	3"	TQHB-3	20,000 ftlb (7-5/8" BC)

Larger TORQ-HUB's available upon request



Distributor:



INNOVATIVE

FOUNDATION SOLUTIONS LTD.

www.ifsequip.com