

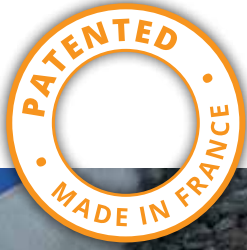

Minet Lacing Technology

# **SUPER-SCREW<sup>®</sup>** Lacing





# What is it?

# SUPER-SCREW®

## Super-Screw: Fastener/Splice and Patch

Minet Lacing Technology's flagship product is the **Super-Screw**. Having achieved great success with conveyor belt installations and repairs, **Super-Screw** stands out as a leader in the industry. It is a flexible rubber splice that screws directly onto the belt, with great accuracy and precision.

The **Super-Screw** uses specifically designed self-drilling, self-tapping screws that preserve the belt integrity by spreading the carcass threads without cutting them.

This technology allows the **Super-Screw** to be installed regardless of the location or accessibility of the conveyor belt and regardless of weather conditions, all while significantly reducing downtime.

Simple and practical, the **Super-Screw** is available in several different rubber choices. Some include Grade-one Abrasion Resistant, Stainless Steel, HOT, and MSHA rated.



## General Data Chart

Super-Screw types	35	63	65	80	85	100	105	180	200
Belt thickness, in.	5/32 - 1/2"	5/32 - 1/2"		5/32 - 19/32"		5/32 - 19/32"	5/32 - 14/32"	9/32 - 13/16"	9/32 - 3/4"
Maximum belt tension, PIW	200	360		450		650		1650	2000
Minimum Pulley Ø, in.	6"	8"		10"		12"		16"	20"
Thickness top, in.	5/32"	3/16"	15/64"	15/64"	9/32"	9/32"	11/32"	9/32"	11/32"
Thickness bottom, in.	5/32"	11/64"		7/32"				15/64"	

## Versions Available - Pick Rubber Compound Here

 **AR** – Abrasion Resistant

 **HOT** – Heat Resistant 338°F (392°F)

 **MOR** – Moderately Oil Resistant  
(248°F Heat Resistant)

 **SS** – Stainless Steel

 **F** – Fire Resistant MSHA (Anti-static  
and Non-sparking)

 **W** – White FDA/USDA Cover with All  
Stainless Steel Inserts and Screws\*

\*For W-White food grade ONLY, sold in 48" length



**BB/FB or SB** –  
Bare Back/Friction  
Back or Sliding  
Bed\*\*

\*\*Available in AR or MOR. Please designate which in  
parenthesis on Purchase Order.

## ADVANTAGES

- Quick installation (saves downtime)
- Expensive equipment or specialized tooling not required for installation
- No need for a highly skilled operator
- No drilling and no template
- No need for physical strength
- Self-tapping screws go into the belt to maintain integrity
- Wear-resistant and cut-resistant
- High tensile strength
- Flexible
- Can be used as a bridge/saddle even with different belt carcass thickness (unmatched sides)
- Suitable for high-heat belt up to 392°F
- Compatible with small pulley diameters
- Compatible with conveyor belt scrapers
- Perfect for tubular belt
- Leak-proof
- Available "IN A ROLL" or "READY-TO-INSTALL" (see next page)
- Several different rubber compounds available (see above)

## Note

Our non-magnetic splices use 316 stainless steel screws and inserts





# SUPER-SCREW

Available in two varieties: Ready to install or in a roll



## "READY TO INSTALL"



Abrasion Resistant Super-Screw shown

**Super-Screw** Ready to Install: The assembly spacers are preinstalled, so that the top cover matches the bottom part. The **Super-Screw** is delivered with the appropriate number of screws and PZ bits to install the splice (matched by inches ordered). It is available in any length between 12 inches up to the length of a roll as detailed below.

Delivered with:



Super-Screw Assembled



Screws



PZ Bit (PZ2 for Super-Screw series 35 to 100 and PZ3 for 180 to 200)

Spacers (removed during install)

## "IN A ROLL"



Roll of Moderately Oil Resistant - MOR shown

**Super-Screw** roll purchases are delivered in 2 separate rolls: A top roll and a bottom roll. You receive the number of screws, spacers and bits to install the complete roll. The size of the spacers and screws can be assorted to meet multiple needs, per the request of the customer.

**Roll length by series:**

- 82 ft / 984 inches for the **Super-Screw** 35 to 105
- 50 ft / 600 inches for the **Super-Screw** 180 to 200

Includes:



Spacers



Bucket of Screws



PZ Bits

# SUPER-SCREW

The best solution for patch repairs



Need more information?  
Please visit our website

**MLTnorthamerica.com**



Super-Screw



Roll shipped in 2 boxes-  
1 top cover and  
1 bottom cover



Super-Screw



Super-Screw on steel cord belt



Adding screws to a roll



Super-Screw installed in troughing application

# How to Install Super-Screw 35 to 100

Note: For clarity, areas already screwed are shown in grey.

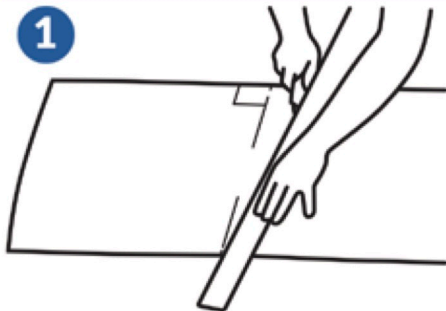

Install the SuperScrew (SS) on a bias.

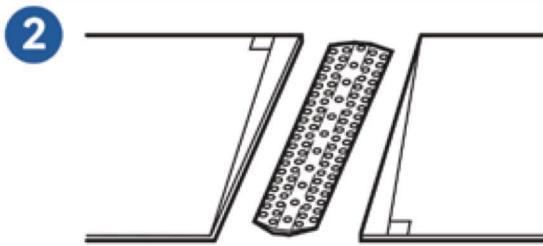

Square the belt your normal way. Then drop down on either side 1" per 12" of the belt width. On the other side of the belt do the reverse so the ends will mate or match.

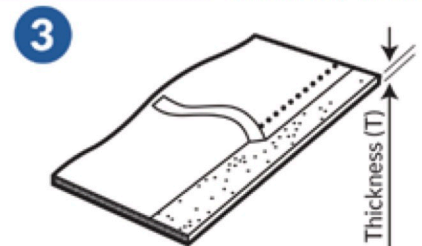

Skive the top of the belt to the appropriate depth. (Required when running wipers, cleaners or scrapers.)

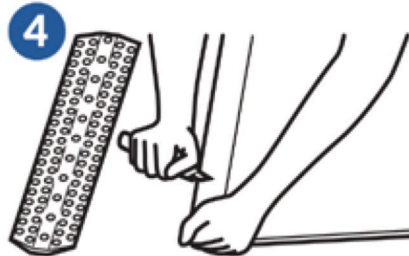

**4A**  
Slightly chamfer or sharpen the top and bottom of both ends of your belt to aid in sliding the ends of the belt into the SS.

**4B**  
Position the SS so that the belt is firm against the spacers already inserted in the SS.

Choose screw length based on belt thickness (T)			
Thickness (T)	SS 35-63	SS 65-80	SS 85-100
3-4 mm	5 x 10	5 x 12	
5-6, 9 mm	5 x 12	5 x 14	5 x 16
7-8, 9 mm	5 x 14	5 x 16	5 x 18
9-10, 9 mm	5 x 16	5 x 18	5 x 20
11-12, 9 mm	5 x 18	5 x 20	5 x 22
13-14, 9 mm	Trim down	Trim down	5 x 24

## 5 Screwing Sequence

**USE A HEAVY DUTY 18VOLT OR GREATER DRILL**

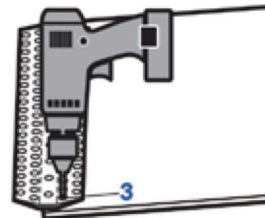
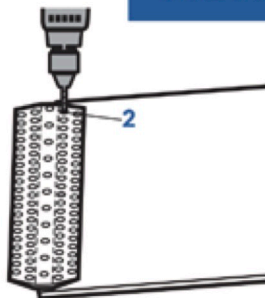
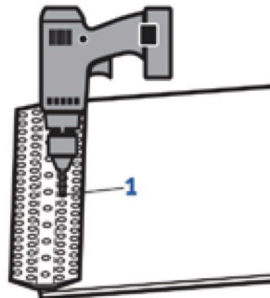

Install one screw in the center of the fastener (1), in the row closest to the spacers.

Then install a screw in both edges of the fastener (2), (3), then in the center between the center screw and the edge screw. Keep centering between the last screws installed (4), skipping from one side of the fastener to the other, and complete the row in this fashion.

Tighten the screws until the fastener slightly puckers, this will indicate that the nut on the back side of the fastener has been seated in the carcass of the belt.

Completely install second row of screws, exactly like the first row, installing the center screw first, the edge screws second, and then the centers until row is complete.

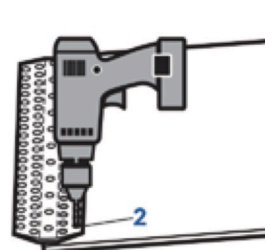
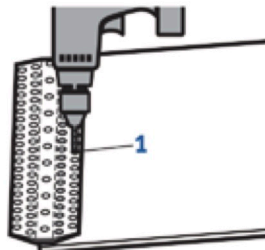
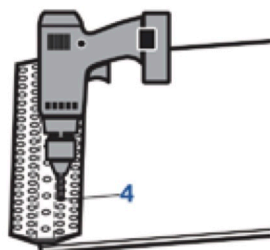

## VERY IMPORTANT! Spacers must be removed!



**REMOVE** spacers across the center of the fastener, discard the spacers. Save the screws. (This will be the last Row of screws installed.)

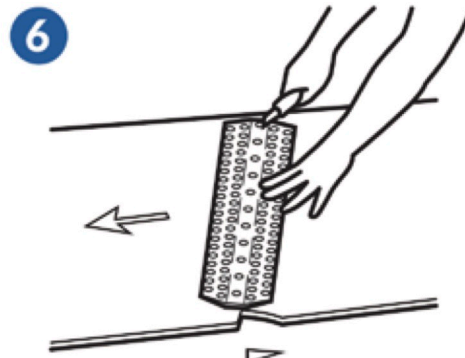

Butt both ends of the belt together for a tight fit, then follow the screwing sequence (see above) for this side, installing the center row last.

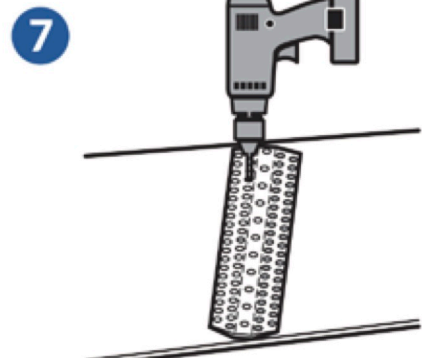

Check the bottom of the fastener making sure the nuts are pulled in the carcass of the belt.





Super-Screw



MS 55 Fasteners



Self-Lock® Fasteners



MR® Fasteners



Super-Screw



Fix'N Go



Clip'N Lock® Fasteners



Super-Screw



PS15 Belt Skiver



Belt repair with Super-Screw



Technical Assistance



Innovative R&D



Product Info Online

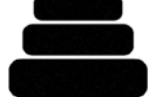

Standard Products Ready to Ship



Training Available



Fast Turnaround

**MLT: A full line of conveyor belt fasteners and conveyor belt products**

## MLT Inc.

2011 Nuggett Rd.  
High Point, NC 27263

Office: 336-434-0363

Fax: 336-434-2263

info@MLTnorthamerica.com

**MLTnorthamerica.com**

Distributor

