

To: All Prospective Bidders

From: C Godbey  
Cynthia Godbey  
Director of Procurement & Contract Administration

Date: January 11, 2019

Re: Project No. CI-121218  
Hammond Village Roofing Project

This addendum is a part of the Contract Documents which modifies the original Bidding Documents dated December 12, 2018 as noted below. Acknowledge receipt of this Addendum in the space provided on the Bid Form. Failure to do so may subject the Bidder to disqualification.

This Addendum consists of one page.

**ADDENDUM #1**

CHANGE:

Bid Date from **January 17, 2019** to **January 24, 2019**

Bid Form: Change from **135 sheets** of plywood to **165 sheets** of plywood.

QUESTIONS:

1. How many sheets of plywood are to be figured in the project?  
ANSWER: 165 sheets of plywood.
2. Will there be any soffit or fascia done as a part of this project?  
ANSWER: No, there will be no replacement of any fascia, soffit, or metal wrap on this project.
3. Under General Part 1C; says to metal wrap fascia.  
ANSWER: See answer to #2 above.
4. Will the contractor be required to install a new "drip edge."  
ANSWER: No, per the City of Columbia Inspection Division the existing "drip edge" is sufficient.
5. What day of the month are draws to be turned in and approximately how long will payment take to receive?  
ANSWER: The housing authority cuts checks on the 10<sup>th</sup> and 25<sup>th</sup> of the month. Pay applications must be received 15 days prior to the check run however, contractors can only submit one pay application per month per project.
6. How many buildings are to be re-roofed? There are 28 buildings in this project, 27 residential buildings and 1 Community building. Note there is no building number 13.

Please submit sealed bids to:

**Cynthia Godbey, Director of Procurement**  
1917 Harden Street  
Columbia, SC 29201-1015

If you have any question regarding this matter please feel free to call me at (803)254-3886 extension 234.

**END OF ADDENDUM NO. 1**

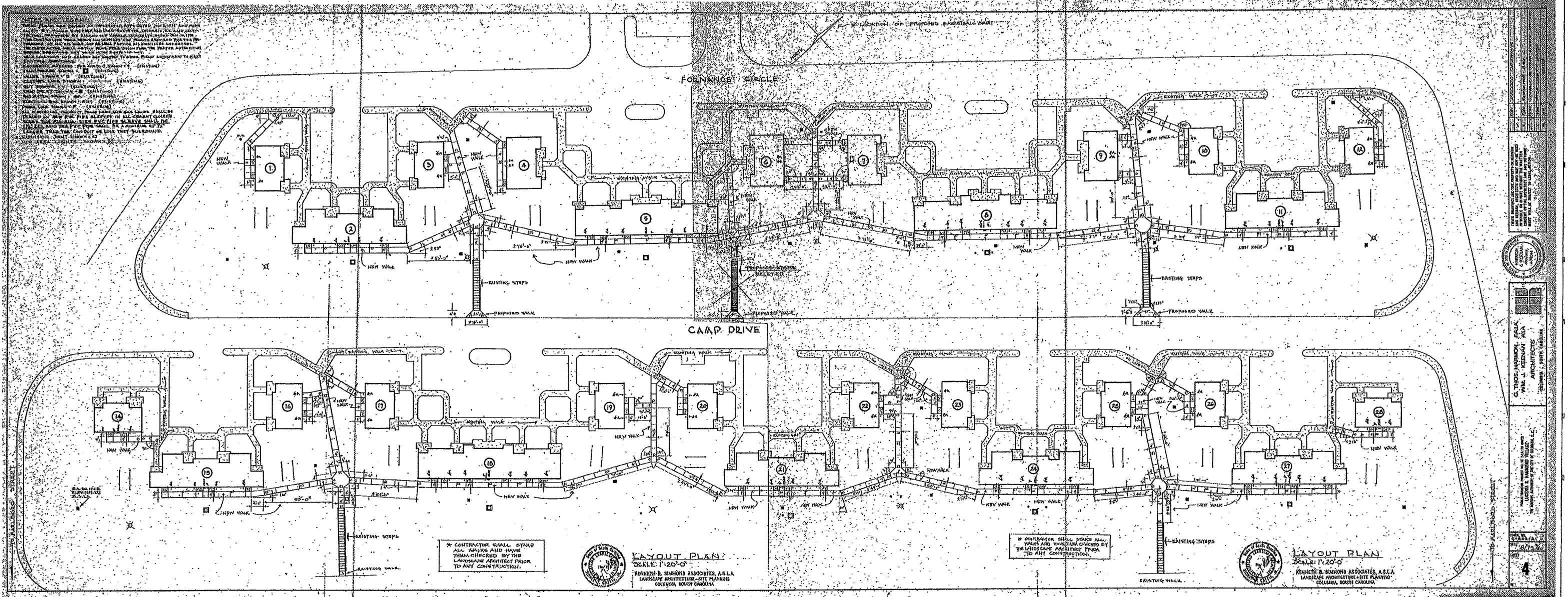

**NOTES:**  
 1. ALL DIMENSIONS ARE TO FACE UNLESS OTHERWISE NOTED.  
 2. ALL DIMENSIONS ARE TO FACE UNLESS OTHERWISE NOTED.  
 3. ALL DIMENSIONS ARE TO FACE UNLESS OTHERWISE NOTED.  
 4. ALL DIMENSIONS ARE TO FACE UNLESS OTHERWISE NOTED.  
 5. ALL DIMENSIONS ARE TO FACE UNLESS OTHERWISE NOTED.  
 6. ALL DIMENSIONS ARE TO FACE UNLESS OTHERWISE NOTED.  
 7. ALL DIMENSIONS ARE TO FACE UNLESS OTHERWISE NOTED.  
 8. ALL DIMENSIONS ARE TO FACE UNLESS OTHERWISE NOTED.  
 9. ALL DIMENSIONS ARE TO FACE UNLESS OTHERWISE NOTED.  
 10. ALL DIMENSIONS ARE TO FACE UNLESS OTHERWISE NOTED.  
 11. ALL DIMENSIONS ARE TO FACE UNLESS OTHERWISE NOTED.  
 12. ALL DIMENSIONS ARE TO FACE UNLESS OTHERWISE NOTED.  
 13. ALL DIMENSIONS ARE TO FACE UNLESS OTHERWISE NOTED.  
 14. ALL DIMENSIONS ARE TO FACE UNLESS OTHERWISE NOTED.  
 15. ALL DIMENSIONS ARE TO FACE UNLESS OTHERWISE NOTED.  
 16. ALL DIMENSIONS ARE TO FACE UNLESS OTHERWISE NOTED.  
 17. ALL DIMENSIONS ARE TO FACE UNLESS OTHERWISE NOTED.  
 18. ALL DIMENSIONS ARE TO FACE UNLESS OTHERWISE NOTED.  
 19. ALL DIMENSIONS ARE TO FACE UNLESS OTHERWISE NOTED.  
 20. ALL DIMENSIONS ARE TO FACE UNLESS OTHERWISE NOTED.  
 21. ALL DIMENSIONS ARE TO FACE UNLESS OTHERWISE NOTED.  
 22. ALL DIMENSIONS ARE TO FACE UNLESS OTHERWISE NOTED.  
 23. ALL DIMENSIONS ARE TO FACE UNLESS OTHERWISE NOTED.  
 24. ALL DIMENSIONS ARE TO FACE UNLESS OTHERWISE NOTED.  
 25. ALL DIMENSIONS ARE TO FACE UNLESS OTHERWISE NOTED.

\* CONTRACTOR SHALL STAKE ALL MARKS AND HAVE THEM CHECKED BY THE LANDSCAPE ARCHITECT PRIOR TO ANY CONSTRUCTION.

\* CONTRACTOR SHALL STAKE ALL MARKS AND HAVE THEM CHECKED BY THE LANDSCAPE ARCHITECT PRIOR TO ANY CONSTRUCTION.



**LAYOUT PLAN**  
 SCALE: 1"=20'-0"  
 RICHARD B. SIMMONS ASSOCIATES, A.S.L.A.  
 LANDSCAPE ARCHITECTS—SITE PLANNERS  
 COLUMBIA, SOUTH CAROLINA

**LAYOUT PLAN**  
 SCALE: 1"=20'-0"  
 RICHARD B. SIMMONS ASSOCIATES, A.S.L.A.  
 LANDSCAPE ARCHITECTS—SITE PLANNERS  
 COLUMBIA, SOUTH CAROLINA

1000 VILLAGE DRIVE  
 COLUMBIA, SOUTH CAROLINA 29201  
 PHONE: 803/792-1111  
 FAX: 803/792-1112  
 WWW: WWW.RBSA.COM  
 RICHARD B. SIMMONS ASSOCIATES, A.S.L.A.  
 LANDSCAPE ARCHITECTS—SITE PLANNERS  
 COLUMBIA, SOUTH CAROLINA  
 PROJECT: HAMMOND VILLAGE  
 DRAWING NO.: 8/75/00  
 DATE: 8/75/00  
 SHEET NO.: 1 OF 1

HAMMOND VILLAGE

# HAMMOND VILLAGE

## SOIL BORING LOCATION MAP

SCALE: 1" = 80'

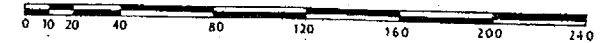

- BENCH MARK LOCATED ON TOP OF FIRE HYDRANT AT NORTHEAST CORNER OF LUCAS ROAD AND MARLBORO ROAD. ELEVATION (137.17) M.S.L.
- EXISTING CONTOURS SHOWN: - - - - - (100)
- BUILDING TYPES DESIGNATED: ① ② ③ ④
- BORING LOCATIONS SHOWN: • 17

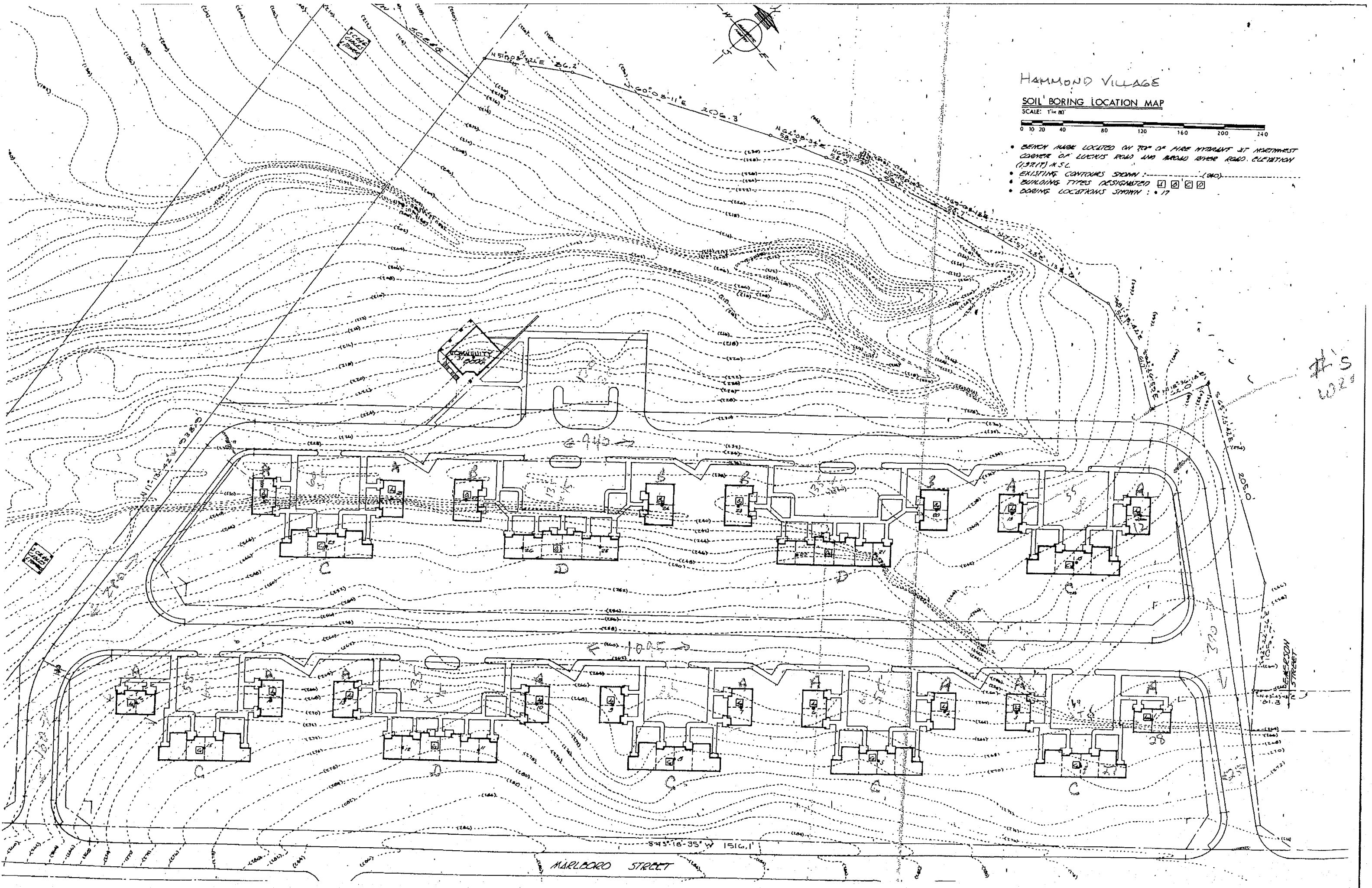

HIS  
WORK

MARLBORO STREET

DIVISION STREET

LUCAS ROAD