

SRPC Reducing Port Connector

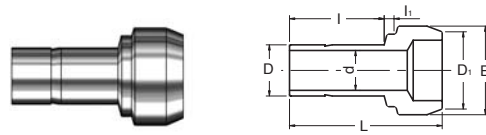

Connects Fractional **SUPERLOK** Port To Male AN

| Part No. | Tube O.D. D ₁ (inch) | Reduced Tube O.D. D (inch) | d | E | I | I ₁ | L |
|--------------|---------------------------------|----------------------------|-------|-------|-------|----------------|-------|
| SRPC 2 - 1 | 1/8 | 1/16 | 0.76 | 6.09 | 8.63 | 2.03 | 17.27 |
| SRPC 4 - 1 | 1/4 | 1/16 | 0.76 | 9.39 | 8.63 | 3.55 | 18.03 |
| SRPC 4 - 2 | 1/4 | 1/8 | 2.10 | 9.39 | 13.46 | 3.30 | 22.60 |
| SRPC 6 - 2 | 3/8 | 1/8 | 2.10 | 12.70 | 13.46 | 3.81 | 23.11 |
| SRPC 6 - 4 | 3/8 | 1/4 | 4.40 | 12.70 | 15.74 | 3.30 | 24.89 |
| SRPC 8 - 4 | 1/2 | 1/4 | 4.40 | 15.74 | 15.74 | 3.81 | 29.21 |
| SRPC 8 - 6 | 1/2 | 3/8 | 6.90 | 15.74 | 17.52 | 3.30 | 30.48 |
| SRPC 12 - 8 | 3/4 | 1/2 | 9.40 | 22.09 | 24.38 | 3.81 | 37.84 |
| SRPC 16 - 8 | 1 | 1/2 | 9.40 | 28.44 | 24.38 | 4.82 | 42.67 |
| SRPC 16 - 12 | 1 | 3/4 | 14.80 | 28.44 | 25.90 | 4.06 | 43.43 |

Installation Instructions Port Connector

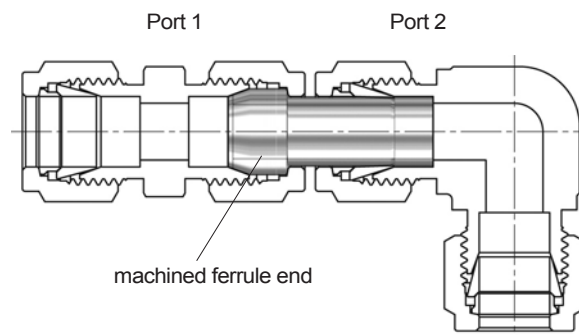

- Remove nut and ferrules from the first of two SUPERLOK ports to be connected.
- Slip nut (not ferrules) over machined ferrule end of port connector.
- Insert port connector into SUPERLOK port 1 and snug by hand.
Tighten with wrench 1/4 turn only. For 1/8, 3/16 in., 2, 3, and 4mm tube fittings, tighten only 1/8 turn. Subsequent connections are made by tightening slightly with a wrench after snugging the nut finger tight.
- Insert other end of the port connector into SUPERLOK port 2 and tighten nut 1 1/4 turns from finger-tight. For 1/16, 1/8, 3/16 in., 2, 3, and 4mm tube fittings, only 3/4 turn from finger-tight is necessary.

• All dimensions in millimeters unless specified as "inch". Dimension are for reference only, subject to change