

# Soils Map

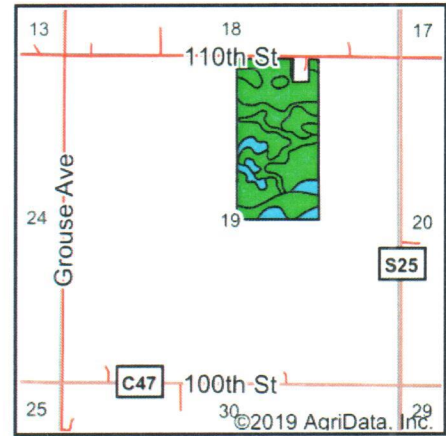

State: Iowa  
 County: Franklin  
 Location: 19-91N-21W  
 Township: Hamilton  
 Acres: 76.69  
 Date: 7/11/2019

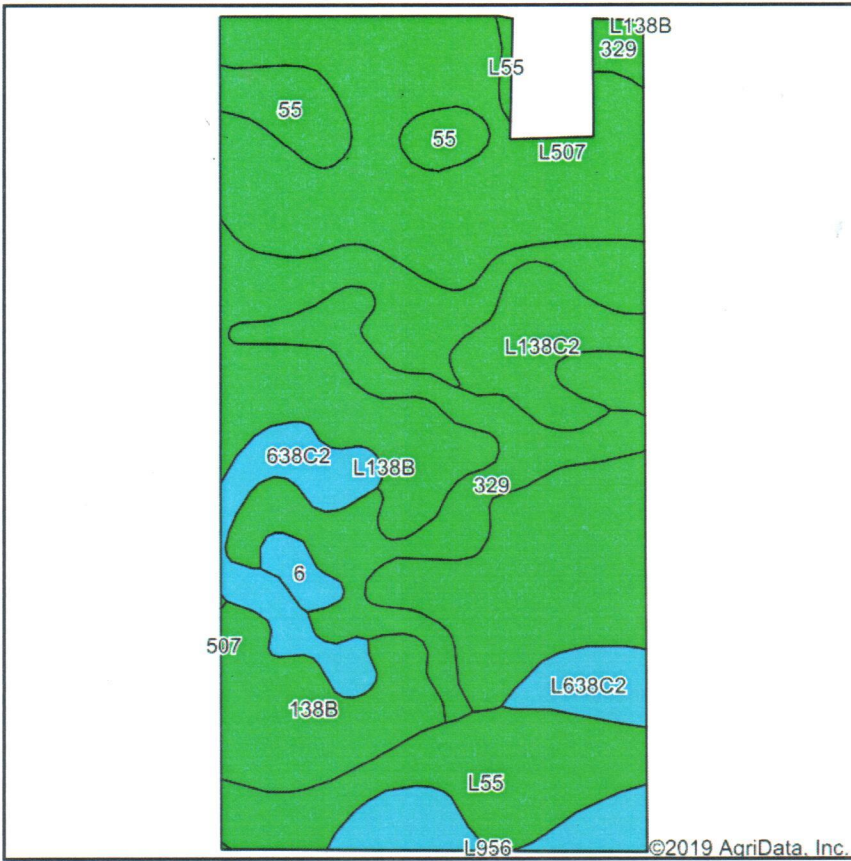

Soils data provided by USDA and NRCS.

Area Symbol: IA069, Soil Area Version: 25												
Code	Soil Description	Acres	Percent of field	CSR2 Legend	Water Table	Restrictive Layer	Septic Limits	Foundation Limits	Non-Irr Class *c	CSR2**	CSR	*n NCCPI Soybeans
L138B	Clarion loam, Bemis moraine, 2 to 6 percent slopes	21.13	27.6%		4.9ft.	> 6.5ft.	somewhat limited	somewhat limited	Ile	88		79
L507	Canisteo clay loam, Bemis moraine, 0 to 2 percent slopes	16.31	21.3%		0.5ft.	> 6.5ft.	very limited	very limited	llw	87		79
329	Webster-Nicollet complex, 0 to 3 percent slopes	9.69	12.6%		2.6ft.	> 6.5ft.	very limited	very limited	llw	87	86	79
L55	Nicollet loam, 1 to 3 percent slopes	7.71	10.1%		1.6ft.	> 6.5ft.	very limited	very limited	Ile	91		83
138B	Clarion loam, 2 to 6 percent slopes	5.79	7.5%		2.9ft.	> 6.5ft.	very limited	somewhat limited	Ile	89	82	83
L138C2	Clarion loam, Bemis moraine, 6 to 10 percent slopes, moderately eroded	3.88	5.1%		4.9ft.	> 6.5ft.	somewhat limited	somewhat limited	Ille	83		60
638C2	Clarion-Storden complex, 6 to 10 percent slopes, moderately eroded	3.80	5.0%		6.3ft.	> 6.5ft.	somewhat limited	somewhat limited	Ille	75	59	65
55	Nicollet clay loam, 1 to 3 percent slopes	2.96	3.9%		1.5ft.	> 6.5ft.	very limited	very limited	Iw	89	89	78
L956	Harps-Okoboji complex, Bemis moraine, 0 to 2 percent slopes	2.75	3.6%		1.6ft.	> 6.5ft.	very limited	very limited	llw	69		76
L638C2	Clarion-Storden complex, Bemis moraine, 6 to 10 percent slopes, moderately eroded	1.85	2.4%		5.5ft.	> 6.5ft.	somewhat limited	somewhat limited	Ille	75		61
6	Okoboji silty clay loam, 0 to 1 percent slopes	0.82	1.1%		0ft.	> 6.5ft.	very limited	very limited	Illw	59	57	77
<b>Weighted Average</b>										<b>85.9</b>	<b>*-</b>	<b>*n 77.4</b>

\*\*IA has updated the CSR values for each county to CSR2.  
 \*- CSR weighted average cannot be calculated on the current soils data, use prior data version for csr values.  
 \*n: The aggregation method is "Weighted Average using major components"  
 \*c: Using Capabilities Class Dominant Condition Aggregation Method  
 Soils data provided by USDA and NRCS.