



METAL-FAB INC.



BIOMASS PRODUCTS
BIOMASS CHIMNEY

FOR USE WITH BIOMASS FUEL-FIRED APPLIANCES.

Type L Biomass Chimney

For use with biomass fuels such as pellet, corn, wheat or other grassy and woody plants as specified by appliance manufacturers.

- Tested and UL 641 Listed.
- Pipe and fittings in 3" and 4" diameters.
- Factory-built double wall construction, using 430 stainless steel flue and galvanized steel outer casing.
- Positive twist lock for easy assembly and disassembly without tools and without damage.
- Rope gaskets at each joint to prevent fly ash leakage.

BIOMASS CHIMNEY INTERIOR - NO OFFSET

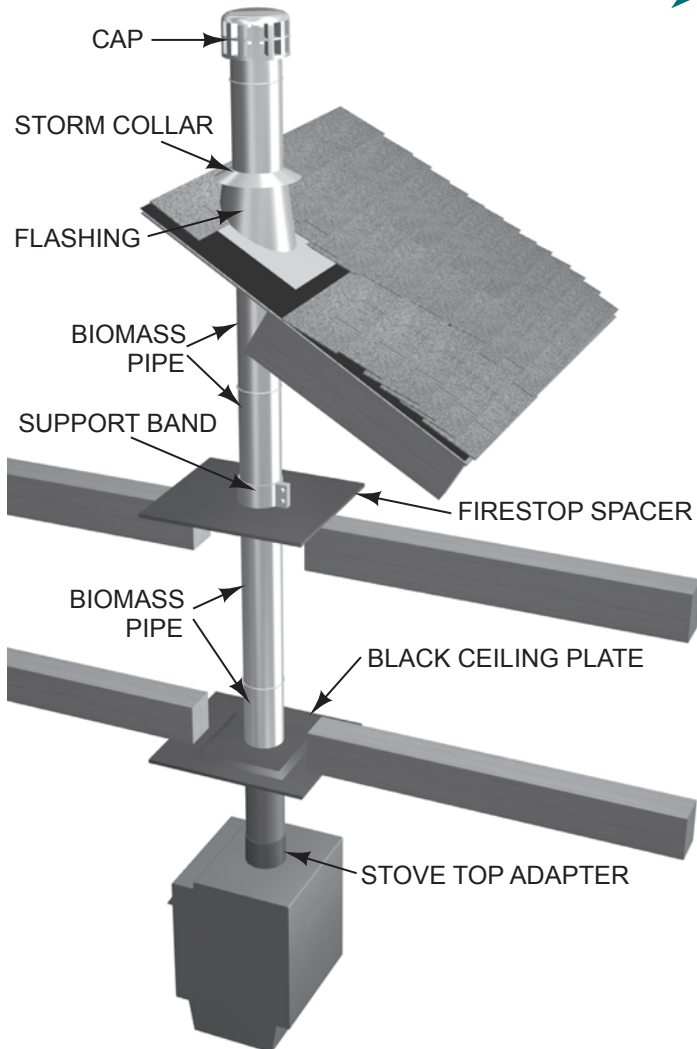

All Biomass Chimney components are available in matte black.

Just add "B" to the end of the part numbers you are ordering.

B

B Indicates available in black.

BIOMASS CHIMNEY REAR EXHAUST INTERIOR - NO OFFSET

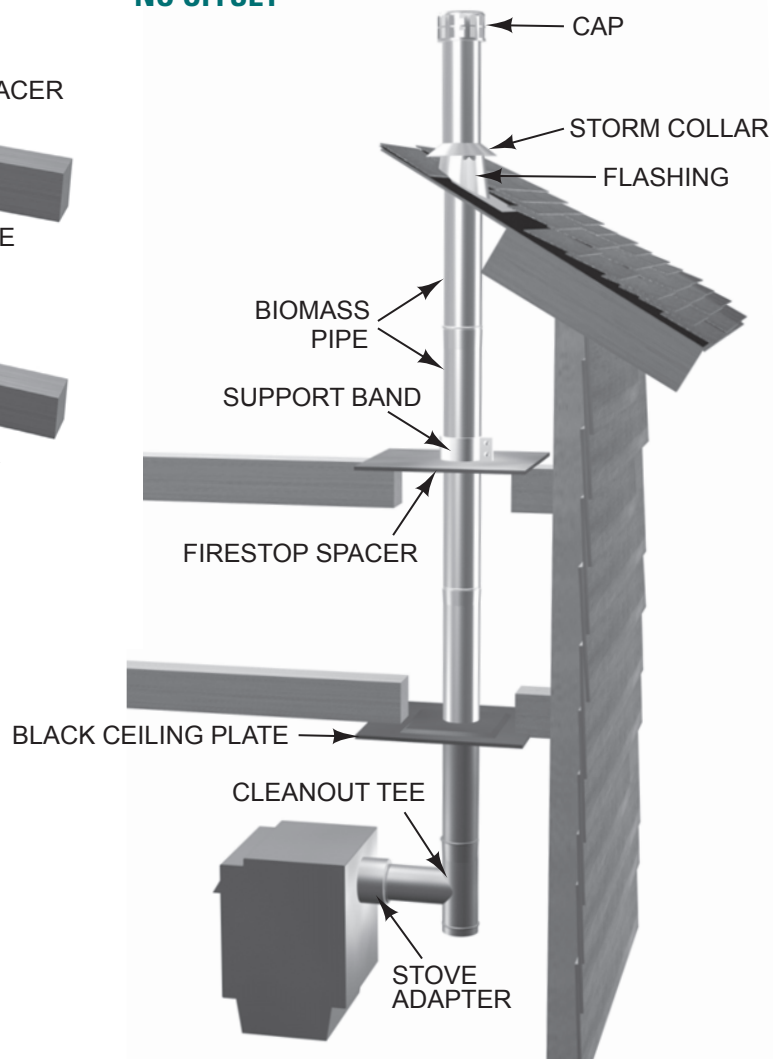

BIOMASS CHIMNEY REAR EXHAUST EXTERIOR

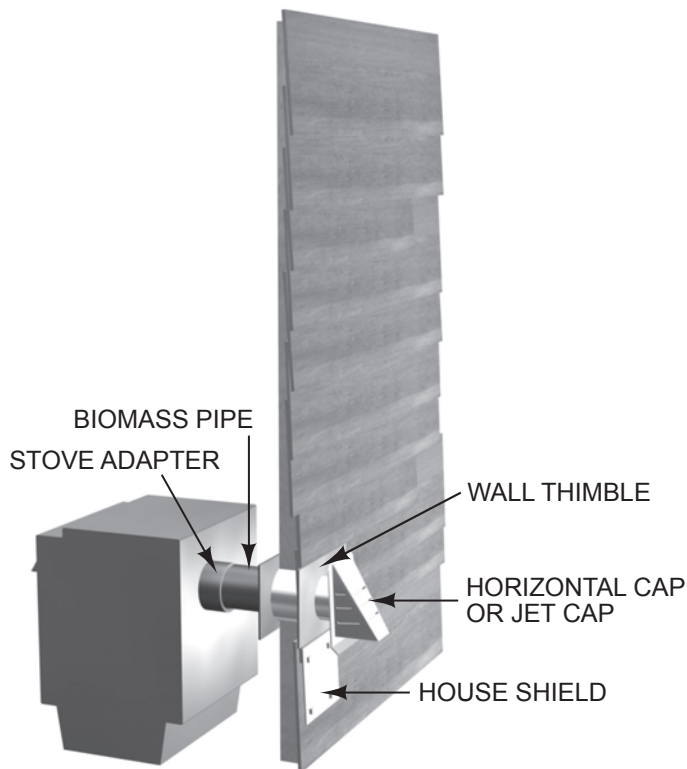

BIOMASS CHIMNEY REAR EXHAUST EXTERIOR - VERTICAL TERMINATION

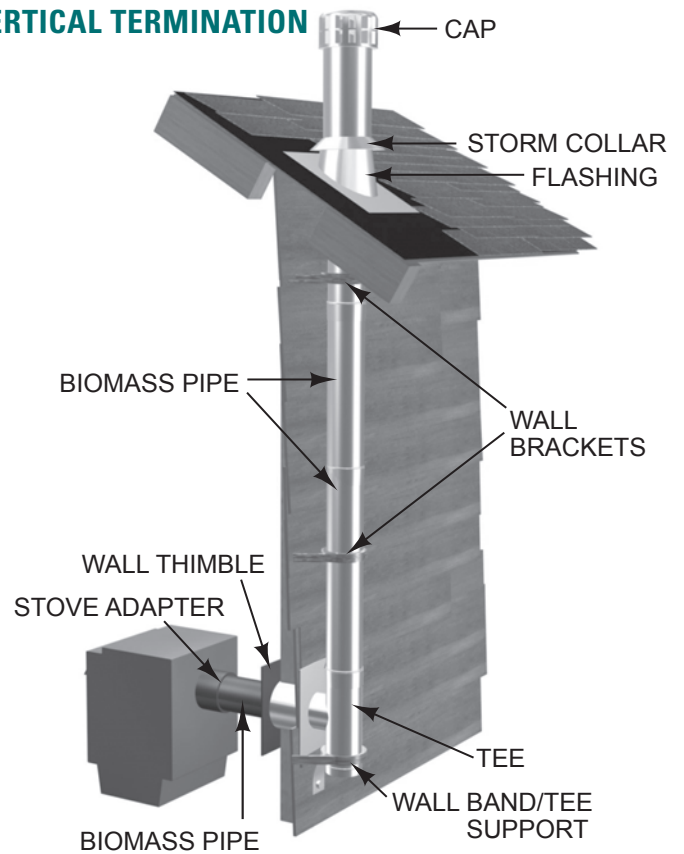

BIOMASS CHIMNEY APPLIANCE INSERT

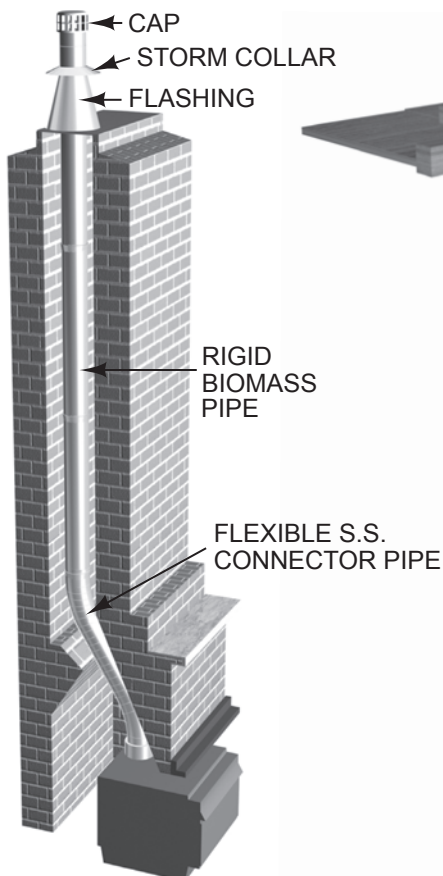

BIOMASS CHIMNEY TOP EXHAUST INTO EXISTING 2100° CHIMNEY

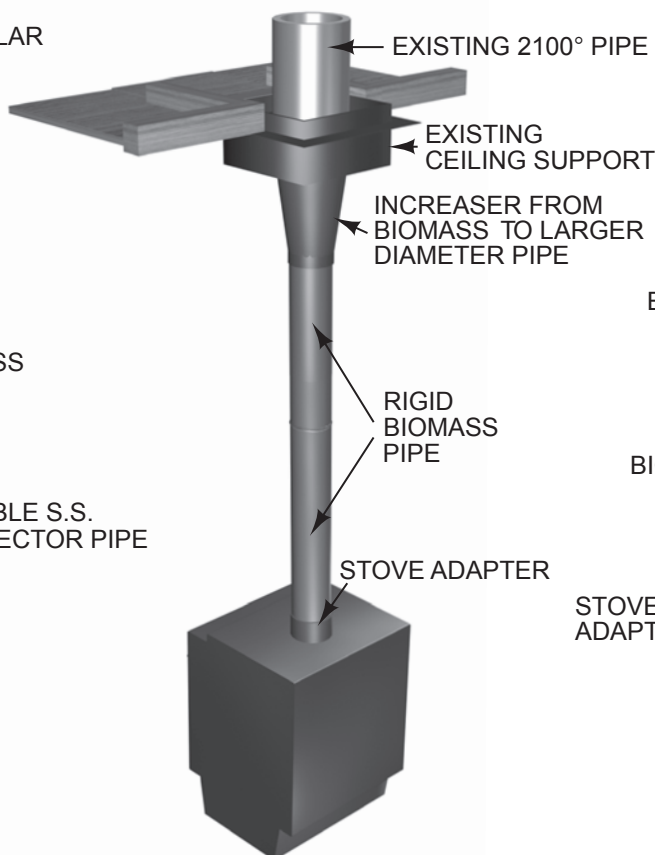

BIOMASS CHIMNEY TOP EXHAUST - EXTERIOR

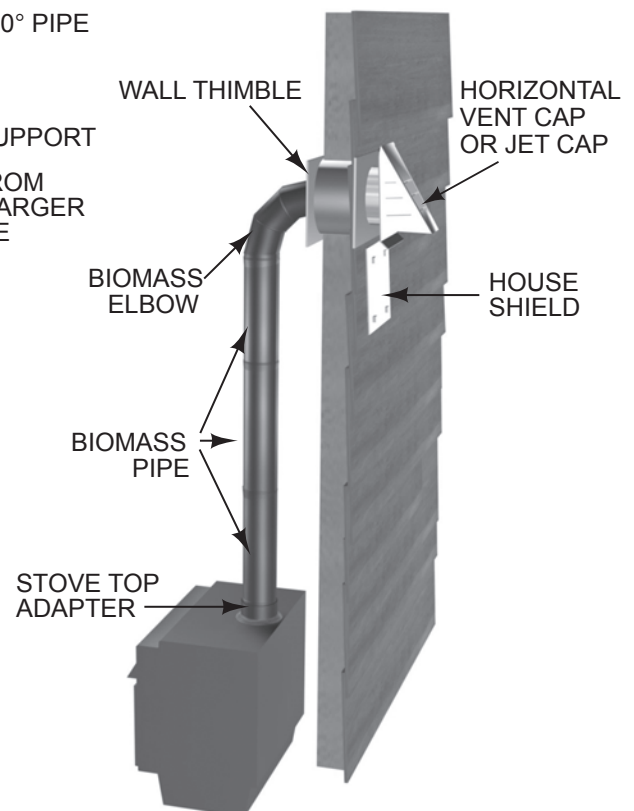

RIGID PIPE LENGTHS – P60, P36, P24, P12, P6

B

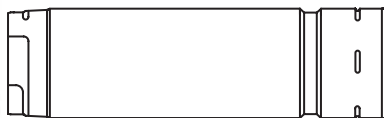

Stainless liner. Galvanized casing.
3" clearance to combustibles.

DIA.	OD	6"	12"	24"	36"	60"
3"	3.50"	X	X	X	X	X
4"	4.50"	X	X	X	X	X

Note: Pipe overlaps 1½" when joined together.
Assembled length is 1½" less than listed length.

ADJUSTABLE LENGTH PIPE – P12A

B

Adjustable length
P12A is used when
fixed pipe lengths
are inappropriate.
Adjustable from 4"
to 8".

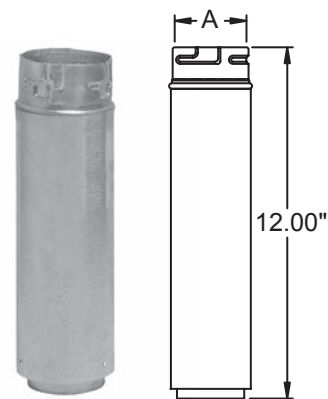

S.S FLEXIBLE CONNECTOR – PFXC



5' Flexible connector length,
with end fittings. Available
in 3" and 4" diameters.

25' S.S. FLEX COIL – SLX



3" and 4" diameter x 25'
coils of 316L acid resistant
stainless steel. Easily
handled, and very flexible.

TRIM SLEEVE – PTS

B

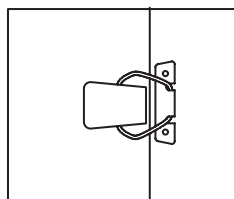

Used at any pipe
joint to enhance
appearance and
reduce joint
leakage.

MALE FLEX ADAPTER – P4A

B

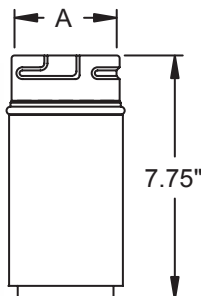

Enables transition
from flex to rigid
pipe.

FEMALE FLEX ADAPTER – P4FA

B

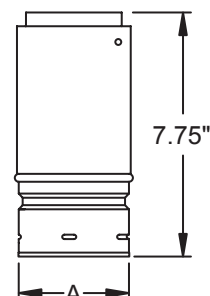

Enables transition
from appliance or
rigid pipe to flex
pipe.

STOVE ADAPTER – STANDARD – PSA

B

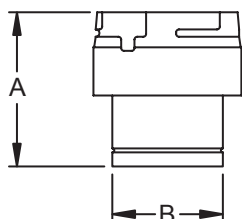

PSA
A = 5.00" length
B = 3.00" or 4.00" I.D.

Use as a connector between stove
exhaust collar and the positive twist lock
of biomass chimney pipe. Order PSA
when O.D. of exhaust collar is a true 3"
or 4" dimension. Order PSAU when
collar is less than 3" or 4" diameter.

STOVE ADAPTER – UNIVERSAL – PSAU

B

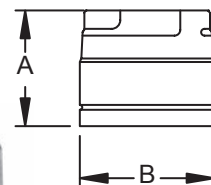

Spacer Tabs

45° ELBOW – P45

B

SIZE	A	B	C	D
3"	4.40"	3.40"	5.57"	14.94"
4"	4.50"	3.80"	5.75"	15.37"

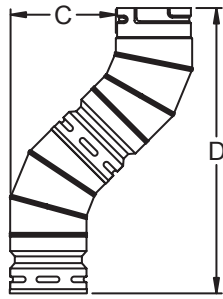
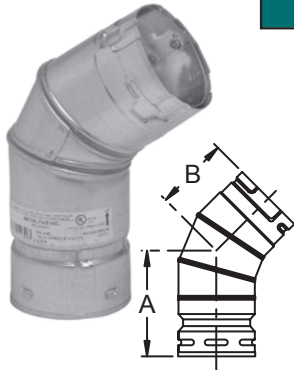

Used to obtain lateral movement around obstructions or to angle the biomass chimney towards the wall thimble. Elbows are factory sealed and are non-adjustable.

90° ELBOW – P90

B

SIZE	A	B	C	D
3"	5.50"	5.75"	11.75"	13.25"
4"	6.40"	6.50"	12.13"	13.63"

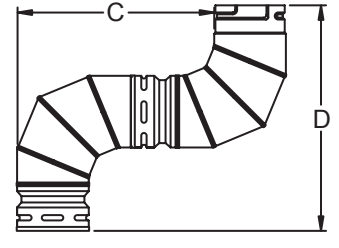
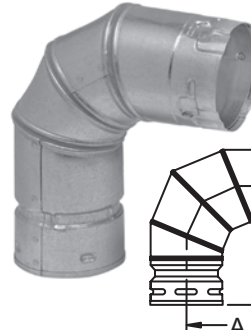

STANDARD TEE W/PULL-OFF CAP – PT

B

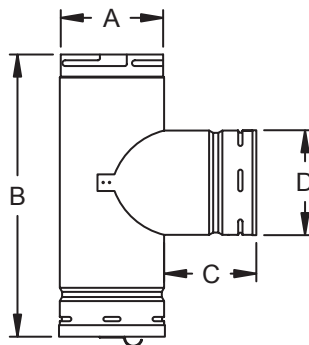

SIZE	A	B	C	D
3"x 3"	3.50"	9.13"	3.00"	3.50"
4"x 4"	4.50"	10.13"	3.00"	4.50"

Use tee to transition from horizontal to vertical inside or to an exterior chimney that is mounted to a tee support.

REDUCED TAP TEE W/PULL-OFF CAP – 4PT3

B

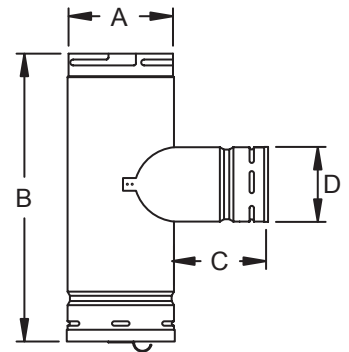

SIZE	A	B	C	D
4"x 3"	4.50"	10.13"	3.00"	3.50"

REDUCED TAP TEE W/ADAPTER – 4PT3A

B

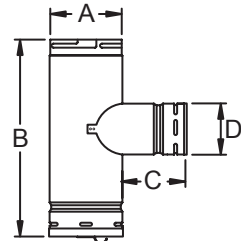

For use at the appliance. Extended flue at tap fits stove outlet.

SIZE	A	B	C	D
4"x 3"	4.50"	10.13"	3.00"	3.50"

FLEX TEE – 3PFLXT AND 4PFLXT3

B

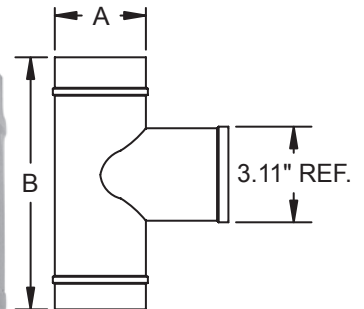

Connects appliance to S.S. pellet flex pipe.

SIZE	A	B
3"	3.11"	8.75"
4"	4.11"	9.75"

STANDARD TEE CAP – PTC

B

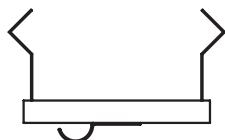
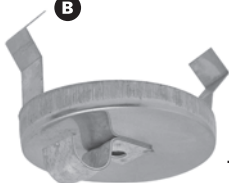

This part number applies when tee cap is sold separately.

TWIST-OFF TEE CAP – PCTC

B

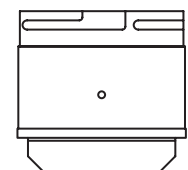

This part number applies when tee cap is sold separately.

Note: Pipe overlaps 1½" when joined together.
Assembled length is 1½" less than listed length.

HORIZONTAL CLEANOUT TEE W/TWIST-OFF TEE CAP – PCT

B

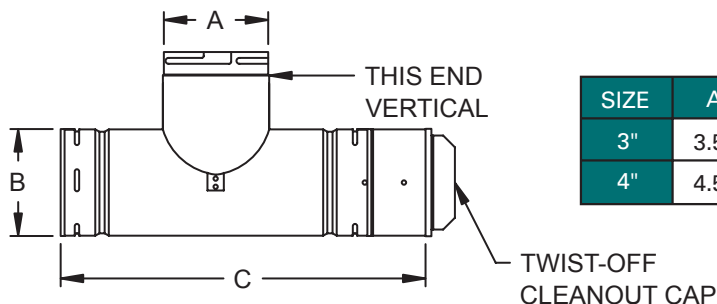

SIZE	A	B	C
3"	3.50"	3.50"	11.00"
4"	4.50"	4.50"	14.12"

VERTICAL CLEANOUT TEE W/TWIST OFF TEE CAP – PVCT

B

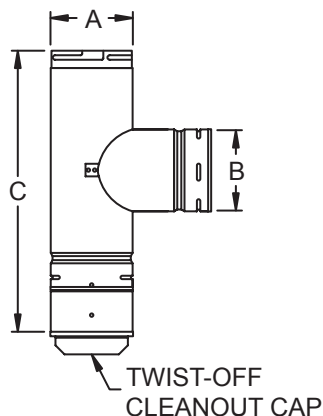

SIZE	A	B	C
3"	3.50"	3.50"	11.00"
4"	4.50"	4.50"	14.12"

COMBINATION WALL BAND/TEE SUPPORT – PWBS

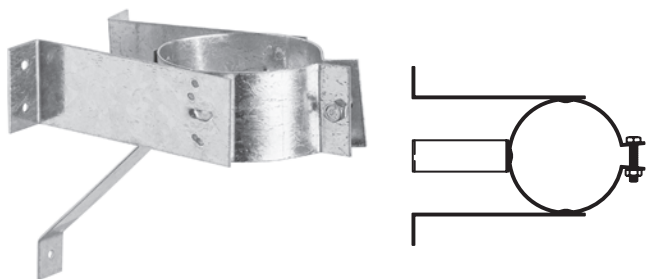

Provides exterior, vertical/lateral support for chimney. Maximum height of chimney which can be supported is 30 feet.

SUPPORT ADJUSTMENT KIT – PWAS

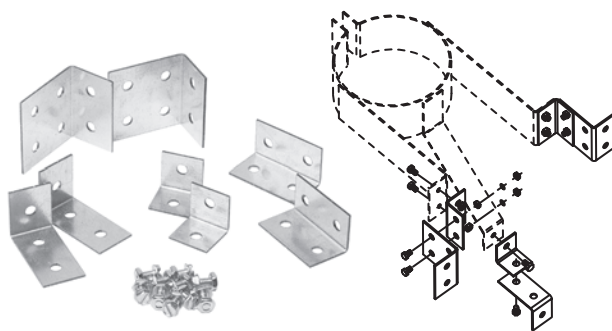

Enables adjustment of standard wall support (PWBS) from minimum 3" to maximum 5".

WALL BRACKET – PWB

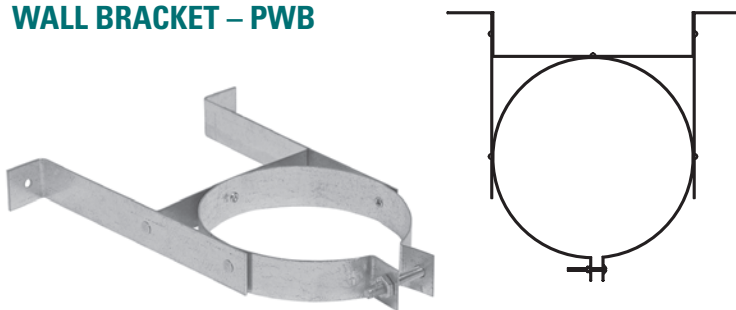

Used to provide lateral support while maintaining proper clearance. Recommended spacing is 6 ft. between bands above the starting point.

WALL BRACKET ADJUSTMENT KIT – PWBA

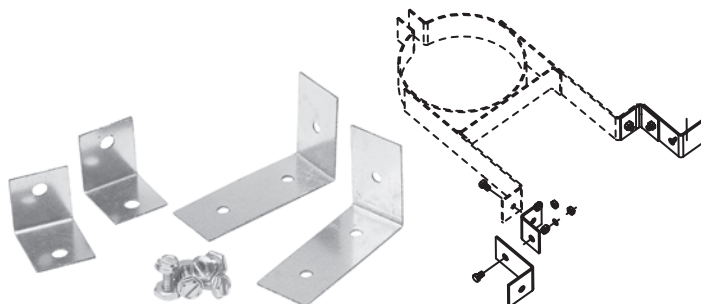

Enables adjustment of standard wall bracket (PWB) from minimum 3" to maximum 5".

WALL THIMBLE – PWT

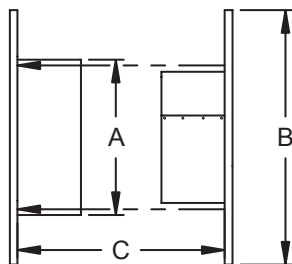
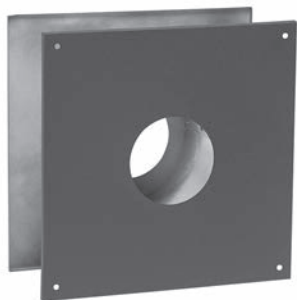

SIZE	A	B	C
3"	6.13"	10.13"	5.00" TO 9.50"
4"	7.13"	10.13"	5.00" TO 9.50"

Provides the proper clearance for the pellet/corn pipe when it passes through a combustible wall.

HOUSE SHIELD – PHS

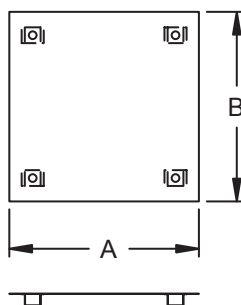

SIZE	A	B
3"	12.00"	18.00"
4"	12.00"	18.00"

Used in horizontal vent applications to provide extra protection from discharge.

ROOF SUPPORT – PRS

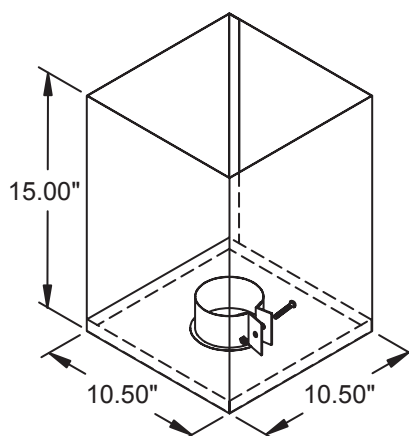

For use on open beamed pitched roofs or ceilings. Includes trim pieces for finishing out installation. Also includes support band.

BLACK CEILING PLATE – PCP

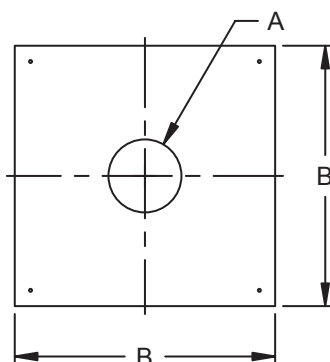

SIZE	A	B
3"	3.63"	17.50"
4"	4.63"	17.50"

Used as an exposed surface trim piece where biomass chimney passes through a floor or ceiling.

FIRESTOP SPACER – PFS

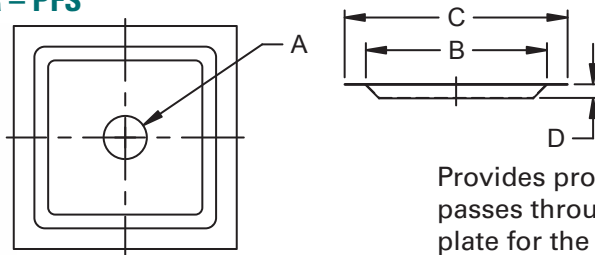
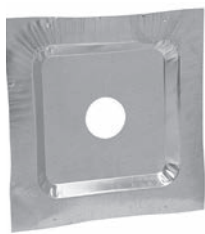

SIZE	A	B	C	D
3"	3.56"	13.00"	17.50"	1.00"
4"	4.56"	13.00"	17.50"	1.00"

Provides proper clearance where biomass chimney passes through a floor or the ceiling. Serves as a support plate for the support band (sold separately).

SUPPORT BAND – PSB

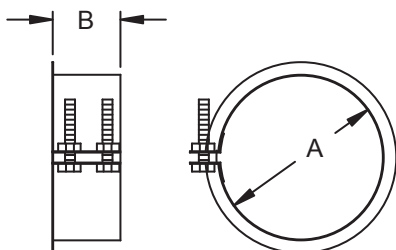
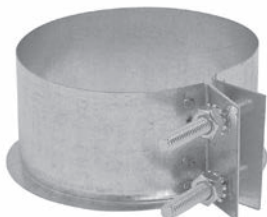

SIZE	A	B
3"	3.56"	1.50"
4"	4.56"	1.50"

Used to support the biomass chimney as it passes through the firestop spacer or roof support. This piece typically sits on top of the firestop spacer or inside the roof support.

VERTICAL VENT CAP – PRC

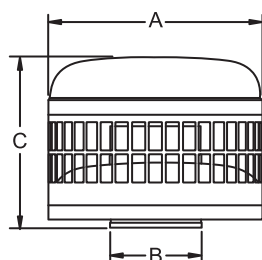
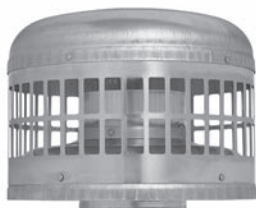

SIZE	A	B	C
3"	8.25"	3.00"	6.75"
4"	8.25"	4.00"	6.75"

Stainless steel cap guards against rain, snow, and down drafts. Helps provide proper venting action. Attractive design enhances appearance.

HORIZONTAL VENT CAP – PHC

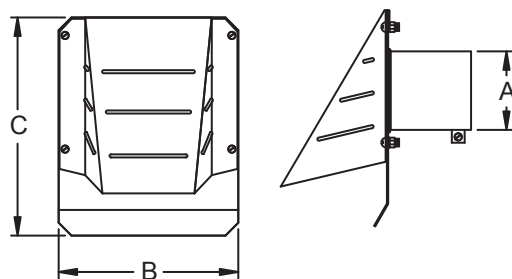

SIZE	A	B	C
3"	3.50"	7.00"	10.00"
4"	4.50"	7.00"	10.00"

Stainless steel cap prevents entrance of rain and directs flue gasses away from house.

HORIZONTAL JET CAP – PJC

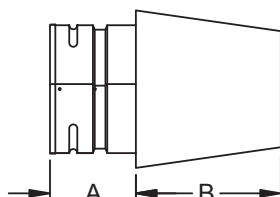

SIZE	A	B
3"	3.00"	5.25"
4"	3.00"	5.25"

Jet cap directs flue gas away from house.

STANDARD FLASHING – PF

SIZE	A	B	PLATE SIZE
3"	3.63"	7.50"	14.63" x 14.63"
4"	4.63"	7.50"	14.63" x 14.63"

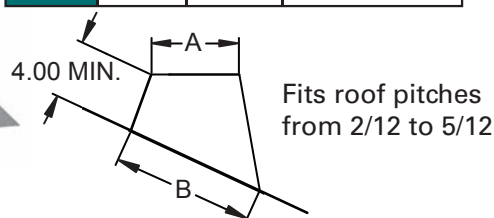
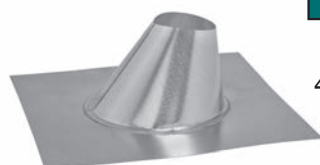

HIGH PITCH FLASHING – PF-12

SIZE	A	B	PLATE SIZE
3"	3.69"	12.00"	20.00" x 20.00"
4"	4.69"	12.00"	20.00" x 20.00"

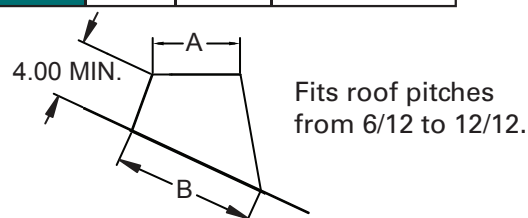

TALL CONE FLASHING – PFT

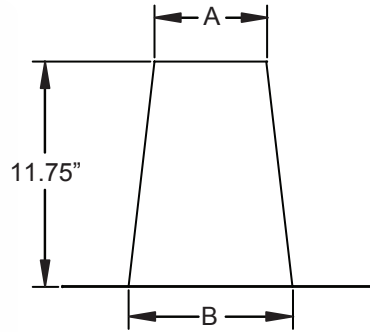
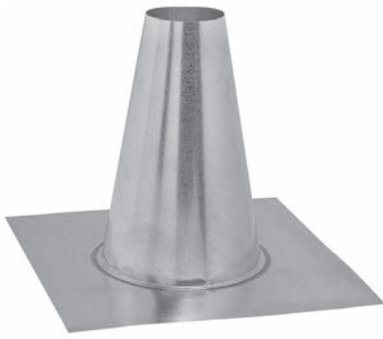

SIZE	A	B	PLATE SIZE
3"	3.60"	7.50"	14.63" x 14.63"
4"	4.60"	7.50"	14.63" x 14.63"

Fits roof pitches from 0/12 to 2/12

STORM COLLAR – PSC

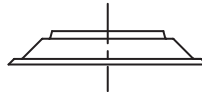
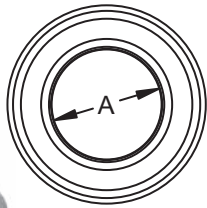

SIZE	A
3"	3.53"
4"	4.53"

Used in combination with the flashing to ensure water-tight installation. Slips around pipe above the flashing.

3" to 4" INCREASER – 3PI4

B

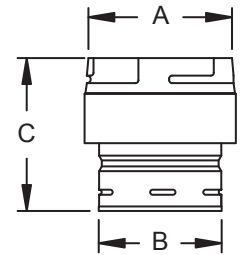

A = 4.00" B = 3.00" C = 4.75"

Provides transition from 3" to 4" diameter pipe.

INCREASERS TO TEMP/GUARD – P6SWA AND P8SWA

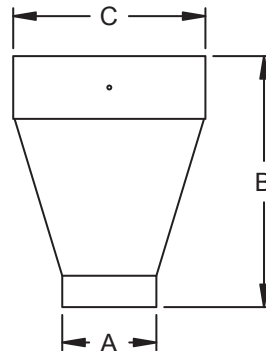

PART	A	B	C
3P6SWA	3.00"	8.00"	6.13"
4P6SWA	4.00"	8.00"	6.13"
4P8SWA	4.00"	8.00"	8.13"

VERTICAL INSTALLATION KIT – 3PVK



Available in 3" only.
Includes:

- Vertical Cap
- Standard Tee
- 12" Adjustable Length
- Stove Adapter-Standard
- Wall Thimble
- Wall Band/Tee Support
- 2 Wall Bands

HORIZONTAL INSTALLATION KIT – 3PHK



Available in 3" only.
Includes:

- Horizontal Cap
- Standard Tee
- 90 Degree Elbow
- Stove Adapter-Standard
- Wall Thimble
- Wall Band

"L" VENT FOR OIL COMPONENTS

Note: Pipe overlaps 1½" when joined together.
Therefore, assembled length is 1½" less than listed length.

Metal-Fab Type "L" Vent is tested and listed to UL 641 for venting high efficiency oil appliances with maximum flue temperatures of 570°. Double wall construction includes a galvanized exterior jacket, with a stainless inner liner. Available in diameters of 4", 5" and 6". May be used as a connector or as a complete system on oil appliances that are listed as suitable for use with Type "L" Vent.

RIGID PIPE LENGTHS – P60, P36, P24, P12,

* PS60, PS36 (5" & 6" only)



Stainless liner. Galvanized casing.
*Stainless liner. Stainless casing.

DIA	OD	12"	24"	36"	60"
4"	4.50"	X	X	X	X
5"	5.50"	X	X	X	X
6"	6.50"	X	X	X	X

ADJUSTABLE LENGTH PIPE – P12A

Adjustable length P12A is used when fixed pipe lengths are inappropriate. Adjustable from 4" to 8".

Diameters
4", 5", 6"

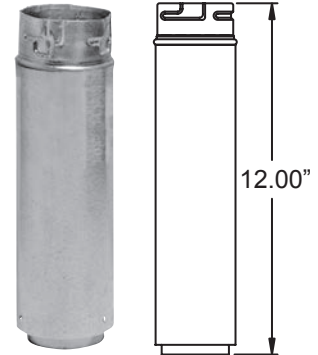

APPLIANCE ADAPTER – PSA

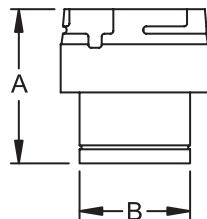

PSA
A = 5.00" length
B = 4.00", 5.00" & 6.00" I.D.

Use as a connector between appliance exhaust collar and the positive twist lock of "L" Vent pipe.

VERTICAL VENT CAP – PRC

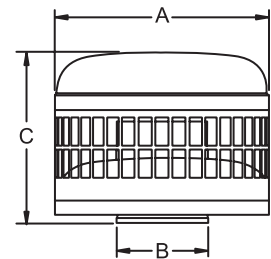
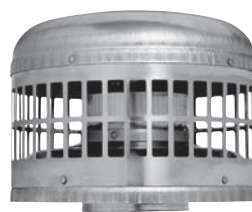

SIZE	A	B	C
5"	10.00"	5.50"	6.50"
6"	12.00"	6.50"	6.50"

Stainless steel cap guards against rain, snow, and down drafts. Helps provide proper venting action.

45° ELBOW – P45 ADJ. IN 5" & 6" FIXED IN 4"

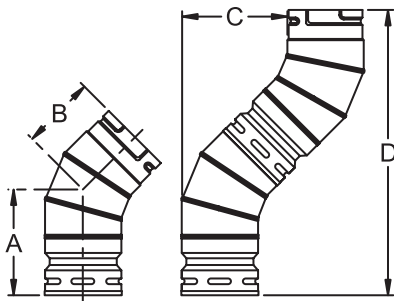

Used to obtain lateral movement around obstructions or to angle the "L" Vent pipe towards the wall thimble.

SIZE	A	B	C	D
4"	4.50"	3.80"	5.75"	15.37"
5"	5.92"	4.96"	6.63"	17.51"
6"	6.63"	4.02"	6.47"	17.12"

90° ELBOW – P90 ADJ. IN 5" & 6" FIXED IN 4"

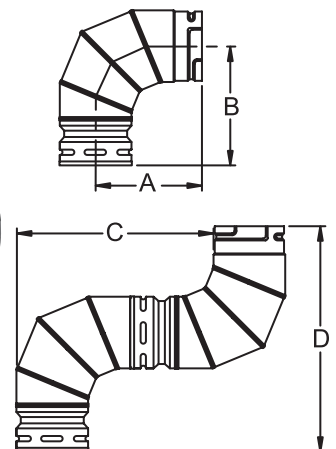

SIZE	A	B	C	D
4"	6.40"	6.50"	12.13"	13.63"
5"	6.17"	6.95"	10.84"	13.90"
6"	5.60"	6.95"	9.70"	13.90"

STANDARD TEE W/PULL-OFF CAP – PT

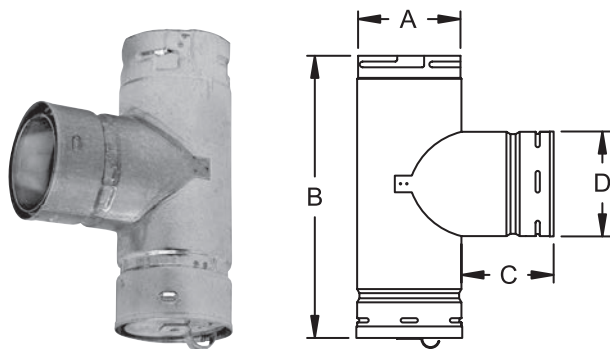

SIZE	A	B	C	D
4"	4.50"	10.13"	3.00"	4.50"
5"	5.50"	11.13"	3.00"	5.50"
6"	6.50"	12.13"	3.00"	6.50"

Use tee to transition from horizontal to vertical inside or to an exterior chimney the is mounted to a tee support.

STANDARD TEE CAP – PTC

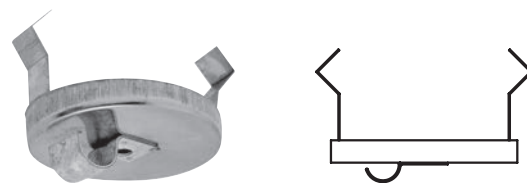

This part number applies when tee cap is sold separately.

COMBINATION WALL BAND/TEE SUPPORT – PWBS

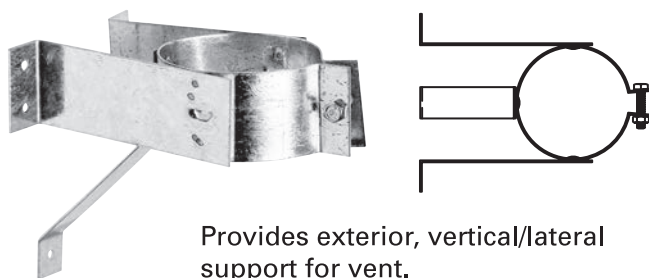

Provides exterior, vertical/lateral support for vent.

WALL BRACKET – PWB (4") WALL HANGER – PWH (5" & 6")

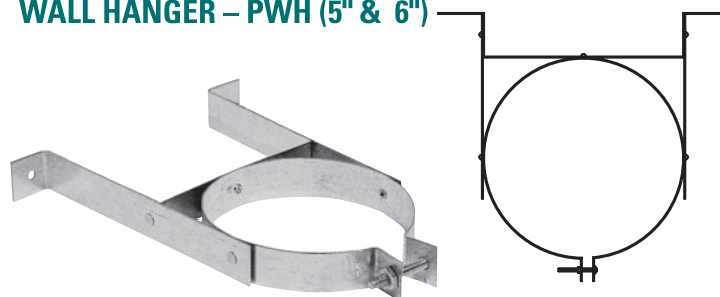

Used to provide lateral support while maintaining proper clearance. Recommended spacing is 6 ft. between bands above the starting point.

FIRESTOP SPACER – PFS

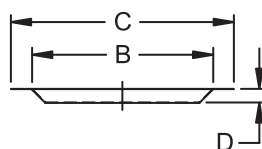
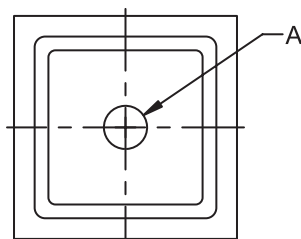
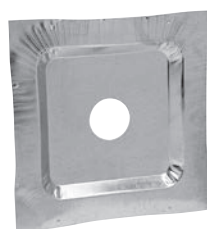

SIZE	A	B	C	D
4"	4.56"	13.00"	17.37"	1.00"
5"	5.56"	13.00"	17.37"	1.00"
6"	6.56"	13.00"	17.37"	1.00"

Provides proper clearance where "L" Vent pipe passes through a floor or the ceiling. Serves as a support plate for the support band (sold separately).

SUPPORT BAND – PSB

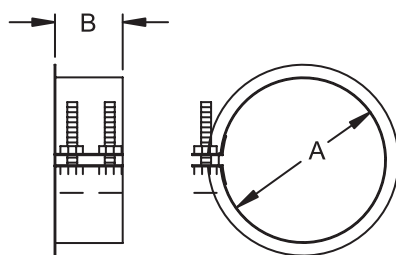
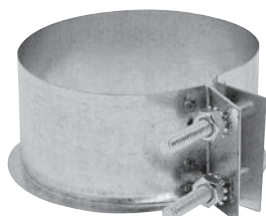

SIZE	A	B
4"	4.56"	1.75"
5"	5.56"	1.75"
6"	6.56"	1.75"

Used to support the "L" Vent pipe as it passes through the firestop spacer. This piece typically sits on top of the firestop spacer.

STANDARD STAINLESS FLASHING – PSF

SIZE	A	B	PLATE SIZE
5"	5.63"	8.25"	14.63" x 14.63"
6"	6.63"	9.50"	17.50" x 17.50"

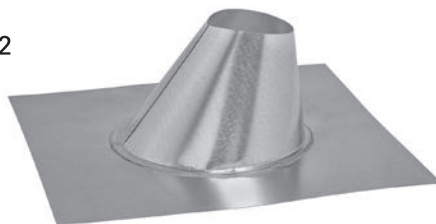
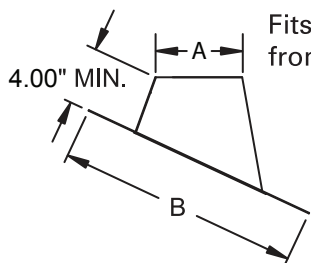

HIGH PITCH STAINLESS FLASHING – PSF-12

SIZE	A	B	PLATE SIZE
5"	5.69"	12.00"	20.00" x 20.00"
6"	6.75"	12.50"	21.00" x 28.00"

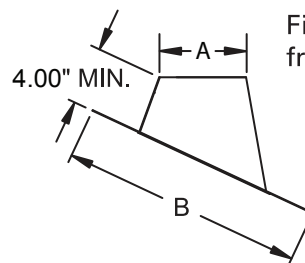

TALL CONE STAINLESS FLASHING – PSFT

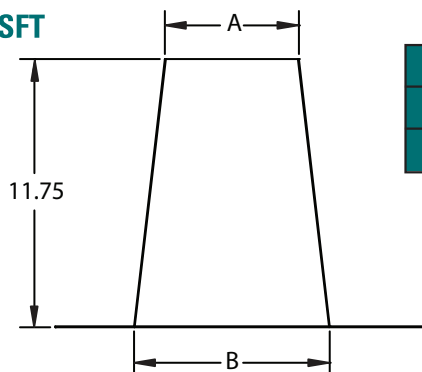

SIZE	A	B	PLATE SIZE
5"	5.60"	8.25"	14.63" x 14.63"
6"	6.60"	9.50"	17.00" x 17.00"

Fits roof pitches from 0/12 to 2/12

STAINLESS STORM COLLAR – PSSC

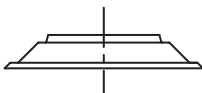
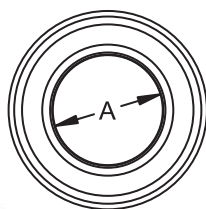

SIZE	A
5"	5.53"
6"	6.53"

Used in combination with the flashing to ensure water-tight installation. Slips around pipe above the flashing.

4" to 5" INCREASER – 4PI5

5" to 6" INCREASER – 5PI6

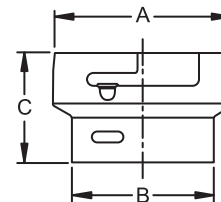

SIZE	A	B	C
4" TO 5"	5.50"	4.50"	2.68"
5" TO 6"	6.50"	5.50"	2.68"

Provides transition to larger diameter pipe.

WALL THIMBLE – PWT

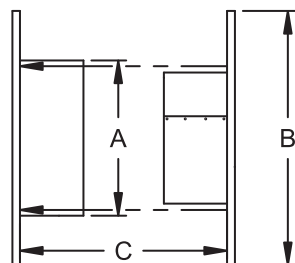
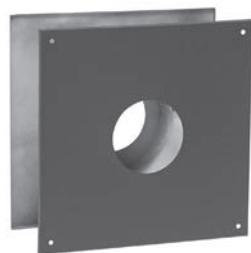

SIZE	A	B	C
4"	7.00"	13.00"	5.00" TO 9.50"
5"	8.00"	13.00"	5.00" TO 9.50"
6"	9.00"	13.00"	5.00" TO 9.50"

Provides the proper clearance for the "L" Vent pipe when it passes through a combustible wall.



800-835-2830