



# CASCADE TOWERS

## East Tower Suite 805

20819 72nd Avenue South, Kent, WA 98032

Twin 8-Story Class A Office Towers with a Fountain and Central Pedestrian Promenade.

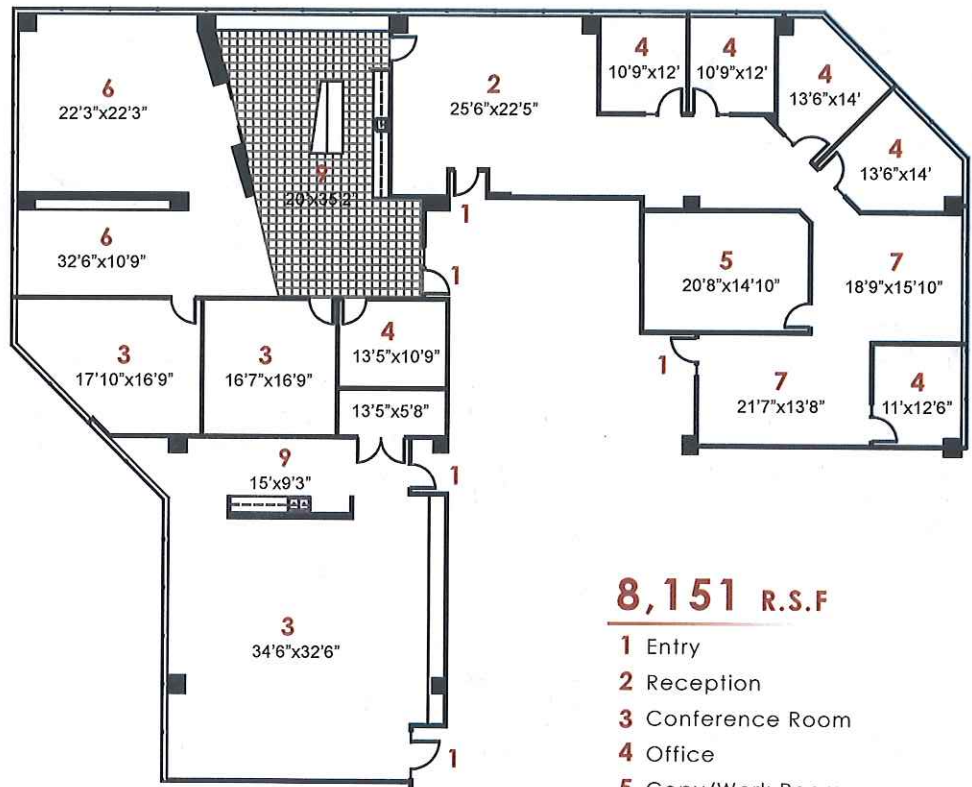

**8,151 R.S.F.**

- 1 Entry
- 2 Reception
- 3 Conference Room
- 4 Office
- 5 Copy/Work Room
- 6 Break-out Area
- 7 Open Office Area
- 8 Storage/I.T.
- 9 Break Room

(253) 395-9226

Rob Samuels | Leasing Coordinator  
RobS@FountainheadNW.com

CREATING THE **BEST PLACE**  
FOR THE **BEST PEOPLE** TO WORK.



www.FountainheadNorthwest.com

The Cascade Towers at CenterPoint Corporate Park.

# ENGAGE YOUR EMPLOYEE'S NEEDS...

## CULTURE & AMENITIES



- 1/4 & 1/2 Mile Outdoor Fitness Paths with Stretching Station
- On-Site Management, Engineering & Design Team
- Corporate Barbeque Areas
- Nature trail along Mill Creek
- Conference Center with rooms up to 200 people

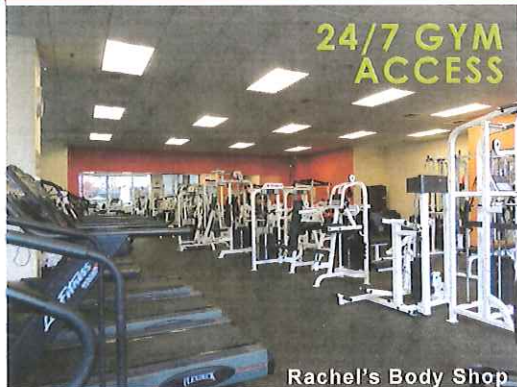

### 24/7 GYM ACCESS

Rachel's Body Shop

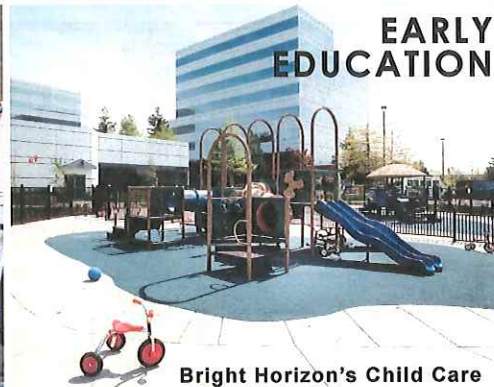

### EARLY EDUCATION

Bright Horizon's Child Care



### FULL SERVICE

Alki Bakery Cafe

Full service 24/7 fitness center & personal training ([www.rachelsbodyshop.com](http://www.rachelsbodyshop.com))

Providing infant to pre-kindergarten programs ([www.brighthorizons.com](http://www.brighthorizons.com))

Providing breakfast, lunch & catering services. ([www.alkibakery.com](http://www.alkibakery.com))

## CLOSE TO EVERYTHING..

- Shopping
- Hotels
- Restaurants
- Entertainment
- Schools
- Housing

## + ON SITE TRANSPORTATION ROUTES

FOR MORE INFORMATION  
[www.FountainheadNorthwest.com](http://www.FountainheadNorthwest.com)  
 253-395-9226

### Access to FOUR major highways!

