



SWIMMING POOL HANDOUT

PLACEMENT ON LOT

Minimum setback requirements for swimming pools are as follows:

- Must be located in either the rear yard or side yard of the dwelling.
- Must be located a minimum five (5) feet from any property line.
- Must be located a minimum twenty (20) feet from the livable portion or 15 feet from a non livable portion of a neighbor's residence.
- Must be located a minimum twelve (12) feet from the side property line of an adjacent vacant lot.
- Swimming pool must be enclosed with a minimum six (6) foot fence with self closing and self latching gates.
- Lighting must be directed so as to not cause a disturbance to neighboring properties.
- Pool equipment, pool sheds or equipment buildings must meet the requirements of the adopted building code and Hooper City zoning for placement and permits.

PERMIT REQUIREMENTS

The following documentation is required for a swimming pool permit:

- ___ 1 – Completed Hooper City permit application.
- ___ 2 – 2 sets of engineered building plans.
- ___ 3 – 2 copies of the site plan. Site plan must be drawn to scale (minimum scale 1"=20') and include actual setbacks from property lines and existing structures for the pool and associated equipment and the location of any windows or other openings in the dwelling. (See example on reverse side)
- ___ 4 – Building permits are required for equipment buildings over 200 sq. ft.; compliance permits are required if under 200 sq. ft.

DISCLAIMER

The information on this handout is not intended to be a complete list of requirements for swimming pools. This information is however a general list of those items which are typically overlooked or missed by the owner or builder. Whether the work is done by a licensed General Contractor, or by the homeowner, both are required to comply with all model codes adopted by the State of Utah, as well as Hooper City ordinances.

ADDRESS:
SUBDIVISION:
LOT:

INTERIOR LOT

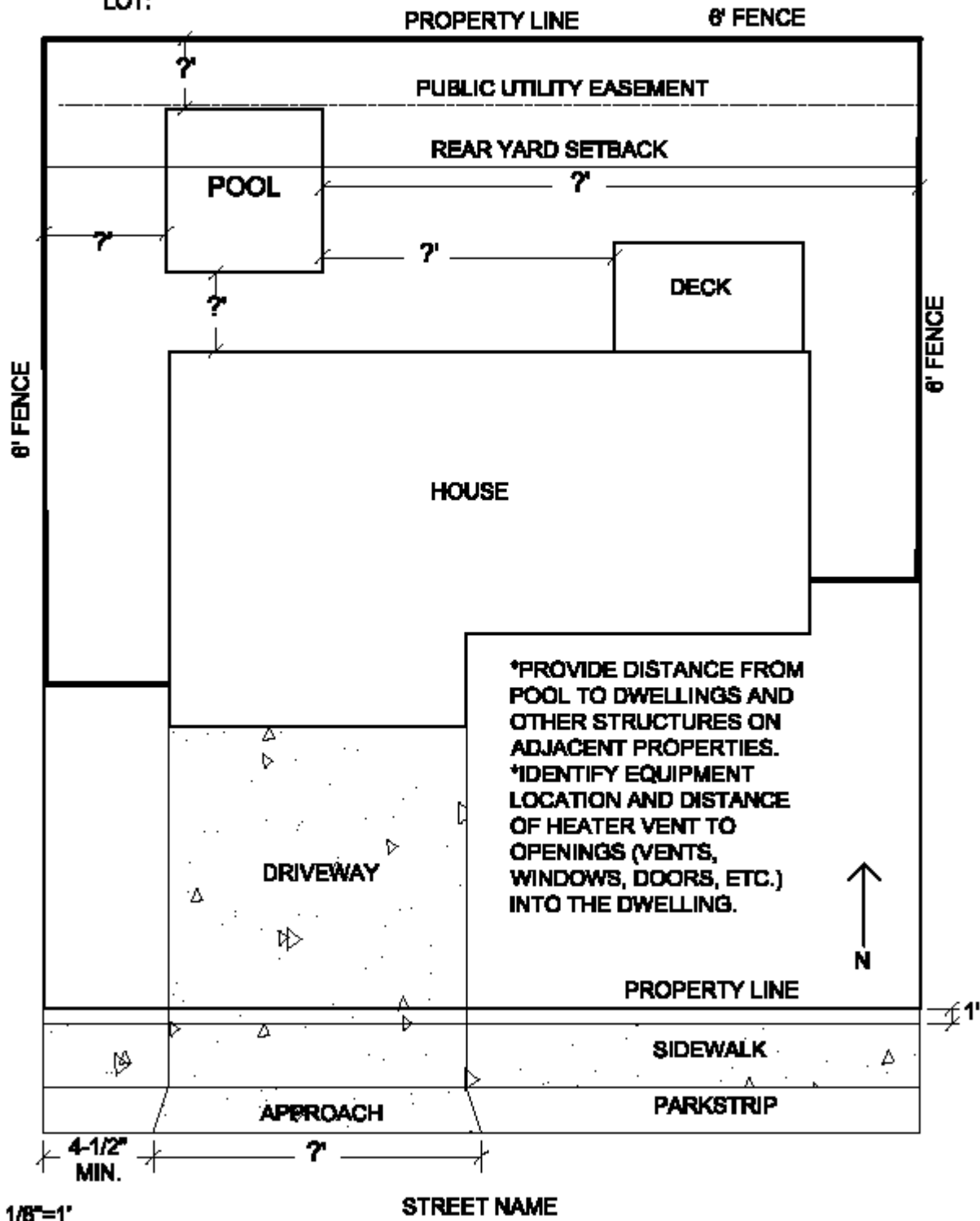

*PROVIDE DISTANCE FROM POOL TO DWELLINGS AND OTHER STRUCTURES ON ADJACENT PROPERTIES.
*IDENTIFY EQUIPMENT LOCATION AND DISTANCE OF HEATER VENT TO OPENINGS (VENTS, WINDOWS, DOORS, ETC.) INTO THE DWELLING.