

Chicago Civic Center Project ■ 1949

City of Chicago Plan Commission

Robert Brownjohn, Typography and Presentation

John van der Meulen, Architectural Staff

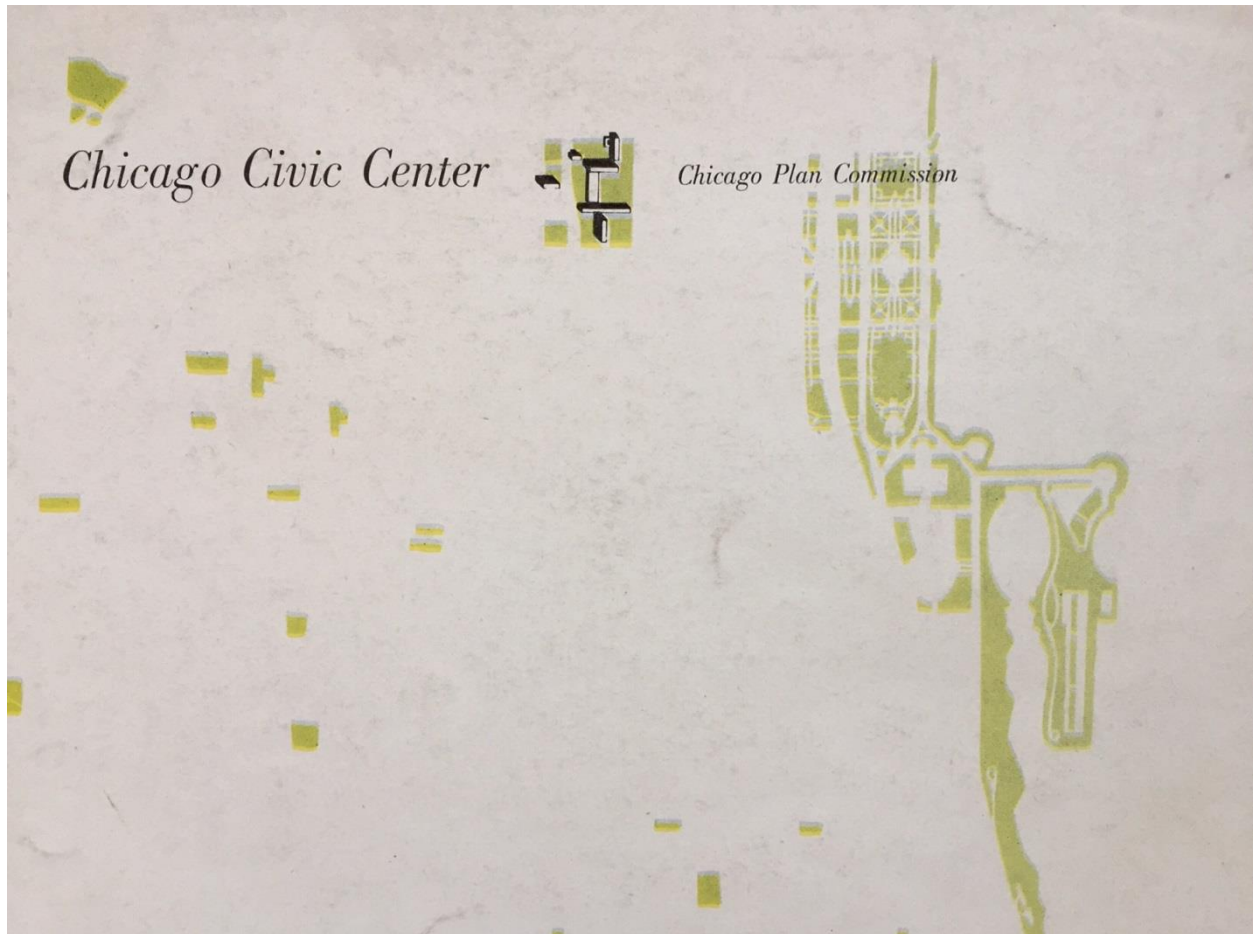

Booklet Cover

by the Plan Commission staff

Harry Weese
John Weese
John van der Meulen
Bruce Adams
Gyo Obata
Jack Meltzer *research*
Robert D. Carpenter
Daniel Ferrone
C. Richard Hubert
Leroy J. Ziegele
Robert Brownjohn *typography and presentation*
Leo Skubic *presentation*
Reuel Denney *text*
Robert Thierman *assistant*
Albert Sherwood *model*

architectural design

site location

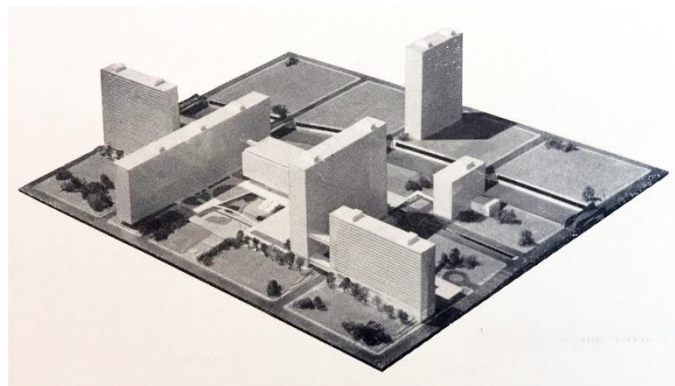

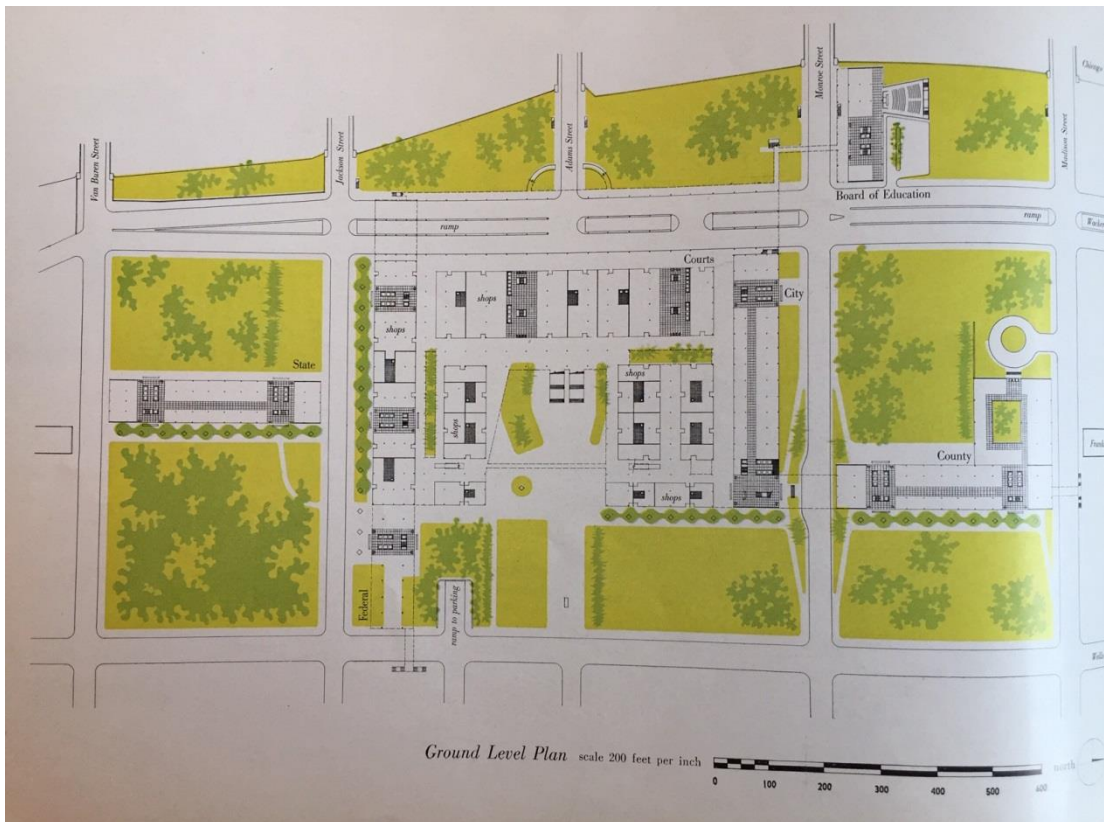
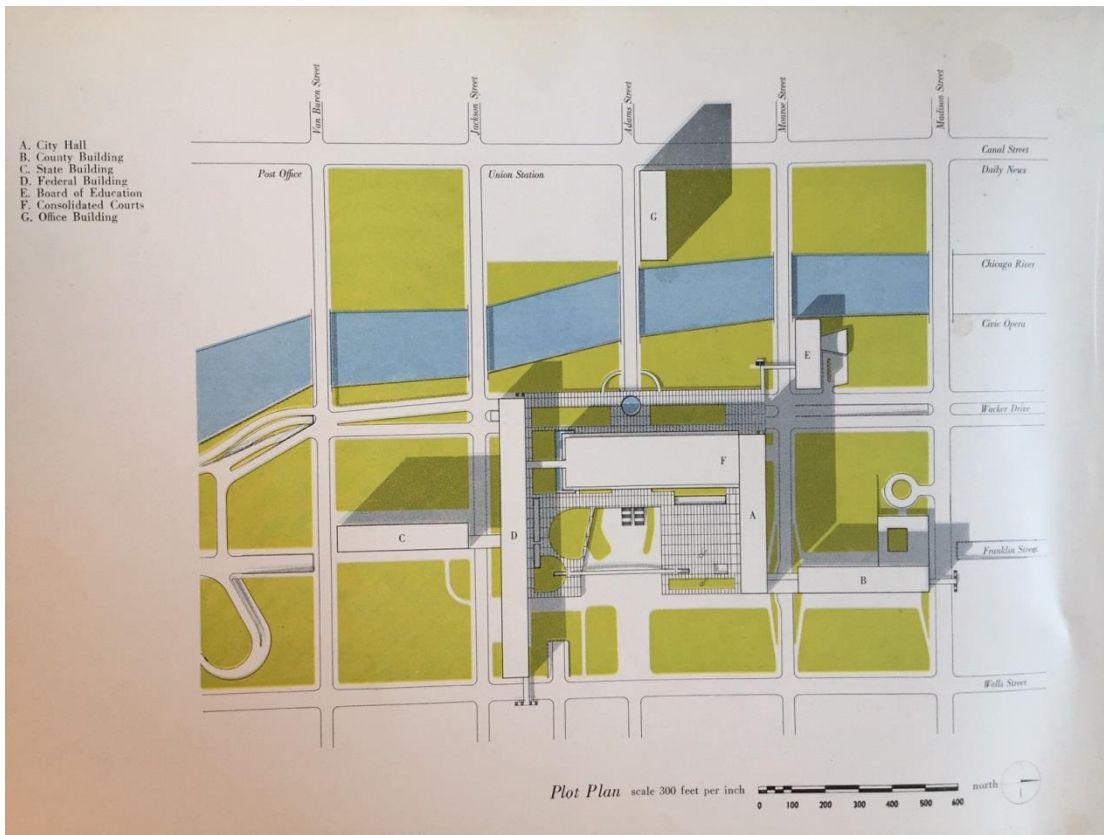

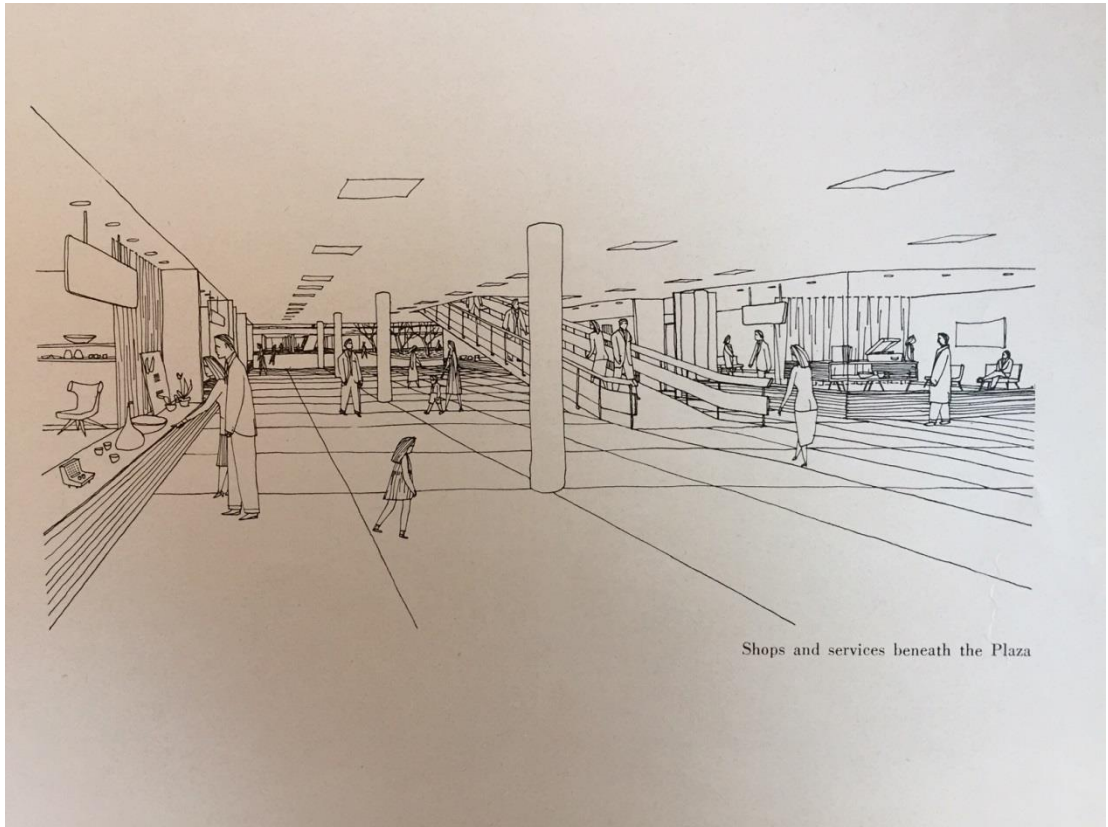
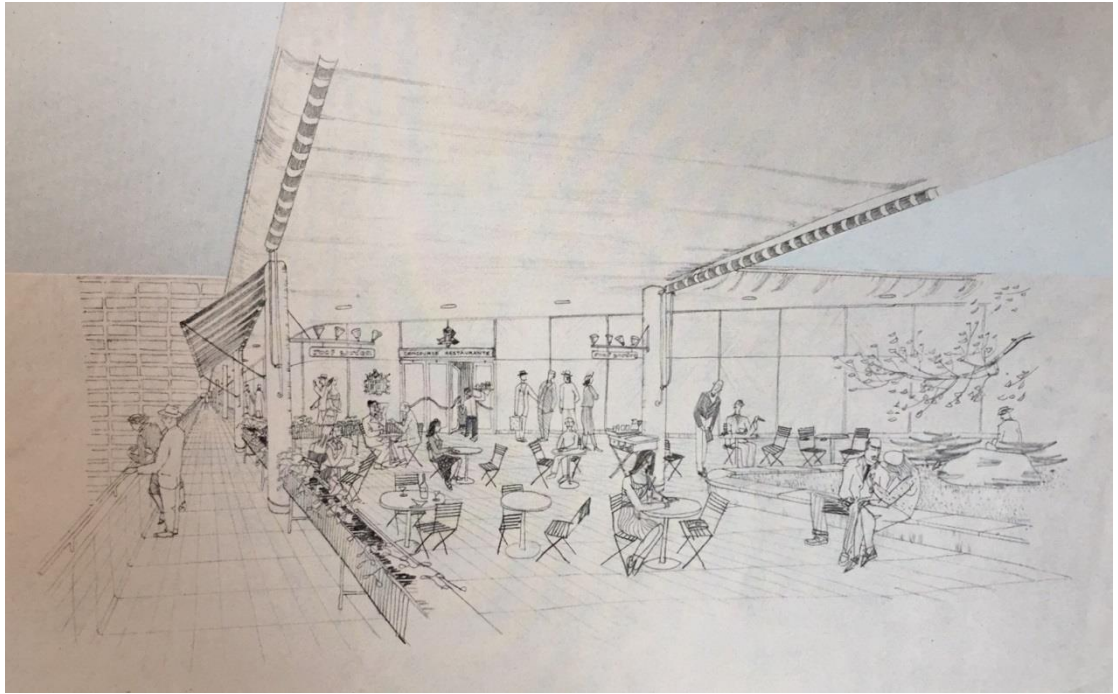

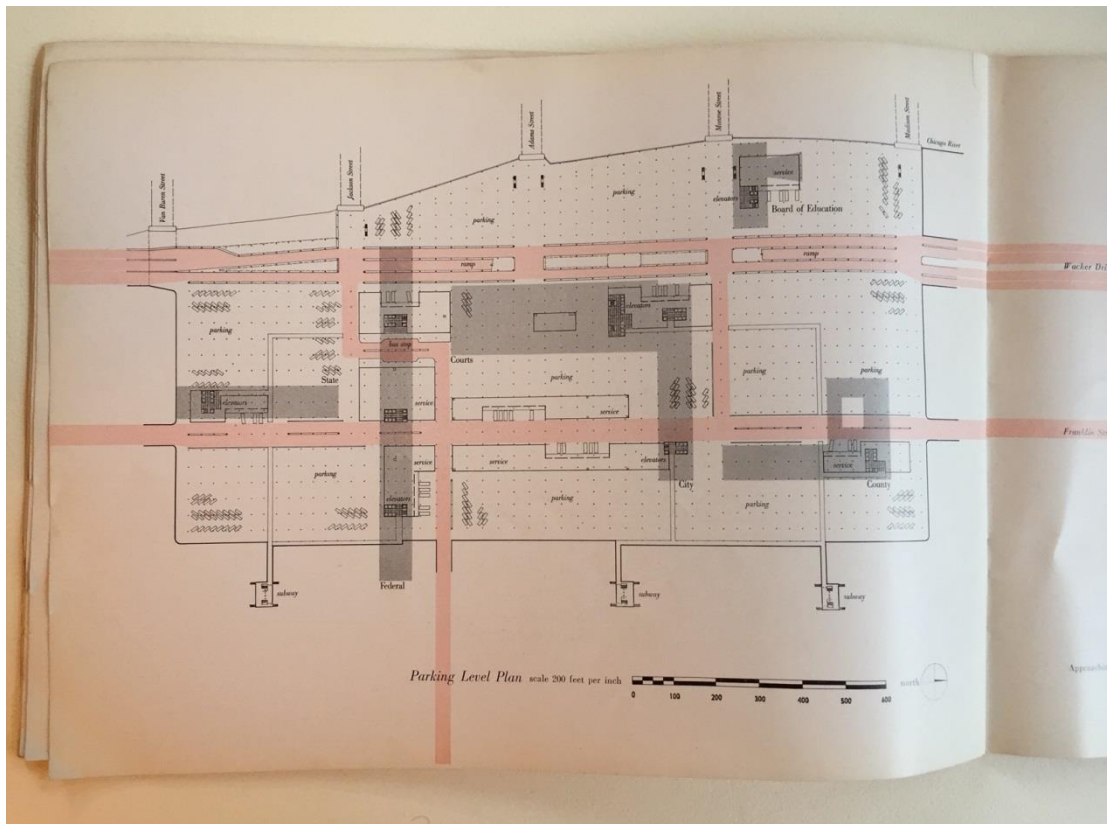
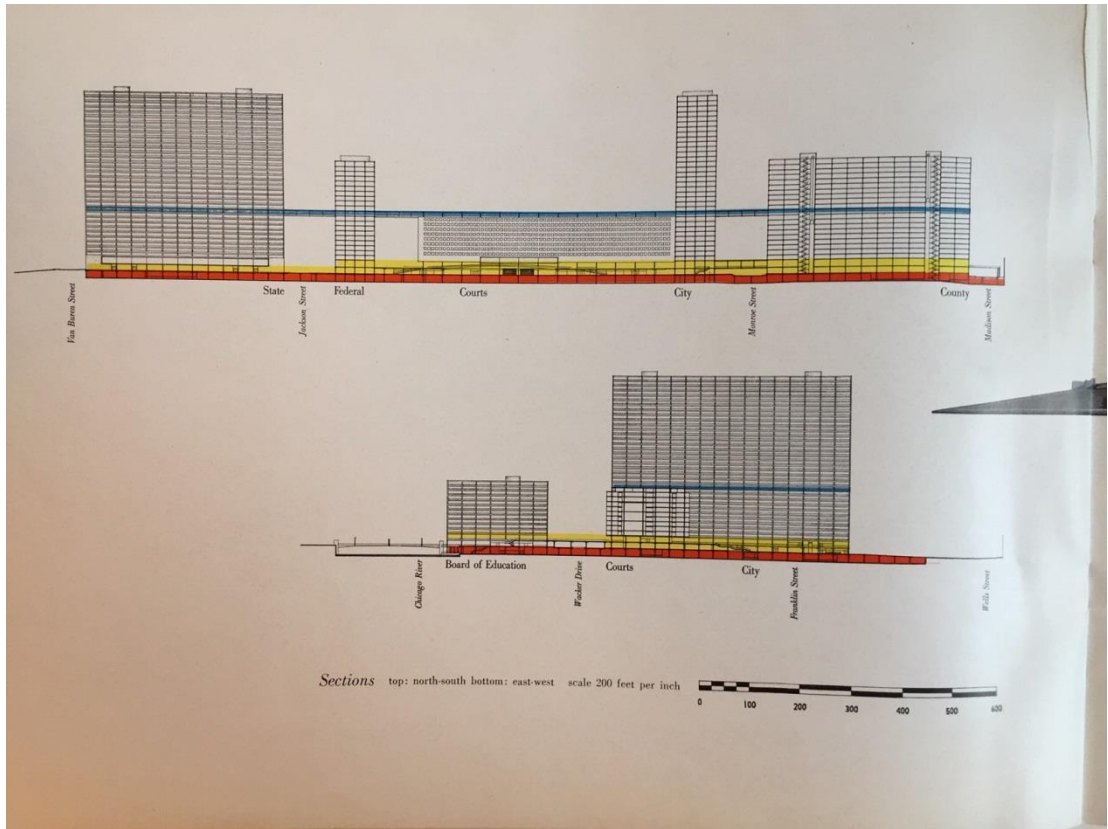

The public plaza is located one level above the street. The public is only a step from the conveniently-located information desks of the government agencies in the Center; only a step to the elevators. The Esplanade over Wacker Drive and its direct connection with the river front park may well become out of Chicago's outstanding attractions.

Wise planning for the practical needs of government in Chicago demands careful consideration of much more than provision for efficient public office space. Of major importance in the evaluation of a new Civic Center are the physical elements that enhance the environment of everyday living. The Esplanade, with its attractive view, the rehabilitation of the river front as a park, the numerous trees, the easy movement of pedestrian and auto traffic, the arrangement of buildings in a pleasing setting are all elements contributing to this objective.

Equally important is the relationship between the individual and each of the buildings. Careful examination of the Civic Center site plan reveals the human scale to which the public-office buildings have been designed. They appear tall and imposing, yet not so large as to be overwhelming and oppressive. They are conceived as workable tools, not merely as grandiose monuments to a great city. The proposed Civic Center is on a scale commensurate with Chicago's greatness. The Civic Center property emphasizes the Loop as the center of the metropolis. The river, the lake, and the steel rails of the railroads have brought Chicago the elements of its greatness. In the Civic Center these will be merged a symbol of Chicago's vitality.

The scale of the Civic Center project is vast, but so is the city it is planned to ultimately serve. Chicago deserves a project of this magnitude.



The Plaza staff photograph

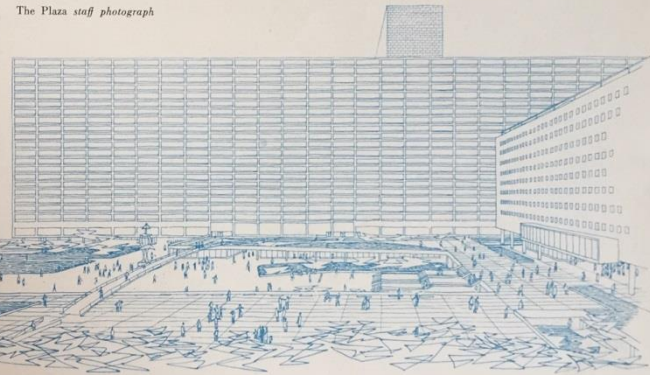

View of the Plaza from the City Building

