

# Soils Map

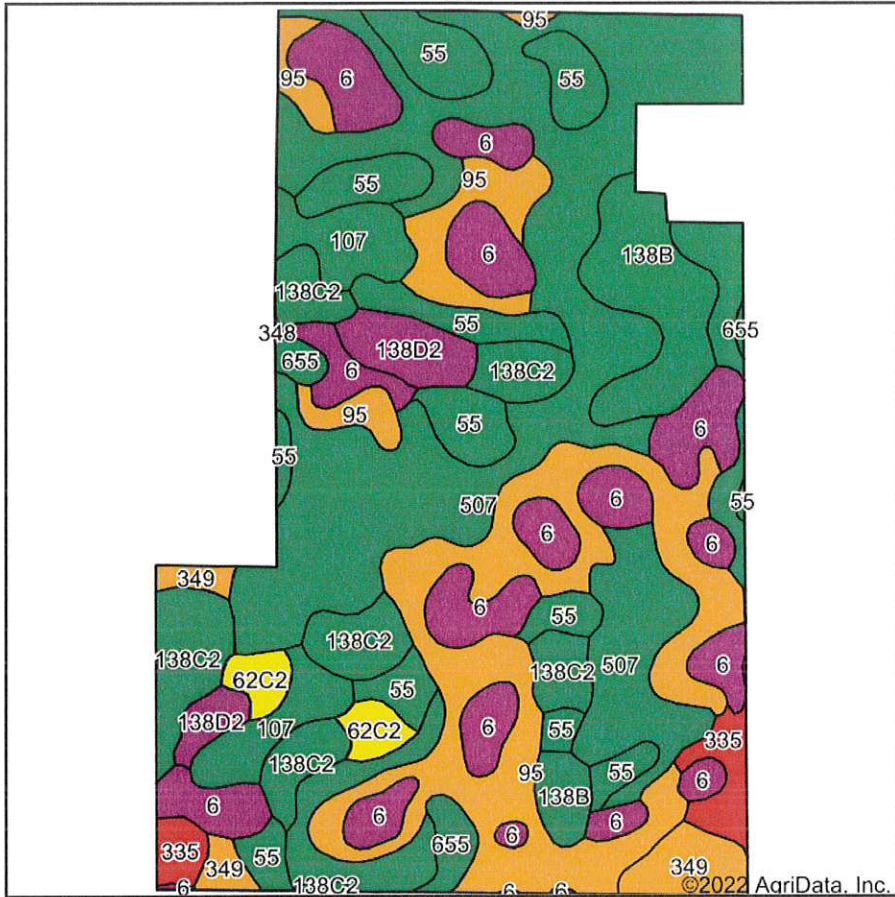

Soils data provided by USDA and NRCS.

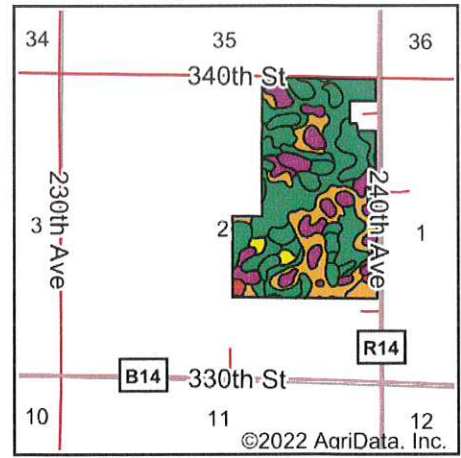

State: **Iowa**  
 County: **Kossuth**  
 Location: **2-97N-27W**  
 Township: **Buffalo**  
 Acres: **165.17**  
 Date: **7/18/2022**



Area Symbol: IA109, Soil Area Version: 28

Code	Soil Description	Acres	Percent of field	CSR2 Legend	Non-Irr Class *c	CSR2**	CSR	
507	Canisteo clay loam, 0 to 2 percent slopes	51.38	31.1%		IIw	84	75	
95	Harps clay loam, 0 to 2 percent slopes	28.95	17.5%		IIw	72	60	
6	Okoboji silty clay loam, 0 to 1 percent slopes	23.62	14.3%		IIIw	59	54	
55	Nicollet clay loam, 1 to 3 percent slopes	16.49	10.0%		Iw	89	85	
138C2	Clarion loam, 6 to 10 percent slopes, moderately eroded	13.32	8.1%		IIIe	83	62	
138B	Clarion loam, 2 to 6 percent slopes	9.04	5.5%		Ile	89	77	
107	Webster clay loam, 0 to 2 percent slopes	6.34	3.8%		IIw	86	80	
138D2	Clarion loam, 9 to 14 percent slopes, moderately eroded	4.09	2.5%		IIIe	51	52	
349	Darfur loam, 0 to 2 percent slopes	4.08	2.5%		IIw	74	71	
335	Harcot loam, 0 to 2 percent slopes	3.30	2.0%		IIw	39	52	
62C2	Storden loam, 6 to 10 percent slopes, moderately eroded	2.42	1.5%		IIIe	64	49	
655	Crippin loam, 1 to 3 percent slopes	2.14	1.3%		Ie	91	80	
<b>Weighted Average</b>						<b>2.15</b>	<b>76.9</b>	<b>68.2</b>

\*\*IA has updated the CSR values for each county to CSR2.

\*c: Using Capabilities Class Dominant Condition Aggregation Method  
 Soils data provided by USDA and NRCS.