

## CARBON DIOXIDE FEED SYSTEM

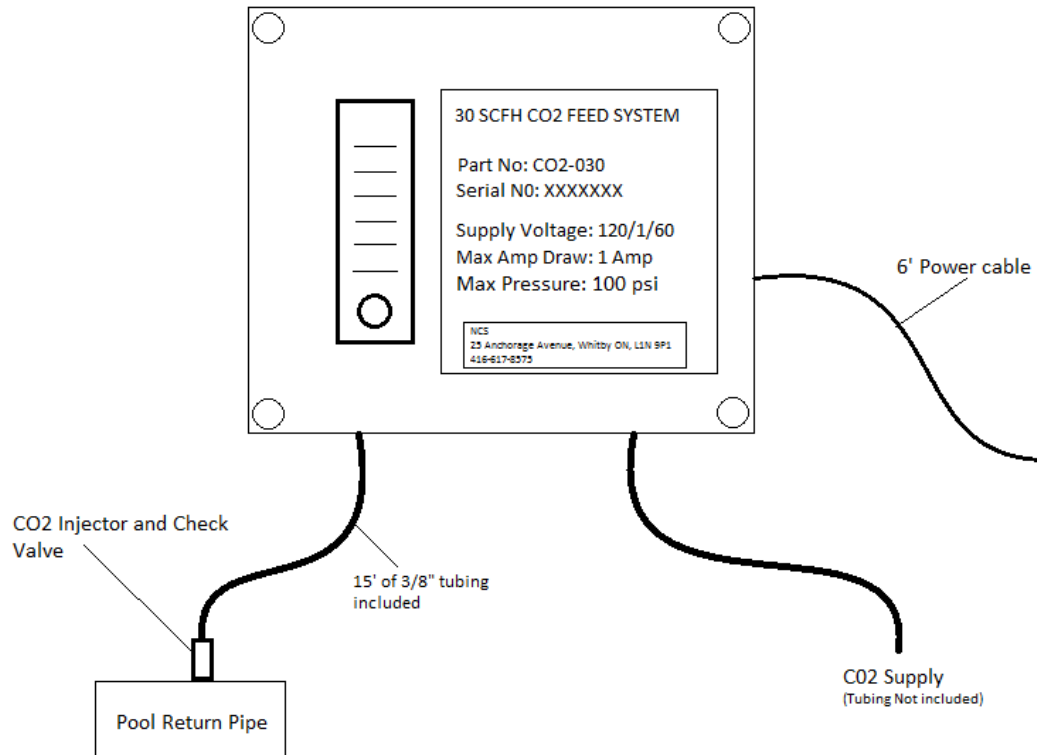

The CO2 feed control system shall be housed in an impact and corrosion resistant polycarbonate Nema 4X cabinet. The cabinet shall have four (4) 3/16" diameter mounting holes and corrosion resistant polyamide cover screws. The feed solenoid shall be normally closed and constructed of polycarbonate plastic. The valve shall have tube push connections and spade electrical connections for ease of service. The electrical power requirement are 120/1/60 VAC with a 6 ft power cord with moulded male plug. The inlet and out CO2 connection shall be 3/8" push connections with 25 ft of 3/8" tubing supplied.

The CO2 injector/diffuser fitting shall consist of a nylon check valve requiring 1 psi opening pressure; 3/8" push connection, diffuser to ensure proper absorption of CO2 into the water flow. The unit will have a 1/2" male NPT thread for installation into the pool circulation system.

Model option	30 SCFH	Part Number CO2-030
	180 SCFH	Part Number CO2-180

