

**Watters Road**

VOL. 2006, PG. 214, CCMR

N89°08'09"E 372.90'

10.0' N89°13'34"E

N00°46'26"W 350.92'

N00°46'26"W

282.99'

5' TXU ELECTRIC ESM T. VOL. 5846, PG. 2246, CCLR

INLET PROTECTION W/ P2 FILTER PHASES 2-5 PER SD-EC04

INLET PROTECTION W/ P2 FILTER PHASES 2-5 PER SD-EC04

**3.203 Acres**  
**139,507 Sq. Ft.**

IMMANUEL LUTHERAN CHURCH OF ALLEN, TEXAS  
REMAINDER OF 5.000 ACRE TRACT  
CC# 95-0097206, CCLR

**John Fyke Survey, A-325**

**Bossy Boots Drive**

$\Delta = 15^{\circ}38'25"$   
 $R = 1055.00'$   
 $Arc = 287.99'$   
 $Ch = N80^{\circ}07'09"W$

S89°05'32"W 131.20'

INLET PROTECTION W/ P2 FILTER PHASES 2-5 PER SD-EC04



SCALE IN FEET  
SCALE: 1" = 20'

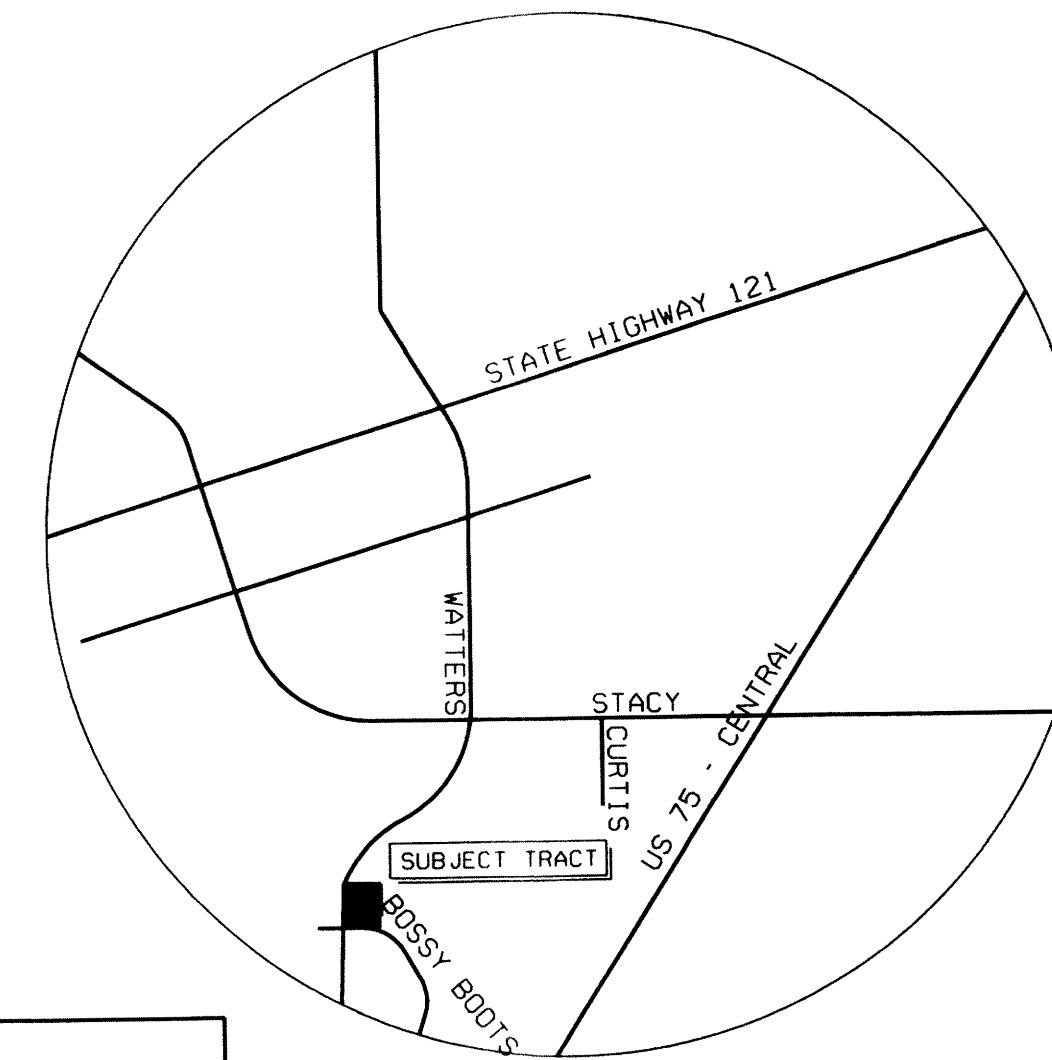

LOCATION MAP  
MAPSCO PAGE 459-M

**LEGEND:**

- SILT FENCE
- CONSTRUCTION ENTRANCE
- INLET PROTECTION
- CONCRETE WASHOUT PIT

**EROSION CONTROL CONSTRUCTION PHASING:**

- PHASE 1 - TOP SOIL REMOVAL AND ROUGH GRADING
- PHASE 2 - UTILITY INSTALLATION
- PHASE 3 - BUILDING CONSTRUCTION
- PHASE 4 - PAVING
- PHASE 5 - LANDSCAPE AND IRRIGATION

**GENERAL NOTES:**

1. EROSION CONTROL DEVICES AS SHOWN ON THE EROSION CONTROL PLAN FOR THE PROJECT SHALL BE INSTALLED PRIOR TO THE START OF LAND DISTURBING ACTIVITIES ON THE PROJECT.
2. ALL EROSION CONTROL DEVICES ARE TO BE INSTALLED IN ACCORDANCE WITH THE APPROVED PLANS AND SPECIFICATIONS FOR THE PROJECT. CHANGES ARE TO BE APPROVED BEFORE CONSTRUCTION BY THE DESIGN ENGINEER AND THE CITY OF ALLEN ENGINEERING DEPARTMENT.
3. IF THE EROSION CONTROL PLAN AS APPROVED CANNOT CONTROL EROSION AND OFF-SITE SEDIMENTATION FROM THE PROJECT THE EROSION CONTROL PLAN WILL BE REQUIRED TO BE REVISED AND/OR ADDITIONAL EROSION CONTROL DEVICES WILL BE REQUIRED ON SITE.
4. IF OFF-SITE SOIL BORROW OR SPOIL SITES ARE USED IN CONJUNCTION WITH THIS PROJECT, THIS INFORMATION SHALL BE DISCLOSED AND SHOWN ON THE EROSION CONTROL PLAN. OFF-SITE BORROW AND SPOIL AREAS ARE CONSIDERED A PART OF THE PROJECT SITE AND THEREFORE SHALL COMPLY WITH THE CITY EROSION CONTROL REQUIREMENTS. THESE AREAS SHALL BE STABILIZED WITH PERMANENT GROUND COVER PRIOR TO FINAL APPROVAL OF THE PROJECT.

**NOTE:**

SD-EC04 REFERS TO CITY OF ALLEN STANDARD CONSTRUCTION DETAILS - EROSION CONTROL AVAILABLE ON-LINE

CITY OF ALLEN  
Approved for construction.  
Approved does not waive the  
AUG 05 2014  
true intent of the standard specifications or contract documents.

REV.	BY:	REVISION

**EROSION CONTROL CONSTRUCTION PLAN**

	INSTALLATION:	REMOVAL:
CONSTRUCTION ENTRANCE	PRIOR TO STARTING	PRIOR TO PAVEMENT PLACEMENT
SILT FENCE	PRIOR TO STARTING	AFTER ESTABLISHING GRASS COVER

**BMP MAINTENANCE SCHEDULE**

BMP	MAINTENANCE FREQUENCY	BY:
SILT FENCE	WEEKLY/AFTER RAINS	CONTRACTOR
CONST ENTRANCE	WEEKLY/AFTER RAINS	CONTRACTOR
INLET PROTECTION	WEEKLY/AFTER RAINS	CONTRACTOR

OWNER:  
RADHA KRISHNA TEMPLE  
7405 STONEY POINT DRIVE  
PLANO, TEXAS 75025  
SHREYA BHAT  
(972) 527-6195

ENGINEER:  
HELMBERGER ASSOCIATES, INC.  
1525 BOZMAN ROAD  
WYLIE, TEXAS 75098  
RANDALL T. HELMBERGER, PE  
(972) 442-7459

ARCHITECT:  
SHASHI D. PATEL, AIA NCARB  
ARCHITECTS AND PLANNERS  
442 EAST END AVE., SUITE B  
PITTSBURGH, PA 15221  
SHASHI PATEL  
(412) 760-5928

GRASS COVER TO BE ESTABLISHED AND MAINTAINED ON ALL DISTURBED GROUND AREAS UPON COMPLETION OF FINAL GRADING

TOTAL DISTURBED AREA = 3.20 ACRES

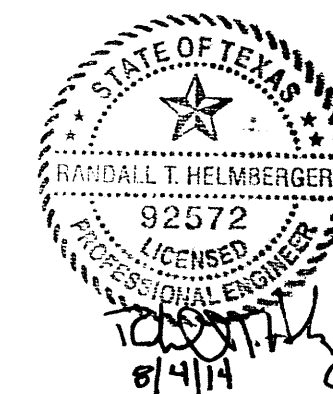

**EROSION CONTROL PLAN**

RADHA KRISHNA TEMPLE

NE CORNER WATTERS ROAD AND BOSSY BOOTS ROAD  
ALLEN, TEXAS

TYPE REGISTRATION NO. F-000756  
**H** HELMBERGER ASSOCIATES, INC.  
CIVIL AND ENVIRONMENTAL ENGINEERS  
1525 BOZMAN ROAD, WYLIE, TEXAS 75098 (972) 442-7459

DESIGN	DRAWN	DATE	SCALE	NOTES	NO.
HELM.	CADD	NOVEMBER 2013	1"=30'	ERBORDER	1337 C5