

HEIGHTS TOWER SYSTEMS

Flat Hinge Base (use flat bases as templates)

VIEW of Anchor Bolts
AFTER Installation
is complete.

Lockwasher or flatwasher to be used in this position.
Nut may or may not be positioned underneath.

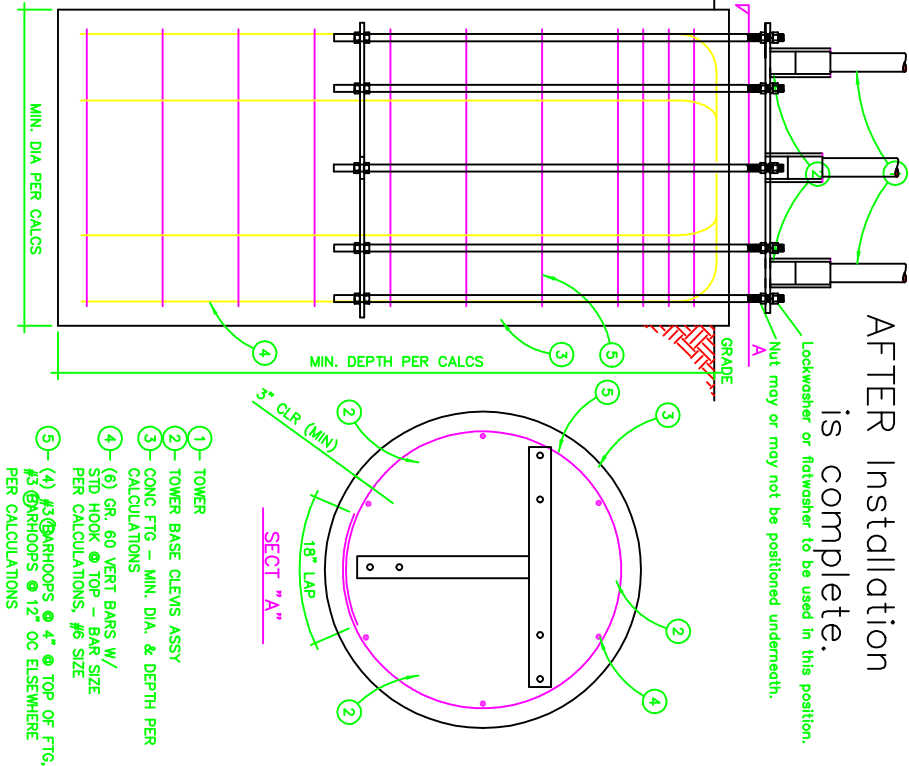

Side View of Anchor bolts
with top template in place
during installation.

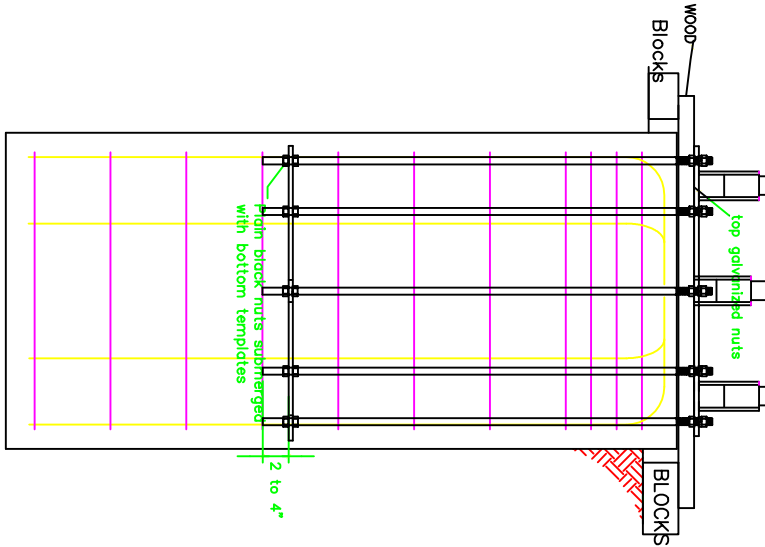

Top View with top template
bars during installation;

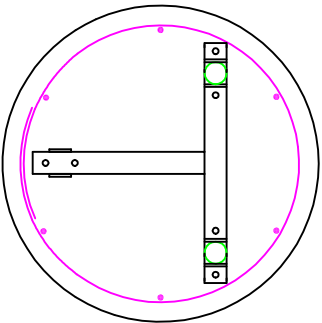

setting of all—thread anchor rods before pouring of concrete. Threaded rod to extend 5 to 8" above concrete