



Converting a One Way Traverse  
to a Two Way  
*Basic Drapery Hardware*



kirsch

# Converting a 1 Way Traverse to a 2 Way



1. Start with a Single Traverse One Way Draw (66" - 120" Part # 336025)

Available in a variety of sizes



# Converting a 1 Way Traverse to a 2 Way



2. Lay rod face down & pull sections apart  
Free cord from Right master; slide it off; discard



# Converting a 1 Way Traverse to a 2 Way

kirsch®

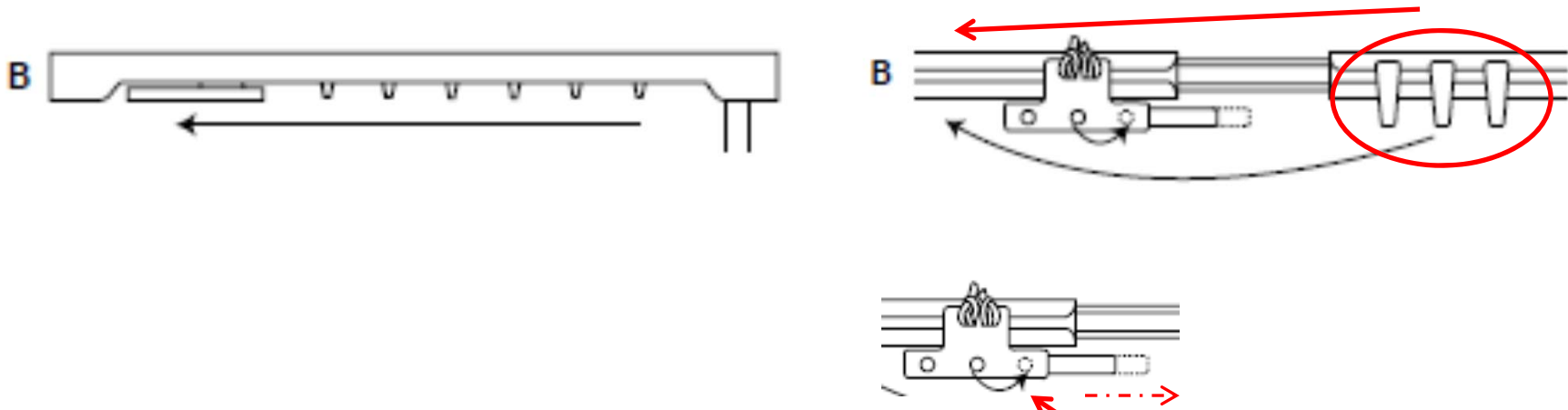

## 3. Cord & Stack Right

- Move master arm in remaining master to right screw hole; slide off
  - Move all slides to outside (large) rod section.
  - Replace master; rejoin rod.



# Converting a 1 Way Traverse to a 2 Way

kirsch®

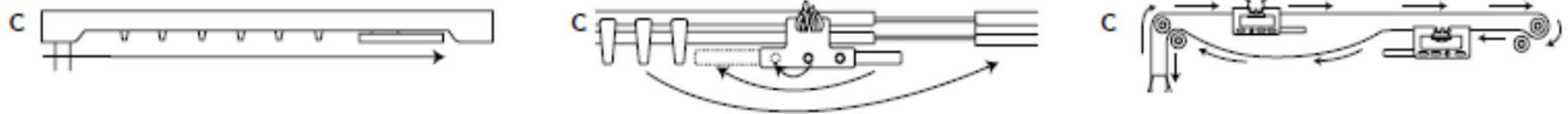

## 3. Cord & Stack Left

- Untie cord Left, remove guide.....restring cord & re-knot
- Untie cord on Right & pull down between wheels on right
  - Add guide restring & reknot
- Change screw in master, reverse arm; slide off
- Move all slides to inside (small) rod section
  - Replace master; rejoin rod

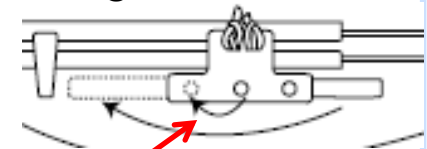

# Converting a 1 Way Traverse to a 2 Way



Download the PDF "1 - Pager" of this training

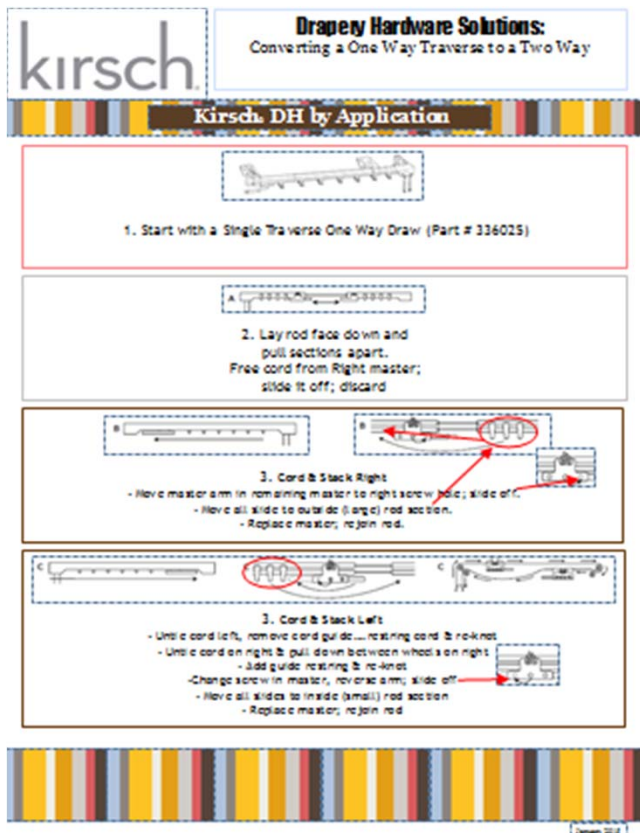

- A summary of this training is available in a 1-page PDF
- To Download the PDF, visit your Kirsch Distributor's website
- Also see other great *Kirsch Drapery Hardware Solutions* training shorts



Drapery Hardware Solutions

kirsch.



Thank You!

kirsch