



Digital electronic wheel balancer with led display for motorcycle wheels

Digital electronic wheel balancer with led display for motorcycle wheels.

Main Features

Giuliano Industrial S.p.A.

The information contained in this document is the sole property of Giuliano Industrial S.p.A. The document is NOT authentic if it has been downloaded from a website different from www.giuliano-automotive.com.



Description

Digital electronic wheel balancer with led display for motorcycle wheels.

Functions

- Manual measuring of wheel diameter and distance;
- Automatic START and STOP;
- Static and dynamic balancing;
- Huge combination of **ALU programs**;
- Special **ALU-S** program;
- **FES** function;
- **OPTIMATCH** function;
- Self-diagnosis;
- Self-calibration;
- Complete with **ProBike Eco Kit** clamping adaptor for motorcycle wheels;
- Wheel guard available as optional.

Standard Features

Max. wheel weight	75 kg
Max. tyre diameter	900 mm
Rim diameter	10"-30" / 255-765 mm
Rim width	1.5"-20" / 40-510 mm
Power supply	230V - 1ph - 50/60 Hz
Cycle time	6.0s (5 3/4" x 14") 15 Kg
Rotating speed	< 100 rpm
Balancing precision	± 1g
Net weight	85 kg
Dimensions (WxDxH)	970x480x987 mm

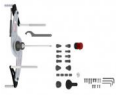

PROBIKE EKO KIT (9341191)
Clamping adaptor for motorcycle wheels.
Complete with 14 mm diam. shaft. and Quick
Fix quick clamping device

Standard accessories

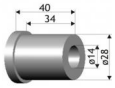

9342850
Set of 28 mm centering rings for ProBike Eco
Kit with 14 mm diam. shaft



9342851
19 mm diam. shaft with complete set of
centering rings, adaptors and Quick Fix quick
clamping device, for ProBike Eco



PROFI KIT (9342852)
Set of special adaptors for 19 mm diam. shaft
on ProBike Eco

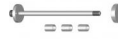

9342853
10 mm diam. shaft with adaptors, for ProBike
Eco



Scan QR code to go to product web page



Giuliano Industrial S.p.A.

via Guerrieri 6

Correggio (RE)

Italy

+39 0522 731111

+39 0522 633198

<http://www.giuliano-automotive.com>



Social Network



Facebook



YouTube



Google+



Twitter



Giuliano Industrial S.p.A.