

Scenic Tsar

Reconstructed and Renovated 2012 | Passengers 112 | Cabins 56 | Crew 71 | Gross tonnage 3,019

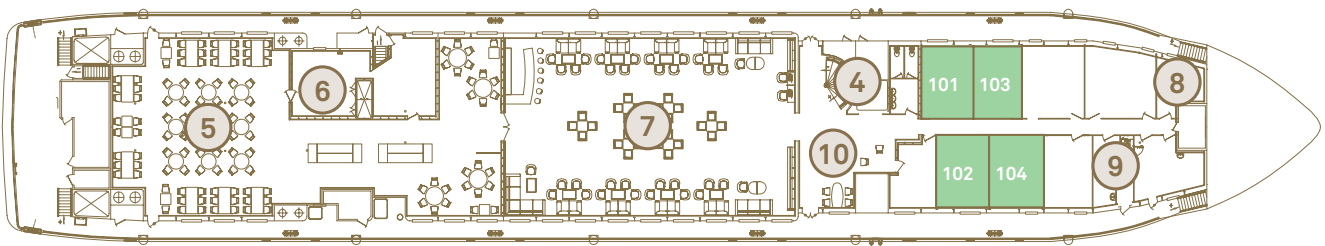
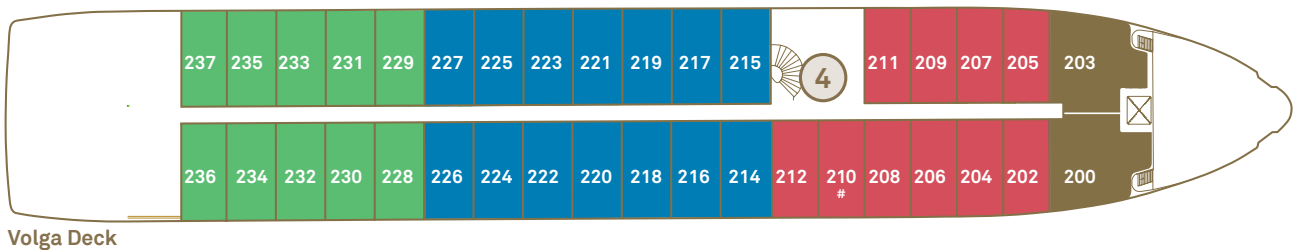
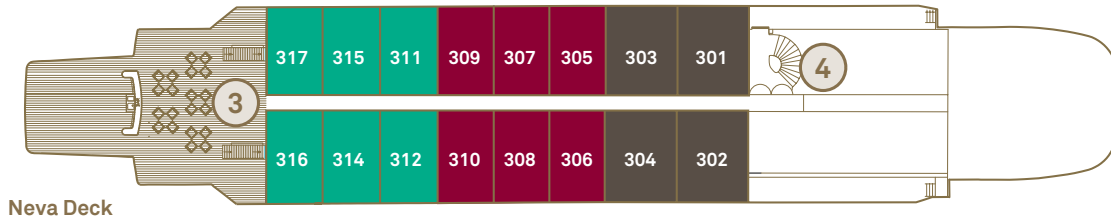
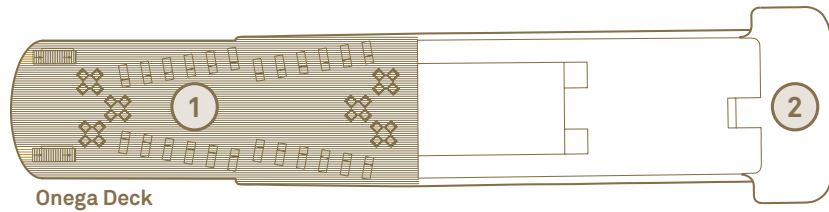

Deck Plan

- ① Sun Deck
- ② Wheelhouse
- ③ Neva Lounge & Bar
- ④ Elevator
- ⑤ Crystal Dining
- ⑥ Galley
- ⑦ Panorama Lounge & Bar
- ⑧ Beauty Salon
- ⑨ Wellness Area
- ⑩ Reception

Suite Categories

Neva Deck

- PA** Deluxe Balcony Suite
- P** Deluxe Balcony Suite
- R** Royal Suite

Volga Deck

- BA** Balcony Suite
- BB** Balcony Suite
- B** Balcony Suite
- RS** Royal Panorama Suite

Moskva Deck

- E** Standard Suite

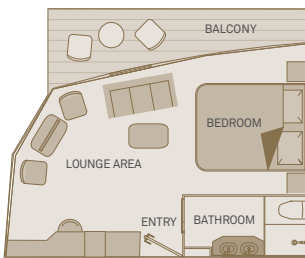

Royal Panorama Suite

334ft²

RS

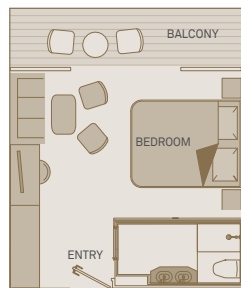

Royal Suite

300ft²

R



Deluxe Balcony Suite

236ft²

PA P



Balcony Suite

215ft²

BA BB B

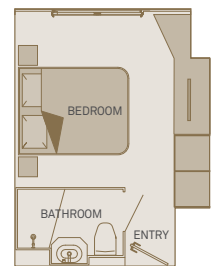

Standard Suite

161ft²

E

Scenic Tsar is not a Scenic Space-Ship, inclusions and amenities differ. The deckplan and cabin layout images are an indication only and may vary. Bed configurations will be different in some categories. #Cabin 210 has an obstructed view from the balcony due to steel pillar of the ship.