

DekPro™ Prestige Aluminum Rail System Tri-Rail Installation Instructions

Tri-Rail Installation Instructions

Materials Needed:

- 2 - Bottom Rail Brackets
- 1 - Mid-Rail (96-1/4")

Step 1:

Ensure that Steps 1 - 4 have been done from the level railing instructions on pages 3 - 5 of this booklet to get you to this point of the installation.



Step 2:

Once cut to size, the bottom rail can be used as a template to cut the mid rail. Transfer bottom rail length to mid rail ensuring that baluster cutouts are in alignment. Mark Mid-Rail for reference, then cut. Repeat at opposite end of rail. (See diagram below) Paint cut ends to prevent oxidation.

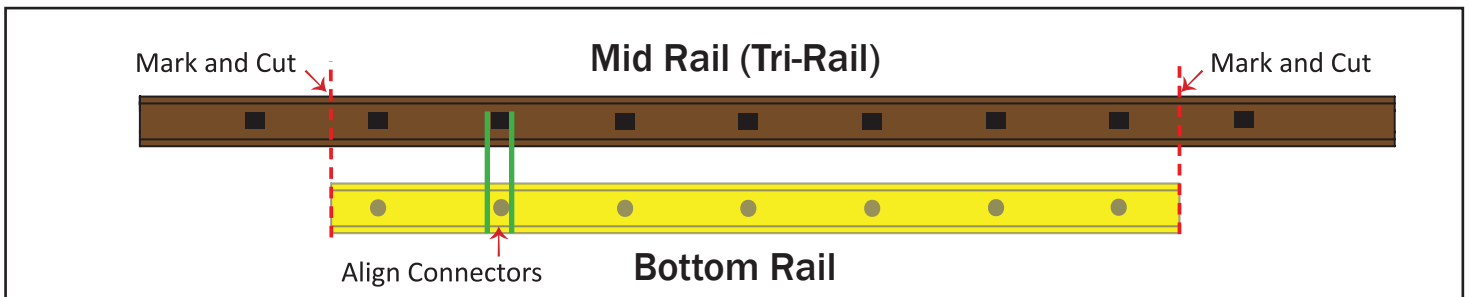

Step 3:

Place balusters into bottom rail and set bottom rail into bottom rail brackets. Then slide Mid-Rail down the balusters. (Mid-Rail stays loose at this point)

Step 4:

Set the top rail onto balusters. Then, determine distance of Mid-Rail to Top Rail.

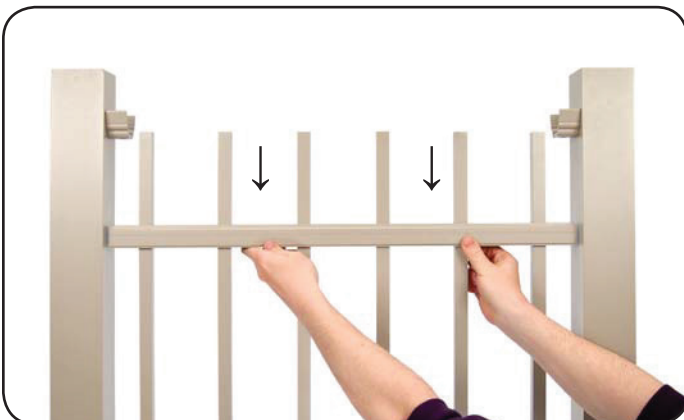

DekPro™ Prestige Aluminum Rail System Tri-Rail Installation Instructions

Tri-Rail Installation Instructions

Step 5:

Locate brackets. With the Mid-Rail temporarily held in place, slide the bracket on the Mid-Rail to determine the location of the bracket. Mark location on both posts.



Step 7:

With all brackets installed, place the assembled railing into the brackets.



Step 6:

Remove rail section and then center the bracket on the post with the bottom edge of the bracket at the line you marked previously. Use T30 Torx self-drilling screws to fasten bracket. (Pre-drill holes if desired)



Step 8a:

Secure rails into brackets with screws. Install top bracket screw first to pull rail down tightly. Then screw mid bracket and bottom bracket to secure rails in place.



Step 8b:

Use a mallet/hammer and wood block to seat bracket cover onto bracket. **IMPORTANT: Bracket cover must be tapped straight down or tabs may be damaged.**

