

CAPABILITY STATEMENT

COMPANY

PCS Engineering was established in 1999, we are professionally licensed engineers. Our six person firm has provided building system engineering services for clients in PA, NJ, DE, NY and MD. Our corporate office is located in Oreland, PA. PCS Engineering qualifies as a small business.

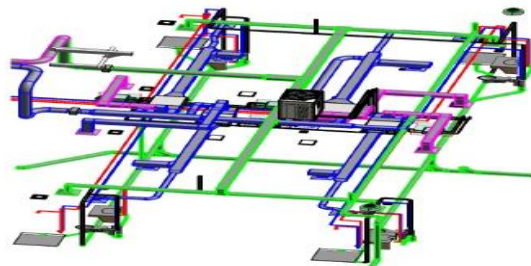

COMPANY PRINCIPALS

Stephen T. Peel, P.E.: *President* with nearly 40 years of experience in Mechanical Engineering. Steve holds a Bachelor of Science degree in Mechanical Engineering. Registered Professional Engineer in PA, NJ, DE, NY and Maryland.

Louis Irvine, P.E.: *Principal Electrical Engineer* with more than 35 years of experience and holds a Bachelor of Science degree from Drexel University. Professional Engineer Registered in PA and NJ.

Theresa Peel: *Business Development Manager* with over 25 years' experience in Sales & Marketing and holds a Bachelor of Science degree in Accounting.

Robert Butakis: *Project Contract Administrator/ Owner's Representative* with over 45 years within the Building and Mechanical trades industry.

SERVICES

PCS Engineering provides engineering services for Heating, Ventilation, Air Conditioning and Refrigeration (HVAC&R), Plumbing/Process Piping, Lighting, Electrical and Fire Protection. Construction Administration and Permit Plans. ASHRAE Energy Audits and Facilities Asset Management.

CLIENTS

Mott MacDonald
Array Architects
Meyer Architects
Jones, Lang, LaSalle Americas, Inc.
Bristol Township
Holy Family University
Rutgers University
Air National Guard – Horsham, PA

COMPANY DESIGNATIONS

CAGE CODE: 7EGP4
DUNS NUMBER: 00-359-0523
EIN: 23-3018402

COMPANY STRUCTURE

Small Business

NAICS CODES

541330 Engineering Service
236220 Commercial and Institutional
Building Construction

SIC CODES

8711 8741

WEBSITE: www.pcsengineering.net

CONTACT INFORMATION

Preferred Construction Services, Inc.
PCS Engineering
31 Park Ave
Oreland, PA 19075

Phone: 215-572-6600

Fax: 215-572-6800

E-Mail: info@pcsengineering.net

CAPABILITIES

Building System Design:

**Heating, Ventilation, Air Conditioning
and Refrigeration (HVAC & R)
Plumbing/Process Piping
Lighting, Electrical, Fire Protection**

ASHRAE Energy Audits and Reports

Facilities Asset Management

Construction Administration and Permit Plans