

INDEX OF SHEETS	
SHEET NO.	DESCRIPTION
1	Title Sheet
1A	Index Of Sheets Cont'd. & Std. Drg. Nos.

STATE OF OREGON
DEPARTMENT OF TRANSPORTATION
PLANS FOR PROPOSED PROJECT
**PAVING, GRADING, DRAINAGE,
& STRUCTURES**

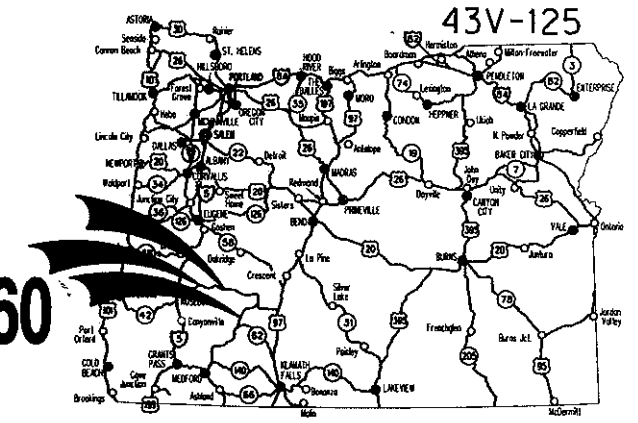

No.	DATE	REVISIONS	BY
1	3-24-10	Change date, From: March To: April	MSI

OR230/OR138:NORTH UMPQUA-UPPER ROGUE-BUNDLE 560

WEST DIAMOND LAKE HIGHWAY

DOUGLAS AND JACKSON COUNTIES

▲ APRIL 2010

Overall Length Of Project - 0.58 Miles

ATTENTION:
Oregon Law Requires You To Follow Rules Adopted By The Oregon Utility Notification Center. Those Rules Are Set Forth In OAR 952-001-0010 Through OAR 952-001-0090. You May Obtain Copies Of The Rules By Calling The Center. (Note: The Telephone Number For The Oregon Utility Center Is (503) 232-1987.)

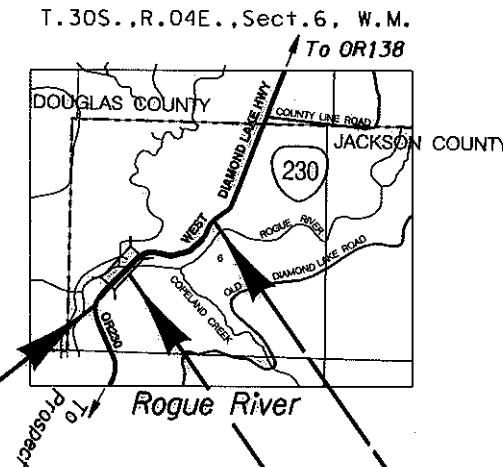
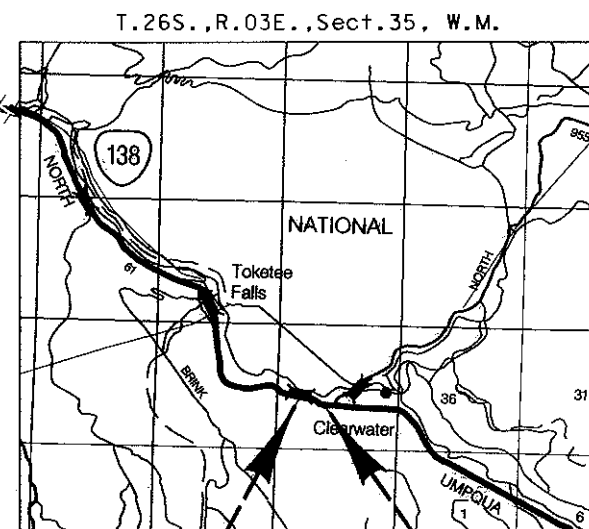
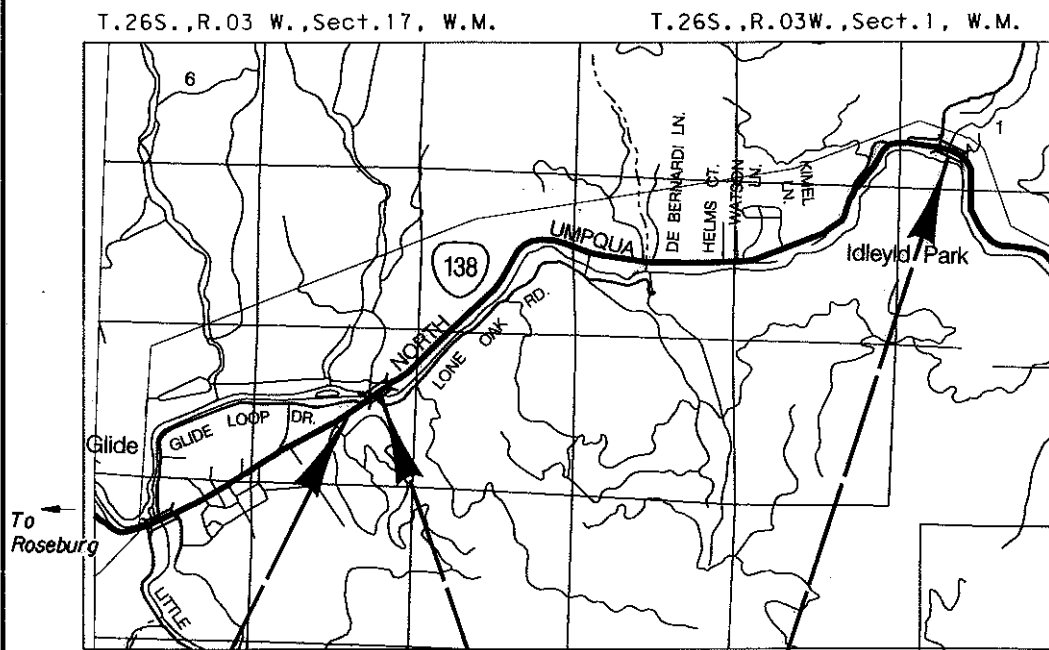

BEGINNING OF PROJECT
X-NH-OTIA-S000(541)
STA. "LR" 941+20.00 (M.P. 17.80)

LONE ROCK (Work Area #4)
STA. "LR" 941+20.00 TO
STA. "LR" 946+34.59 (M.P. 17.86)

ROCK CREEK (Work Area #3)
STA. "RC" 863+36.00 TO
STA. "RC" 868+06.00 (M.P. 22.30)

PENSTOCK (Work Area #2)
STA. "P" 864+34.00 TO
STA. "P" 865+59.93 (M.P. 57.36)

END OF PROJECT
X-NH-OTIA-S000(541)
STA. "P" 865+59.93 (M.P. 57.43)

BEGINNING OF PROJECT
X-NH-OTIA-S000(541)
STA. "WD" 264+00.00 (MP 4.96)

ROGUE RIVER (Work Area #1)
STA. "WD" 264+00.00 TO
STA. "WD" 297+50.00 (M.P. 5.16)

END OF PROJECT
X-NH-OTIA-S000(541)
STA. "WD" 297+50.00 (MP 5.61)

OREGON TRANSPORTATION COMMISSION

- Gail Achterman CHAIR
- Michael Nelson VICE-CHAIR
- Janice Wilson COMMISSIONER
- Alan Brown COMMISSIONER
- David Lohman COMMISSIONER
- Matthew L. Garrett DIRECTOR OF TRANSPORTATION

These plans were developed using ODOT design standards. Exceptions to these standards, if any, have been submitted and approved by the ODOT Chief Engineer or their delegated authority.

Approving Authority: Signature & date **3-24-10**

MARK THOMPSON, TECH CENTER MGR
Print name and title

Best H Hartman For Cathy Nelson
Concurrence by ODOT Chief Engineer

**OR230/OR138: NORTH UMPQUA-
UPPER ROGUE-BUNDLE 560
WEST DIAMOND LAKE HIGHWAY
JACKSON COUNTY**

FEDERAL HIGHWAY ADMINISTRATION	PROJECT NUMBER	SHEET NO.
OREGON DIVISION	X-NH-OTIA-S000(541)	1

Dimensions are based on existing plans. Field verify all dimension and elevations prior to fabrication and ordering reinforcing.

SCALE WARNING

If scale bar doesn't measure one inch then drawing is not to scale

Repair Items:

1. Remove and replace existing bridge cantilever and rail (for details, see dwg. 83582, 83583)
2. Longitudinal deck strengthening (for details, see dwg. 83584)
3. Crossbeam strengthening (for details, see dwg. 83585, 83586)
4. Construct silica fume concrete overlay with class 1 & 2 deck preparation for details, see 83582) (apply class 3 deck preparation as needed)
5. Construct expansion joint repair using asphaltic plug joints (for details, see BR157)*
6. Construct end bent joint repair using asphaltic plug joints (for details, see BR157)*
7. Seismic Retrofit (for details, see dwg. 83587-83589)
8. Concrete repair (for details, see dwg. 83582)
9. Deck drains (for details, see dwg. 83583)
10. Concrete Injection (for details, see dwg. 83584)
11. Abutment shear wall (for details, see dwg. 83588)

* 1/2 min thickness

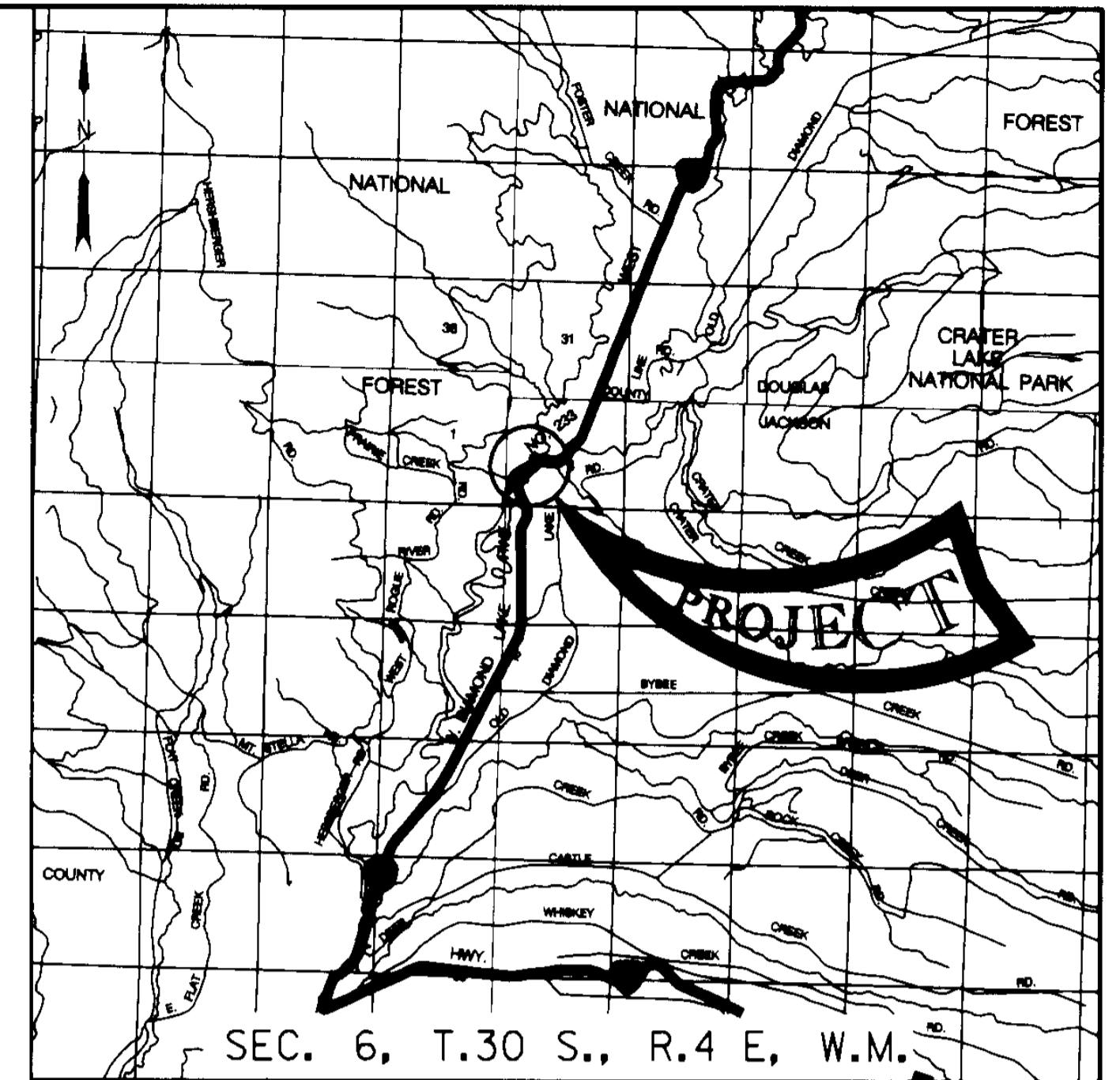

LOCATION MAP

No Scale

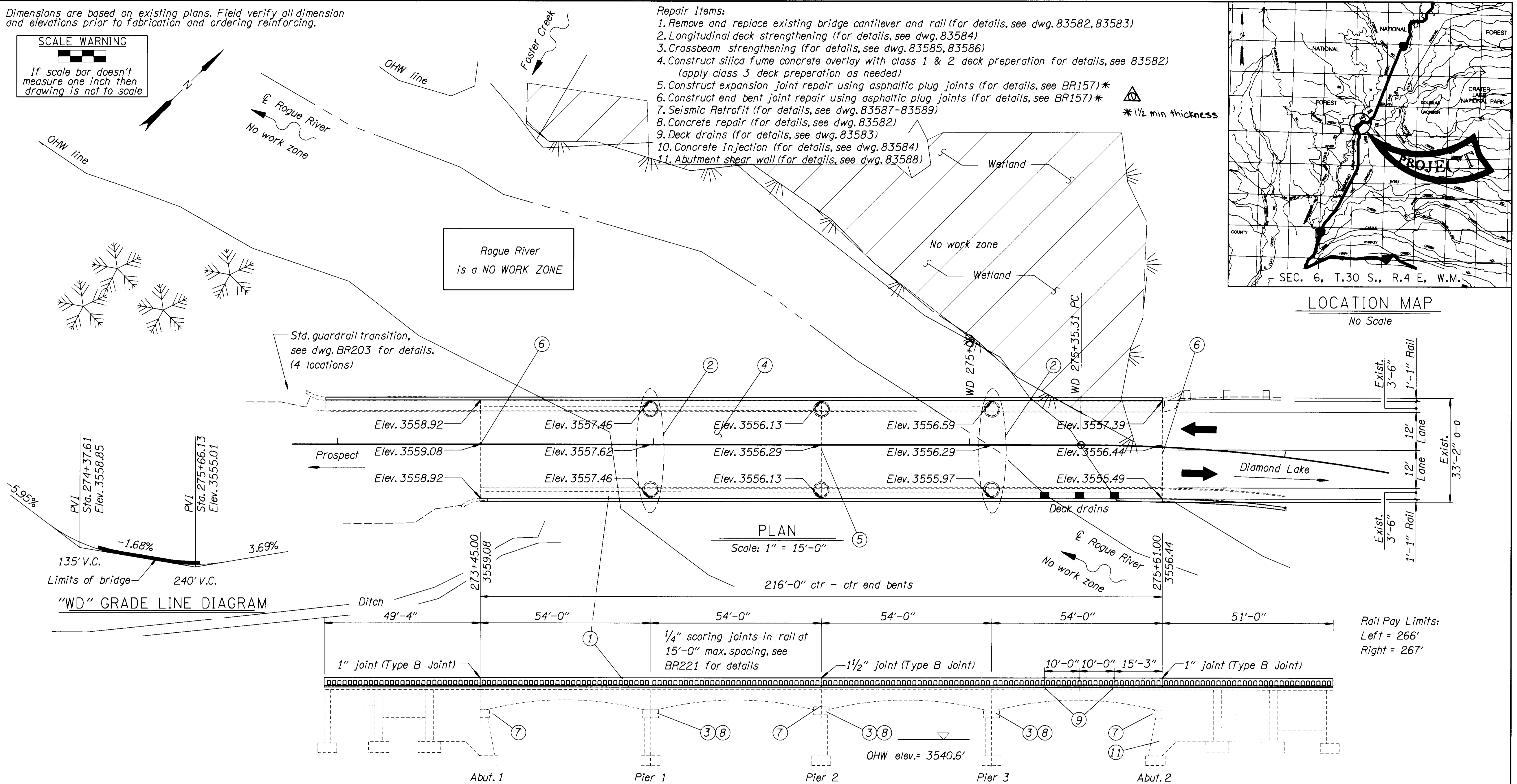

Note:
Elevations shown are based on North American Vertical Datum, 1988.

Elevations shown are finish grade at top of SFC overlay at gutter line and centerline of bent for the new structure.

DATE	REVISION	BY
3/11/2010	Added Note	

ACCOMPANIED BY DWGS. BR157, BR203, BR221,
Existing as-built plans

DRAFTER: K. Corlew
 DESIGNER: K. Corlew
 CHECKER: A. Dela Cruz
 REVIEWER: R. Grubbs



REGION 3 - TECHNICAL CENTER

STRUCTURE NO. 03461
 DATE Jan. - 2010
 CALC. BOOK 5743

ROGUE RIVER, HWY 233
 OR230/OR138: NORTH UMPQUA - UPPER ROGUE - BUNDLE 560
 WEST DIAMOND LAKE HIGHWAY (OR230), MP 5.16
 JACKSON COUNTY

SHEET 1 OF 11
 DRAWING NO. 83580

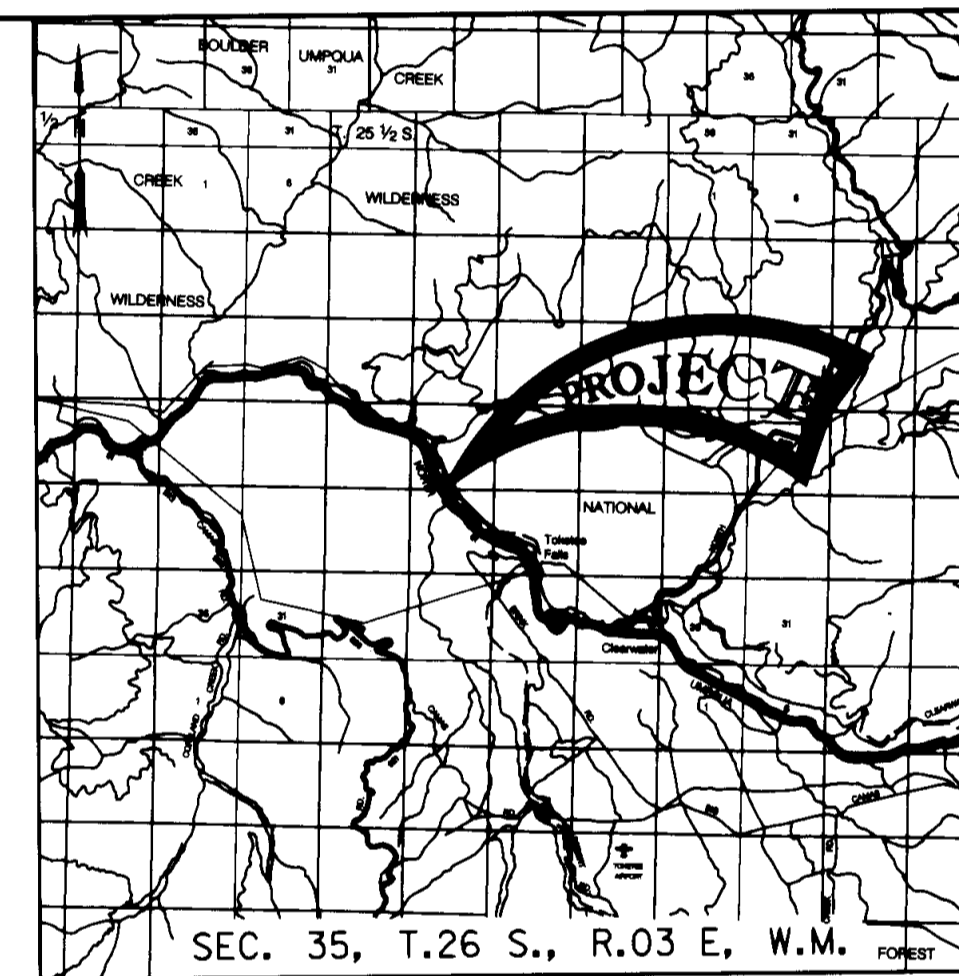
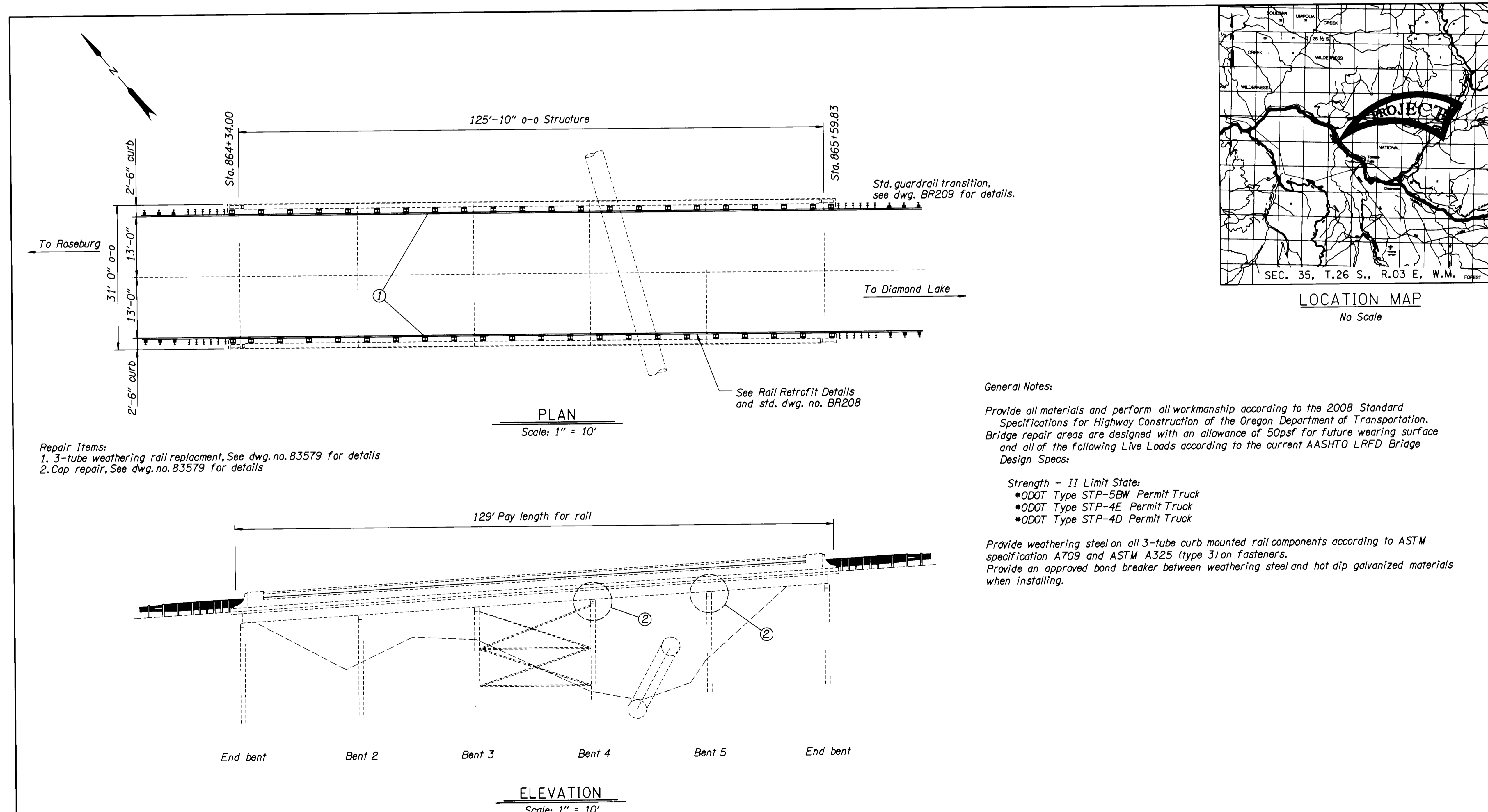

Repair Items:
1. 3-tube weathering rail replacement. See dwg. no. 83579 for details
2. Cap repair. See dwg. no. 83579 for details

General Notes:
Provide all materials and perform all workmanship according to the 2008 Standard Specifications for Highway Construction of the Oregon Department of Transportation. Bridge repair areas are designed with an allowance of 50psf for future wearing surface and all of the following Live Loads according to the current AASHTO LRFD Bridge Design Specs:
Strength - II Limit State:
• QDOT Type STP-5BW Permit Truck
• QDOT Type STP-4E Permit Truck
• QDOT Type STP-4D Permit Truck
Provide weathering steel on all 3-tube curb mounted rail components according to ASTM specification A709 and ASTM A325 (type 3) on fasteners.
Provide an approved bond breaker between weathering steel and hot dip galvanized materials when installing.

DATE	REVISION	BY	DESIGNER	CHECKER	REVIEWER	STRUCTURE NO.	DATE	CALC. BOOK	PLAN AND ELEVATION	SHEET 1 OF 23
3/11/2010	Added sheet	RG	K. Corlew	A. Dela Cruz	R. Grubbs	16861	Jan. - 2010			83578
ACCOMPANIED BY DWGS. BR208, BR209 existing as-built plans						OREGON DEPARTMENT OF TRANSPORTATION		ROUGH CREEK, HWY 138 (PENSTOCK) OR230/OR138: NORTH UMPQUA - UPPER ROGUE - BUNDLE 560 NORTH UMPQUA HWY, MP 57.36 DOUGLAS COUNTY		DRAWING NO.
						REGION 3 - TECHNICAL CENTER				

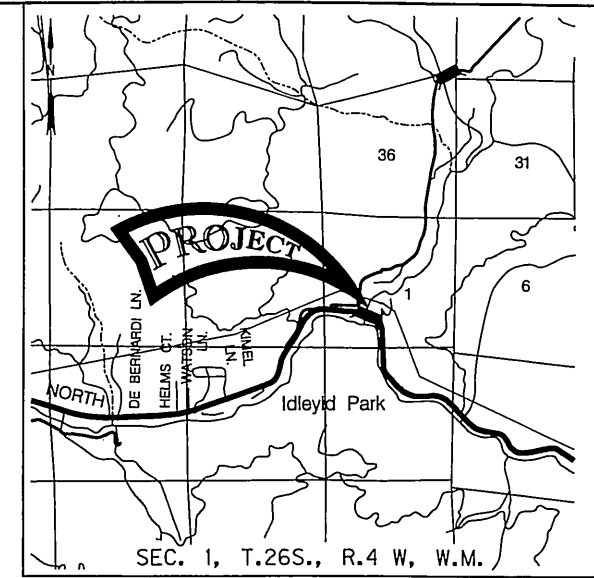
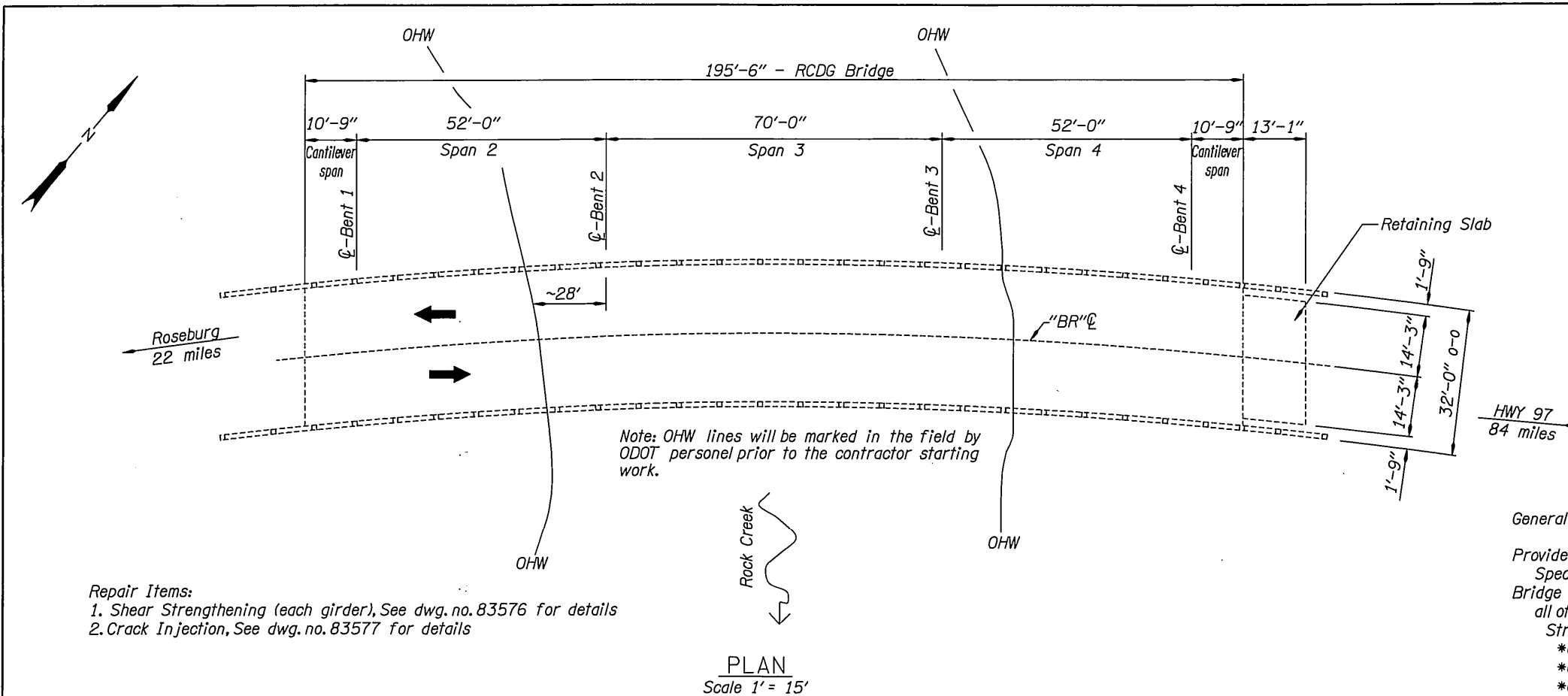

LOCATION MAP
No Scale

Repair Items:
1. Shear Strengthening (each girder), See dwg. no. 83576 for details
2. Crack Injection, See dwg. no. 83577 for details

General Notes:

Provide all materials and perform all workmanship according to the 2008 Standard Specifications for Highway Construction of the Oregon Department of Transportation. Bridge strengthening is designed with an allowance of .50psf for future wearing surface and all of the following Live Loads according to the current AASHTO LRFD Bridge Design Specs:
Strength - II Limit State:
*ODOT Type STP-5BW Permit Truck
*ODOT Type STP-4E Permit Truck
*ODOT Type STP-4D Permit Truck

Provide fully threaded anchor rods conforming to ASTM A449 or ASTM A193 (Grade B7) for internal shear anchors.
-Avoid existing reinforcement.

PLAN
Scale 1' = 15'

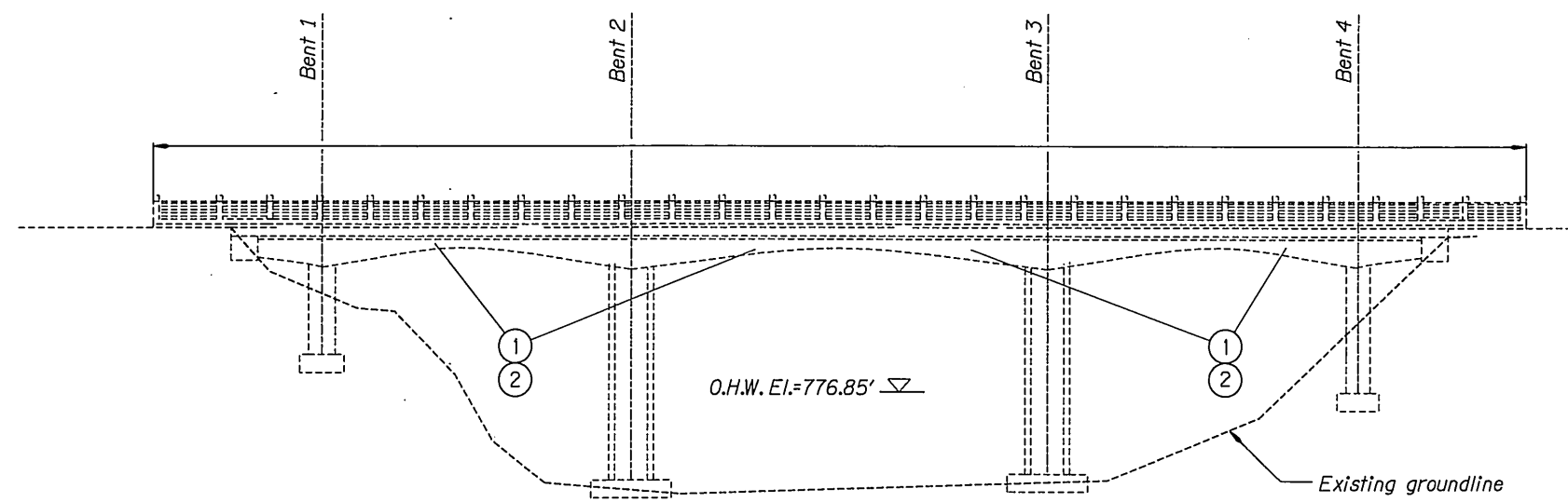

Note: Area below OHW elevation is a "No Work Zone".

ELEVATION
Scale 1' = 15'

DATE	REVISION	BY	DRAFTER: Jill Hector	STRUCTURE NO. 07904	ROCK CREEK, HWY 138 OR230/OR138: NORTH UMPQUA - UPPER ROGUE - BUNDLE 560 NORTH UMPQUA HWY, MP 22.30 DOUGLAS COUNTY	SHEET 1 OF 3
			DESIGNER: K. Corlew			
ACCOMPANIED BY DWGS. Existing as-built plans			CHECKER: A. Dela Cruz	CALC. BOOK 5743	PLAN & ELEVATION	DRAWING NO. 83575
			REVIEWER: R. Grubbs			

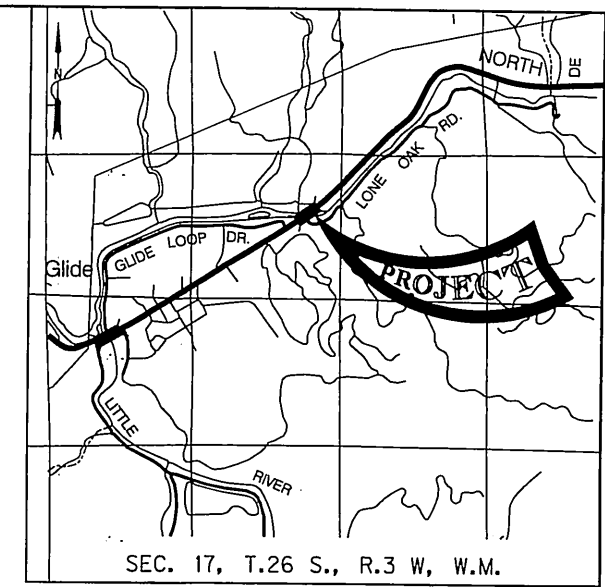
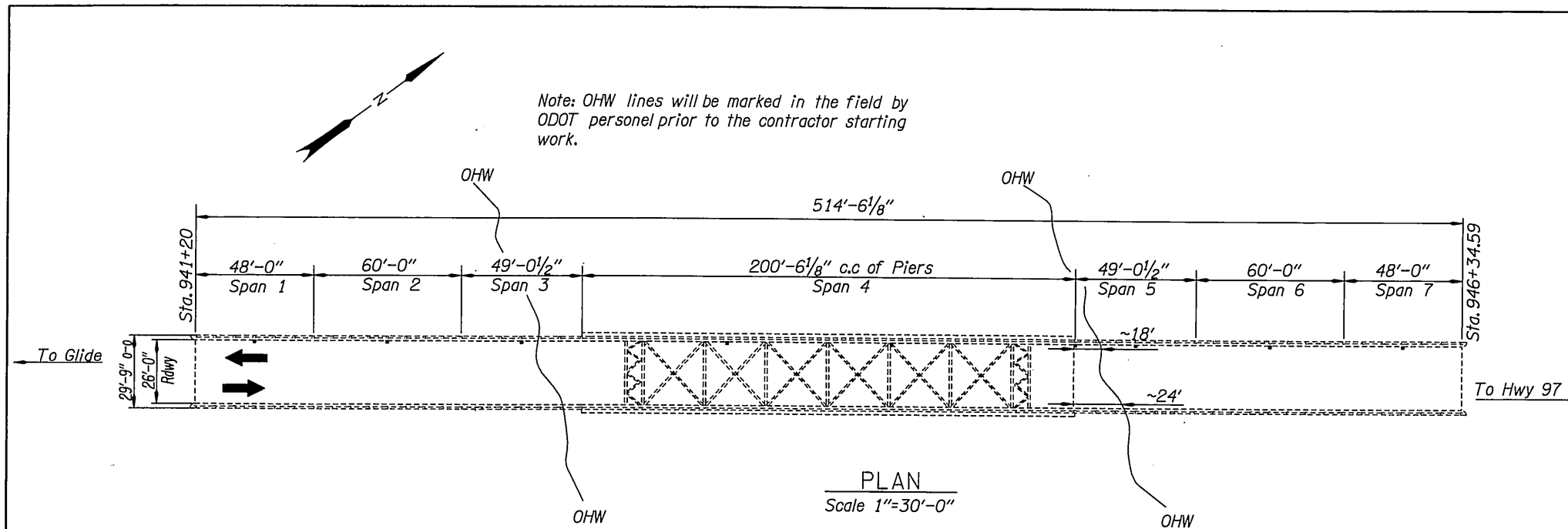

LOCATION MAP
No Scale

- Repair Items:
1. Shear Strengthening (each girder), See dwg. no. 83574 for details
 2. Crack Injection, See dwg. no. 83573 for details
 3. Seismic Retrofit, See dwg. no. 83571 and 83572 for details
 4. 2 Tube Curb mounted Rail Retrofit, See dwg. no. 83573 for details

General Notes:

Provide all materials and perform all workmanship according to the 2008 Standard Specifications for Highway Construction of the Oregon Department of Transportation. Bridge strengthening is designed with an allowance of 50psf for future wearing surface and all of the following Live Loads according to the current AASHTO LRFD Bridge Design Specs: Strength - II Limit State:
 *ODOT Type STP-5BW Permit Truck
 *ODOT Type STP-4E Permit Truck
 *ODOT Type STP-4D Permit Truck
 Provide all reinforcing steel according to ASTM specification A706, or AASHTO M31 (ASTM A615) Grade 60. Provide field bent stirrups according to ASTM Specification A706. Use the following splice lengths, unless shown otherwise:

REINFORCING SPLICE LENGTHS (CLASS B) GRADE 60 f'c = 3.3 ksi										
Bar Size	#3	#4	#5	#6	#7	#8	#9	#10	#11	#14 & #18
Uncoated	1'-0"	1'-4"	1'-8"	2'-0"	2'-9"	3'-7"	4'-6"	5'-9"	7'-0"	Not Permitted
Coated (1)	1'-2"	1'-7"	2'-0"	2'-5"	3'-3"	4'-3"	5'-5"	6'-10"	8'-5"	Not Permitted
Coated (2)	1'-6"	2'-0"	2'-6"	3'-0"	4'-1"	5'-4"	6'-9"	8'-7"	10'-6"	Not Permitted

Use coated (1) for epoxy coated bars with cover at least 3*d_b and clear spacing between bars at least 6*d_b.

Use coated (2) for epoxy coated bars with cover less than 3*d_b and clear spacing between bars less than 6*d_b.

Increase all splice lengths 40% for horizontal or nearly horizontal bars so placed that more than 12" of fresh concrete is cast below the bar.

Provide a minimum clear cover of 2" for all reinforcing unless shown otherwise or noted as follows:

- top of deck slab = 2 1/2"
- bottom of deck slab = 1 1/2"
- stirrup ties = 1"

Splice reinforcing steel at alternate bars, staggered at least one splice length or as far as possible, unless shown otherwise.

Provide Class 3300 - 3/4 concrete for all concrete.

Provide fully threaded anchor rods conforming to ASTM A449 or ASTM A193 (Grade B7) for internal shear anchors.

-Avoid existing reinforcement.

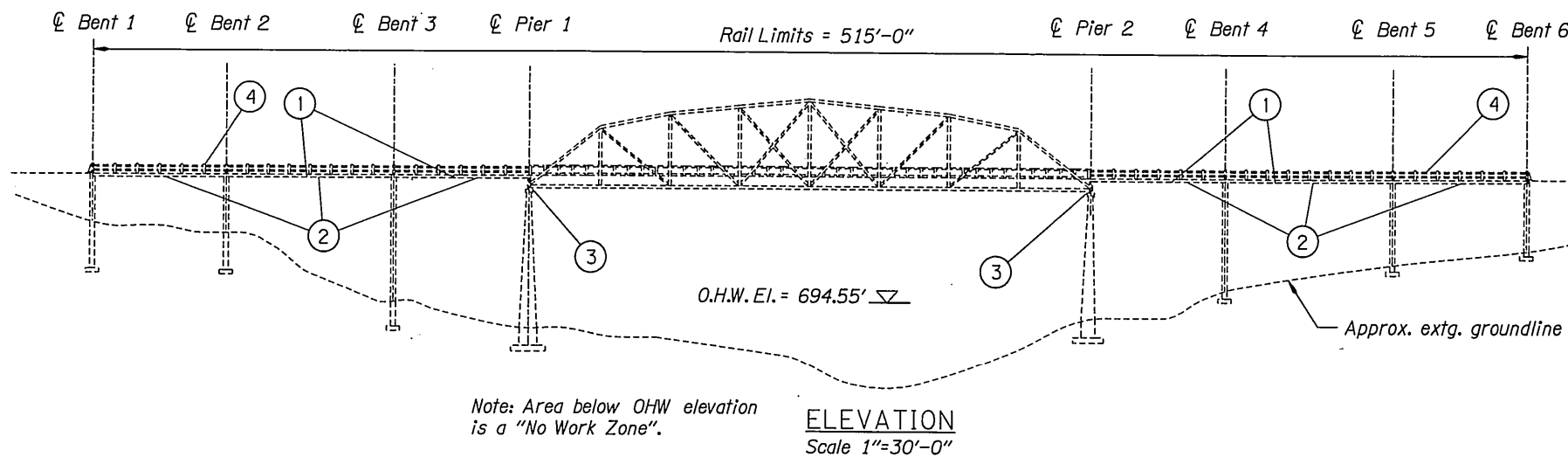

ELEVATION
Scale 1"=30'-0"

DATE	REVISION	BY	DRAFTER: K. Corlew			STRUCTURE NO.	NORTH UMPQUA RIVER, HWY 138 (LONE ROCK) OR230/OR138: NORTH UMPQUA - UPPER ROGUE - BUNDLE 560 NORTH UMPQUA HIGHWAY, MP 17.86 DOUGLAS COUNTY	SHEET
			DESIGNER: K. Corlew			02496		1 OF 5
ACCOMPANIED BY DWGS. BR206, existing as-built plans			CHECKER: A. Dela Cruz			DATE		DRAWING NO.
			REVIEWER: R. Grubbs			Jan. - 2010		
					CALC. BOOK 5743	PLAN & ELEVATION		