

EVERGREEN DETAIL

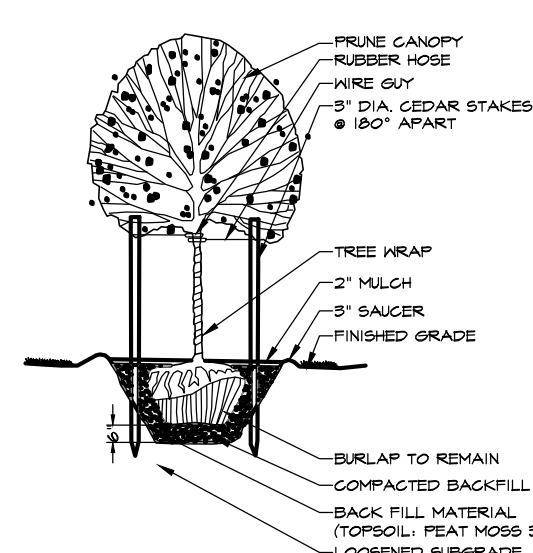

DECIDUOUS TREE DETAIL

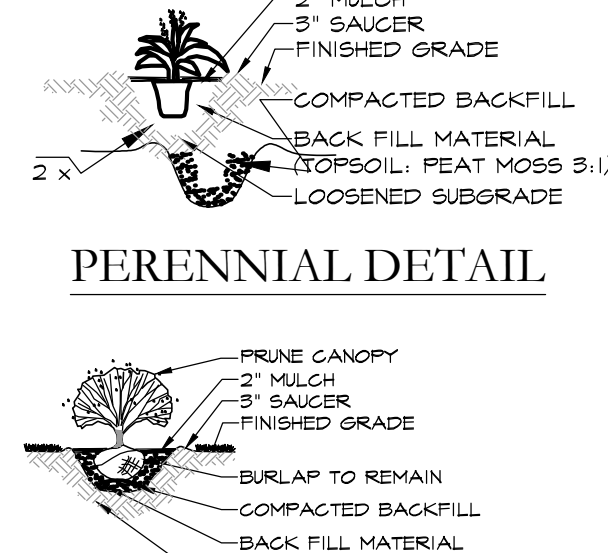

PERENNIAL DETAIL

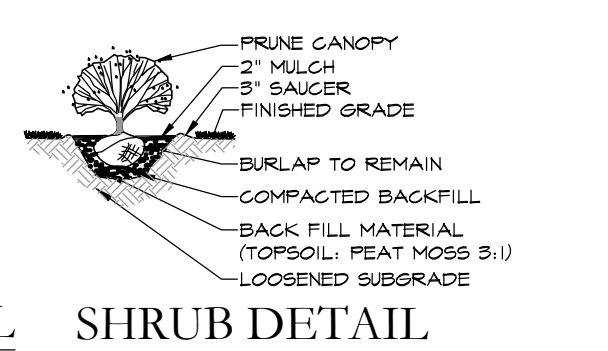

SHRUB DETAIL

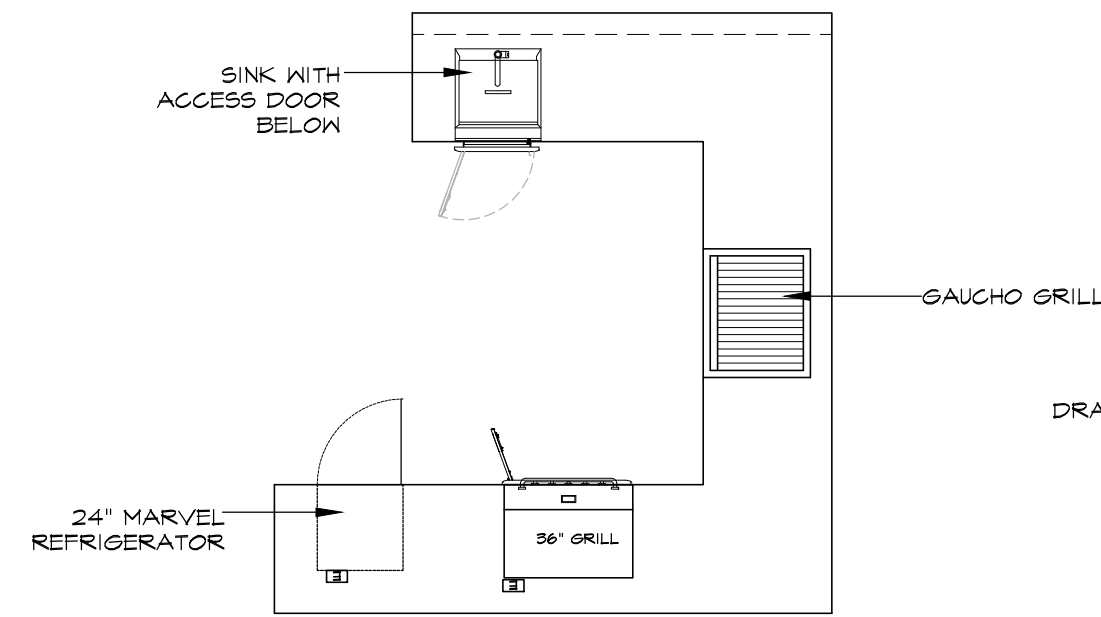

BARBECUE DETAILS

SCALE: NTS

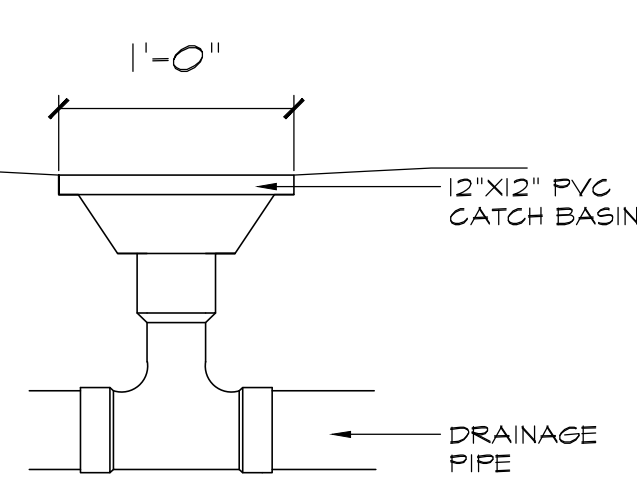
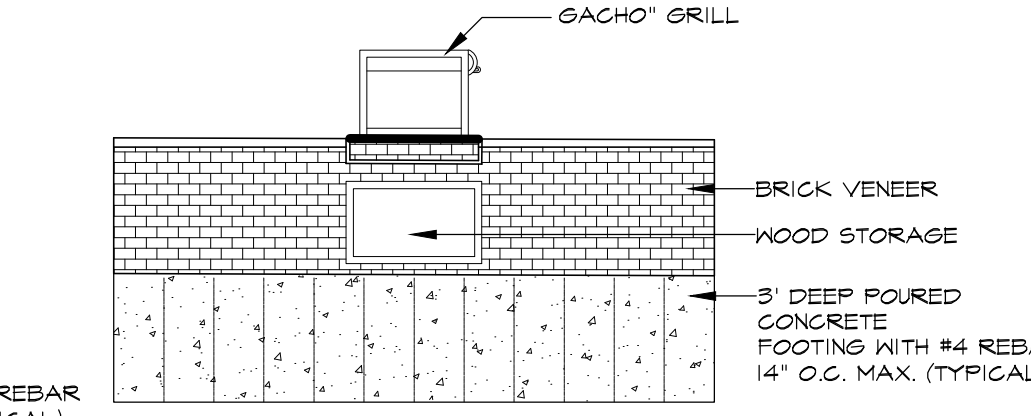
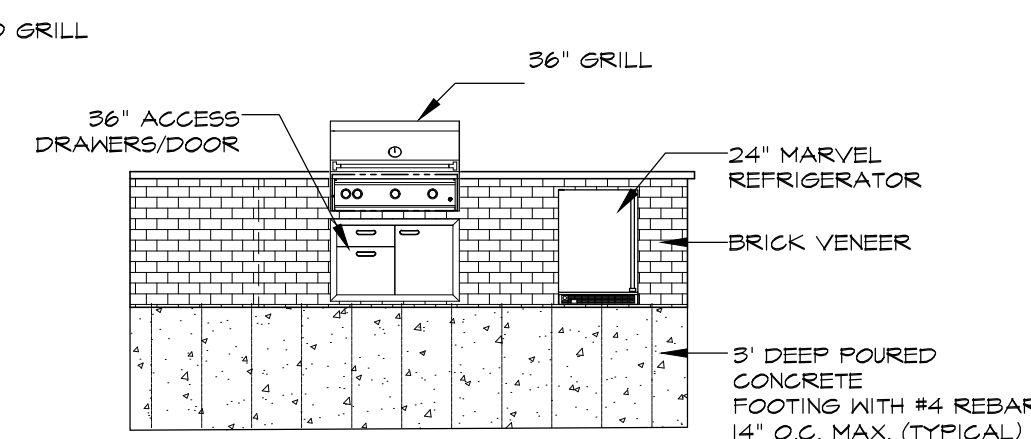
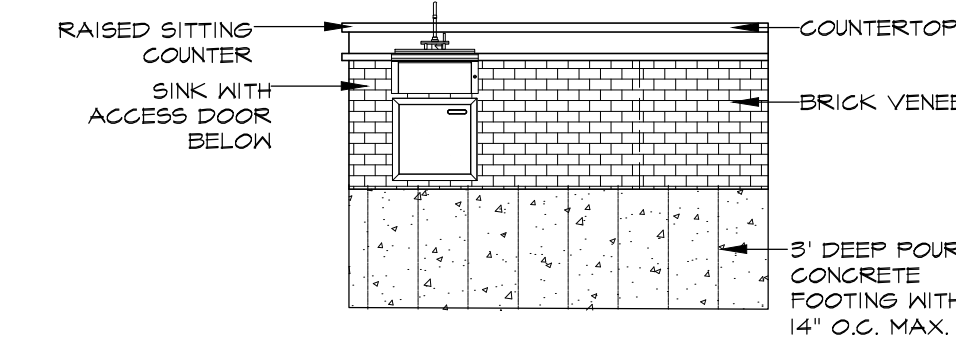

CATCH BASIN DETAIL

SCALE: NTS

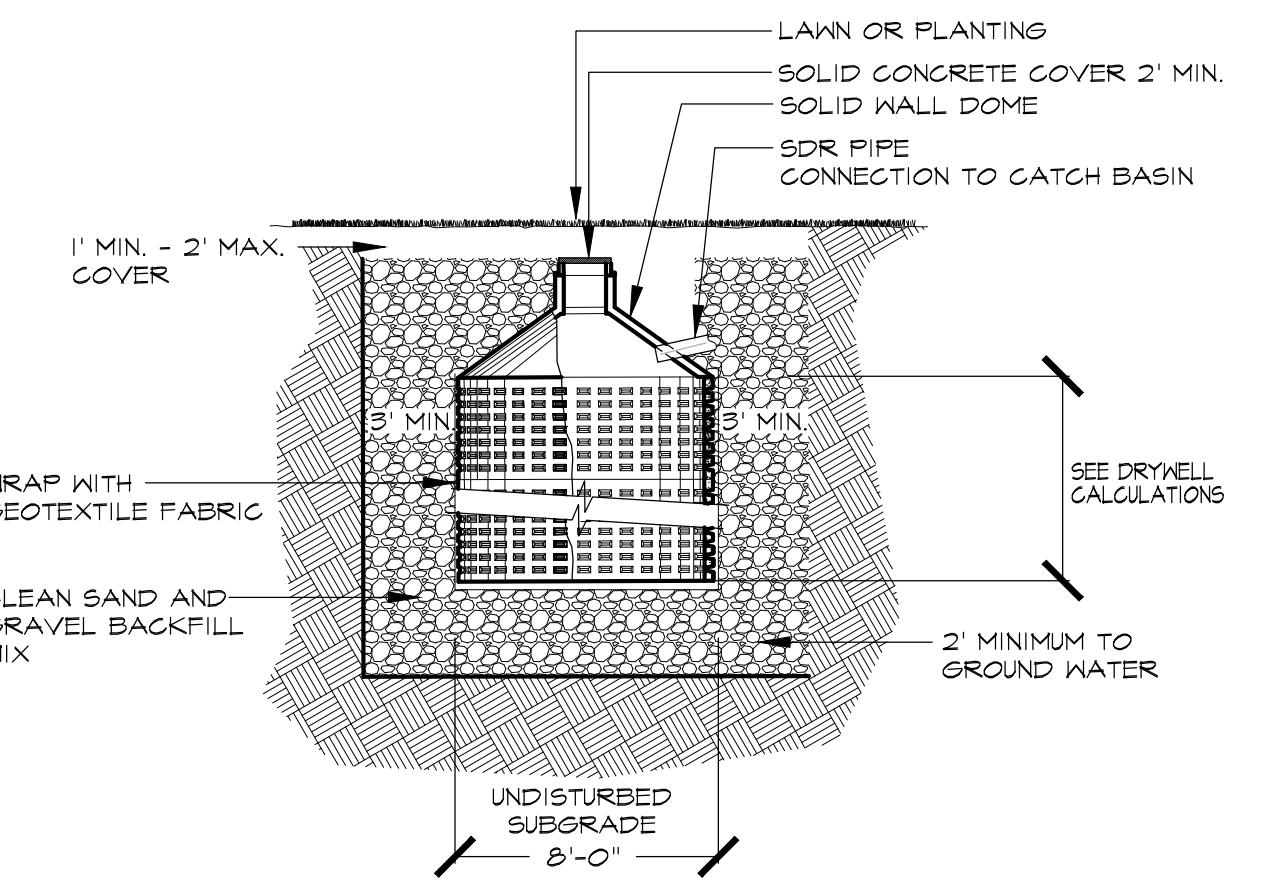

DRYWELL DETAIL

SCALE: NTS

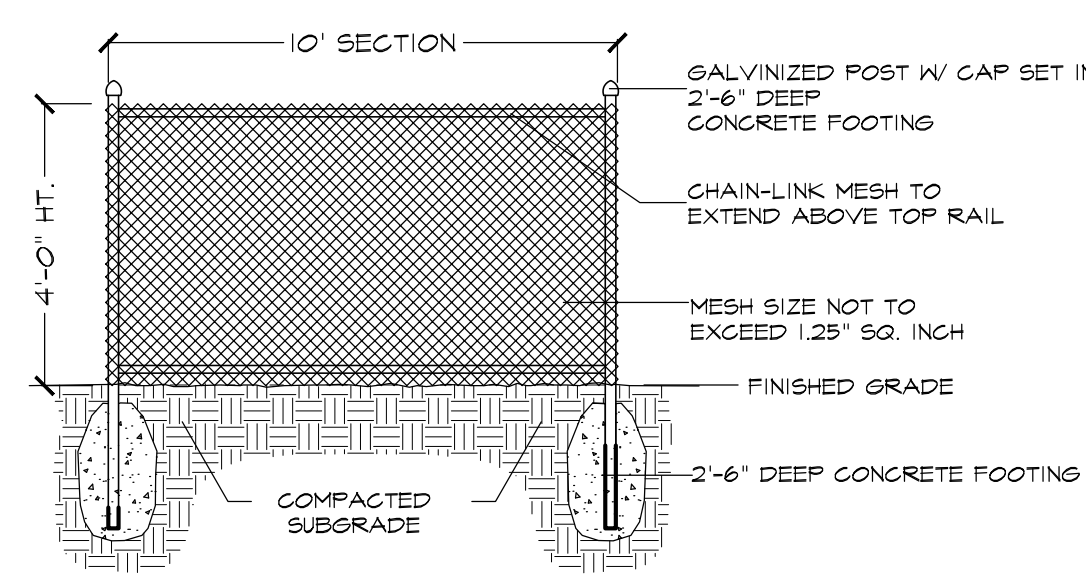

CHAIN LINK FENCE DETAIL

SCALE: NTS

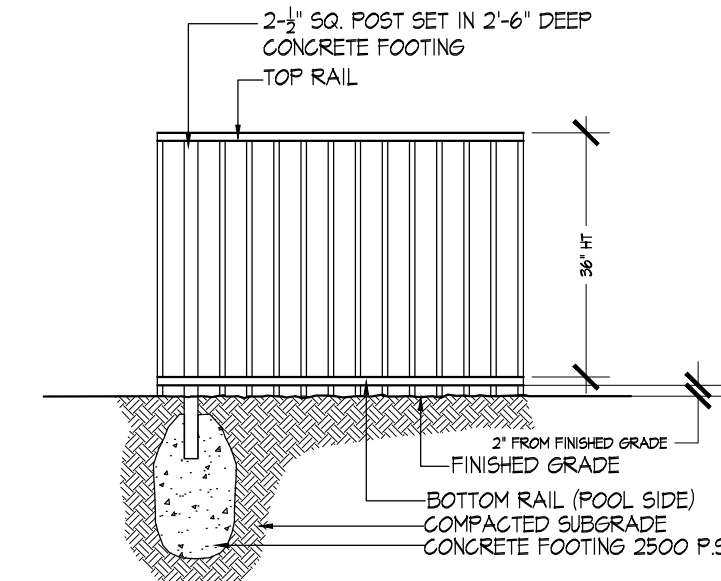

ALUMINUM ESTATE FENCE DETAIL

SCALE: NTS

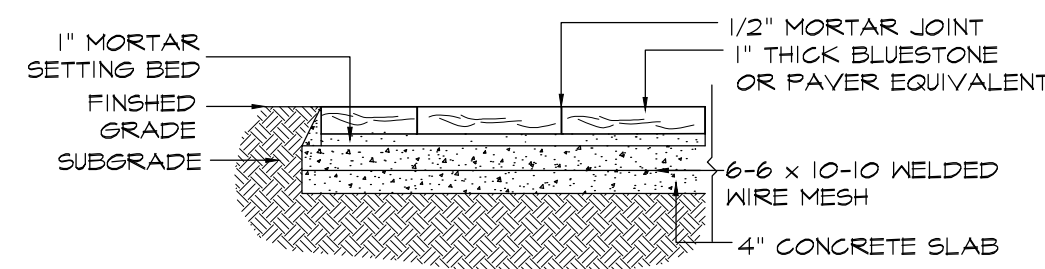

PAVING DETAIL

SCALE: NTS

PROPOSED NEW PLANT SCHEDULE				
QTY	SYMBOL	BOTANICAL NAME	COMMON NAME	SIZE
1	LI	LAGERSTROEMIA	GRAPE MYRTLE	8-10' HT.
5	HA	HYDRANGEA 'ANNABELLE'	ANNABELLE HYDRANGEA	5 GAL.
5	HW	HYDRANGEA 'WEE WHITE'	WEE WHITE HYDRANGEA	5 GAL.
10	HY	HYDRANGEA 'ALL SUMMER BEAUTY'	ALL SUMMER BEAUTY HYDRANGEA	5 GAL.
17	IC	ILEX CRENATA	JAPANESE HOLLY	21-24"
41	PS	PRUNUS SCHIPKAENSIS	SKIP LAUREL	3-4' HT.
9	SP	SPIREA 'ANTHONY WATERER'	ANTHONY WATERER SPIREA	3 GAL.

LEGEND	
	EXISTING COURT AND TERRACE TO BE REMOVED
	PROPOSED DRAINAGE
	EXISTING TREE TO REMAIN
	EXISTING HEDGE TO REMAIN
	EXISTING TREE TO BE REMOVED

Landscape Architect:
Kevin J. Natalie, RLA
NY State Registered Landscape Architect
001775
36 The Glen
Glen Head, NY 11545



LOT COVERAGE CALCULATIONS:

MAX. IMPERVIOUS SURFACE COVERAGE

-MAX. PERMITTED 14502.12 (LOT SIZE)-12,001 (LOT AREA) = 2501.12 x 26% = 650.29
650.29 + 4520 = 5,170.29 sq ft

EXISTING IMPERVIOUS COVERAGE

- DWELLING = 3,230 sq ft
- DRIVEWAY = 1,848 sq ft
- FRONT LANDING = 63 sq ft
- SIDE WALK = 242 sq ft
- SIDE LANDING = 23 sq ft
- REAR LANDING = 40 sq ft
- REAR TERRACE = 562 sq ft
- GAME COURT = 765 sq ft
- AC UNITS = 25 sq ft
6,798 sq ft

TOTAL EXISTING IMPERVIOUS SURFACE LOT COVERAGE = 6,798 sq ft

PROPOSED IMPERVIOUS COVERAGE

- EX DWELLING = 3,230 sq ft
- EX DRIVEWAY = 1,848 sq ft
- EX FRONT LANDING = 63 sq ft
- EX AC UNITS = 25 sq ft
- EX SIDE LANDING = 23 sq ft
- PROPOSED REAR LANDING AND STEPS = 59 sq ft
- PROPOSED REAR TERRACES (763 + 140) = 903 sq ft
- PROPOSED BARBECUE = 42 sq ft
- PROPOSED POOL INCLUDING COPING = 480 sq ft
- PROPOSED POOL EQUIPMENT = 30 sq ft
6,753 sq ft

TOTAL PROPOSED IMPERVIOUS SURFACE LOT COVERAGE = 6,753 sq ft

PROPOSED LOT COVERAGE (STRUCTURES ABOVE GRADE)

-MAX. PERMITTED LOT COVERAGE FOR RESIDENCE B= 15% = 14502.12 x .15 = 2,175.31 sq ft

- EX DWELLING = 3,230 sq ft
- EX FRONT LANDING = 63 sq ft
- EX AC = 25 sq ft
- EX SIDE LANDING = 23 sq ft
- PROPOSED REAR LANDING AND STEPS = 59 sq ft
- PROPOSED POOL INCLUDING COPING (BELOW GRADE) = 480 sq ft
- PROPOSED POOL EQUIPMENT = 30 sq ft
- PROPOSED BBQ = 42 sq ft

TOTAL PROPOSED LOT COVERAGE (STRUCTURES ABOVE GRADE) = 4,002 sq ft

PROPOSED LOT COVERAGE IS 4,002 SQ FT IS 1826.69 SQ FT OVER THE MAX. PERMITTED LOT COVERAGE OF 2,175.31

DRYWELL CALCULATIONS

3" RAINFALL

POOL TERRACE, REAR LANDING AND STEPS: 962 SQ FT
(962 SQ FT) x (.25) = 240.5 CUBIC FEET REQUIRED
240.5/42.26 = 5.69 VERT. FT. OF DEPTH REQUIRED

10% OF POOL CAPACITY

342 SQ. FT. X 6 FT. DEEP AVERAGE = 2,052 CU. FT.
2,052 X 10% = 205.2 CU. FT.
205.2 CU. FT. / 42.26 = 5.5 VERT. FT.

POOL TERRACE: 5.69 VERT. FT. REQ.
POOL CAPACITY: 5.5 VERT. FT. REQ.
TOTAL: 11.2 or 12 VERTICAL FEET OF 8" diam DRYWELL REQUIRED

RES B	ZONING CHART		LOT SIZE: 14,502.12 SF
	REQUIRED	PROPOSED	
POOL SIDE SETBACK	25 FT MIN	25' FT	YES
POOL REAR SETBACK	25 FT MIN	25' FT	YES
POOL EQUIP SIDE SETBACK	25 FT MIN	25' FT	YES
POOL FENCE	25 FT MIN	25' FT	NO
FENCE	SHRUBBERY REQUIRED ALONG EXTERIOR SIDE	5' EXISTING HEDGING TO REMAIN	YES
OUTDOOR KITCHEN	MIN 5 FT	7-3' FT	YES

SITE PLAN
SELINGER
RESIDENCE

56 WILLOW ROAD
WOODSBURG, NEW YORK 11598



SCALE: 1"=10'-0"

DATE: AUGUST 3, 2021

REVISIONS: AUGUST 23, 2021 (ZONING CHART, SETBACKS)

SURVEY NOTES:
INFORMATION FOR
BASE PLAN TAKEN
FROM SURVEY BY
ISLAND WIDE LAND
SURVEYORS

31 Prospect St
Huntington, New York 11743
P:(631) 547-5200
F:(631) 547-0340

P.O. Box 1376
910 Montauk Highway
Water Mill, New York 11976
P:(631) 726-6610
F:(631) 726-6619

Copyright © The Laurel Group. The design, drawings, specifications, and documents prepared by this office are instruments of the designer's service. The Laurel Group retains all common law, statutory, and other reserved rights, including copyright. All documents prepared by The Laurel Group shall not be used by the owner/client or others for this project or for any modifications to this project for completion by other. No part of these documents may be reproduced or utilized in any form by any means without written permission from The Laurel Group.

ALL CONTRACTORS AND SUB-CONTRACTORS ARE RESPONSIBLE FOR MARKING OUT AND WORKING SAFELY AROUND ALL UNDERGROUND UTILITIES THAT ARE PRESENT ON THE PROPERTY