



# For Lease

**Available Space:**  
 Approximately 14,350 sq ft available

## Location

Easy access to IH35 at  
 495 Round Rock West Drive  
 Round Rock, TX



**This property Located conveniently to IH35 Has been a lab for motors, computers and lighting. It is heavy in electrical power and compressed air. The lay out has hard wall offices and shop area and a large area for Tenant's cubicles. Cubicles as shown in drawing are not part of the lease offering but gives ideas as how it was laid out. The property is clean and appears to be well maintained by the former Tenant. The current Tenant has only a few employees at the property therefore move-in is near**

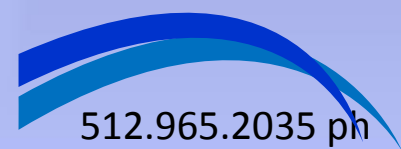
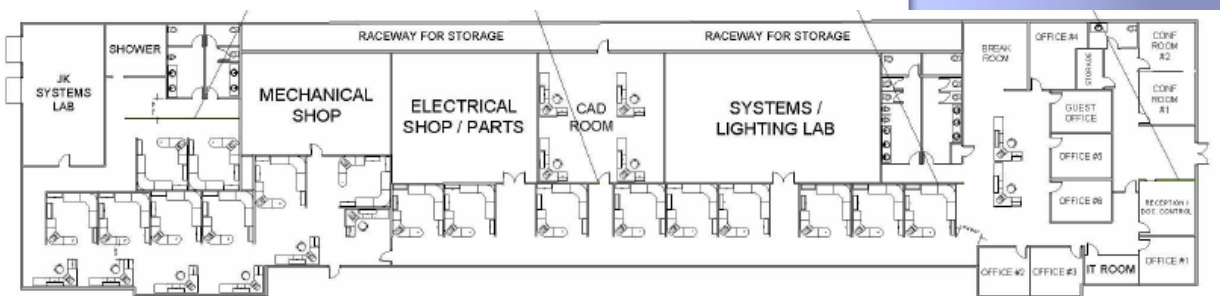

512.965.2035 ph  
 jb@jbrealtyaustin.com

All information regarding this property is from sources deemed reliable, however no independent investigation has been made of this information and no warranty or representation is made as to the accuracy thereof. This property is submitted subject to errors, omissions, change of price, withdrawal from the market, prior sale and/or other conditions. No warranties or representations are made as to any condition that may affect the value or suitability of the property and Buyer must independently verify same. All measurements, values and numbers are approximate and must be verified by Buyer prior to closing.