



Dow Building Solutions

# THERMAX™ Brand Insulation

## Distinguished among the competition



THERMAX™ outperforms the industry's other polyisocyanurate ("polyiso") insulations. With 16 patents on its unique performance and innovation since 1975, THERMAX surpasses industry competition for fire resistance<sup>[1]</sup>, dimensional stability<sup>[2]</sup>, flashing options, facer variety, R-Value<sup>[3]</sup>, system warranty, and more.

### Glass Fiber Reinforced Core

THERMAX insulations have expanded fiberglass throughout the foam core, not just in one layer. This makes it *less friable*, gives it *better fire resistance* since it will char before burning, and results in *superior dimensional stability*. Because of the even dispersion of glass fibers throughout the foam core, THERMAX will perform better in "kerf cut" (curved) applications, allowing for maximum design flexibility.

### Fluid Applied Flashing / Joint Treatment

LIQUIDARMOR™ fluid applied flashing, available in acrylic sprayable formula (-CM) as well as trowel-able silicone formulation (-LT), makes *sealing board joints faster* than with tape, and *eliminates issues* that often accompany tape application (gaps, wrinkles, etc.).

### Superior R-Value

From room temperature to the lower temperature range of 20°F, THERMAX Brand Insulation *gains R-Value at lower mean temperatures*, unlike other types of polyisocyanurate insulations that have been reported to lose significant R-Value in third party studies (see Figure 1 below). See Tech Solution 538.0 for more information.

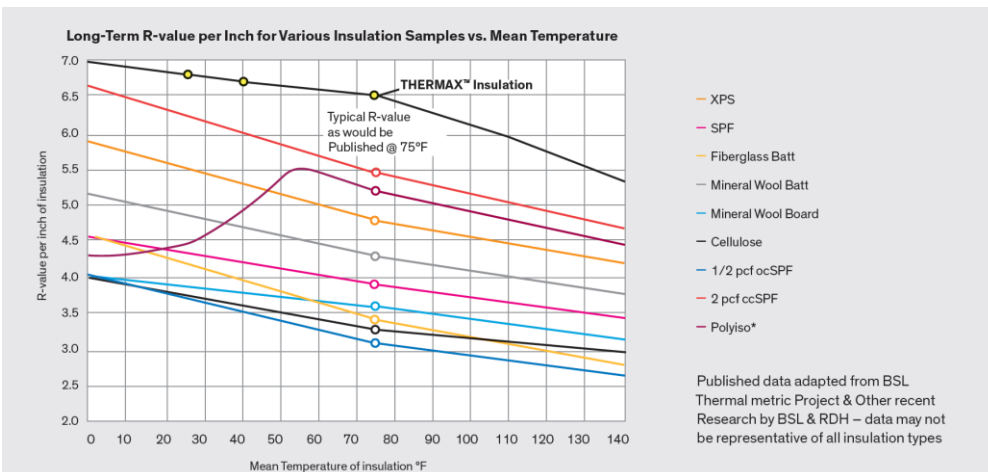

### Choose the Best THERMAX for Your Project

THERMAX brand insulations have a wide variety of facers to meet the needs of your diverse range of projects. Choose products for interior / exterior, exposed / covered, robust / economic applications.

#### THERMAX XArmor CI

4 mil gray facer  
Exterior continuous insulation  
Used in THERMAX Wall System

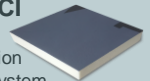

#### THERMAX CI

1.25 mil blue facer  
Exterior continuous insulation  
Used in THERMAX Wall System

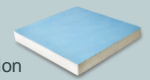

#### THERMAX Sheathing

1 mil smooth facer  
Multi-purpose

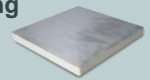

#### THERMAX Heavy Duty

4 mil white facer  
Interior insulation & finish

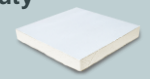

#### THERMAX Light Duty

1.25 mil white facer  
Interior insulation & finish



Figure1: Common Representation of Selected Insulation R-Values as a function of Mean Temperature with THERMAX Brand Insulation properties added.

## System Warranty

Projects using the THERMAX Wall System can be registered for our System Warranty. This market leading warranty *reduces your risk* by covering the elements: thermal performance, water resistance, and UV exposure. Warranties are unique to each project, listing project owner, address, date of warranty issuance, and distinct warranty number.

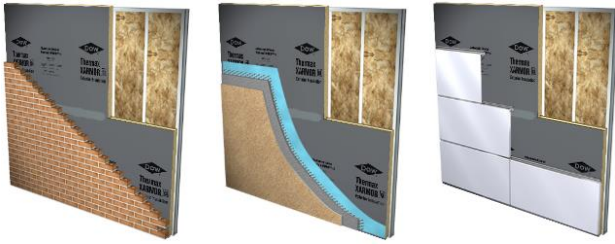

## NFPA 285 Approved Assemblies

Today, Dow strives to make it easier for designers to insulate walls with continuous insulation to meet IBC and ASHRAE for energy efficient assemblies and to pass fire tests like ASTM E84 and NFPA 285 per IBC Chapter 26. There are many NFPA 285 approved assemblies using THERMAX insulation, including use with MCM, Metal Panels, and High Pressure Laminate veneers. *Try our Wall Builder tool* to begin your design: [building.dow.com/en/wall-builder](http://building.dow.com/en/wall-builder)

<sup>1</sup>THERMAX is the only polyiso with FM 4880 approval in the corner burn test that allows you to leave THERMAX exposed to the interior without thermal barrier in both ceiling and wall application for Factory Mutual Insured Buildings. THERMAX has also passed UL 1715 and NFPA 286 for use on interior walls AND ceiling without thermal barrier.

<sup>2</sup>THERMAX has 20x better dimensional stability: 0.1% movement per length vs. 2% standard acceptance per ASTM D2126.

<sup>3</sup>THERMAX outperforms tested R-values of typical generic polyisocyanurate foam down to 20°F per ASTM C518.

*Can other polyisos compare?*

	Expanded Fiberglass Throughout Foam Core	Class A (ASTM E84) for All Sizes & Facers	Widest Range of NFPA 285 Assemblies	Only Polyiso with Corner Burn Test for BOTH Wall and Ceiling	Higher R-Value	Fluid Applied Joint Sealer	Widest Variety of Facers	Best in Class System Warranty	Better Dimensional Stability
<b>THERMAX</b>	✓	✓	✓	✓	✓	✓	✓	✓	✓



In the U.S.  
**The Dow Chemical Company**  
 Dow Building Solutions  
 200 Larkin Center  
 Midland, MI 48674

In Canada  
**Dow Chemical Canada ULC**  
**Dow Building Solutions**  
 450 – 1<sup>st</sup> St. SW  
 Suite 2100  
 Calgary, AB T2P5H1

For Technical Information:  
**1-866-583-BLUE** (2583) (English)  
**1-800-363-6210** (French)

For Sales Information:  
**1-800-232-2436** (English)  
**1-800-565-1255** (French)

[dowbuildingsolutions.com](http://dowbuildingsolutions.com)

NOTICE: No freedom from any patent owned by Dow or others is to be inferred. Because use conditions and applicable laws may differ from one location to another and may change with time, Customer is responsible for determining whether products and the information in this document are appropriate for Customer's use and for ensuring that Customer's workplace and disposal practices are in compliance with applicable laws and other government enactments. The product shown in this literature may not be available for sale and/or available in all geographies where Dow is represented. The claims made may not have been approved for use in all countries or regions. Dow assumes no obligation or liability for the information in this document. References to "Dow" or the "Company" mean The Dow Chemical Company and its consolidated subsidiaries unless otherwise expressly noted. NO WARRANTIES ARE GIVEN; ALL IMPLIED WARRANTIES OF MERCHANTABILITY OR FITNESS FOR A PARTICULAR PURPOSE ARE EXPRESSLY CONCLUDED.

The buyer assumes all risks as to the use of the material. Buyer's exclusive remedy or any claim (including without limitations, negligence, strict liability, or tort) shall be limited to the refund of the purchase price of the material. Failure to strictly adhere to any recommended procedures shall release The Dow Chemical Company of all liability with respect to the materials or use thereof. The information herein is not intended for use by non-professional designers, applicators or other persons who do not purchase or utilize this product in the normal course of their business.

CAUTION: This product is combustible and shall only be used as specified by the local building code with respect to flame spread classification and to the use of a suitable thermal barrier. For more information, consult MSDS, call Dow at 1-866-583-BLUE (2583) or contact your local building inspector. In an emergency, call 1-989-4400.

**WARNING: Rigid foam insulation does not constitute a working walkable surface or quality as a fall protection product.**

Building and/or construction practices unrelated to building materials could greatly affect moisture and the potential for mold formation. No material supplier including Dow can give assurance that mold will not develop in any specific system.

®™ TRADEMARK OF THE DOW CHEMICAL COMPANY ("DOW") OR AN AFFILIATED COMPANY OF DOW.

Form No. 179-00379-0417