

**Come Cruise with the Ski Club on January 6<sup>th</sup> -16<sup>th</sup> 2019**

**Roundtrip from Fort Lauderdale onboard the Zuiderdam**



Guests aboard *Zuiderdam*, the first in our Vista-class series, enjoy a spectacular art and antique collection, wide teak decks, elegant dining rooms and spacious staterooms-many with verandahs. At the heart of *Zuiderdam*, suspended in a three-story atrium, is a Waterford Crystal Seahorse. Other notable pieces include a painting of Queen Beatrix by pop culture artist and icon, Andy Warhol, medallions by Frank Lloyd Wright, and a massive floral painting by Charles Ben.

While on-board, choose from an array of onboard activities that allow you to pursue new interests or relax and rejuvenate. Explore the wonders of our world through exclusive BBC Earth natural history content through onboard activities, concerts and films. Enjoy onboard cooking shows and hands-on workshops in partnership with America's Test Kitchen Learn how to edit, display and share your vacation videos and photographs through our Digital Workshop powered by Windows®. The Greenhouse Spa & Salon offers spa treatments, a thermal pool and lounge and a variety of salon services. Our fully equipped Fitness Center includes state-of-the-art cardio and weight machines, as well as classes in Yoga, Pilates, indoor cycling and more. On deck enjoy two outdoor pools, along with basketball and volleyball courts.

*Zuiderdam* guests enjoy dazzling entertainment options from their very first night on board. As part of the updates done in November 2017, two new music venues have been added: Lincoln Center Stage, featuring world-class musicians performing chamber music, and Billboard Onboard, rocking the house with 50 years of chart-topping hits. These venues will join the already popular B.B. King's Blues Club, which brings the best of Memphis blues to sea, and completes our new "Music Walk" experience.



Sunday, January 6	<a href="#">Fort Lauderdale, FL</a>	5:00pm
Monday, January 7	<a href="#">Half Moon Cay, Bahamas</a>	8:00am 3:00pm
Tuesday, January 8	At Sea	
Wednesday, January 9	<a href="#">Aruba</a>	1:00pm 11:00pm
Thursday, January 10	<a href="#">Curacao</a>	8:00am 4:00pm
Friday, January 11	At Sea	
Saturday, January 12	<a href="#">Panama Canal (Partial Transit)</a> (Cruising)	
Saturday, January 12	<a href="#">Colon, Panama</a>	3:00pm 8:00pm
Sunday, January 13	<a href="#">Puerto Limon, Costa Rica</a>	6:30am 4:00pm
Monday, January 14	At Sea	
Tuesday, January 15	At Sea	
Wednesday, January 16	<a href="#">Fort Lauderdale, FL</a>	7:00am

## Suites & Staterooms

Holland America Line's graceful, mid-sized ships are known for their generous amount of personal space. All staterooms feature luxurious Sealy® Premium Euro-Top mattresses, fine linens and towels, premium massage showerheads and Elemis Aromapure bath products. And you're going to love the inspired enhancements to suites (more to come in May 2018).

**Signature Suites** Category: SS, SY, SZ **Prices starting at \$ 2,299**

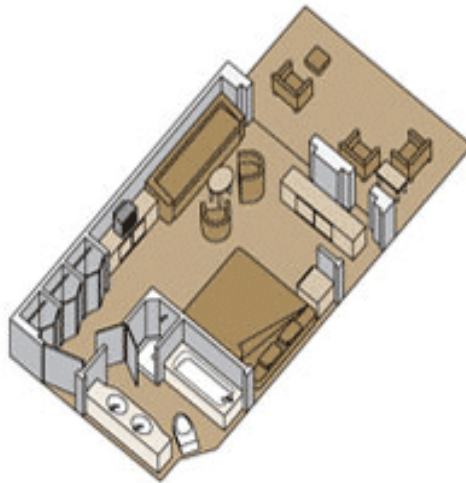

2 lower beds convertible to 1 queen-size bed, bathroom with dual sink vanity, full-size whirlpool bath, shower and additional shower stall, large sitting area, private verandah, 1 sofa bed for 1 person, floor-to-ceiling windows. Approximately 372–384 sq. ft. including verandah.

Include all the stateroom amenities, plus:

- **New** premium duvet, and soft, cotton bathrobes and slippers
  - **New** binoculars for use during voyage
- A variety of firm, medium and soft pillows
- No-host mini-bar for easy entertaining
  - Oversized bath towels
- One-touch telephone concierge service
  - Fresh flowers
- Complimentary DVD library

**Verandah** Category: VQ, V, VA, VB, VC, VD, VE, VF, VH Prices starting at \$1,999

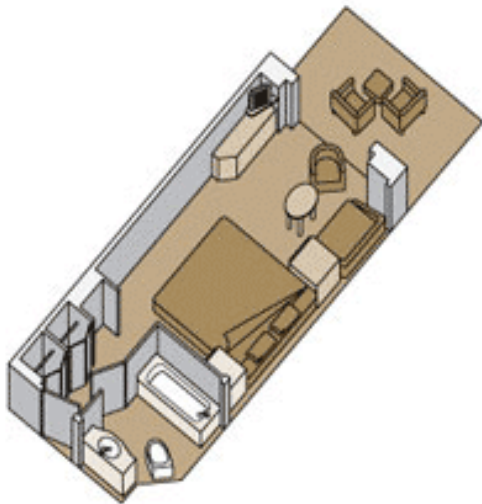

2 lower beds convertible to 1 queen-size bed, bathtub, shower, sitting area, private verandah, floor-to-ceiling windows. Approximately 212–359 sq. ft. including verandah.

Stateroom amenities include:

- Our signature Mariner's Dream™ bed featuring plush Sealy Posturepedic® Euro-Top mattress and finely woven cotton linens
- Deluxe waffle weave and terry cloth bathrobes for use during your voyage
- 100% Egyptian cotton towels
- Premium massage showerheads
- 5X magnifying make-up mirrors and salon-quality hair dryers
- Fragrant soaps, lotions, shampoo and other bath amenities from Elemis Aromapure
- Complimentary fresh fruit on request
- Elegant ice bucket and serving tray for in-stateroom beverages
- Flat-panel TV and DVD player
- Ice service, shoeshine service and nightly turndown service

- **Ocean-view Large or Standard Ocean-view Staterooms Prices starting at \$1,499**  
Full Ocean-view: C, D, DD, E, F, G\*  
Partial Sea-view: G\* Obstructed view: GG, H, HH

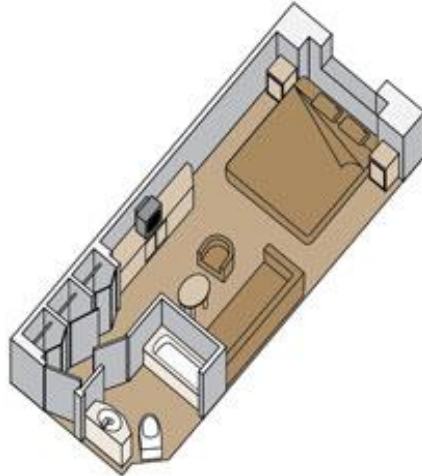

2 lower beds convertible to 1 queen-size bed, bathtub, shower. Approximately 174–180 sq. ft.  
Stateroom amenities include:

- Luxurious beds featuring Sealy® Premium Euro-Top mattresses and finely woven cotton linens
- Deluxe waffle weave and terry cloth bathrobes for use during your voyage
- 100% Egyptian cotton towels
- Premium massage showerheads
- 5X magnifying make-up mirrors and salon-quality hair dryers
- Fragrant soaps, lotions, shampoo and other bath amenities from Elemis Aromapure
- Complimentary fresh fruit on request
- Elegant ice bucket and serving tray for in-stateroom beverages
- Flat-panel TV and DVD player
- Ice service, shoeshine service and nightly turndown service



## **Interior Large or Standard Interior Staterooms Prices Starting at \$1,399**

Large: I, J\*, K\* Standard: L, M, MM, N, NN



2 lower beds convertible to 1 queen-size bed, shower. Approximately 151–233 sq. ft.  
Stateroom amenities include:

- Luxurious beds featuring Sealy® Premium Euro-Top mattresses and finely woven cotton linens
- Deluxe waffle weave and terry cloth bathrobes for use during your voyage
- 100% Egyptian cotton towels
- Premium massage showerheads
- 5X magnifying make-up mirrors and salon-quality hair dryers
- Fragrant soaps, lotions, shampoo and other bath amenities from Elemis Aromapure
- Complimentary fresh fruit on request
- Elegant ice bucket and serving tray for in-stateroom beverages
- Flat-panel TV and DVD player
- Ice service, shoeshine service and nightly turndown service

## Dining Venues

Enjoy everything from a burger and fries by the Lido Pool to the authentic Italian flavors of Canaletto to the ultimate in refined and luxurious dining at the Pinnacle Grill.



### **Dining venues on *Zuiderdam*:**

Pinnacle Grill, Master Chef's Table Pop Up (available on 8+ night cruises), Canaletto, Sel de Mer Pop Up, The Dining Room, Lido Market and the Dive-In

## Activities

Onboard activities abound, including exclusive BBC Earth Experiences: learn about the ocean and natural world through amazing concerts, films, shows, and children's activities. Hone video-editing, movie-making, and scrapbook skills in the Digital Workshop powered by Windows®, rejuvenate at our Greenhouse Spa, go to a wine tasting or simply relax and unwind.



### **Activities offered onboard *Zuiderdam*:**

America's Test Kitchen, BBC Earth Experiences, Movies in the Screening Room, Digital Workshop, powered by Windows, Greenhouse Spa & Salon, Club HAL and The Loft, Fitness Center, Basketball & Volleyball courts, Two swimming pools, The Shops of Holland America Line







## Entertainment & Nightlife

Dazzling entertainment options abound on board *Zuiderdam*, including the popular B.B. King's Blues Club.



### Entertainment offered onboard *Zuiderdam*:

B.B. King's Blues Club, Lincoln Center Stage, Billboard Onboard, Gallery Bar, Vista Show Lounge, Piano Bar, Casino, Ocean Bar, Pinnacle Bar

