

RYERSON REALTY LLC

2761 Country Lane Circle Eagle Grove, IA 50533-8722

Phone 515-448-3079

Fax 515-448-5028

ryerson@goldfieldaccess.net

www.ryersonauctionrealtyltd.com

Deborah Vance, Broker Michael Ryerson, Sales Lisa Foust, Sales

Cell 515-689-3715

Cell 515-689-3728

Cell 515-851-1843



Property Address: 902 Central Ave. East Clarion, Iowa

Property Location: LOT 4 EXC. W 30' & EXC S 10' & LOT 3 BLOCK1 WALNS

Price: \$ 95,000.00

Approx. age construction 1950, 1976 & 1988

Style: Single Story

Real Estate Taxes: \$ 2,028.00 2017-18

Lot Size 76'x120'

Building 1: Block building with entire office space

Gross building area 3360'

2 Toilets—No hot water heater

Paved 3,000 SF, Asphalt parking

Roof: Center is flat with pitch on all the outer edges

Building has 18' x 11' reinforced concrete vault with a 7' ceiling

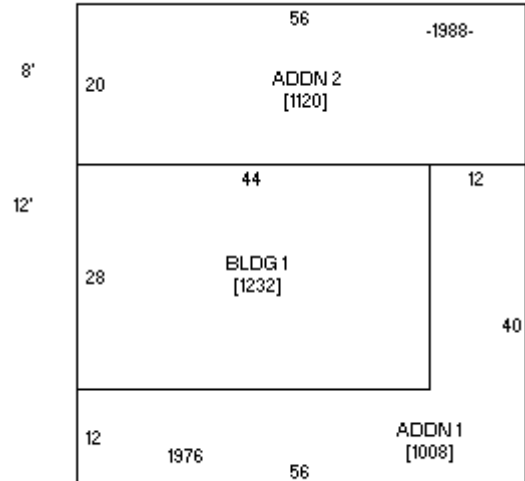

The following information, although believed to be accurate, is not guaranteed to be so.
Buyer should do his own inspections to be sure.

The greatest compliment we can receive is a personal referral. Please tell your friends about us."