

SKI CLUB CRUISE SEPTEMBER 13-21TH 2020



EMBARK ON THE AMERICAN EMPRESS FOR AN UNFORGETTABLE RIVER CRUISE

Proudly serving as the largest overnight riverboat west of the Mississippi River, the *American Empress* delivers classic elegance and modern luxury on a grand scale. One step onboard and you will quickly discover that there is far more to this vessel than her welcoming appearance and signature red paddlewheel.

Boasting a vast collection of some of the finest historical artifacts and artwork of the Native Alaska, Russian, Gold Rush and sternwheeler eras, the corridors of the *American Empress* hold nearly as much beauty and intrigue as the dramatic scenery unfolding on the river outside. You needn't be an art enthusiast to appreciate the captivating display of Pacific Northwest heritage that this unique collection represents.

A river cruise aboard the *American Empress* incites moments of sheer perfection with her seamless blend of stunning backdrops, exceptional dining venues, dynamic public spaces and stunning décor. We invite you to step aboard and delight in the luxurious modern amenities, gracious service and endless authentic experiences that await you.

Grand scale luxury and classic style await you aboard the *American Empress*. Join us for a paddlewheel cruise through America's Pacific Northwest. Indulge yourself with delicious, onboard dining choices, welcoming staff and country club ambiance, and then view the vessel's collection of North American regional artifacts from the Gold Rush and sternwheeler eras and more. Enjoy the

breathtaking natural beauty as you cruise one of the most famous rivers in the region. The *American Empress* welcomes you with the latest amenities that you want and the style and luxury you deserve.

American Queen Steamboat Company is strongly committed to preserving the marine environment and continually strives to do our part in keeping America's waterways cleaner.

DISTINCTIONS

- The largest, most elegant riverboat in the Pacific Northwest
- Included deluxe hotel stay before your voyage - including breakfast, taxes, portage and transfers to the *American Empress*
 - Complimentary wine and beer with dinner
 - Regionally inspired fine dining
 - Broadway-caliber entertainment and enrichment
 - Comprehensive, guided shore excursions
 - Authentic Paddlewheel Riverboat

American Empress Fine Dining



Fine Dining Aboard Your Columbia River Cruise

Treat your taste buds in the dining room of the *American Empress* on your next Columbia or Snake River cruise. Our creative culinary staff prepares each meal with local ingredients and the region's delicious offerings, including seasonal fruits and vegetables, sustainable fish and free-range chicken. Choose from a vast menu of offerings, so you can satisfy your cravings at every meal during your river cruise.

AN AFFAIR TO REMEMBER

Each morning, afternoon and evening you'll savor each bite of the delectable dishes fashioned by our creative culinary staff. Staying true to her Pacific Northwest surroundings, the culinary team takes full advantage of the region's diverse bounty of fresh ingredients including sustainable fish, free-range chicken and artisan cheeses along with seasonal fruits and vegetables. Menu choices are abundant allowing you to make it as light or as hearty as you wish. From made-to-order omelets and smoked salmon, to Dungeness crab, freshly cut steaks and indulgent desserts, the possibilities are endless.

In addition to the sumptuous array of selections thoughtfully prepared each day, guests have the opportunity to taste top local beers, wines and liquors of the region as the vessel cruises through the majestic scenery of the Columbia and Snake Rivers.



THE RIVER GRILL & BAR OFFERS INCLUDED ALTERNATE DINING



COMPLIMENTARY WINE AND BEER WITH DINNER



CUISINE

FRESH, LOCALLY SOURCED INGREDIENTS CREATE EXCEPTIONAL

American Empress Entertainment



Can't Miss Columbia and Snake River Cruise Entertainment

American Empress voyages include a variety of splendid entertainment that will keep your toes tapping and your imagination running wild.

Night after night, top entertainers take center stage and deliver high-caliber performances worthy of Broadway. Boasting a rich décor accentuated with sparkling crystal chandeliers, elevated ceiling and comfortable seating, the warm ambiance of The Show Lounge provides the perfect setting in which to enjoy rousing musical revues and high-energy cabaret from our exceptional cast.

The vessel's Paddlewheel Lounge is a popular, alternate venue featuring smooth solo performances and soft piano music in the afternoon. Take pleasure in this intimate atmosphere which is ideal for sharing pre-dinner cocktails. For your late-night entertainment, we'll pick up the pace and play all your favorites as you dance the night away.

As history plays such a large part of your cruise experience, our Riverlorian is onboard for each voyage to impart the history and lore of the Columbia and Snake Rivers. In addition to our ever-present Riverlorian, we often feature a diverse lineup of guest historians who take to the stage and transport you to another era. You'll enjoy hearing from these noted speakers who offer astounding insights on the culture and heritage of the Pacific Northwest. Delight in an all-encompassing narrative of the Lewis & Clark Expeditions for a spellbinding evening and you will retire to your room convinced that you've just had a conversation with history.

American Empress **AE** River Cruising



River Cruising Aboard the *American Empress*

The mighty rivers of the United States of America once served as the great highways of early exploration and inspired dreams of discovery. Today, the *American Empress* follows in the footsteps of Lewis and Clark, the intrepid explorers who have come to define the historical context of our Pacific Northwest voyages. The soaring mountains and dramatic landscapes remain majestic, unspoiled and unimaginably glorious with an abundant wildlife and fascinating frontier spirit. Each *American Empress* voyage offers unique perspectives on the region's history, culture and landscape that you can't get anywhere else: up-close, in-depth and unforgettable.

Remarkable shore excursions are provided in each port of call and include the cultural and historical landmarks that signify the living legacy of the region's first settlers. Guests with specific interests are encouraged to enjoy the variety of Premium Shore Excursions offered such as a journey to the volcanic crater of Mount St. Helens.

As history plays such a large part of your cruise experience, our Riverlorian is onboard for each voyage to impart the history and legends of the Columbia and Snake Rivers. In addition, our river cruises often feature a diverse lineup of guest historians who take to the stage and transport you to another era. You'll enjoy hearing from these noted speakers who offer astounding insights on the culture and heritage of the Pacific Northwest destinations you'll visit.

An unforgettable getaway awaits you aboard the *American Empress* through the nature of the Pacific Northwest. Get up-close and in-depth with a river cruise experience you won't ever forget.



Vancouver, WA (Portland) to Clarkston, WA (Spokane) 9-Day Journey

September 13, 2020 – September 21, 2020 ★ Fares from \$3,899

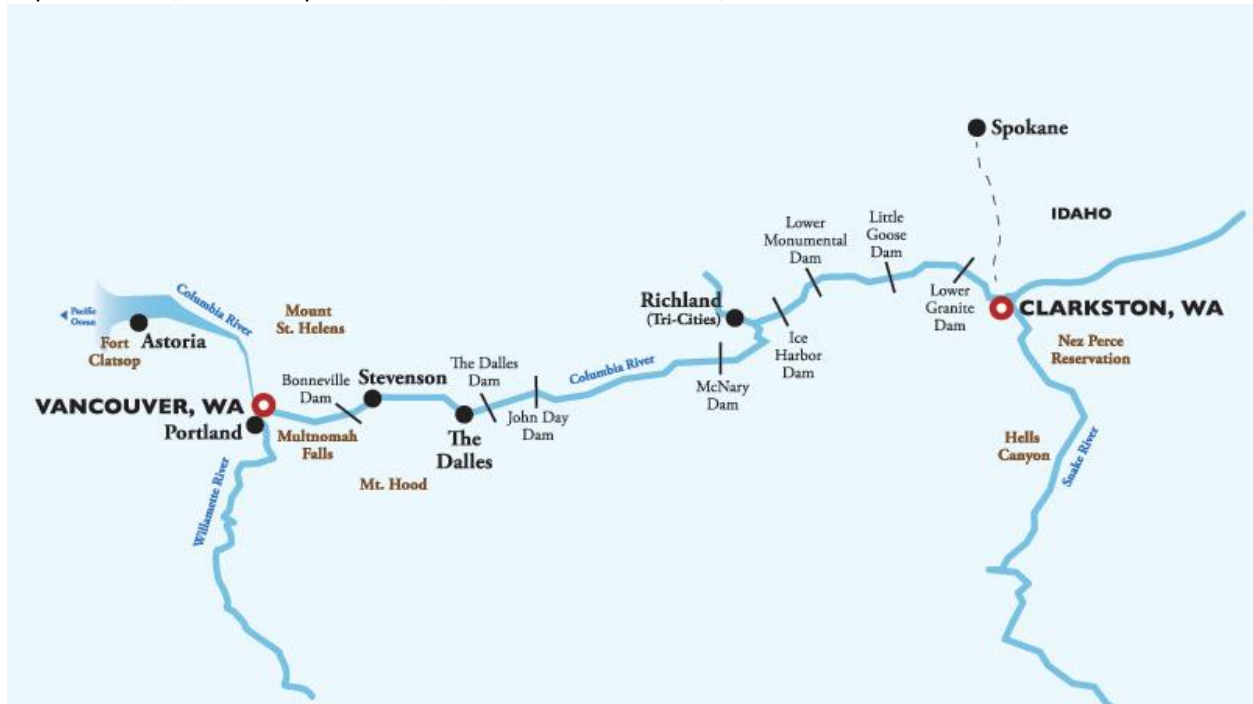

Cruise Summary

PACIFIC NORTHWEST SPLENDOR - "Ocean in view! O! The joy!" These are the original words, and spelling of "ocean," William Clark scrawled in his journal on November 7, 1805. One could hardly blame him for forgetting his spelling lessons in all the excitement. Experience the same sense of excitement and wonder as your journey begins in Vancouver near the Pacific Ocean, the objective of Lewis and Clark's expeditionary party, the Corps of Discovery. You will visit many historic, scenic and enjoyable sites along your Columbia and Snake River voyage to Clarkston. If you're looking for something tailored more to a specific interest, you might enjoy the Premium Shore Excursion to Multnomah Falls or a trip to the Western Antique Aeroplane & Automobile Museum.

Itinerary

Day 1: Hotel Stay - Vancouver, WA



Enjoy your complimentary stay at the Hilton Vancouver Hotel. The evening is yours to venture into the city and independently explore local attractions.

Our Hospitality Desk will be located in the hotel for your convenience between 3:00 p.m. and 7:00 p.m.. It is here that our friendly staff can assist with everything from general questions about your upcoming voyage to reserving Premium Shore Excursions. An American Queen Steamboat Company representative, as well as a local representative, will be readily available to provide you with dining, entertainment, and sight-seeing suggestions so that you may maximize your time in Vancouver.

Day 2: Vancouver, WA



Departure 6:00 PM

Today is the big day! Spend a few hours before your departure exploring the beautiful city of Vancouver.

If you didn't have a chance to check-in on the first night, the hospitality desk will be open today between 8:30 AM and 12:00 PM at the official Pre-Cruise hotel. During the easy check-in procedure, representatives will arrange your transfer to the vessel and answer questions regarding your upcoming voyage. The process is simple and will have you back to exploring or relaxing in no time. If you think of additional questions, the hospitality staff will be at your service until the transfers begin to take you to the *American Empress*.

Day 3: Astoria, OR



Astoria is known to be the oldest American Settlement west of the Rocky Mountains. For thousands of years, Clatsop Indians inhabited the lands that are now known as Astoria. In 1805, Lewis and Clark led their expedition through the town and spent the winter at Fort Clatsop. In 1813, a British warship sailed into the Columbia River, gaining possession of the city and holding control until 1818, when they finally agreed to a joint occupation of the land. The British did not fully leave Astoria until 1846. There is no doubting the rich history has deep roots grounded in this Columbia River town. When the history combines with the scenery, the harmony will surely bring you back for more!

Day 4: The Dalles, OR



At the end of the overland Oregon Trail, The Dalles holds a unique place in history as a jumping-off spot for pioneers, soldiers, gold miners, adventurers, gun-slingers, floozies, and scallywags. Lewis and Clark camped at this location at Rock Fort Camp during their historic journey in 1805 and 1806. Fort Dalles was established in 1850. Oregon Trail pioneers ended their overland journey at The Dalles, forced to build rafts and take the “river road” west to Fort Vancouver, then into the Willamette River valley. Ten thousand years of Native American trading took place on the banks of the Columbia River, shaped by the Ice Age Missoula floods. The town was located at the foot of a series of dangerous rapids which the Hudson’s Bay Company fur traders called “The Dalles of the Columbia.”

Day 5: Stevenson, WA



On the banks of the scenic Columbia River, the city of Stevenson is your launch pad to the Washington side of the Gorge. A stroll along the Rock Cove pathway or the Columbia River waterfront is a great way to take in surroundings. Downtown Stevenson is home to unique shops, art galleries, and restaurants. Stevenson is in the heart of the Columbia River Gorge National Scenic Area. Explore the eastern entrance to Mount St. Helens or the spectacular Lewis River Valley.

Day 6: Scenic River Cruising or Optional Premium Experience



Spend a leisurely day cruising through the scenic Columbia River Gorge. You may wish to relax on your veranda and take in the spectacular scenery, attend a discussion with our Riverlorian or enjoy a variety of onboard activities. If you prefer a day ashore, you can also choose a premium experience that will take you to Pendleton, Oregon while the vessel is underway. There you have the opportunity to explore the wild West town, enjoy a delicious lunch, browse downtown shops and tour the Pendleton Woolen Mill and factory outlet store.

Day 7: Richland, WA (Tri-Cities)



Richland is located near the confluence of the Yakima and Columbia Rivers, the northern most point reached by the Lewis and Clark Expedition in 1805. First incorporated in 1910, Richland remained a small agricultural community until the Army acquired it and 670 square miles of adjacent land in 1943 as the site of the Hanford Engineer Works which was used to produce plutonium during World War II and the Cold War. Today, the historic B Reactor and other important historical venues are part of the new Manhattan Project National Historic Park. The city is also home to the Pacific Northwest National Laboratory and a branch campus of Washington State University.

Day 8: Clarkston, WA



Nestled at the union of the Snake and Clearwater Rivers in southeast Washington, Clarkston is the gateway to North America's deepest gorge, Hells Canyon on the Snake River. The picturesque vistas, year-round mild climates, and a deep history make this scenic inland port a more-than-desirable stop! Spend the day following the footsteps of the historic Lewis and Clark journey – where the city received its name. This incredible city is filled with artifacts and stories that depict the journeys of famous explorers. Clarkston has the ideal climate for visitors to enjoy countless activities including fishing, scenic walks along the trails, shopping, and exploring!

Day 9: Clarkston, WA (Spokane)



Thank you for cruising with us! We hope that you had a memorable experience and look forward to welcoming you aboard in the future. Enjoy Clarkston at your leisure or consider a Post-Cruise Premium Shore Excursion with airport transfer.

Highlights

Your Cruise Fare Includes:

- Complimentary Hop-On Hop-Off shore excursions in each port of call
- Complimentary deluxe hotel stay the night before your voyage – includes breakfast, taxes, portage and transfers to the *American Empress*
- All onboard meals, including both fine dining and casual cuisine
- 24-Hour Room Service
- Complimentary wine and beer with dinner
- Complimentary cappuccino, espresso, specialty coffees, tea, bottled water and soft drinks throughout your voyage
- Gracious service from a friendly, all-American staff
- Daily lectures by the Riverlorian, our onboard historian
- Professional showboat-style entertainment and dancing nightly
- Our own dedicated fleet of deluxe motorcoaches

Available for Purchase: Additional Pre-voyage Hotel Night

Available for Purchase: Optional Post-voyage Hotel Night

Terms and Conditions

One included pre-voyage hotel night is provided as part of the voyage fare. Additional pre-voyage hotel nights may be purchased for an additional charge. Guests are required to present a credit card upon hotel check-in to cover their incidental charges. Post-voyage hotel nights are not included in the voyage fare and may be purchased for an additional charge. A maximum of three pre-voyage and three post-voyage hotel nights are allowed for any booking. In lieu of an included pre-voyage hotel night on any voyage, a \$50 per person onboard credit is available upon request and dependent upon voyage date. On a back-to-back voyage, two included hotel nights or a combination of one included hotel night plus a \$50 per person onboard credit will be granted in lieu of taking a second included hotel night. A hotel credit will not be offered if a hotel is unable to accommodate additional hotel nights. Additional room night availability is based on the AQSC standard annual rate and is not guaranteed. The AQSC pre-voyage hotel may offer a direct promotional rate throughout the year that is lower than the AQSC standard annual rate.

Fares are per person, double occupancy, with the exception of single cabin categories. Fares quoted are in U.S. dollars and do not include air or land transportation. Port Charges of \$199 per person are additional and not included in the fare. All fares, itineraries, hotels, entertainment, shore excursions and other voyage attributes are subject to change and we are not responsible for errors or omissions therein.

American Empress Accommodations

Veranda Staterooms (AE - E)

Enjoy a great value with this efficient yet spacious staterooms. Your semi-private veranda provides a quiet place to watch the ever-changing scenery.

Note: Single beds cannot be converted to a queen/king bed in select staterooms. Please ask your reservations agent for details.



Category AE – E are Purple rooms on the deck Plan. Vista Deck rooms 401,402,404, 411-420

- 150 sq. ft.
- Queen bed or two single beds
- Full bathroom with shower
- Semi-private veranda
- Interior access
- Vista View Deck

Outside Staterooms with Window (AE - D)

These large staterooms provide a cozy atmosphere and spectacular river views through a generously sized window.. *Note: Single beds cannot be converted to a queen/king bed in select staterooms. Please ask your reservations agent for details.*



Category AE – D are Dark Green rooms on the Explorer Deck

- 180 sq. ft.
- Queen bed or two single beds
- Full bathroom with shower
- Interior access
- Explorer Deck

Deluxe Veranda Staterooms (AE - C)

Deluxe Veranda Staterooms are a popular choice for many couples. Share a toast on your private veranda as you glide through the fresh air of Pacific Northwest.

Note: Single beds cannot be converted to a queen/king bed in select staterooms. Please ask your reservations agent for details.



Category AE – C are Light Green rooms on the Frontier and Discovery Decks

- 180 sq. ft.
- Queen bed or two single beds
- Full bathroom with shower
- Private veranda
- Interior access

Discovery and Frontier Decks

Superior Veranda Staterooms (AE - B)

Enjoy your spacious stateroom, with a cozy sitting area or a panoramic view through the large forward-facing windows. Your private veranda provides a quiet place to watch the ever-changing scenery. *Note: Single beds cannot be converted to a queen/king bed in select staterooms. Please ask your reservations agent for details.*



Category AE – B are Orange rooms 202, 302, 343-348 and 403

- 210-250 sq. ft.
- Queen bed or two single beds
- Full bathroom with shower
- Sitting area
- Private veranda
- Interior access
- Vista View, Discovery and Frontier Decks

Suites with Veranda (AE - A)

Enjoy this large suite with a comfortable sitting area and premium sound system. Your semi-private veranda provides splendid river views from four stories above the river, and direct access to the wraparound Vista View Deck, perfect for sharing a view and socializing with fellow guests.

Note: Single beds cannot be converted to a queen/king bed for select staterooms. Please ask your reservations agent for details.



Category AE – A are Blue rooms on the Vista Deck rooms 405-410

- 310 sq. ft.
- Queen bed or two single beds
- Full bathroom with shower
- Sitting area with sofa
- Semi-private veranda
- Interior and exterior access
- Vista View Deck

Luxury Suites with Veranda (AE - LS)

Feel as if you own the *American Empress* in this expansive suite. You are treated to sweeping river views through large windows facing forward and starboard. Step out onto your private veranda and scan the riverbanks for wildlife. Converse in your spacious sitting room complete with a large flat-screen TV, premium sound, cocktail table and wet bar. As a guest of our Luxury Suite, you will be treated to exclusive suite-level *Commodore Services* and amenities, as well as River Butler service.

Commodore Services®

Guests holding reservations for Luxury Suite (LS) accommodations will receive our exclusive *Commodore Services*, which includes a bottle of wine from the region and a fruit basket upon arrival, preferred dining arrangements in The Astoria Dining Room, reserved seating in The Show Lounge, and an invitation to dine with Senior Officers of the *American Empress*.

Guests of these elite-level suites will also receive the services of a friendly River Butler. These services include a warm welcome with a tour of your suite, unpacking and hanging of clothes, preparation and packing of your luggage, laundry and pressing services, shoe shine and conditioning, afternoon tea served in your suite, breakfast and dinner served on your private veranda upon request, in-suite pre-dinner canapés and post-dinner sweets, and a personal escort to your reserved seating in The Show Lounge.



Category AE – LS are Light yellow rooms 201 and 301

- 410 sq. ft.
- Queen bed or two single beds
- Full bathroom with shower

- Sitting area with sofa
- Private veranda
- Interior access
- Discovery and Frontier Decks
- *Commodore Services*, including a River Butler

Single Outside Staterooms with Veranda (AE - CS)

The single outside stateroom is slightly scaled down for the single traveler but allows you to take full advantage of the splendid features of our Deluxe Veranda Staterooms.



Category AE – CS There is just one of these room 221 on the Frontier Deck

- 160 sq. ft.
- Single bed
- Full bathroom with shower
- Private veranda
- Interior access
- Frontier Deck

Deck Plans

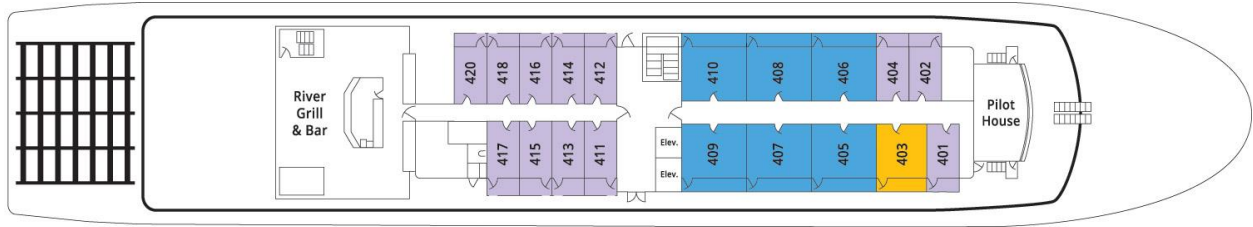

DECK 4 - VISTA VIEW DECK

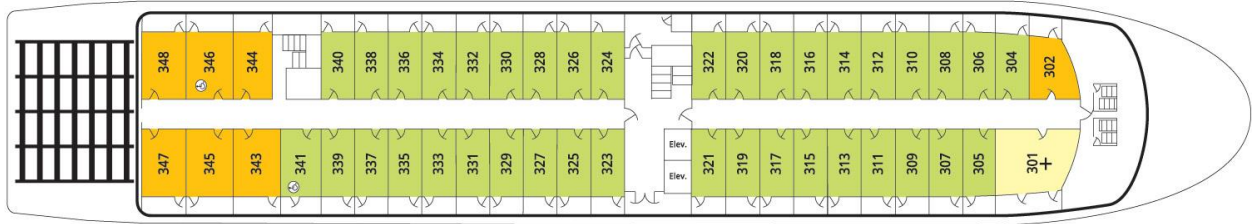

DECK 3 - DISCOVERY DECK

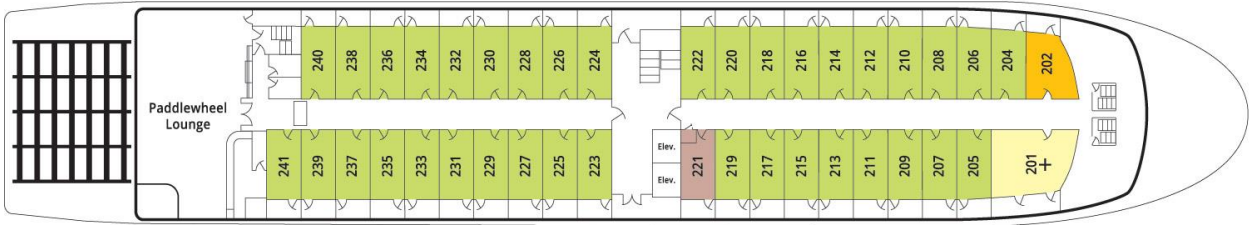

DECK 2 - FRONTIER DECK

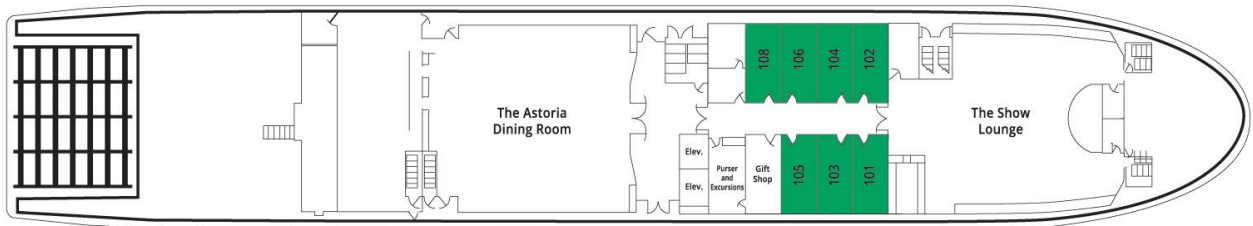

DECK 1 - EXPLORER DECK