



DIN 84

**Tornillo cabeza cilíndrica con ranura DIN 84**

Código	Medida D x L (mm)	unds caja
D850305	M-3x 5	2.000
D850306	M-3x 6	2.000
D850308	M-3x 8	2.000
D850310	M-3x 10	2.000
D850312	M-3x 12	2.000
D850316	M-3x 16	2.000
D850320	M-3x 20	2.000
D850325	M-3x 25	2.000
D850330	M-3x 30	2.000
D850406	M-4x 6	1.000
D850408	M-4x 8	1.000
D850410	M-4x 10	1.000
D850412	M-4x 12	1.000
D850416	M-4x 16	1.000
D850420	M-4x 20	1.000
D850425	M-4x 25	1.000
D850430	M-4x 30	1.000
D850435	M-4x 35	1.000
D850440	M-4x 40	1.000
D850445	M-4x 45	1.000
D850305	M-5x 8	2.000
D850306	M-5x 10	2.000
D850308	M-5x 12	2.000
D850310	M-5x 16	2.000
D850312	M-5x 20	2.000
D850316	M-5x 25	2.000
D850320	M-5x 30	2.000
D850325	M-5x 35	2.000
D850330	M-5x 40	2.000
D850406	M-5x 45	1.000
D850408	M-5x 50	1.000
D850410	M-5x 55	1.000
D850412	M-5x 60	1.000
D850416	M-5x 70	1.000
D850608	M-6x 8	2.000
D850610	M-6x 10	2.000
D850612	M-6x 12	2.000
D850616	M-6x 16	2.000
D850620	M-6x 20	1.000
D850625	M-6x 25	1.000
D850630	M-6x 30	1.000
D850635	M-6x 35	1.000
D850640	M-6x 40	1.000
D850645	M-6x 45	1.000
D850650	M-6x 50	1.000
D850655	M-6x 55	1.000
D850660	M-6x 60	1.000
D850670	M-6x 70	1.000

Código	Medida D x L (mm)	unds caja
DI850810	M-8x 10	2.000
DI850812	M-8x 12	2.000
DI850320	M-8x 20	2.000
DI850825	M-8x 25	2.000
DI850830	M-8x 30	2.000
DI850835	M-8x 35	2.000
DI850840	M-8x 40	1.000
DI850845	M-8x 45	1.000
DI850850	M-8x 50	1.000
DI850855	M-8x 55	1.000
DI850860	M-8x 60	1.000
DI850102	M-10x 20	1.000
DI850103	M-10x 25	1.000
DI850104	M-10x 30	1.000
DI850105	M-10x 35	1.000
DI850106	M-10x 40	1.000
DI850107	M-10x 45	1.000
DI850108	M-10x 55	1.000
DI850109	M-10x 60	1.000

d (mm)	K (mm)	t (mm)	c (mm)
M-3	1,8	0,8	0,8
M-4	2,4	1	1,2
M-5	3	1,2	1,4
M-6	3,6	1,4	1,6
M-8	4,8	2	2,5
M-10	6	2,5	3

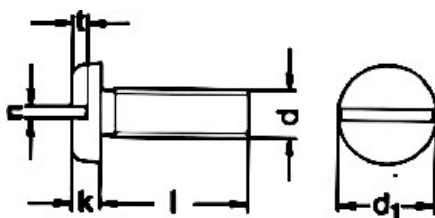

**k:** Altura de cabeza  
**s:** Ancho de llave  
**d:** Métrica  
**L:** Longitud  
**t:** Profundidad

Tornillo con cabeza cilíndrica ranurada, rosca métrica.

Puede ser suministrado lacado en cualquier color de la carta RAL.



**GARANTÍA FESIT**



## DIN 963

Tornillo con cabeza cilíndrica ranurada, rosca métrica.



### GARANTÍA FESIT



Código Medida D x L (mm)  unds caja

D950305	M-3x 5	2.000
D950306	M-3x 6	2.000
D950308	M-3x 8	2.000
D950310	M-3x 10	2.000
D950312	M-3x 12	2.000
D950316	M-3x 16	2.000
D950320	M-3x 20	2.000
D950325	M-3x 25	2.000
D950330	M-3x 30	2.000
D950406	M-4x 6	1.000
D950408	M-4x 8	1.000
D950410	M-4x 10	1.000
D950412	M-4x 12	1.000
D950416	M-4x 16	1.000
D950420	M-4x 20	1.000
D950425	M-4x 25	1.000
D950430	M-4x 30	1.000
D950435	M-4x 35	1.000
D950440	M-4x 40	1.000
D950445	M-4x 45	1.000
D950305	M-5x 8	2.000
D950306	M-5x 10	2.000
D950308	M-5x 12	2.000
D950310	M-5x 16	2.000
D950312	M-5x 20	2.000
D950316	M-5x 25	2.000
D950320	M-5x 30	2.000
D950325	M-5x 35	2.000
D950330	M-5x 40	2.000
D950406	M-5x 45	1.000
D950408	M-5x 50	1.000
D950410	M-5x 55	1.000
D950412	M-5x 60	1.000
D950416	M-5x 70	1.000
D950608	M-6x 8	2.000
D950610	M-6x 10	2.000
D950612	M-6x 12	2.000
D950616	M-6x 16	2.000
D950620	M-6x 20	1.000
D950625	M-6x 25	1.000
D950630	M-6x 30	1.000
D950635	M-6x 35	1.000
D950640	M-6x 40	1.000
D950645	M-6x 45	1.000
D950650	M-6x 50	1.000
D950655	M-6x 55	1.000
D950660	M-6x 60	1.000
D950670	M-6x 70	1.000

## Tornillo cabeza con ranura DIN 963

Código Medida D x L (mm)  unds caja

D950810	M-8x 10	2.000
D950812	M-8x 12	2.000
D950320	M-8x 20	2.000
D950825	M-8x 25	2.000
D950830	M-8x 30	2.000
D950835	M-8x 35	2.000
D950840	M-8x 40	1.000
D950845	M-8x 45	1.000
D950850	M-8x 50	1.000
D950855	M-8x 55	1.000
D950860	M-8x 60	1.000
D950102	M-10x 20	1.000
D950103	M-10x 25	1.000
D950104	M-10x 30	1.000
D950105	M-10x 35	1.000
D950106	M-10x 40	1.000
D950107	M-10x 45	1.000
D950108	M-10x 55	1.000
D950109	M-10x 60	1.000

d (mm)	K (mm)	dk (mm)	c (mm)
M-3	1,8	5,6	0,8
M-4	2,4	7,5	1,2
M-5	3	9,2	1,4
M-6	3,6	11	1,6
M-8	4,8	14,5	2,5
M-10	6	18	3



**k:** Altura de cabeza  
**s:** Ancho de llave  
**d:** Métrica  
**L:** Longitud  
**dk:** Profundidad



### Tornillo cabeza con ranura DIN 965

Código	Medida D x L (mm)	unds caja
D9650305	M-3x 5	2.000
D9650306	M-3x 6	2.000
D9650308	M-3x 8	2.000
D9650310	M-3x 10	2.000
D9650312	M-3x 12	2.000
D9650316	M-3x 16	2.000
D9650320	M-3x 20	2.000
D9650325	M-3x 25	2.000
D9650330	M-3x 30	2.000
D9650406	M-4x 6	1.000
D9650408	M-4x 8	1.000
D9650410	M-4x 10	1.000
D9650412	M-4x 12	1.000
D9650416	M-4x 16	1.000
D9650420	M-4x 20	1.000
D9650425	M-4x 25	1.000
D9650430	M-4x 30	1.000
D9650435	M-4x 35	1.000
D9650440	M-4x 40	1.000
D9650445	M-4x 45	1.000
D9650305	M-5x 8	2.000
D9650306	M-5x 10	2.000
D9650308	M-5x 12	2.000
D9650310	M-5x 16	2.000
D9650312	M-5x 20	2.000
D9650316	M-5x 25	2.000
D9650320	M-5x 30	2.000
D9650325	M-5x 35	2.000
D9650330	M-5x 40	2.000
D9650406	M-5x 45	1.000
D9650408	M-5x 50	1.000
D9650410	M-5x 55	1.000
D9650412	M-5x 60	1.000
D9650416	M-5x 70	1.000
D9650608	M-6x 8	2.000
D9650610	M-6x 10	2.000
D9650612	M-6x 12	2.000
D9650616	M-6x 16	2.000
D9650620	M-6x 20	1.000
D9650625	M-6x 25	1.000
D9650630	M-6x 30	1.000
D9650635	M-6x 35	1.000
D9650640	M-6x 40	1.000
D9650645	M-6x 45	1.000
D9650650	M-6x 50	1.000
D9650655	M-6x 55	1.000
D9650660	M-6x 60	1.000
D9650670	M-6x 70	1.000

Código	Medida D x L (mm)	unds caja
D9650810	M-8x 10	2.000
D9650812	M-8x 12	2.000
D9650320	M-8x 20	2.000
D9650825	M-8x 25	2.000
D9650830	M-8x 30	2.000
D9650835	M-8x 35	2.000
D9650840	M-8x 40	1.000
D9650845	M-8x 45	1.000
D9650850	M-8x 50	1.000
D9650855	M-8x 55	1.000
D9650860	M-8x 60	1.000
D9650102	M-10x 20	1.000
D9650103	M-10x 25	1.000
D9650104	M-10x 30	1.000
D9650105	M-10x 35	1.000
D9650106	M-10x 40	1.000
D9650107	M-10x 45	1.000
D9650108	M-10x 55	1.000
D9650109	M-10x 60	1.000

d (mm)	K (mm)	dk (mm)	c (mm)
M-3	1,8	5,6	0,8
M-4	2,4	7,5	1,2
M-5	3	9,2	1,4
M-6	3,6	11	1,6
M-8	4,8	14,5	2,5
M-10	6	18	3

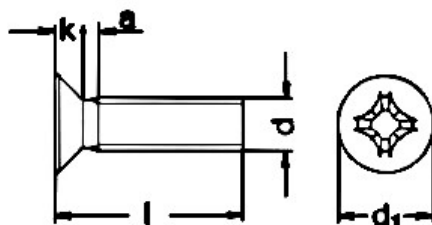

**k:** Altura de cabeza  
**s:** Ancho de llave  
**d:** Métrica  
**L:** Longitud  
**dk:** Profundidad

DIN 965

Tornillo con cabeza cilíndrica ranurada, rosca métrica.



GARANTÍA FESIT





Tornillo cab. avellanada



Countersunk head screw



Parafuso DIN 7991



Viti testa cilindrica



Vis Tête bombée



Sicherheitsschr

## DIN 7985

Tornillo con cabeza cilíndrica ranurada, rosca métrica.



## Tornillo cabeza cilíndrica con ranura DIN 963

Código	Medida D x L (mm)	unds caja
D79850305	M-3x 5	2.000
D79850306	M-3x 6	2.000
D79850308	M-3x 8	2.000
D79850310	M-3x 10	2.000
D79850312	M-3x 12	2.000
D79850316	M-3x 16	2.000
D79850320	M-3x 20	2.000
D79850325	M-3x 25	2.000
D79850330	M-3x 30	2.000
D79850406	M-4x 6	1.000
D79850408	M-4x 8	1.000
D79850410	M-4x 10	1.000
D79850412	M-4x 12	1.000
D79850416	M-4x 16	1.000
D79850420	M-4x 20	1.000
D79850425	M-4x 25	1.000
D79850430	M-4x 30	1.000
D79850435	M-4x 35	1.000
D79850440	M-4x 40	1.000
D79850445	M-4x 45	1.000
D79850305	M-5x 8	2.000
D79850306	M-5x 10	2.000
D79850308	M-5x 12	2.000
D79850310	M-5x 16	2.000
D79850312	M-5x 20	2.000
D79850316	M-5x 25	2.000
D79850320	M-5x 30	2.000
D79850325	M-5x 35	2.000
D79850330	M-5x 40	2.000
D79850406	M-5x 45	1.000
D79850408	M-5x 50	1.000
D79850410	M-5x 55	1.000
D79850412	M-5x 60	1.000
D79850416	M-5x 70	1.000
D79850608	M-6x 8	2.000
D79850610	M-6x 10	2.000
D79850612	M-6x 12	2.000
D79850616	M-6x 16	2.000
D79850620	M-6x 20	1.000
D79850625	M-6x 25	1.000
D79850630	M-6x 30	1.000
D79850635	M-6x 35	1.000
D79850640	M-6x 40	1.000
D79850645	M-6x 45	1.000
D79850650	M-6x 50	1.000
D79850655	M-6x 55	1.000
D79850660	M-6x 60	1.000
D79850670	M-6x 70	1.000

Código	Medida D x L (mm)	unds caja
D79850810	M-8x 10	2.000
D79850812	M-8x 12	2.000
D79850320	M-8x 20	2.000
D79850825	M-8x 25	2.000
D79850830	M-8x 30	2.000
D79850835	M-8x 35	2.000
D79850840	M-8x 40	1.000
D79850845	M-8x 45	1.000
D79850850	M-8x 50	1.000
D79850855	M-8x 55	1.000
D79850860	M-8x 60	1.000

d (mm)	K (mm)	dk (mm)
M-3	2,4	5,6
M-4	3,1	8
M-5	3,8	9,5
M-6	4,6	12
M-8	6	16



**k:** Altura de cabeza  
**s:** Ancho de llave  
**d:** Métrica  
**L:** Longitud  
**dk:** Profundidad

## GARANTÍA FESIT





### Tornillo cabeza alomada DIN 603

## DIN 603

Cabeza alomada

Tornillo de cabeza alomada.

Acabado: Zincado

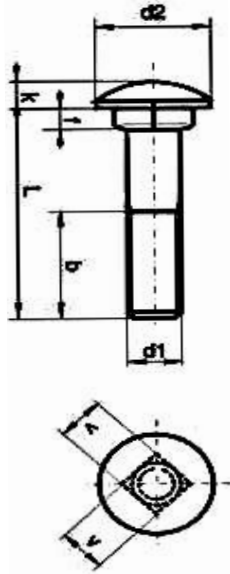

**p:** Paso de rosca  
**k:** Altura de cabeza  
**s:** Ancho de llave  
**d:** Metrica  
**L:** Longitud  
**f:** Cuello  
**d2:** Cabeza  
 b1: L ≤ 125 mm  
 b2: 125 mm < L ≤ 200 mm

L (mm)	M-5 Ø	M-6 Ø	M-8 Ø	M-10 Ø	M-12 Ø	M-16 Ø
16	X	X	X			
20	X	X	X	X		
25	X	X	X	X	X	
30	X	X	X	X	X	
35	X	X	X	X	X	
40	X	X	X	X	X	X
40	X	X	X	X	X	X
45	X	X	X	X	X	X
50	X	X	X	X	X	X
55	X	X	X	X	X	X
60	X	X	X	X	X	X
65	X	X	X	X	X	X
70	X	X	X	X	X	X
75	X	X	X	X	X	X
80	X	X	X	X	X	X
90		X	X	X	X	X
100		X	X	X	X	X
110		X	X	X	X	X
120		X	X	X	X	X
130		X	X	X	X	X
140		X	X	X	X	X
150		X	X	X	X	X
160			X	X	X	X
180			X	X	X	X
190			X	X	X	X
200			X	X	X	X
210			X	X	X	X
220			X	X	X	X
230			X	X	X	X
240			X	X	X	X
250			X	X	X	X
260			X	X	X	X

d (mm)	K (mm)	b1 (mm)	b2 (mm)	f (mm)	d2 (mm)	p (mm)
M-5	5,4	16	22	4	13	0,8
M-6	6,6	18	24	4	16	1
M-8	8,1	22	28	5	20	1,25
M-10	9,2	26	32	6	24	1,50
M-12	11,5	30	36	8	30	1,75
M-16	14,4	38	44	12	38	1,75



GARANTÍA FESIT



# DIN 934

Tuerca zincada métrica DIN 934 rosca

Clase 8.





**DIN 934  
clase 8 pavonada**



**DIN 934  
clase 8 zincada**



**DIN 934 Clase 8  
Galv. en caliente.**

Código	Medida D x L (mm)	Código	Medida D x L (mm)	Código	Medida D x L (mm)
Pavonado		Zincado		Galvanizado en caliente.	
DP9348M03	M-3	D9348M03	M-3		
DP9348M04	M-4	D9348M04	M-4		
DP9348M05	M-5	D9348M05	M-5		
DP9348M06	M-6	D9348M06	M-6	D9348M06	M-6
DP9348M08	M-8	D9348M08	M-8	D9348M08	M-8
DP9348M10	M-10	D9348M10	M-10	D9348M10	M-10
DP9348M12	M-12	D9348M12	M-12	D9348M12	M-12
DP9348M14	M-14	D9348M14	M-14	D9348M14	M-14
DP9348M16	M-16	D9348M16	M-16	D9348M16	M-16
DP9348M18	M-18	D9348M18	M-18	D9348M18	M-18
DP9348M20	M-20	D9348M20	M-20	D9348M20	M-20
DP9348M22	M-22	D9348M22	M-22	D9348M22	M-22
DP9348M24	M-24	D9348M24	M-24	D9348M24	M-24
DP9348M27	M-27	D9348M27	M-27	D9348M27	M-27
DP9348M30	M-30	D9348M30	M-30	D9348M30	M-30
DP9348M33	M-33	D9348M33	M-33	D9348M33	M-33
DP9348M36	M-36	D9348M36	M-36	D9348M36	M-36
DP9348M39	M-39	D9348M39	M-39	D9348M39	M-39
DP9348M42	M-42	D9348M42	M-42	D9348M42	M-42
DP9348M45	M-45	D9348M45	M-45	D9348M45	M-45
DP9348M48	M-48	D9348M48	M-48	D9348M48	M-48
DP9348M52	M-52	D9348M52	M-52	D9348M52	M-52
DP9348M56	M-56	D9348M56	M-56	D9348M56	M-56
DP9348M60	M-60	D9348M60	M-60	D9348M60	M-60

## GARANTÍA FESIT



Normas

DIN 934

ISO 4032/4034

Material : clase 8

Recubrimiento: Zincado galvánica



d (mm)	s (mm)	m (mm)	b3 (mm)	s (mm)	m (mm)
M-3	5,5	2,4	M-24	36	19
M-4	7	3,2	M-27	41	22
M-5	8	4	M-30	46	24
M-6	10	5	M-33	50	26
M-8	13	6,5	M-36	55	29
M-10	17	8	M-39	60	31
M-12	19	10	M-42	65	34
M-14	22	11	M-45	70	36
M-16	24	13	M-48	75	38
M-18	27	15	M-52	80	42
M-20	30	16	M-56	85	44
M-22	32	18	M-60	90	46



 Tuerca hexagonal

 Hexagonal nut

 Porca hexagonal

 Dadi esagonali

 Écrou hexagonal

 Sechskantmutter







**DIN 934 Clase 10  
Zincada**



**DIN 934 Inox A-2  
AISI 304**



**DIN 934 Clase 10  
DACROMET®**

Código	Medida D x L (mm)	Código	Medida D x L (mm)	Código	Medida D x L (mm)
Zincado				<b>DACROMET®</b>	
		DI9348M03	M-3		
		DI9348M04	M-4		
		DI9348M05	M-5		
DP93410M06	M-6	DI9348M06	M-6	D934D8M06	M-6
DP93410M08	M-8	DI9348M08	M-8	D934D8M08	M-8
DP93410M10	M-10	DI9348M10	M-10	D934D8M10	M-10
DP93410M12	M-12	DI9348M12	M-12	D934D8M12	M-12
DP93410M14	M-14	DI9348M14	M-14	D934D8M14	M-14
DP93410M16	M-16	DI9348M16	M-16	D934D8M16	M-16
DP93410M18	M-18	DI9348M18	M-18	D934D8M18	M-18
DP93410M20	M-20	DI9348M20	M-20	D934D8M20	M-20
DP93410M22	M-22	DI9348M22	M-22	D934D8M22	M-22
DP93410M24	M-24	DI9348M24	M-24	D934D8M24	M-24
DP93410M27	M-27	DI9348M27	M-27	D934D8M27	M-27
DP93410M30	M-30	DI9348M30	M-30	D934D8M30	M-30
DP93410M33	M-33	DI9348M33	M-33	D934D8M33	M-33
DP93410M36	M-36	DI9348M36	M-36	D934D8M36	M-36
DP93410M39	M-39	DI9348M39	M-39	D934D8M39	M-39
DP93410M42	M-42	DI9348M42	M-42	D934D8M42	M-42
DP93410M45	M-45	DI9348M45	M-45	D934D8M45	M-45
DP93410M48	M-48	DI9348M48	M-48	D934D8M48	M-48
DP93410M52	M-52	DI9348M52	M-52	D934D8M52	M-52
DP93410M56	M-56	DI9348M56	M-56	D934D8M56	M-56
DP93410M60	M-60	DI9348M60	M-60	D934D8M60	M-60



d (mm)	s (mm)	m (mm)	b3 (mm)	s (mm)	m (mm)
M-3	5,5	2,4	M-24	36	19
M-4	7	3,2	M-27	41	22
M-5	8	4	M-30	46	24
M-6	10	5	M-33	50	26
M-8	13	6,5	M-36	55	29
M-10	17	8	M-39	60	31
M-12	19	10	M-42	65	34
M-14	22	11	M-45	70	36
M-16	24	13	M-48	75	38
M-18	27	15	M-52	80	42
M-20	30	16	M-56	85	44
M-22	32	18	M-60	90	46

## DIN 934

Tuerca zincada rosca métrica DIN 934

Clase 10.

### GARANTÍA FESIT



Normas

DIN 934

ISO 4032/4034

Material : clase 10

Recubrimiento:Zincado galvánica





**FESIT**  
HERRAMIENTAS ESPECIALES

# DIN 985

Tuerca zincada rosca métrica autoblocante DIN 985



## Tuerca métrica clase 8 DIN 985

Código	Medida D x L (mm)	Código	Medida D x L (mm)	Código	Medida D x L (mm)
Zincado		INOXIDABLE A-2 AISI304		INOXIDABLE A-4 AISI316	
D985M03	M-3	DI985M03	M-3	DI9854M03	
D985M04	M-4	DI985M04	M-4	DI9854M04	M-4
D985M05	M-5	DI985M05	M-5	DI9854M05	M-5
D985M06	M-6	DI985M06	M-6	DI9854M06	M-6
D985M08	M-8	DI985M08	M-8	DI9854M08	M-8
D985M10	M-10	DI985M10	M-10	DI9854M10	M-10
D985M12	M-12	DI985M12	M-12	DI9854M12	M-12
D985M14	M-14	DI985M14	M-14	DI9854M14	M-14
D985M16	M-16	DI985M16	M-16	DI9854M16	M-16
D985M18	M-18	DI985M18	M-18	DI9854M18	M-18
D985M20	M-20	DI985M20	M-20	DI9854M20	M-20
D985M22	M-22	DI985M22	M-22	DI9854M22	M-22
D985M24	M-24	DI985M24	M-24		
D985M27	M-27	DI985M27	M-27		
D985M30	M-30				
D985M33	M-33				
D985M36	M-36				
D985M39	M-39				
D985M42	M-42				
D985M45	M-45				

### GARANTÍA FESIT



Normas

DIN 985

ISO 10511

Material : clase 8, AISI304

AISI316

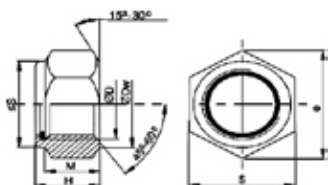

d (mm)	s (mm)	H (mm)	b3 (mm)	s (mm)	H (mm)
M-3	5,5	4	M-24	36	24
M-4	7	5	M-27	41	27
M-5	8	5	M-30	46	30
M-6	10	6	M-33	50	33
M-8	13	8	M-36	55	36
M-10	17	10	M-39	60	39
M-12	19	12	M-42	65	42
M-14	22	14	M-45	70	45
M-16	24	16			
M-18	27	18,5			
M-20	30	20			
M-22	32	22			





 Tuerca hexagonal

 Hexagonal nut

 Porca hexagonal

 Dadi esagonali

 Écrou hexagonal

 Sechskantmutter





Tuerca estriada DIN 6923



Tuerca baja DIN 936



Tuerca ciega DIN 1587

Código	Medida D x L (mm)	Código	Medida D x L (mm)	Código	Medida D x L (mm)
DIN 6923		DIN 936		DIN 1587	
D6923M03	M-3				
D6923M04	M-4	D936M04	M-4	D1587M04	
D6923M05	M-5	D936M05	M-5	D1587M04	
D6923M06	M-6	D936M06	M-6	D1587M06	M-6
D6923M08	M-8	D936M08	M-8	D1587M08	M-8
D6923M10	M-10	D936M10	M-10	D1587M10	M-10
D6923M12	M-12	D936M12	M-12	D1587M12	M-12
D6923M14	M-14	D936M14	M-14	D1587M14	M-14
D6923M16	M-16	D936M16	M-16	D1587M16	M-16
		D936M18	M-18	D1587M18	M-18
		D936M20	M-20	D1587M20	M-20
		D936M22	M-22	D1587M22	M-22
		D936M24	M-24	D1587M24	M-24
		D936M27	M-27		
		D936M30	M-30		

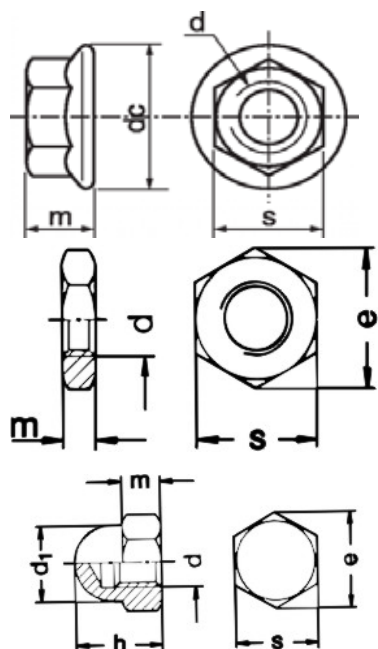

d (mm)	s (mm)	Paso (mm)
M-3	5,5	0,6
M-4	7	0,7
M-5	8	0,8
M-6	10	1
M-8	13	1,25
M-10	17	1,5
M-12	19	1,75
M-14	22	2
M-16	24	2
M-18	27	2,5
M-20	30	2,5
M-22	32	2,5
M-24	36	3
M-27	41	3
M-30	46	3,5

DIN 936 DIN1587  
DIN6923

Tuerca zincada rosca métrica DIN 936-DIN6923-DIN1587

www.fesit.es

GARANTÍA FESIT



Normas

DIN 936 DIN 6923 DIN1587



**Fesit**  
HERRAJES ESPECIALES

# DIN 125-9021-127

Arandelas planas.

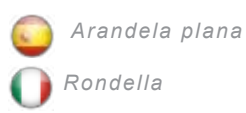

**DIN 125**



**DIN 9021**



**DIN 127**

Código	Medida D x L (mm)	Código	Medida D x L (mm)	Código	Medida D x L (mm)
D125M03	M-3	D9021M03	M-3	D0127M03	M-3
D125M04	M-4	D9021M04	M-4	D0127M04	M-4
D125M05	M-5	D9021M05	M-5	D0127M05	M-5
D125M06	M-6	D9021M06	M-6	D0127M06	M-6
D125M08	M-8	D9021M08	M-8	D0127M08	M-8
D125M10	M-10	D9021M10	M-10	D0127M10	M-10
D125M12	M-12	D9021M12	M-12	D0127M12	M-12
D125M14	M-14	D9021M14	M-14	D0127M14	M-14
D125M16	M-16	D9021M16	M-16	D0127M16	M-16
D125M18	M-18	D9021M18	M-18	D0127M18	M-18
D125M20	M-20	D9021M20	M-20	D0127M20	M-20
D125M22	M-22	D9021M22	M-22	D0127M22	M-22
D125M24	M-24	D9021M24	M-24	D0127M24	M-24
D125M27	M-27	D9021M27	M-27	D0127M27	M-27
D125M30	M-30	D9021M30	M-30	D0127M30	M-30
D125M33	M-33	D9021M33	M-33	D0127M33	M-33
D125M36	M-36	D9021M36	M-36	D0127M36	M-36
D125M39	M-39	D9021M39	M-39	D0127M39	M-39
D125M42	M-42	D9021M42	M-42	D0127M42	M-42

M	D2 (mm)	D1 (mm)	H (mm)
M-3	7	3,2	0,5
M-4	9	4,3	0,8
M-5	10	5,3	1
M-6	12	6,4	1,6
M-8	16	8,4	1,6
M-10	20	10,5	2
M-12	24	13	2,5
M-14	28	15	2,5
M-16	30	17	3
M-18	34	19	3
M-20	37	21	3
M-22	39	23	3
M-24	44	25	4
M-27	50	28	4
M-30	56	31	4
M-33	60	34	5
M-36	66	37	5
M-39	72	40	6
M-42	78	43	7

M	d1 (mm)	d (mm)	S (mm)
M-3	10		
M-4	12	4,3	0,8
M-5	15	5,3	1
M-6	18	6,4	1,6
M-8	25	8,4	1,6
M-10	30	10,5	2
M-12	40	13	2,5
M-14	45	15	2,5
M-16	50	17	3
M-18	56	19	3
M-20	60	21	3
M-22	68	23	3
M-24	70	25	4
M-27	50	28	4
M-30	90	31	4
M-33	110	34	5
M-36	130	37	5
M-39	140	40	6
M-42	160	43	7

M	d1 (mm)	d (mm)	S (mm)
M-3	6,7	3,1	0,8
M-4	7,6	4,1	0,9
M-5	9,2	5,1	1,2
M-6	11,8	6,1	1,6
M-8	14,8	8,1	1,6
M-10	18,1	10,2	2,2
M-12	21,1	12,2	2,5
M-14	24,1	14,2	3
M-16	27,4	16,2	3,5
M-18	29,4	18,2	3,5
M-20	33,6	20,2	4
M-22	35,9	22,5	4
M-24	40	24,5	5
M-27	43	27,5	5
M-30	48,2	30,5	6
M-33	55,2	33,5	6
M-36	58,2	36,5	6
M-39	61,2	39,5	6
M-42	68,2	42,5	7

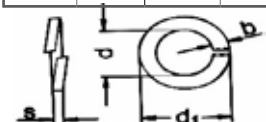
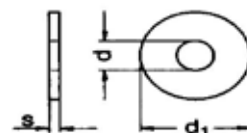
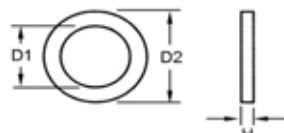

## GARANTÍA FESIT



Normas

DIN 125-9021-127+

ISO 4032/4034

Material : clase 8

Recubrimiento: Zincado galvánica



 Arandela plana

 Plain washer

 Anilha plana

 Rondella

 Rondelle

 Unterlegscheibe



**DIN 125 INOX A2**

**DIN 9021 INOX A2**

**DIN 127 INOX A2**

Código	Medida D x L (mm)	Código	Medida D x L (mm)	Código	Medida D x L (mm)
DI125M03	M-3	DI9021M03	M-3	D01127M03	M-3
DI125M04	M-4	DI9021M04	M-4	D01127M04	M-4
DI125M05	M-5	DI9021M05	M-5	D01127M05	M-5
DI125M06	M-6	DI9021M06	M-6	D01127M06	M-6
DI125M08	M-8	DI9021M08	M-8	D01127M08	M-8
DI125M10	M-10	DI9021M10	M-10	D01127M10	M-10
DI125M12	M-12	DI9021M12	M-12	D01127M12	M-12
DI125M14	M-14	DI9021M14	M-14	D01127M14	M-14
DI125M16	M-16	DI9021M16	M-16	D01127M16	M-16
DI125M18	M-18	DI9021M18	M-18	D01127M18	M-18
DI125M20	M-20	DI9021M20	M-20	D01127M20	M-20
DI125M22	M-22	DI9021M22	M-22	D01127M22	M-22
DI125M24	M-24	DI9021M24	M-24	D01127M24	M-24
DI125M27	M-27	DI9021M27	M-27	D01127M27	M-27
DI125M30	M-30	DI9021M30	M-30	D01127M30	M-30
DI125M33	M-33	DI9021M33	M-33	D01127M33	M-33
DI125M36	M-36	DI9021M36	M-36	D01127M36	M-36
DI125M39	M-39	DI9021M39	M-39	D01127M39	M-39
DI125M42	M-42	DI9021M42	M-42	D01127M42	M-42

M	D2 (mm)	D1 (mm)	H (mm)
M-3	7	3,2	0,5
M-4	9	4,3	0,8
M-5	10	5,3	1
M-6	12	6,4	1,6
M-8	16	8,4	1,6
M-10	20	10,5	2
M-12	24	13	2,5
M-14	28	15	2,5
M-16	30	17	3
M-18	34	19	3
M-20	37	21	3
M-22	39	23	3
M-24	44	25	4
M-27	50	28	4
M-30	56	31	4
M-33	60	34	5
M-36	66	37	5
M-39	72	40	6
M-42	78	43	7

M	d1 (mm)	d (mm)	S (mm)
M-3	10		
M-4	12	4,3	0,8
M-5	15	5,3	1
M-6	18	6,4	1,6
M-8	25	8,4	1,6
M-10	30	10,5	2
M-12	40	13	2,5
M-14	45	15	2,5
M-16	50	17	3
M-18	56	19	3
M-20	60	21	3
M-22	68	23	3
M-24	70	25	4
M-27	50	28	4
M-30	90	31	4
M-33	110	34	5
M-36	130	37	5
M-39	140	40	6
M-42	160	43	7

M	d1 (mm)	d (mm)	S (mm)
M-3	6,7	3,1	0,8
M-4	7,6	4,1	0,9
M-5	9,2	5,1	1,2
M-6	11,8	6,1	1,6
M-8	14,8	8,1	1,6
M-10	18,1	10,2	2,2
M-12	21,1	12,2	2,5
M-14	24,1	14,2	3
M-16	27,4	16,2	3,5
M-18	29,4	18,2	3,5
M-20	33,6	20,2	4
M-22	35,9	22,5	4
M-24	40	24,5	5
M-27	43	27,5	5
M-30	48,2	30,5	6
M-33	55,2	33,5	6
M-36	58,2	36,5	6
M-39	61,2	39,5	6
M-42	68,2	42,5	7

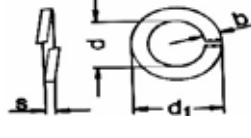
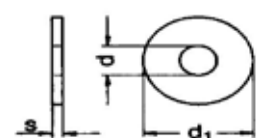
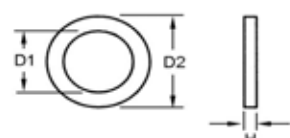

## DIN 125-9021-127

Arandelas planas.



www.fesit.es

GARANTÍA FESIT

TESTED & APPROVED  
BY FESIT

Steel INOX A-2  
CALIDAD FESIT

Normas  
DIN 127-125-9021



 Varilla roscada

 Threaded rod

 Varão roscado

 Barra filettata

 Tige filetée

 Gewindestange

# DIN 975



**DIN 975 4.8 Sin baño**

**DIN 975 8.8 Sin baño**

**DIN 975 4.8 Zincado**

Varilla roscada

D (mm)	L (mm) 1.000	L (mm) 3.000
M-3	X	
M-4	X	
M-5	X	
M-6	X	X
M-8	X	X
M-10	X	X
M-12	X	X
M-14	X	X
M-16	X	X
M-18	X	X
M-20	X	X
M-22	X	X
M-24	X	X
M-27	X	X
M-30	X	X
M-33	X	X
M-36	X	X
M-39	X	
M-42	X	
M-45	X	
M-48	X	
M-52	X	
M-56	X	
M-60	X	

D (mm)	L (mm) 1.000
M-3	
M-4	
M-5	
M-6	X
M-8	X
M-10	X
M-12	X
M-14	X
M-16	X
M-18	X
M-20	X
M-22	X
M-24	X
M-27	X
M-30	X
M-33	X
M-36	X
M-39	X
M-42	X
M-45	X
M-48	X
M-52	X
M-56	X
M-60	X

D (mm)	L (mm) 1.000	L (mm) 2.000	L (mm) 3.000
M-3	X		
M-4	X	X	
M-5	X	X	
M-6	X	X	X
M-8	X	X	X
M-10	X	X	X
M-12	X	X	X
M-14	X	X	X
M-16	X	X	X
M-18	X	X	X
M-20	X	X	X
M-22	X		X
M-24	X		X
M-27	X		X
M-30	X		X
M-33	X		X
M-36	X		X
M-39	X		
M-42	X		
M-45	X		
M-48	X		
M-52	X		
M-56	X		
M-60	X		

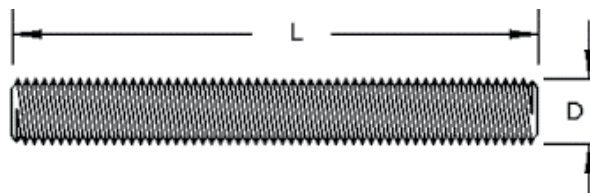

**GARANTÍA FESIT**



Normas

DIN 975

Material : clase 4.8. 8.8



 Varilla roscada

 Threaded rod

 Varão roscado

 Barra filettata

 Tige filetée

 Gewindestange



### DIN 975 8.8 Zincado

### DIN 975 8.8 Galvanizado en caliente

### DIN 975 Inoxidable A2



D (mm)	L (mm) 1.000
M-3	
M-4	
M-5	
M-6	X
M-8	X
M-10	X
M-12	X
M-14	X
M-16	X
M-18	X
M-20	X
M-22	X
M-24	X
M-27	X
M-30	X
M-33	X
M-36	X
M-39	X
M-42	X
M-45	X
M-48	X
M-52	X
M-56	X
M-60	

D (mm)	L (mm) 1.000
M-3	
M-4	
M-5	
M-6	
M-8	X
M-10	X
M-12	X
M-14	X
M-16	X
M-18	X
M-20	X
M-22	X
M-24	X
M-27	X
M-30	X
M-33	X
M-36	X
M-39	X
M-42	X
M-45	X
M-48	X
M-52	X
M-56	X
M-60	X

D (mm)	L (mm) 1.000	L (mm) 3.000
M-3	X	
M-4	X	
M-5	X	X
M-6	X	X
M-8	X	X
M-10	X	X
M-12	X	X
M-14	X	X
M-16	X	X
M-18	X	X
M-20	X	X
M-22	X	X
M-24	X	X
M-27	X	X
M-30	X	X
M-33	X	
M-36	X	
M-39	X	
M-42	X	
M-45	X	
M-48	X	
M-52	X	
M-56	X	
M-60	X	

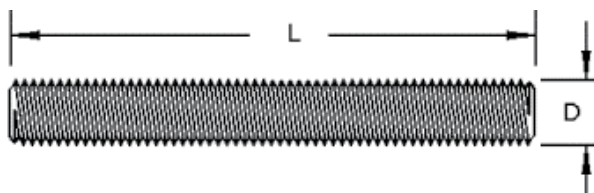

## DIN 975

Varilla roscada.

GARANTÍA FESIT



Normas  
DIN 975

