

Deadwood Interpretation Plazas

Deadwood, South Dakota

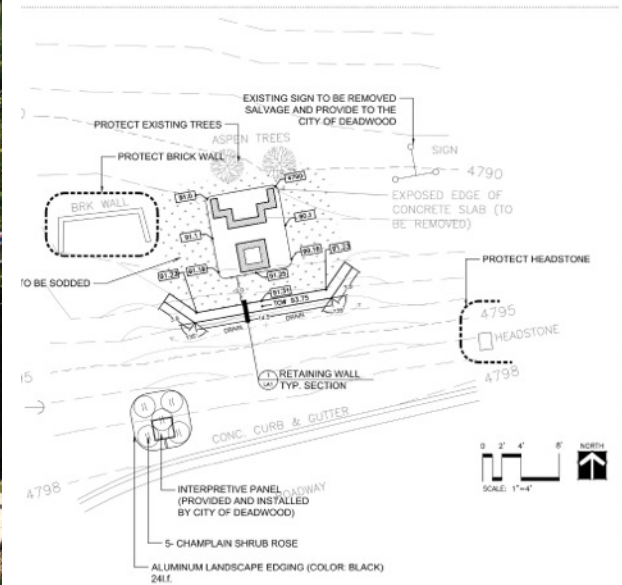

The Deadwood USS Maine Memorial, Deadwood School Canon and Flag Plaza, the Deadwood Mountain Grand Mining Preservation Plaza, and the Mt. Moriah Chinese Burner projects play a critical role in the story of the City of Deadwood, South Dakota. Each project was unique in its own story and design. Mark Jobman was the Lead Designer and Landscape Architect on the Deadwood Plaza and Interpretation Projects. The Mt. Moriah Chinese Burner Project included the re-creation of the history burner used in Mt. Moriah. The project required the re-creation of the burner based upon archeological data and the only two photos showing the burner. The USS Maine Memorial included the creation of a new interpretive plaza to house a preserved USS Maine Battle Shell. The plaza included seating, preservation plaques, USS Maine Memorial stone, and aesthetic landscape.

Key Elements:

- ▶ Aesthetic interpretation plazas
- ▶ Carefully selected building materials
- ▶ Understanding of historic elements and significance

Budget: Varies

Completed: 2011-Present

Reference: Kevin Kuckenbecker



* Project was commission and completed while Mark Jobman, Principal of Elevate Design Studios, was employed at Previous Firm.